

STATE OF ILLINOIS
 DEPARTMENT OF TRANSPORTATION
 DIVISION OF HIGHWAYS

F.A. RTE.	SECTION	COUNTY	TOTAL SHEETS	SHEET NO.
	07-00137-00-LS	WILL	8	1
FED. ROAD DIST. NO.	ILLINOIS	CONTRACT NO. 63065		

PLANS FOR PROPOSED FEDERAL AID HIGHWAY
 PLAINFIELD/NAPERVILLE ROAD
 104TH ST. TO 95TH ST.
 MEDIAN LANDSCAPING

SECTION NO.: 07-00137-00-LS
 PROJECT NO.: TE-00D1(788)
 JOB NO.: C-91-142-08
 WILL COUNTY

INDEX OF SHEETS

SHEET NO.	DESCRIPTION
1	COVER SHEET
2	GENERAL NOTES AND INDEX OF HIGHWAY STANDARDS SHEET
3	SUMMARY OF QUANTITIES AND PLANTING DETAILS SHEET
4	EXISTING AND PROPOSED TYPICAL CROSS SECTIONS SHEET
5	PLAN - STA 115+78.15 TO 123+98
6	PLAN - STA 123+98 TO 136+21
7	PLAN - STA 136+21 TO 148+48
8	PLAN - STA 148+48 TO 156+52.79

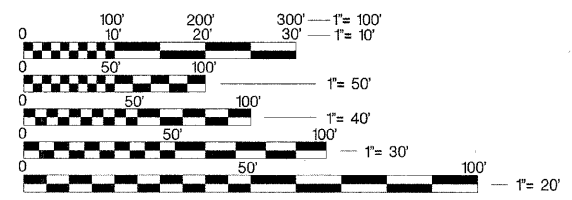

FULL SIZE PLANS HAVE BEEN PREPARED USING STANDARD ENGINEERING SCALES. REDUCED SIZED PLANS WILL NOT CONFORM TO STANDARD SCALES. IN MAKING MEASUREMENTS ON REDUCED PLANS, THE ABOVE SCALES MAY BE USED.

JULIE.
 JOINT UTILITY LOCATION INFORMATION FOR EXCAVATION
 1-800-892-0123
 OR 811

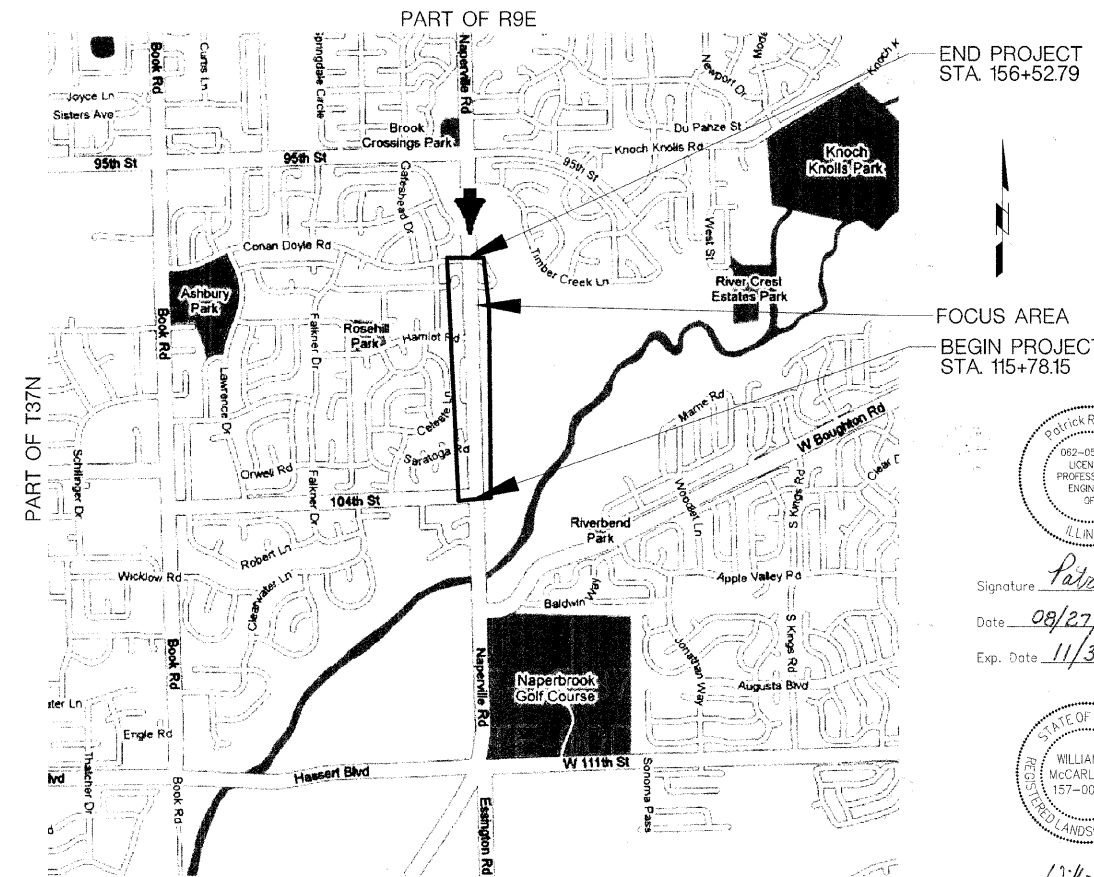

PROJECT LOCATION MAP (NTS)
 GROSS LENGTH: 4074.64 FEET (0.77 MILES)
 NET LENGTH: 2061.50 FEET (0.39 MILES)

Signature: Patrick R. Lynch
 Date: 08/27/08
 Exp. Date: 11/30/2009



Signature: William J. McCarley III
 Date: 27 Aug 08
 Exp. Date: 31 Aug 09

STATE OF ILLINOIS DEPARTMENT OF TRANSPORTATION DIVISION OF HIGHWAYS	
Approved	08/28/08 (DATE) Robert J. Kozurek, Engineering Manager, City of Naperville
Passed	SEPTEMBER 2, 2008 (DATE) Christopher Holt, District Engineer of Local Roads and Streets
Releasing for Bid Based on Limited Review	SEPTEMBER 3, 2008 (DATE) Diana M. O'Keefe, Deputy Director of Highways, Region 1 Engineer

PRINTED BY THE AUTHORITY OF THE STATE OF ILLINOIS

FIELD ENGINEER, MARILYN SOLOMON, 847-705-4407

CONTRACT NO. 63065

GENERAL NOTES

1. ALL CONSTRUCTION SHALL BE DONE IN ACCORDANCE WITH THE FOLLOWING ILLINOIS STANDARD SPECIFICATIONS: THE "STANDARD SPECIFICATIONS FOR ROAD AND BRIDGE CONSTRUCTION" ADOPTED JANUARY 1, 2007; THE LATEST EDITION OF THE "MANUAL ON UNIFORM TRAFFIC CONTROL DEVICES FOR STREETS AND HIGHWAYS"; THE "MANUAL OF TEST PROCEDURES FOR MATERIALS"; THE LATEST EDITION OF THE "SUPPLEMENTAL SPECIFICATIONS AND RECURRING SPECIAL PROVISIONS", AND THE DETAILS AND SPECIAL PROVISIONS INCLUDED IN THE CONTRACT DOCUMENTS.
2. THE CONTRACTOR SHALL CALL J.U.L.I.E. (1-800--892-0123) 72 HOURS BEFORE EXCAVATION. FOR UNDERGROUND UTILITY LOCATIONS, UTILITY LOCATIONS SHOWN ON PLANS ARE APPROXIMATE.
3. THE CONTRACTOR SHALL BE RESPONSIBLE FOR THE PROTECTION OF ALL ABOVE AND BELOW GROUND UTILITIES, EVEN THOUGH THEY MAY APPEAR ON THE PLANS, AND ANY DAMAGE DONE TO EXISTING UTILITIES BY THE CONTRACTOR SHALL BE REPAIRED IMMEDIATELY AT THE CONTRACTOR'S EXPENSE.
4. IT SHALL BE THE CONTRACTOR'S RESPONSIBILITY TO VERIFY ALL DIMENSIONS AND EXISTING CONDITIONS IN THE FIELD PRIOR TO BIDDING OF THE PROJECT.
5. THE CONTRACTOR SHALL PROTECT AND CAREFULLY PRESERVE ALL PROPERTY MARKS AND MONUMENTS UNTIL THE OWNER, AND AUTHORIZED SURVEYOR OR AGENT HAS WITNESSED OR OTHERWISE REFERENCED THEIR LOCATION.
6. THE CONTRACTOR SHALL COORDINATE CONSTRUCTION ACTIVITIES WITH UTILITY COMPANIES, THE WILL COUNTY DEPARTMENT OF HIGHWAYS, LOCAL AGENCIES, AND THE ILLINOIS DEPARTMENT OF TRANSPORTATION.
7. WHEN ARTIFICIAL LIGHTING IS UTILIZED IN NIGHT OPERATIONS THE CONTRACTOR SHALL EXERCISE THE UTMOST PRECAUTIONS IN PREVENTING ADVERSE VISIBILITY TO THE MOTORING PUBLIC AND ADJOINING RESIDENTIAL AREAS.
8. THE CONTRACTOR SHALL MAINTAIN THE SURFACE DRAINAGE OF THE ROAD DURING CONSTRUCTION OF THIS PROJECT. WHEN EXISTING DRAINAGE FACILITIES ARE DISTURBED, THE CONTRACTOR SHALL PROVIDE AND MAINTAIN TEMPORARY OUTLETS AND CONNECTIONS FOR ALL PRIVATE OR PUBLIC DRAINS, SEWER INLETS, OR CATCH BASINS. THE CONTRACTOR SHALL PROVIDE FACILITIES TO TAKE IN ALL STORM WATER WHICH WILL BE RECEIVED BY THESE AND SEWER DISCHARGE THE SAME. THE CONTRACTOR SHALL PROVIDE AND MAINTAIN A TEMPORARY OUTLET AND BE PREPARED AT ALL TIMES TO DISPOSE OF THE WATER RECEIVED FROM THESE TEMPORARY CONNECTIONS UNTIL SUCH TIME AS THE PERMANENT CONNECTIONS ARE IN SERVICE. THIS WORK SHALL NOT BE PAID FOR DIRECTLY, BUT WILL BE CONSIDERED INCIDENTAL TO THE CONTRACT UNLESS OTHERWISE NOTED ON PLANS.
9. THE CONTRACTOR IS TO MAINTAIN ACCESS TO ABUTTING PROPERTY OWNERS AT ALL TIMES, EXCEPT FOR SHORT PERIODS OF TIME, WHEN ACCESS IS GOING TO BE INTERRUPTED, THE CONTRACTOR SHALL NOTIFY THE PROPERTY OWNER NO LESS THAN 24 HOURS IN ADVANCE OF THE INTERRUPTION AND SHALL NOTIFY THE OWNER OF THE TIME AND DURATION OF THE INTERRUPTION.
10. BARRICADES: THE CONTRACTOR SHALL PROVIDE AND INSTALL TWO WEIGHTED SAND BAGS ON EACH TYPE I OR II BARRICADE USED - ONE (1) WEIGHTED SANDBAG ACROSS EACH BOTTOM RAIL.
11. EXISTING CONDITIONS WERE TAKEN FROM THE BEST AVAILABLE INFORMATION. INFORMATION SHOWN CONCERNING FEATURES AND UTILITIES IS NOT GUARANTEED ALL INCLUSIVE OR CORRECT. THE CONTRACTOR SHALL VERIFY THE FEATURES PRIOR TO CONSTRUCTION. EXISTING UTILITIES SHALL BE MAINTAINED IN SERVICE AT ALL TIMES, UNLESS OTHERWISE NOTED ON THE PLANS. THE LOCATION, MATERIAL, AND DIMENSIONS OF EXISTING FACILITIES AND OBSTRUCTIONS ARE BASED UPON AVAILABLE RECORDS AND ARE SHOWN ON THE PLANS STRICTLY AS AN AID TO THE CONTRACTOR, BUT MUST NOT BE CONSTRUED AS BEING ACCURATE, COMPLETE, OR CORRECT.
12. IN ACCORDANCE WITH ARTICLE 107.25 OF THE STANDARD SPECIFICATIONS, THE CONTRACTOR SHALL BE REQUIRED TO MAINTAIN, STOCK, RE-ERECT TEMPORARILY AND/OR REPLACE AT PERMANENT LOCATIONS ALL EXISTING SIGNING AS NOTED THEREIN AS DIRECTED BY THE ENGINEER.
13. CITY OF NAPERVILLE DPU-E REQUIRES THE CONTRACTOR TO CONTACT J.U.L.I.E. TO LOCATE ALL UTILITIES. CONTRACTOR SHALL PROTECT ALL UTILITIES. IT IS NOT ANTICIPATED THAT UTILITIES SHALL HAVE TO BE RELOCATED.

STATE STANDARDS

- 000001-05 STANDARD SYMBOLS, ABBREVIATIONS, AND PATTERNS (8 SHEETS)
- 701601-05 URBAN LANE CLOSURE, MULTILANE, 1W OR 2W WITH NONTRAVERSABLE MEDIAN (2 SHEETS)
- 701701-05 URBAN LANE CLOSURE, MULTILANE INTERSECTION (1 SHEET)
- 701801-03 LANE CLOSURE MULTILANE 1W OR 2W CROSSWALK OR SIDEWALK CLOSURE (1 SHEET)
- 701901 TRAFFIC CONTROL DEVICES (3 SHEETS)

FILE NAME =	USER NAME = WJM	DESIGNED - WJM	REVISED -	STATE OF ILLINOIS DEPARTMENT OF TRANSPORTATION	PLAINFIELD/NAPERVILLE ROAD MEDIAN LANDSCAPING	F.A. -	SECTION	COUNTY	TOTAL	SHEET	
-		DRAWN - MLN	REVISED -				07-00137-00-LS	WILL	8	2	
	PLOT SCALE= 1:20	CHECKED - SLD	REVISED -			CONTRACT NO. 63065					
	PLOT DATE = 08-25-08	DATE - 08-25-08	REVISED -			SCALE: 1"=20' SHEET NO. 2 OF 8 SHEETS GENERAL NOTES AND INDEX OF HWY STANDARDS FED. ROAD DIST. NO. ILLINOIS FED. AID PROJECT					

SUMMARY OF QUANTITIES						
CODE NUMBER	ITEM	UNIT	QUANTITY	ISLAND A	ISLAND B	ISLAND C
				CONSTRUCTION TYPE CODE Y003		
21101805	COMPOST FURNISH AND PLACE, 2"	SQ YD	810	191	239	380
25200110	SODDING, SALT TOLERANT	SQ YD	100			
25200200	SUPPLEMENTAL WATERING	UNIT	10			
67100100	MOBILIZATION	LUMP SUM	1			
70102630	TRAFFIC CONTROL AND PROTECTION, STANDARD 701601	LUMP SUM	1			
70102635	TRAFFIC CONTROL AND PROTECTION, STANDARD 701701	LUMP SUM	1			
70102640	TRAFFIC CONTROL AND PROTECTION, STANDARD 701801	LUMP SUM	1			
70106800	CHANGEABLE MESSAGE SIGN	CAL MO	2			
B2006320	TREE, SYRINGA RETICULATA 'IVORY SILK' (IVORY SILK JAPANESE TREE LILAC), 2-1/2" CAL. TREE FORM, BALLED AND BURLAPPED	EACH	21	3	6	12
C2010224	SHRUB, SPIRAEA JAPONICA 'LITTLE PRINCESS' (LITTLE PRINCESS JAPANESE SPIREA), 2' HEIGHT, BALLED AND BURLAPPED	EACH	369	82	123	164
X0301115	LANDSCAPE BED EDGING	FOOT	1058	204	340	514
X0322831	GAILLARDIA X GRANDIFLORA 'GOBLIN' - CONTAINER GROWN (2 QUART)	EACH	228	58	58	112
XX003239	CALAMAGROSTIS ACUTIFLORA 'KARL FOERSTER' 2 GAL	EACH	440	124	85	231
XX003273	SEDUM 'AUTUMN JOY' (1 GAL.)	EACH	162	36	63	63
XX005767	TREE, MALUS 'CENTURION' (CENTURION CRABAPPLE) 1-3/4" BALLED AND BURLAPPED	EACH	30	6	9	15
XX007724	SOD STRIPPING, 2" DEPTH	SQ YD	810	191	239	380

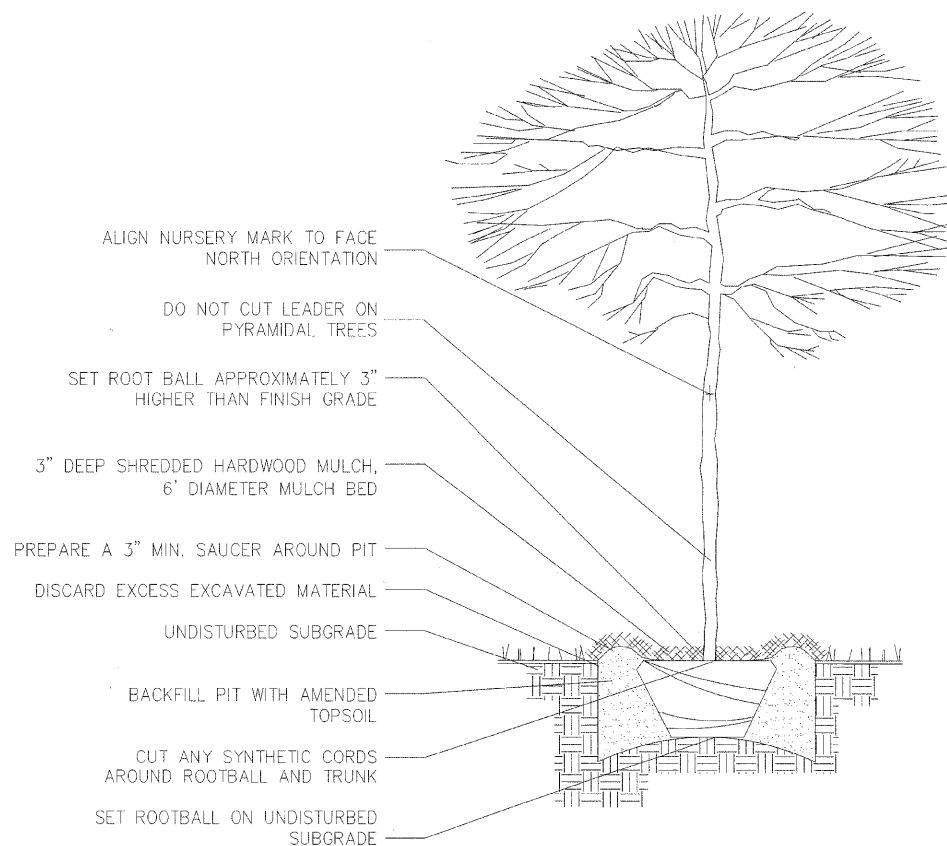

1 DECIDUOUS TREE
NOT TO SCALE

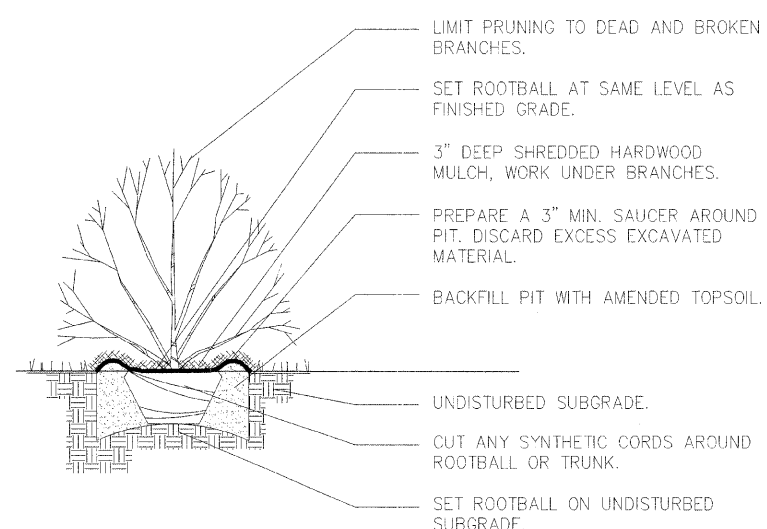

2 SHRUB PLANTING
NOT TO SCALE

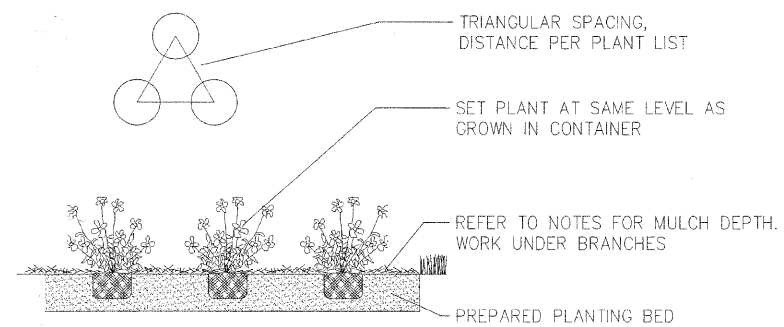

3 PERENNIAL PLANTING
NOT TO SCALE

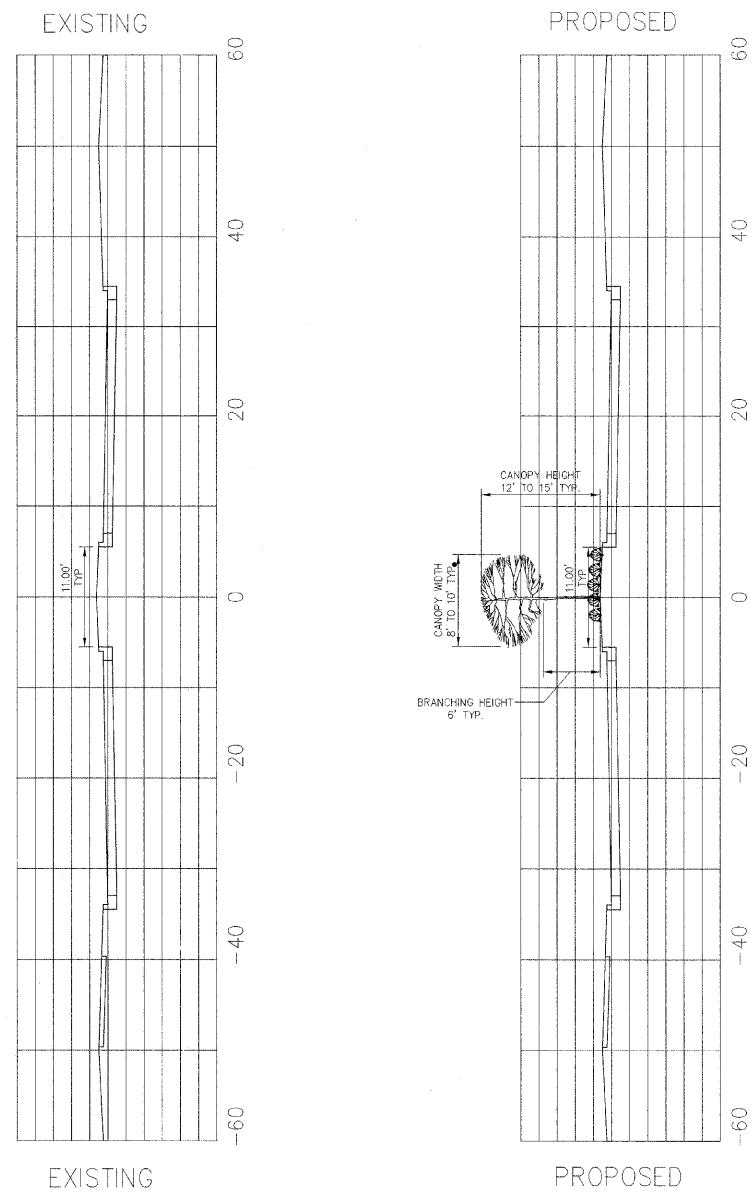

TYPICAL CROSS SECTION - 11 FOOT MEDIAN
 124+49 TO 127+42
 132+58 TO 137+67
 143+48 TO 151+93

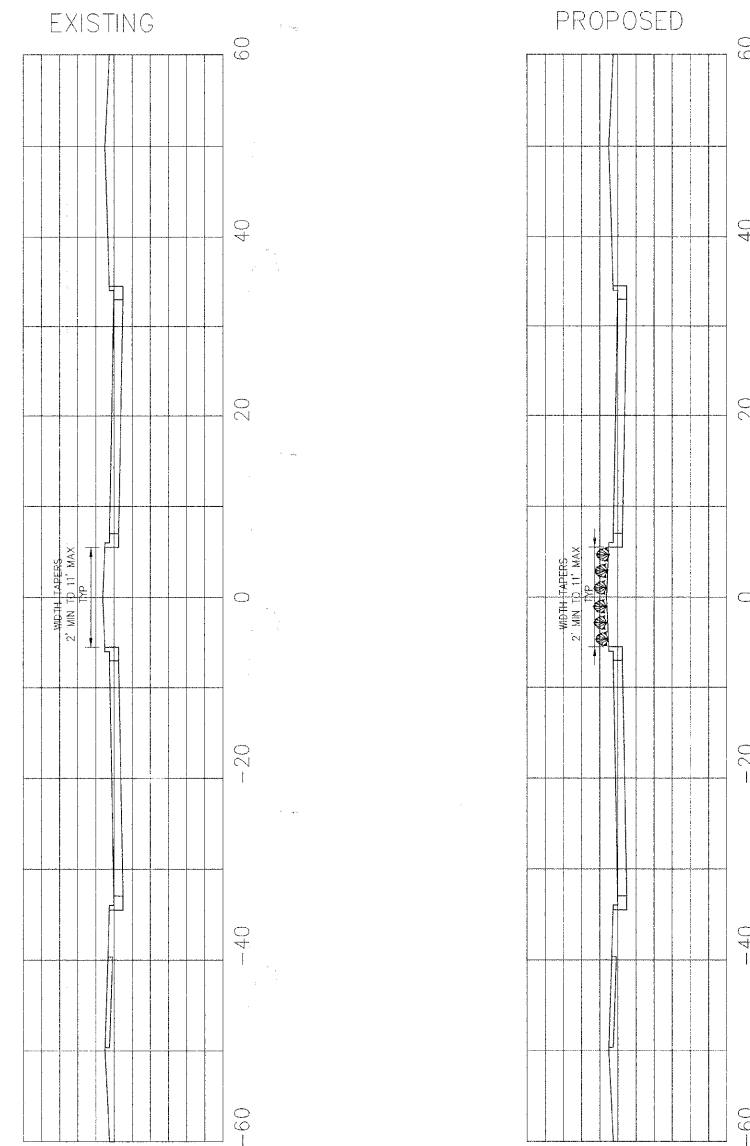

TYPICAL CROSS SECTION - TAPERING MEDIAN
 124+19 TO 124+49
 127+42 TO 128+21
 132+33 TO 132+58
 137+67 TO 137+98
 143+26 TO 143+48
 151+93 TO 153+44

FILE NAME =	USER NAME = WJM	DESIGNED - WJM	REVISED -	STATE OF ILLINOIS DEPARTMENT OF TRANSPORTATION	PLAINFIELD/NAPERVILLE ROAD MEDIAN LANDSCAPING	F.A. RTE.	SECTION	COUNTY	TOTAL SHEETS	SHEET NO.	
		DRAWN - MLN	REVISED -			07-00137-00-LS	WILL	8	4		
		CHECKED - SLD	REVISED -			CONTRACT NO. 63065					
		DATE - 08-25-08	REVISED -			FED. ROAD DIST. NO. ILLINOIS FED. AID PROJECT					
SCALE: 1"=10' H & V SHEET NO. 4 OF 8 SHEETS EXISTING AND PROPOSED TYPICAL CROSS SECTIONS											

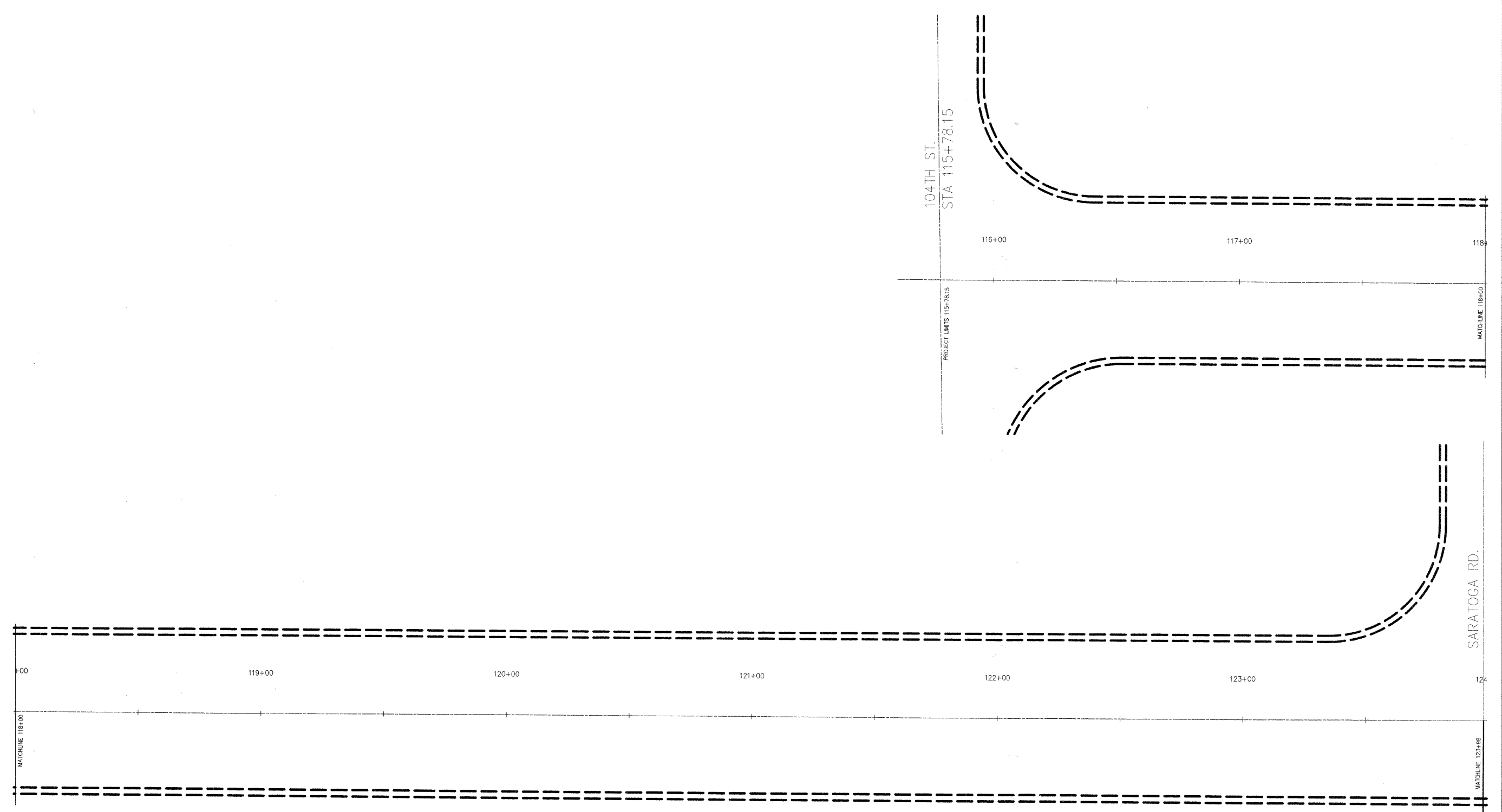
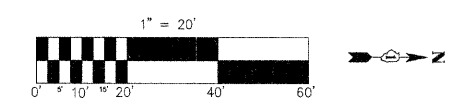

FILE NAME =	USER NAME = MLN	DESIGNED - WJM	REVISED -
-		DRAWN - MLN	REVISED -
	PLOT SCALE = 1:20	CHECKED - SLD	REVISED -
	PLOT DATE = 08-25-08	DATE - 08-25-08	REVISED -

**STATE OF ILLINOIS
DEPARTMENT OF TRANSPORTATION**

PLAINFIELD/NAPERVILLE ROAD MEDIAN LANDSCAPING

SCALE: 1"=20' | SHEET NO. 5 OF 8 SHEETS | STA. 115+78.15 TO STA. 123+98

F.A. RTE.	SECTION	COUNTY	TOTAL SHEETS	SHEET NO.
	07-00137-00-LS	WILL	8	5
CONTRACT NO. 63065				
FED. ROAD DIST. NO. ILLINOIS FED. AID PROJECT				

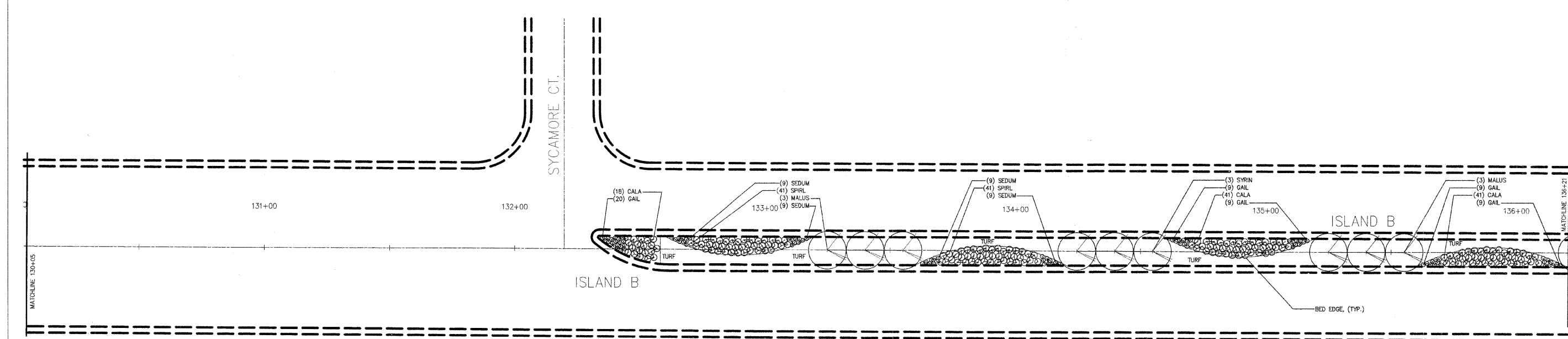
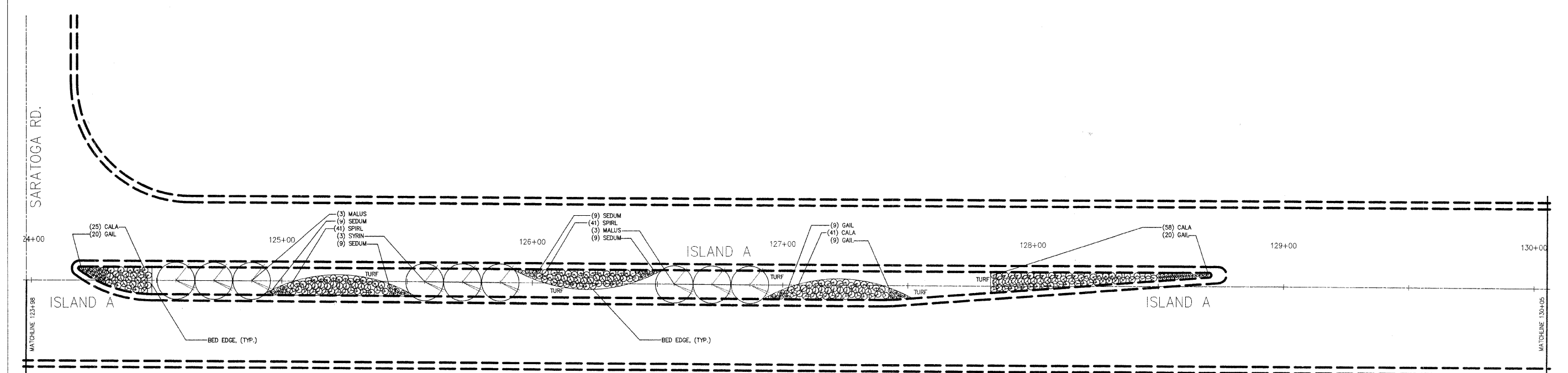
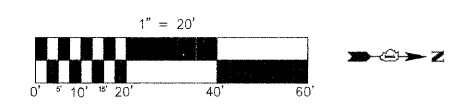

FILE NAME =	USER NAME = MLN	DESIGNED - WJM	REVISED -	STATE OF ILLINOIS DEPARTMENT OF TRANSPORTATION	PLAINFIELD/NAPERVILLE ROAD MEDIAN LANDSCAPING	F.A. -	SECTION	COUNTY	TOTAL SHEETS	SHEET NO.
	PLOT SCALE = 1:20	CHECKED - WJM	REVISED -			07-00137-00-LS	WILL	8	6	
	PLOT DATE = 08-25-08	DATE - 08-25-08	REVISED -			CONTRACT NO. 63065				
						SCALE: 1"=20'	SHEET NO. 6 OF 8 SHEETS	STA. 123+98 TO STA. 136+21	FED. ROAD DIST. NO. ILLINOIS FED. AID PROJECT	

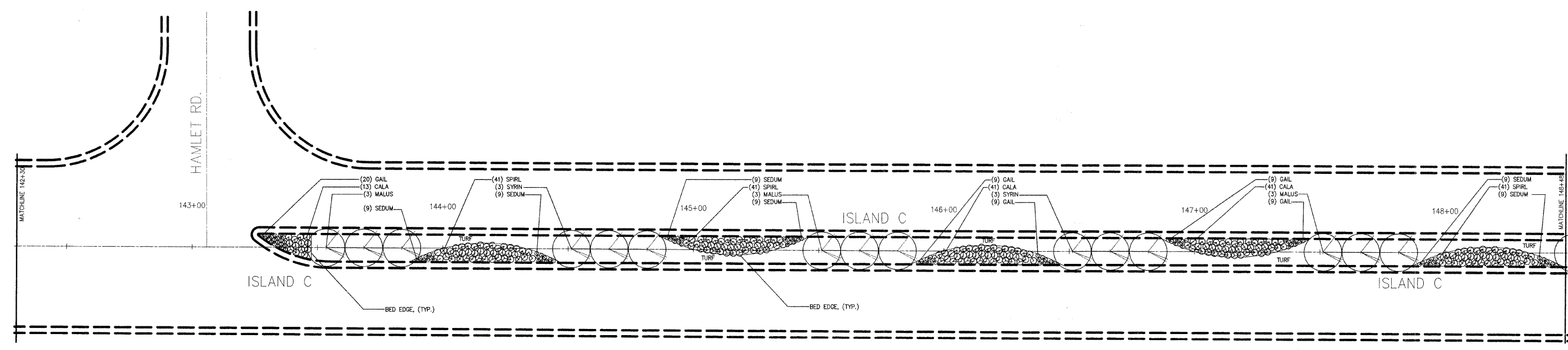
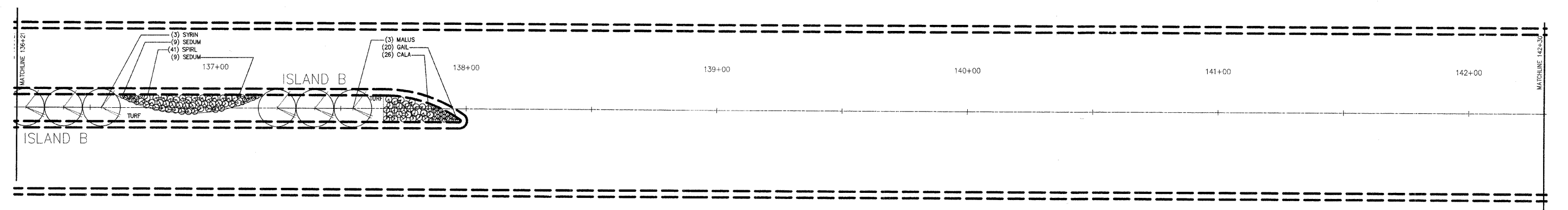
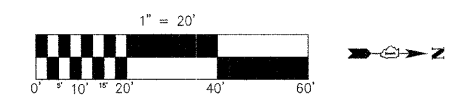

FILE NAME = -	USER NAME = MLN	DESIGNED - WJM	REVISED -	STATE OF ILLINOIS DEPARTMENT OF TRANSPORTATION	PLAINFIELD/NAPERVILLE ROAD MEDIAN LANDSCAPING	F.A. -	SECTION	COUNTY	TOTAL SHEETS	SHEET NO.
	PLOT SCALE = 1:20	DRAWN - MLN	REVISED -			07-00137-00-LS	WILL	8	7	
	PLOT DATE = 08-25-08	CHECKED - WJM	REVISED -			CONTRACT NO. 63065				
		DATE - 08-25-08	REVISED -			FED. ROAD DIST. NO. ILLINOIS FED. AID PROJECT				
				SCALE: 1"=20'		SHEET NO. 7 OF 8 SHEETS		STA. 138+21 TO STA. 148+48		

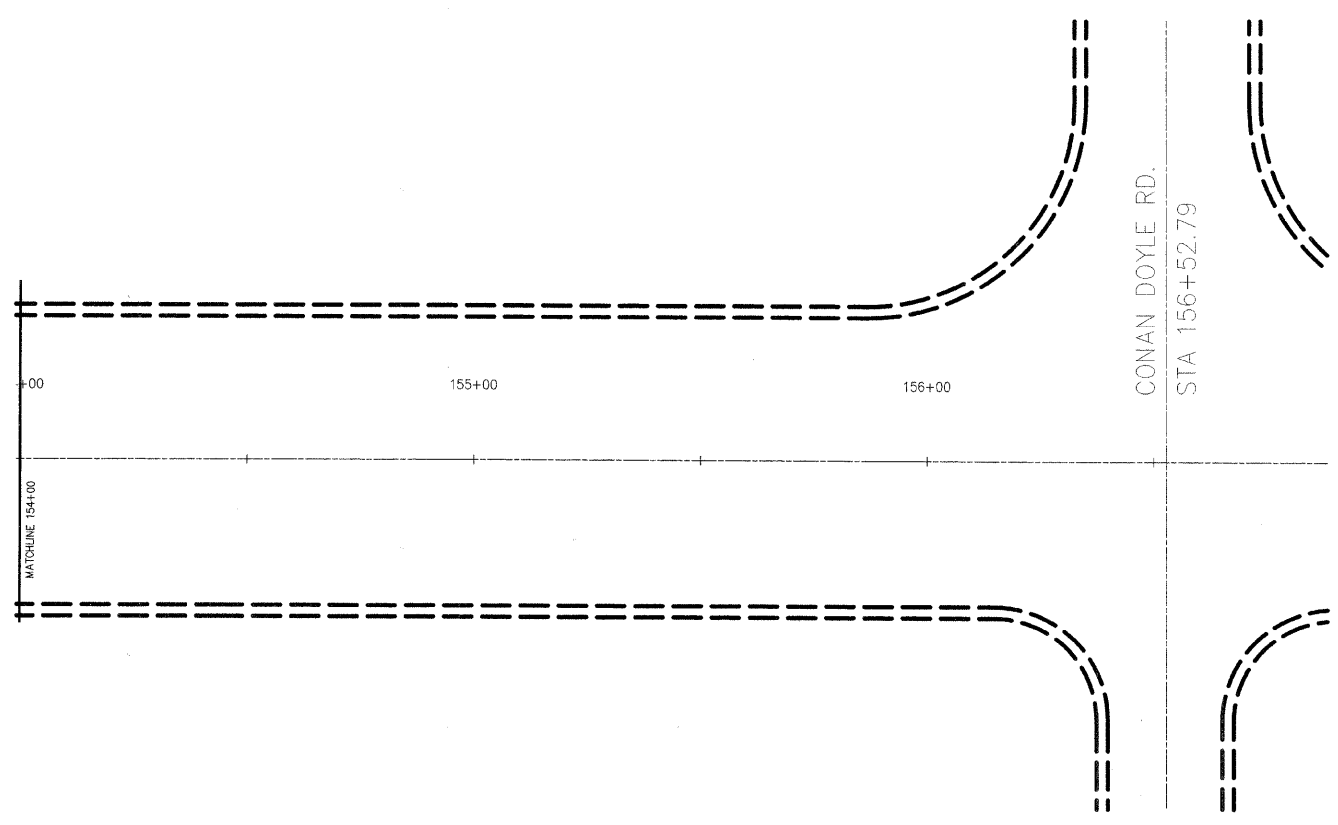
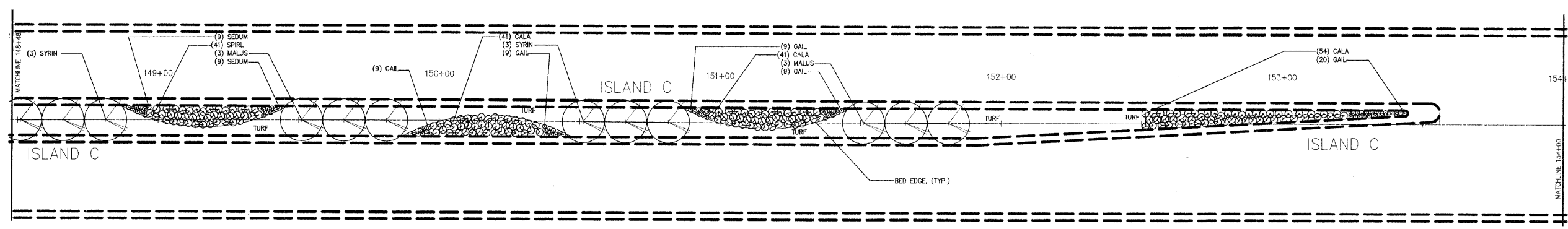
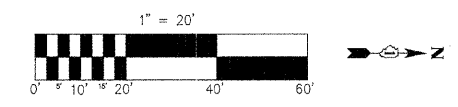

FILE NAME = -	USER NAME = MLN	DESIGNED - WJM	REVISED -	STATE OF ILLINOIS DEPARTMENT OF TRANSPORTATION	PLAINFIELD/NAPERVILLE ROAD MEDIAN LANDSCAPING	F.A. -	SECTION	COUNTY	TOTAL	SHEET
	PLOT SCALE = 1:20	DRAWN - MLN	REVISED -			RTE.	07-00137-00-LS	WILL	8	8
	PLOT DATE = 08-25-08	CHECKED - WJM	REVISED -			CONTRACT NO. 63065				
	DATE - 08-25-08	DATE - 08-25-08	REVISED -			FED. ROAD DIST. NO. ILLINOIS FED. AID PROJECT				
SCALE: 1"=20'						SHEET NO. 8 OF 8 SHEETS		STA. 148+48 TO STA. 156+52.79		