

ROUTE NO.	SECTION	COUNTY	TOTAL SHEETS	SHEET NO.
2714	07-00075-00-RP	COOK	16	1
ILLINOIS PROJECT M-9003 (035)				
CONTRACT NO. 63070				

INDEX OF SHEETS ON SHEET NO. 2

TRAFFIC DATA

2030 ADT = 11,600
 POSTED SPEED LIMIT: 30 MPH
 DESIGN SPEED 30 MPH

DESIGN DESIGNATION

COLLECTOR

PROJECT LOCATED IN
 THE VILLAGE OF SCHILLER PARK

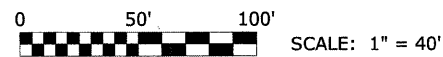
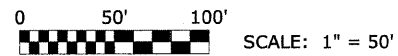
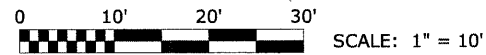

STATE OF ILLINOIS
DEPARTMENT OF TRANSPORTATION
DIVISION OF HIGHWAYS
PLANS FOR PROPOSED
FEDERAL AID HIGHWAY
FAU ROUTE 2714 (25th AVENUE)
WAVELAND AVENUE TO LAWRENCE AVENUE
SECTION NO. 07-00075-00-RP
PROJECT M-9003 (035)
VILLAGE OF SCHILLER PARK
COOK COUNTY
JOB NO. C-91-414-08

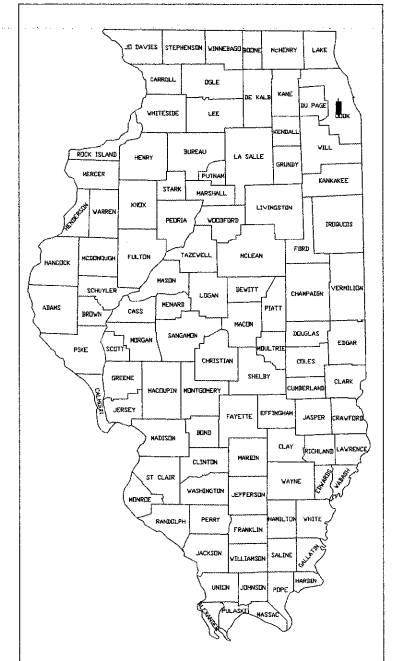

LOCATION OF SECTION INDICATED THIS: [Symbol]

FULL SIZE PLANS HAVE BEEN PREPARED USING STANDARD ENGINEERING SCALES. REDUCED SIZED PLANS WILL NOT CONFORM TO STANDARD SCALES. IN MAKING MEASUREMENTS ON REDUCED PLANS, THE ABOVE SCALES MAY BE USED.

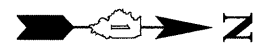

LOCATION MAP
 RANGE 12 EAST

PROJECT ENDS
 STATION 106+75
 25th AVENUE

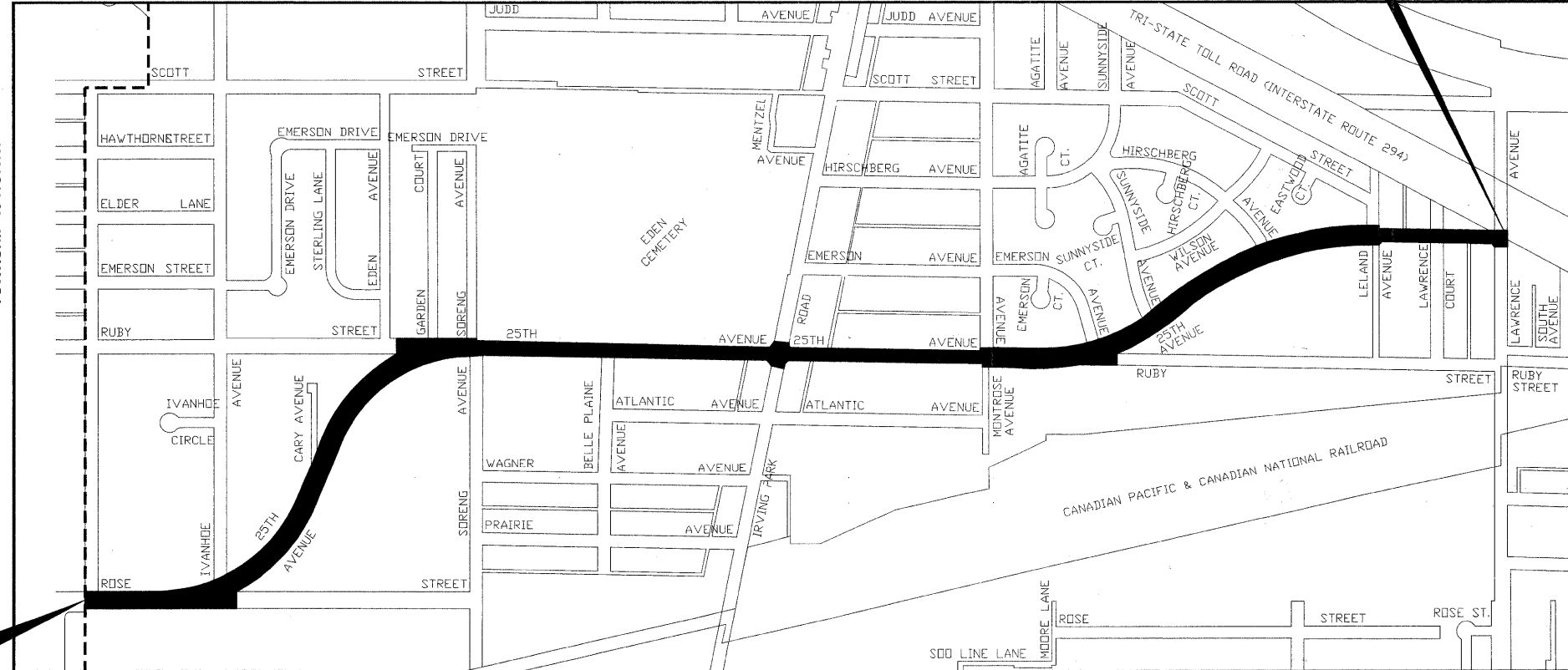

█ - AREA OF IMPROVEMENT

NOT TO SCALE
 GROSS LENGTH OF IMPROVEMENT = 8,015 FT. = 1.518 MI.



Know what's below.
Call before you dig.

CONTRACT NO. 63070

PROJECT BEGINS
 STATION 26+60
 25th AVENUE

STATE OF ILLINOIS
 ILLINOIS DEPARTMENT OF TRANSPORTATION
 DIVISION OF HIGHWAYS

APPROVED: *Anna Montano* 8/14/08 20 08
 VILLAGE OF SCHILLER PARK, PRESIDENT

PASSED: *Christopher M. Holy* SEPTEMBER 02 20 08
 DISTRICT ENGINEER OF LOCAL ROADS & STREETS

RELEASED FOR BID BASED ON LIMITED REVIEW: *Don M. O'Keefe* SEPTEMBER 3, 20 08
 DEPUTY DIRECTOR OF HIGHWAYS, REGION 1 ENGINEER

Mark D. Lucas



DATE SIGNED: 8-1-08
 LICENSE EXPIRES: 11-30-09

EDWIN HANCOCK ENGINEERING COMPANY
 9933 ROOSEVELT ROAD PHONE : (708) 865-0300
 WESTCHESTER, ILLINOIS 60154

Drawing file: W:\Projects\80006062 - 25th Ave Improvement\Cover.dwg Aug 01, 2008 - 9:57am
 FIELD ENGINEER: MARILYN SOLOMON, (847)705-4407

INDEX OF SHEETS

SHEET NO.	DESCRIPTION
1	COVER SHEET, LOCATION MAP
2	INDEX OF SHEETS, LEGEND OF SYMBOLS, & I.D.O.T. STANDARD DRAWINGS
3	SUMMARY OF QUANTITIES
4	EXISTING & PROPOSED TYPICAL CROSS SECTIONS
5-6	PAVEMENT PATCHING SCHEDULES
7-12	EXISTING ROADWAY & PROPOSED IMPROVEMENT PLAN
13	CURB OR CURB AND GUTTER REMOVAL AND REPLACEMENT
14	TRAFFIC CONTROL AND PROTECTION FOR SIDE ROADS, INTERSECTIONS, AND DRIVEWAYS
15	DISTRICT ONE TYPICAL PAVEMENT MARKINGS
16	TRAFFIC CONTROL AND PROTECTIONS AT TURN BAYS (TO REMAIN OPEN TO TRAFFIC)

GENERAL NOTES

STANDARDS

ANY REFERENCE TO STANDARDS THROUGHOUT THE PLANS OR SPECIAL PROVISIONS SHALL BE INTERPRETED TO BE THE LATEST STANDARD OF THE ILLINOIS DEPARTMENT OF TRANSPORTATION AS SHOWN ON THE INDEX OF SHEETS IN THE PLANS. ALL CONSTRUCTION SHALL BE DONE IN ACCORDANCE WITH THE STANDARD SPECIFICATIONS FOR ROAD AND BRIDGE CONSTRUCTION ADOPTED JANUARY 1, 2007, THE "SUPPLEMENTAL SPECIFICATIONS AND RECURRING SPECIAL PROVISIONS" ADOPTED JANUARY 1, 2008, THE LATEST EDITION OF THE "ILLINOIS MANUAL ON UNIFORM TRAFFIC CONTROL DEVICES FOR STREETS AND HIGHWAYS," "THE STANDARD SPECIFICATIONS FOR WATER AND SEWER MAIN CONSTRUCTION IN ILLINOIS" MAY 1996 FIFTH EDITION, AND THE "DETAILS" IN THE PLANS AND THE "SPECIAL PROVISIONS" INCLUDED IN THE CONTRACT DOCUMENTS.

UNDERGROUND UTILITIES

BEFORE STARTING ANY EXCAVATION, THE CONTRACTOR SHALL CALL "JULIE" AT 811 FOR FIELD LOCATIONS OF BURIED ELECTRICAL, TELEPHONE AND GAS FACILITIES. (48 HOURS NOTIFICATION IS REQUIRED).

THE LOCATIONS OF THE UNDERGROUND UTILITIES IF SHOWN ON THE PLANS HAVE BEEN OBTAINED BY FIELD SURVEYS AND SEARCHES OF AVAILABLE RECORDS. IT IS BELIEVED THAT DATA IS ESSENTIALLY CORRECT, BUT THE VILLAGE OF BROOKFIELD, THE ILLINOIS DEPARTMENT OF TRANSPORTATION AND/OR OTHER OFFICES AND AGENCIES ASSOCIATED WITH THE DEVELOPMENT OF THESE PLANS DO NOT GUARANTEE THEIR ACCURACY OR COMPLETENESS. THE CONTRACTOR WILL BE REQUIRED TO VERIFY THE EXACT LOCATION OF EACH FACILITY WITH THE UTILITY COMPANY, AND SHALL TAKE DUE CARE IN ALL PHASES OF THE CONSTRUCTION TO PROTECT ANY SUCH FACILITIES WHICH MAY BE AFFECTED BY THE WORK. ANY DAMAGE TO EXISTING UTILITIES SHALL BE REPAIRED AT THE CONTRACTOR'S EXPENSE.

THE CONTRACTOR SHALL COORDINATE CONSTRUCTION ACTIVITIES WITH UTILITY COMPANIES AND THE VILLAGE OF SCHILLER PARK.

MAINTENANCE OF SEWER FLOWS

THE CONTRACTOR SHALL CONDUCT HIS OPERATIONS AS TO MAINTAIN AT ALL TIMES FLOW THROUGH EXISTING STORM AND SANITARY SEWER SYSTEMS. HE SHALL ALSO PROVIDE AND MAINTAIN AN EFFICIENT PUMPING PLANT IF NECESSARY AND A TEMPORARY OUTLET AND BE PREPARED AT ALL TIMES TO DISPOSE OF THE WATER COLLECTED IN A SAFE MANNER WITHOUT DAMAGE OF ANY KIND TO ADJACENT PROPERTIES. THE ENDS OF EXISTING DRAINAGE LINES WHICH ARE NOT TO BE INCORPORATED INTO THE PROJECT ARE TO BE SEALED AS SPECIFIED IN THE SPECIAL PROVISIONS. EXISTING STRUCTURES ARE TO BE INSPECTED BEFORE CONSTRUCTION STARTS - ANY ACCUMULATION OF MATERIAL IN THE STRUCTURE DUE TO CONSTRUCTION OPERATIONS SHALL BE REMOVED BY THE CONTRACTOR AT HIS EXPENSE.

MAINTENANCE OF EXISTING DRAINAGE STRUCTURES

WHEN DURING THE CONSTRUCTION OPERATIONS, ANY LOOSE MATERIAL IS DEPOSITED IN THE FLOW LINE OF ANY GUTTERS AND DRAINAGE STRUCTURE SO THAT THE NATURAL FLOW OF WATER IS OBSTRUCTED, IT SHALL BE REMOVED AT THE CLOSE OF EACH WORKING DAY. AT THE CONCLUSION OF THE CONSTRUCTION OPERATIONS, ALL DRAINAGE FACILITIES SHALL BE CLEAN AND FREE OF ALL OBSTRUCTIONS DUE TO CONSTRUCTION OPERATIONS. THE COST OF THIS WORK SHALL BE INCIDENTAL TO THE CONTRACT.

SAW CUTTING

THE CONTRACTOR SHALL SAW CUT ASPHALT PAVEMENT AND DRIVEWAY PAVEMENT AS INDICATED ON THE PLANS TO SEPARATE THE EXISTING PAVEMENT TO BE REMOVED BY APPROVED MEANS OR AN APPROVED CONCRETE SAW TO A DEPTH AS DIRECTED BY THE ENGINEER. SUITABLE GUIDELINES OR DEVICES SHALL BE USED TO ASSURE CUTTING A NEAT, STRAIGHT LINE AS SHOWN ON THE PLANS. CARE SHALL BE TAKEN BY THE CONTRACTOR AS NOT TO DAMAGE THE REMAINING PAVEMENT DIRECTLY ADJACENT TO THE PAVEMENT TO BE REMOVED. ANY DAMAGE TO THE EXISTING PAVEMENT RESULTING FROM PAVEMENT REMOVAL OPERATIONS SHALL BE REPAIRED AT THE CONTRACTOR'S EXPENSE. THE COST OF SAW CUTTING DESCRIBED ABOVE SHALL BE INCLUDED IN THE ITEM BEING REMOVED. SAW CUTS FOR PAVEMENT PATCHING WILL BE PAID FOR IN THE CONTRACT.

PAVEMENT PATCHING

LOCATIONS OF CLASS B PATCHES ON PLANS ARE APPROXIMATE. EXACT LOCATIONS WILL BE DETERMINED IN THE FIELD BY THE ENGINEER.

FIELD OFFICE

THE CONTRACTOR WILL NOT BE ALLOWED TO SET UP A YARD OR FIELD OFFICE ON STATE OR VILLAGE PROPERTY WITHOUT WRITTEN PERMISSION FROM THE DEPARTMENT OR THE VILLAGE.

BARRICADES

THE CONTRACTOR SHALL PROVIDE AND INSTALL TWO (2) WEIGHTED SANDBAGS ON EACH TYPE I OR TYPE II BARRICADE USED, ONE (1) WEIGHTED SANBAG ACROSS EACH BOTTOM RAIL.

CURB AND GUTTER

LOCATION OF COMBINATION CONCRETE CURB AND GUTTER REMOVAL AND COMBINATION CONCRETE CURB AND GUTTER (THE TYPE SPECIFIED ON THE PLANS), WILL BE DETERMINED IN THE FIELD BY THE ENGINEER.

ACCESS

THE CONTRACTOR SHALL BE REQUIRED TO PROVIDE ACCESS TO ABUTTING PROPERTY AT ALL TIMES DURING THE CONSTRUCTION OF THIS PROJECT.

LEGEND OF SYMBOLS

(TO BE USED IN CONJUNCTION WITH I.D.O.T. STANDARD 000001-05)

SYMBOL	DESCRIPTION
	EXISTING HOT-MIX ASPHALT CONCRETE AREA
	EXISTING CONCRETE AREA
	PROPOSED PCC BUTT JOINT
	PROPOSED HOT-MIX ASPHALT BUTT JOINT
	HOT-MIX ASPHALT SURFACE REMOVAL
	PORTLAND CEMENT CONCRETE SURFACE REMOVAL
	CONCRETE SIDEWALK AND DRIVEWAY REMOVAL
	PROPOSED CONCRETE AREA, 5" SIDEWALK, 7" DRIVEWAY
	PROPOSED HOT-MIX ASPHALT PAVING AREA
A	STRUCTURE TO BE ADJUSTED
	EXISTING HANDHOLE
	PROPOSED HANDHOLE
"E" H	EXISTING HEAVY DUTY HANDHOLE
H	PROPOSED HEAVY DUTY HANDHOLE
	TRAFFIC SIGNAL CONTROLLER
	DOUBLE HANDHOLE
	EXISTING WATER VALVE BOX
	EXISTING WATER SERVICE BOX
	EXISTING CURB AND GUTTER
	PROPOSED CURB & GUTTER REMOVAL
	PROPOSED COMBINATION CONCRETE CURB & GUTTER B-6.24 (UNLESS NOTED ON PLANS)

I.D.O.T. STANDARD DRAWINGS

STANDARD NO.	TITLE OR DESCRIPTION
000001-05	STANDARD SYMBOLS, ABBREVIATIONS AND PATTERNS
424001-05	CURB RAMPS FOR SIDEWALKS
442101-07	CLASS B PATCHES
701501-04	URBAN LANE CLOSURE, 2-LANE, 2-WAY, UNDIVIDED
701606-05	URBAN LANE CLOSURE, MULTILANE, 2-WAY WITH MOUNTABLE MEDIAN
701701-05	URBAN LANE CLOSURE, MULTILANE INTERSECTION
701801-03	LANE CLOSURE, MULTILANE, 1W OR 2W CROSSWALK OR SIDEWALK CLOSURE
701901	TRAFFIC CONTROL DEVICES
886006	TYPICAL LAYOUT FOR DETECTION LOOPS

REVISION	DATE	BY

SCHILLER PARK
25th AVENUE IMPROVEMENT

INDEX OF SHEETS, LEGEND OF SYMBOLS, GENERAL NOTES, & I.D.O.T. STANDARD DRAWINGS

DRAWN BY: LEV, DMM, MK
CHECKED BY: BP
DATE: 7/23/2008

SCALE: NOT TO SCALE

E.H.E. PROJECT NO.: 800-08-06201

HANCOCK ENGINEERING ♦ Civil Engineers ♦ Municipal Consultants ♦ Established 1911

9933 Roosevelt Road
Westchester, Illinois 60154-2780
Phone: 708/865-0300
Fax: 708/865-1212

SUMMARY OF QUANTITIES				
CODE	PAY ITEM	UNIT	TOTAL QUANTITY	J000 80% Federal 20% Local
20101200	TREE ROOT PRUNING	EACH	20	20
20200410	EARTH EXCAVATION (SPECIAL)	CUYD	725	725
21101610	TOPSOIL FURNISH AND PLACE, 3"	SQYD	1,000	1,000
25000400	NITROGEN FERTILIZER NUTRIENT	POUND	18	18
25000500	PHOSPHORUS FERTILIZER NUTRIENT	POUND	18	18
25000600	POTASSIUM FERTILIZER NUTRIENT	POUND	18	18
25200110	SODDING, SALT TOLERANT	SQYD	1,000	1,000
25200200	SUPPLEMENTAL WATERING	UNIT	50	50
40201000	AGGREGATE FOR TEMPORARY ACCESS	TON	100	100
42101300	PROTECTIVE COAT	SQYD	10,100	10,100
42300300	PORTLAND CEMENT CONCRETE DRIVEWAY PAVEMENT, 7 INCH	SQYD	600	600
42300400	PORTLAND CEMENT CONCRETE DRIVEWAY PAVEMENT, 8 INCH	SQYD	1,000	1,000
42400200	PORTLAND CEMENT CONCRETE SIDEWALK, 5 INCH	SQFT	31,000	31,000
42400800	DETECTABLE WARNINGS	SQFT	100	100
44000200	DRIVEWAY PAVEMENT REMOVAL	SQYD	1,600	1,600
44000600	SIDEWALK REMOVAL	SQFT	600	600
44001700	COMBINATION CURB AND GUTTER REMOVAL AND REPLACEMENT	FOOT	2,500	2,500
44200970	CLASS B PATCHES, TYPE II, 10 INCH	SQYD	3,700	3,700
44200974	CLASS B PATCHES, TYPE III, 10 INCH	SQYD	100	100
44200976	CLASS B PATCHES, TYPE IV, 10 INCH	SQYD	100	100
44213200	SAW CUTS	FOOT	23,600	23,600
56500600	DOMESTIC WATER SERVICE BOXES TO BE ADJUSTED	EACH	1	1
60300305	FRAMES AND LIDS TO BE ADJUSTED	EACH	25	25
67100100	MOBILIZATION	L SUM	1	1
70101700	TRAFFIC CONTROL AND PROTECTION	L SUM	1	1
* 78001100	PAINT PAVEMENT MARKING - LETTERS AND SYMBOLS	SQFT	175	175
* 78001110	PAINT PAVEMENT MARKING - LINE 4"	FOOT	19,000	19,000
* 78001130	PAINT PAVEMENT MARKING - LINE 6"	FOOT	1,100	1,100
* 78001150	PAINT PAVEMENT MARKING - LINE 12"	FOOT	500	500
* 78001180	PAINT PAVEMENT MARKING - LINE 24"	FOOT	500	500
* 88600600	DETECTOR LOOP REPLACEMENT	FOOT	100	100
X0322256	TEMPORARY INFORMATION SIGNING	SQFT	50	50
Z0017202	DOWEL BARS 1 1/2"	EACH	5,200	5,200
Z0075310	TIE BARS 3/4"	EACH	35	35

* DENOTE SPECIALTY ITEMS



◆ Civil Engineers
◆ Municipal Consultants
◆ Established 1911

9933 Roosevelt Road
Westchester, Illinois 60154-2780
Phone: 708/865-0300
Fax: 708/865-1212

REVISION:	

**SCHILLER PARK
25th AVENUE IMPROVEMENT
SUMMARY OF QUANTITIES**

NONE

DRAWN BY: LEV, DMM, MK
CHECKED BY: BP
DATE: 7/23/2008

SCALE: NOT TO SCALE

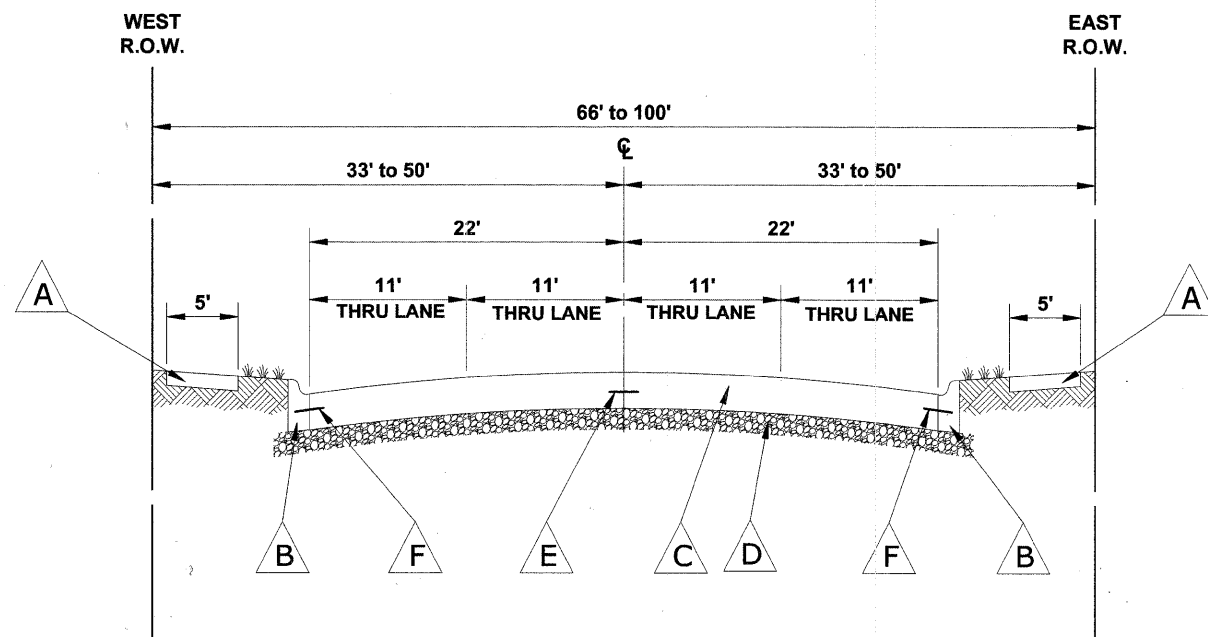

EXISTING TYPICAL CROSS SECTION

25th AVENUE
(STATION 26+60 TO STATION 106+75)

EXISTING LEGEND OF SYMBOLS

SYMBOL	DESCRIPTION
A	EXISTING INTERMITTENT PORTLAND CEMENT CONCRETE SIDEWALK, 5"
B	EXISTING COMBINATION CONCRETE CURB & GUTTER, TYPE B-6.18 OR AS NOTED
C	EXISTING PORTLAND CEMENT CONCRETE PAVEMENT, 10"
D	EXISTING SUB-BASE GRANULAR MATERIAL, 4"
E	EXISTING #5 TIE BARS SPACED 2'-6" O.C.
F	EXISTING #5 TIE BARS SPACED 2'-6" O.C.

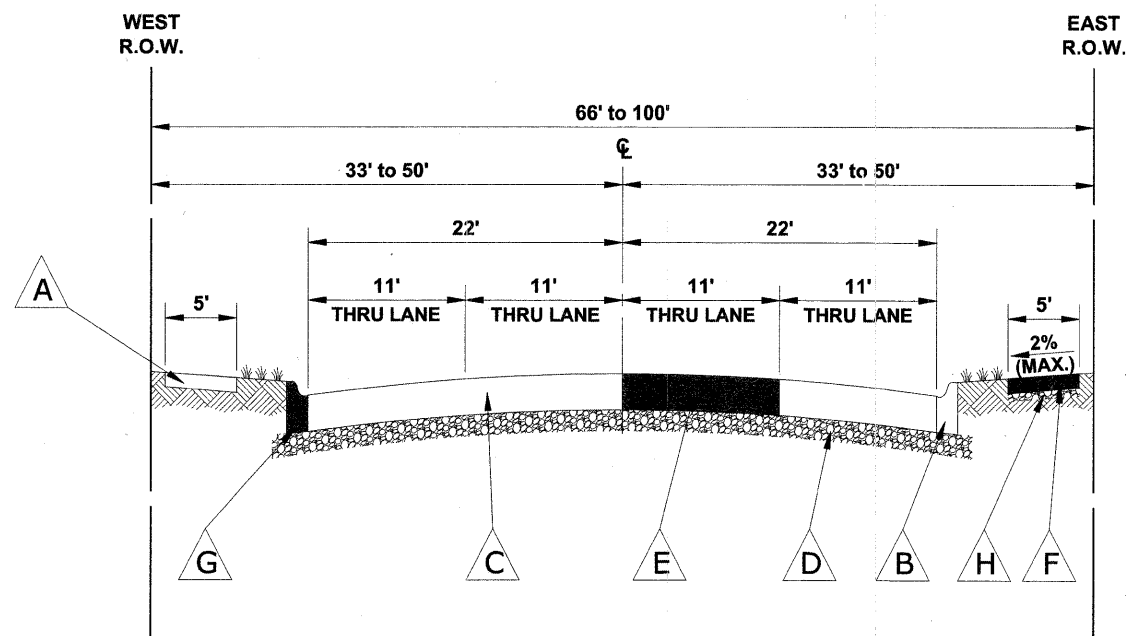

PROPOSED TYPICAL CROSS SECTION

25th AVENUE
(STATION 26+60 TO STATION 106+75)

PROPOSED LEGEND OF SYMBOLS

SYMBOL	DESCRIPTION
A	EXISTING INTERMITTENT PORTLAND CEMENT CONCRETE SIDEWALK, 5"
B	EXISTING COMBINATION CONCRETE CURB & GUTTER, TYPE B-6.18 OR AS NOTED
C	EXISTING PORTLAND CEMENT CONCRETE PAVEMENT, 10"
D	EXISTING SUB-BASE GRANULAR MATERIAL, 4"
E	CLASS B PATCH, 10"
F	PROPOSED INTERMITTENT PORTLAND CEMENT CONCRETE SIDEWALK, 5", WITH EARTH EXCAVATION (SPECIAL)
G	PROPOSED INTERMITTENT COMBINATION CONCRETE CURB & GUTTER REMOVAL & REPLACEMENT
H	AGGREGATE BASE COURSE, TYPE B, 2" (COST INCLUDED IN PORTLAND CEMENT CONCRETE SIDEWALK, 5")

REVISION:	

SCHILLER PARK
25th AVENUE IMPROVEMENT
EXISTING & PROPOSED TYPICAL
CROSS SECTIONS

SCALE: NOT TO SCALE

DRAWN BY: LEV, DMM, MK
CHECKED BY: BP
DATE: 7/23/2008

E.H.E. PROJECT NO.: 800-08-06201



◆ Civil Engineers
◆ Municipal Consultants
◆ Established 1911

9933 Roosevelt Road
Westchester, Illinois 60154-2780
Phone: 708/865-0300
Fax: 708/865-1212

SCHEDULE OF PAVEMENT PATCHING						
STA	LENGTH	WIDTH	CURB LANE		INSIDE LANE	
			AREA	TYPE	AREA	TYPE
26+75	6'	11'	7.3	TYPE II		
27+20	6'	11'	7.3	TYPE II	7.3	TYPE II
27+35	6'	11'	7.3	TYPE II	7.3	TYPE II
27+65	6'	11'	7.3	TYPE II	7.3	TYPE II
27+80	6'	11'	7.3	TYPE II	7.3	TYPE II
28+25	6'	11'	7.3	TYPE II	7.3	TYPE II
28+47	6'	11'	7.3	TYPE II	7.3	TYPE II
28+70	6'	11'	7.3	TYPE II	7.3	TYPE II
29+20	6'	11'	7.3	TYPE II	7.3	TYPE II
29+65	6'	11'	7.3	TYPE II	7.3	TYPE II
30+10	6'	11'	7.3	TYPE II	7.3	TYPE II
30+33	6'	11'	7.3	TYPE II	7.3	TYPE II
30+60	6'	11'	7.3	TYPE II	7.3	TYPE II
30+70	6'	11'	7.3	TYPE II	7.3	TYPE II
31+15	6'	11'	7.3	TYPE II	7.3	TYPE II
31+70	6'	11'	7.3	TYPE II	7.3	TYPE II
32+20	6'	11'	7.3	TYPE II	7.3	TYPE II
32+35	6'	11'	7.3	TYPE II	7.3	TYPE II
32+90	6'	11'	7.3	TYPE II	7.3	TYPE II
33+15	6'	11'	7.3	TYPE II	7.3	TYPE II
33+30	6'	11'	7.3	TYPE II	7.3	TYPE II
33+77	6'	11'	7.3	TYPE II	7.3	TYPE II
34+10	6'	11'	7.3	TYPE II		
34+50	6'	11'	7.3	TYPE II	7.3	TYPE II
35+15	6'	11'	7.3	TYPE II	7.3	TYPE II
35+45	6'	11'	7.3	TYPE II		
36+05	6'	11'	7.3	TYPE II	7.3	TYPE II
36+50	6'	11'	7.3	TYPE II	7.3	TYPE II
36+65	6'	11'	7.3	TYPE II	7.3	TYPE II
37+20	6'	11'	7.3	TYPE II	7.3	TYPE II
37+30	6'	11'	7.3	TYPE II		
37+45	6'	11'	7.3	TYPE II		
37+60	6'	11'	7.3	TYPE II	7.3	TYPE II
38+20	6'	11'	7.3	TYPE II		
38+30	6'	11'	7.3	TYPE II	7.3	TYPE II
39+00	6'	11'	7.3	TYPE II	7.3	TYPE II
39+20	6'	11'	7.3	TYPE II	7.3	TYPE II
39+60	6'	11'	7.3	TYPE II	7.3	TYPE II
39+90	6'	11'	7.3	TYPE II	7.3	TYPE II
40+00	6'	11'	7.3	TYPE II	7.3	TYPE II
40+40	6'	11'	7.3	TYPE II	7.3	TYPE II
40+75	6'	11'	7.3	TYPE II	7.3	TYPE II

SCHEDULE OF PAVEMENT PATCHING						
STA	LENGTH	WIDTH	CURB LANE		INSIDE LANE	
			AREA	TYPE	AREA	TYPE
41+00	31'	11'	37.9	TYPE IV		
41+25	6'	11'			7.3	TYPE II
41+75	6'	11'	7.3	TYPE II	7.3	TYPE II
42+80	6'	11'	7.3	TYPE II	7.3	TYPE II
43+10	6'	11'	7.3	TYPE II	7.3	TYPE II
43+60	6'	11'	7.3	TYPE II	7.3	TYPE II
44+25	6'	11'	7.3	TYPE II	7.3	TYPE II
45+20	6'	11'	7.3	TYPE II	7.3	TYPE II
46+25	6'	11'	7.3	TYPE II	7.3	TYPE II
47+15	6'	11'	7.3	TYPE II	7.3	TYPE II
47+75	6'	11'	7.3	TYPE II	7.3	TYPE II
48+90	6'	11'	7.3	TYPE II	7.3	TYPE II
49+15	6'	11'	7.3	TYPE II	7.3	TYPE II
50+00	6'	11'	7.3	TYPE II	7.3	TYPE II
50+50	6'	11'	7.3	TYPE II	7.3	TYPE II
51+00	6'	11'	7.3	TYPE II	7.3	TYPE II
51+50	6'	11'	7.3	TYPE II	7.3	TYPE II
51+65	6'	11'	7.3	TYPE II	7.3	TYPE II
51+80	6'	11'	7.3	TYPE II	7.3	TYPE II
52+00	6'	11'	7.3	TYPE II	7.3	TYPE II
52+40	6'	11'	7.3	TYPE II	7.3	TYPE II
52+60	6'	11'	7.3	TYPE II	7.3	TYPE II
52+80	6'	11'	7.3	TYPE II	7.3	TYPE II
53+75	15'	11'	18.3	TYPE III		
54+20	15'	11'	18.3	TYPE III		
54+45	15'	11'	18.3	TYPE III		
54+90	15'	11'	18.3	TYPE III		
55+40	6'	11'			7.3	TYPE II
55+85	6'	11'	7.3	TYPE II	7.3	TYPE II
56+40	6'	11'	7.3	TYPE II	7.3	TYPE II
56+90	6'	11'			7.3	TYPE II
57+25	6'	11'	7.3	TYPE II	7.3	TYPE II
58+33	6'	11'	7.3	TYPE II	7.3	TYPE II
58+75	6'	11'	7.3	TYPE II	7.3	TYPE II
59+45	6'	11'	7.3	TYPE II	7.3	TYPE II
60+35	6'	11'	7.3	TYPE II	7.3	TYPE II
60+95	6'	11'	7.3	TYPE II	7.3	TYPE II
66+90	6'	11'	7.3	TYPE II	7.3	TYPE II
70+70	6'	11'	7.3	TYPE II	7.3	TYPE II
72+90	6'	11'	7.3	TYPE II	7.3	TYPE II
80+15	6'	11'	7.3	TYPE II	7.3	TYPE II
83+25	6'	11'	7.3	TYPE II	7.3	TYPE II

SCHEDULE OF PAVEMENT PATCHING						
STA	LENGTH	WIDTH	CURB LANE		INSIDE LANE	
			AREA	TYPE	AREA	TYPE
84+60	6'	11'	7.3	TYPE II	7.3	TYPE II
84+75	6'	11'	7.3	TYPE II	7.3	TYPE II
85+15	6'	11'	7.3	TYPE II	7.3	TYPE II
86+25	6'	11'	7.3	TYPE II	7.3	TYPE II
86+70	6'	11'	7.3	TYPE II	7.3	TYPE II
86+70	6'	11'	7.3	TYPE II	7.3	TYPE II
87+10	6'	11'	7.3	TYPE II	7.3	TYPE II
88+15	6'	11'	7.3	TYPE II	7.3	TYPE II
89+30	6'	11'	7.3	TYPE II	7.3	TYPE II
89+75	6'	11'	7.3	TYPE II	7.3	TYPE II
90+30	6'	11'	7.3	TYPE II	7.3	TYPE II
90+70	6'	11'	7.3	TYPE II	7.3	TYPE II
91+20	6'	11'	7.3	TYPE II	7.3	TYPE II
91+65	6'	11'	7.3	TYPE II	7.3	TYPE II
91+85	32'	11'			39.1	TYPE IV
91+85	6'	11'	7.3	TYPE II		
92+25	6'	11'			7.3	TYPE II
92+25	6'	11'	7.3	TYPE II		
92+80	6'	11'	7.3	TYPE II	7.3	TYPE II
93+35	6'	11'	7.3	TYPE II	7.3	TYPE II
93+75	6'	11'	7.3	TYPE II	7.3	TYPE II
94+00	6'	11'	7.3	TYPE II	7.3	TYPE II
94+75	6'	11'	7.3	TYPE II	7.3	TYPE II
94+90	6'	11'	7.3	TYPE II	7.3	TYPE II
95+00	6'	11'	7.3	TYPE II	7.3	TYPE II
95+20	6'	11'	7.3	TYPE II	7.3	TYPE II
95+80	6'	11'	7.3	TYPE II	7.3	TYPE II
96+30	6'	11'	7.3	TYPE II	7.3	TYPE II
96+80	6'	11'	7.3	TYPE II	7.3	TYPE II
97+30	6'	11'	7.3	TYPE II	7.3	TYPE II
97+90	6'	11'	7.3	TYPE II	7.3	TYPE II
98+05	6'	11'	7.3	TYPE II	7.3	TYPE II
98+55	6'	11'	7.3	TYPE II	7.3	TYPE II
99+40	6'	11'	7.3	TYPE II	7.3	TYPE II
99+90	6'	11'	7.3	TYPE II	7.3	TYPE II
100+25	6'	11'	7.3	TYPE II	7.3	TYPE II
100+55	6'	11'	7.3	TYPE II	7.3	TYPE II
101+15	6'	11'	7.3	TYPE II	7.3	TYPE II
101+40	6'	11'	7.3	TYPE II	7.3	TYPE II
101+55	6'	11'	7.3	TYPE II	7.3	TYPE II
102+00	6'	11'	7.3	TYPE II	7.3	TYPE II
102+90	6'	11'	7.3	TYPE II	7.3	TYPE II
103+10	6'	11'	7.3	TYPE II	7.3	TYPE II
103+30	6'	11'	7.3	TYPE II	7.3	TYPE II
104+00	6'	11'	7.3	TYPE II	7.3	TYPE II
105+70	6'	11'	7.3	TYPE II	7.3	TYPE II
106+60	6'	11'	7.3	TYPE II	7.3	TYPE II

Drawing file: W:\Projects\80000002 - 25th Ave Improvement\SCHEDULES.dwg Jul 23, 2008 - 4:22pm

REVISION:	

**SCHILLER PARK
25th AVENUE IMPROVEMENT
PAVEMENT PATCHING
SCHEDULES**

DRAWN BY: LEV, DMM, MK
CHECKED BY: BP
DATE: 7/23/2008

SCALE: NOT TO SCALE

E.H.E. PROJECT NO.: 800-08-06201

HANCOCK ENGINEERING ♦ Civil Engineers ♦ Established 1911
♦ Municipal Consultants ♦
9933 Roosevelt Road
Westchester, Illinois 60154-2789
Phone: 708/865-0300
Fax: 708/865-1212

SCHEDULE OF PAVEMENT PATCHING						
STA	LENGTH	WIDTH	CURB LANE S. BOUND		INSIDE LANE S. BOUND	
			AREA	TYPE	AREA	TYPE
26+75	6'	11'	7.3	TYPE II		
27+20	6'	11'	7.3	TYPE II	7.3	TYPE II
27+35	6'	11'	7.3	TYPE II	7.3	TYPE II
27+65	6'	11'	7.3	TYPE II	7.3	TYPE II
27+80	6'	11'	7.3	TYPE II	7.3	TYPE II
28+25	6'	11'	7.3	TYPE II	7.3	TYPE II
28+47	6'	11'	7.3	TYPE II	7.3	TYPE II
28+70	6'	11'	7.3	TYPE II	7.3	TYPE II
29+20	6'	11'	7.3	TYPE II	7.3	TYPE II
29+35	6'	11'	7.3	TYPE II	7.3	TYPE II
29+65	6'	11'	7.3	TYPE II	7.3	TYPE II
30+13	6'	11'	7.3	TYPE II	7.3	TYPE II
30+33	6'	11'	7.3	TYPE II	7.3	TYPE II
30+60	6'	11'	7.3	TYPE II	7.3	TYPE II
30+70	6'	11'	7.3	TYPE II	7.3	TYPE II
31+00	6'	11'	7.3	TYPE II	7.3	TYPE II
31+15	6'	11'	7.3	TYPE II	7.3	TYPE II
31+70	6'	11'	7.3	TYPE II	7.3	TYPE II
32+20	6'	11'	7.3	TYPE II	7.3	TYPE II
32+35	6'	11'	7.3	TYPE II	7.3	TYPE II
32+90	6'	11'	7.3	TYPE II	7.3	TYPE II
33+15	6'	11'	7.3	TYPE II	7.3	TYPE II
34+50	6'	11'	7.3	TYPE II	7.3	TYPE II
35+20	6'	11'	7.3	TYPE II	7.3	TYPE II
36+15	6'	11'	7.3	TYPE II	7.3	TYPE II
36+50	6'	11'	7.3	TYPE II	7.3	TYPE II
37+10	6'	11'	7.3	TYPE II	7.3	TYPE II
37+30	6'	11'	7.3	TYPE II	7.3	TYPE II
39+00	6'	11'	7.3	TYPE II	7.3	TYPE II
39+60	6'	11'	7.3	TYPE II	7.3	TYPE II
39+90	6'	11'	7.3	TYPE II	7.3	TYPE II
40+00	6'	11'			7.3	TYPE II
40+40	6'	11'	7.3	TYPE II	7.3	TYPE II
40+85	6'	11'	7.3	TYPE II	7.3	TYPE II
41+20	6'	11'	7.3	TYPE II	7.3	TYPE II
41+75	6'	11'	7.3	TYPE II	7.3	TYPE II
42+00	6'	11'	7.3	TYPE II	7.3	TYPE II
42+30	6'	11'	7.3	TYPE II	7.3	TYPE II

SCHEDULE OF PAVEMENT PATCHING						
STA	LENGTH	WIDTH	CURB LANE S. BOUND		INSIDE LANE S. BOUND	
			AREA	TYPE	AREA	TYPE
42+80	6'	11'	7.3	TYPE II	7.3	TYPE II
43+10	6'	11'	7.3	TYPE II	7.3	TYPE II
43+50	6'	11'	7.3	TYPE II	7.3	TYPE II
43+60	6'	11'	7.3	TYPE II	7.3	TYPE II
44+25	6'	11'	7.3	TYPE II	7.3	TYPE II
45+20	6'	11'	7.3	TYPE II	7.3	TYPE II
46+25	6'	11'	7.3	TYPE II	7.3	TYPE II
47+15	6'	11'	7.3	TYPE II	7.3	TYPE II
48+90	6'	11'	7.3	TYPE II		
49+15	6'	11'	7.3	TYPE II	7.3	TYPE II
50+00	6'	11'	7.3	TYPE II	7.3	TYPE II
50+50	6'	11'	7.3	TYPE II	7.3	TYPE II
51+00	6'	11'	7.3	TYPE II	7.3	TYPE II
51+50	6'	11'	7.3	TYPE II	7.3	TYPE II
51+65	6'	11'	7.3	TYPE II	7.3	TYPE II
51+80	6'	11'	7.3	TYPE II	7.3	TYPE II
52+40	6'	11'	7.3	TYPE II	7.3	TYPE II
52+60	6'	11'	7.3	TYPE II	7.3	TYPE II
55+85	6'	11'	7.3	TYPE II	7.3	TYPE II
56+40	6'	11'	7.3	TYPE II	7.3	TYPE II
56+90	6'	11'	7.3	TYPE II	7.3	TYPE II
57+25	6'	11'	7.3	TYPE II	7.3	TYPE II
58+25	6'	11'	7.3	TYPE II	7.3	TYPE II
58+33	6'	11'			7.3	TYPE II
58+75	6'	11'	7.3	TYPE II	7.3	TYPE II
59+45	6'	11'	7.3	TYPE II	7.3	TYPE II
60+35	6'	11'	7.3	TYPE II	7.3	TYPE II
60+95	6'	11'	7.3	TYPE II	7.3	TYPE II
61+80	6'	11'	7.3	TYPE II		
62+95	6'	11'	7.3	TYPE II	7.3	TYPE II
66+90	6'	11'	7.3	TYPE II	7.3	TYPE II
70+70	6'	11'	7.3	TYPE II	7.3	TYPE II
72+90	6'	11'	7.3	TYPE II	7.3	TYPE II
76+80	6'	11'	7.3	TYPE II	7.3	TYPE II
83+25	6'	11'	7.3	TYPE II		
84+60	6'	11'			7.3	TYPE II
84+80	6'	11'	7.3	TYPE II	7.3	TYPE II
85+15	6'	11'			7.3	TYPE II
86+25	6'	11'	7.3	TYPE II	7.3	TYPE II
86+70	6'	11'	7.3	TYPE II	7.3	TYPE II
87+10	6'	11'	7.3	TYPE II	7.3	TYPE II
88+15	6'	11'	7.3	TYPE II	7.3	TYPE II
88+25	6'	11'	7.3	TYPE II	7.3	TYPE II

SCHEDULE OF PAVEMENT PATCHING						
STA	LENGTH	WIDTH	CURB LANE S. BOUND		INSIDE LANE S. BOUND	
			AREA	TYPE	AREA	TYPE
89+30	6'	11'	7.3	TYPE II	7.3	TYPE II
89+75	6'	11'	7.3	TYPE II	7.3	TYPE II
90+30	6'	11'	7.3	TYPE II	7.3	TYPE II
90+70	6'	11'	7.3	TYPE II	7.3	TYPE II
90+80	6'	11'	7.3	TYPE II	7.3	TYPE II
91+20	6'	11'	7.3	TYPE II	7.3	TYPE II
91+65	6'	11'	7.3	TYPE II	7.3	TYPE II
92+25	6'	11'	7.3	TYPE II	7.3	TYPE II
92+80	6'	11'	7.3	TYPE II	7.3	TYPE II
93+35	6'	11'	7.3	TYPE II		
93+75	6'	11'	7.3	TYPE II	7.3	TYPE II
94+00	6'	11'	7.3	TYPE II	7.3	TYPE II
94+90	6'	11'	7.3	TYPE II	7.3	TYPE II
95+00	6'	11'	7.3	TYPE II	7.3	TYPE II
95+20	6'	11'	7.3	TYPE II	7.3	TYPE II
95+80	6'	11'	7.3	TYPE II	7.3	TYPE II
96+30	6'	11'	7.3	TYPE II	7.3	TYPE II
96+80	6'	11'	7.3	TYPE II	7.3	TYPE II
97+30	6'	11'	7.3	TYPE II	7.3	TYPE II
98+05	6'	11'	7.3	TYPE II	7.3	TYPE II
98+55	6'	11'	7.3	TYPE II	7.3	TYPE II
99+40	6'	11'	7.3	TYPE II	7.3	TYPE II
99+90	6'	11'	7.3	TYPE II	7.3	TYPE II
101+15	6'	11'	7.3	TYPE II	7.3	TYPE II
101+50	6'	11'	7.3	TYPE II	7.3	TYPE II
102+00	6'	11'	7.3	TYPE II	7.3	TYPE II
103+10	6'	11'	7.3	TYPE II	7.3	TYPE II
103+36	6'	11'	7.3	TYPE II	7.3	TYPE II
104+00	6'	11'	7.3	TYPE II	7.3	TYPE II
104+20	6'	11'	7.3	TYPE II	7.3	TYPE II
105+70	6'	11'	7.3	TYPE II	7.3	TYPE II
106+60	6'	11'	7.3	TYPE II	7.3	TYPE II

REVISION:	

**SCHILLER PARK
25th AVENUE IMPROVEMENT
PAVEMENT PATCHING
SCHEDULES**

DRAWN BY: LEV, DMM, MK
CHECKED BY: BP
DATE: 7/23/2008

SCALE: NOT TO SCALE

E.H.E. PROJECT NO.: 800-08-06201

ROUTE NO.	SECTION	COUNTY	TOTAL SHEETS	SHEET NO.
2714	07-00075-00-RP	COOK	16	7
ILLINOIS PROJECT		M-9003 (035)		
CONTRACT NO.		63070		

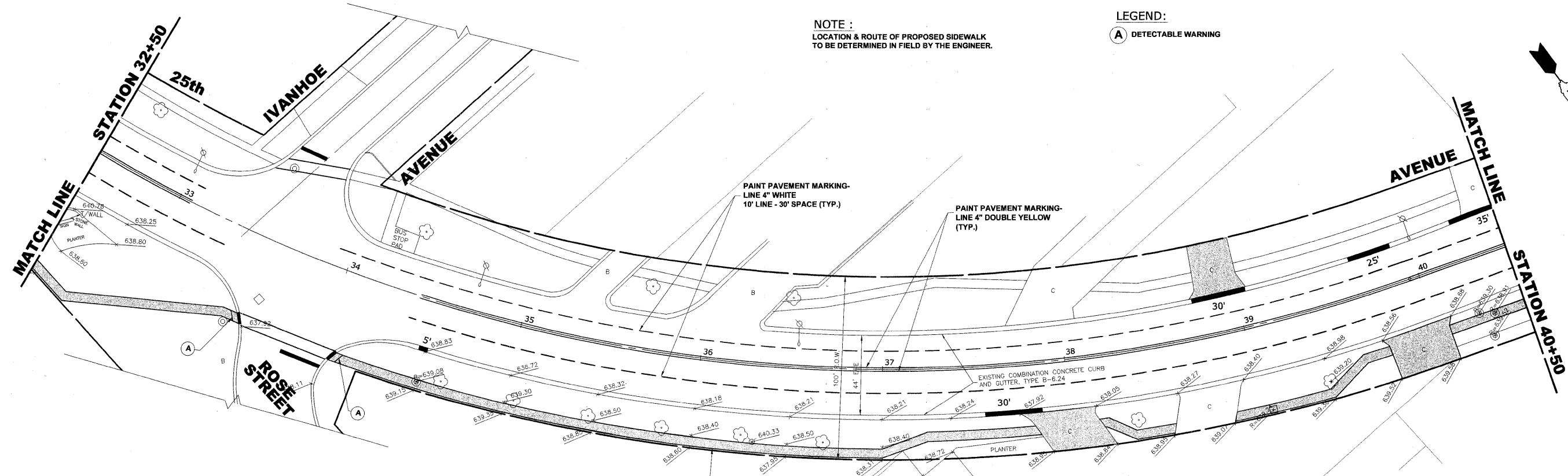
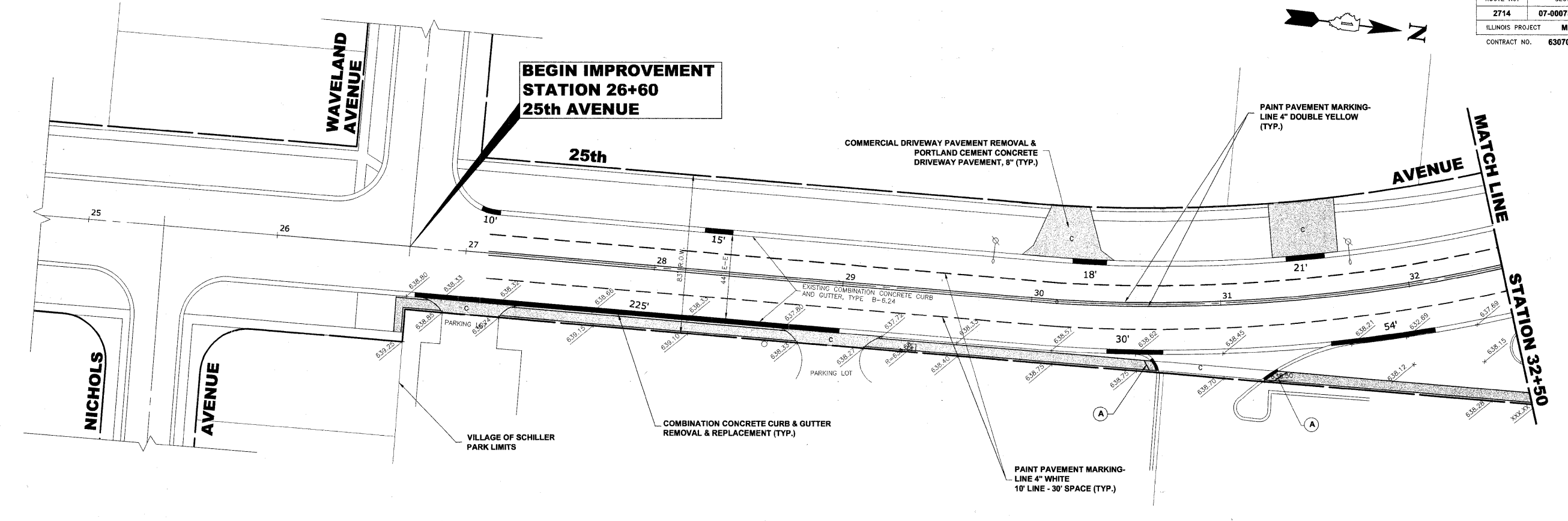

NOTE :
LOCATION & ROUTE OF PROPOSED SIDEWALK
TO BE DETERMINED IN FIELD BY THE ENGINEER.

LEGEND:
A DETECTABLE WARNING

Drawing file: W:\Projects\80008062 - 25th Ave Improvement\25th Avenue\25th Avenue.dwg Jul 23, 2008 - 4:50pm

HANCOCK ENGINEERING ♦ Civil Engineers ♦ Municipal Consultants ♦ Established 1911

9933 Roosevelt Road
Westchester, Illinois 60154-2780
Phone: 708-965-0300
Fax: 708-965-1212

REVISION:	

**SCHILLER PARK
25th AVENUE IMPROVEMENT
(WAVELAND AVENUE TO
LAWRENCE AVENUE)**

SCALE: 1"=30'

DRAWN BY: LEV, DMM, MK
CHECKED BY: BP
DATE: 7/23/2008

E.H.E. PROJECT NO.: 800-08-06201

ROUTE NO.	SECTION	COUNTY	TOTAL SHEETS	SHEET NO.
2714	07-0075-00-RP	COOK	16	8
ILLINOIS PROJECT		M-9003 (035)		
CONTRACT NO.		63070		

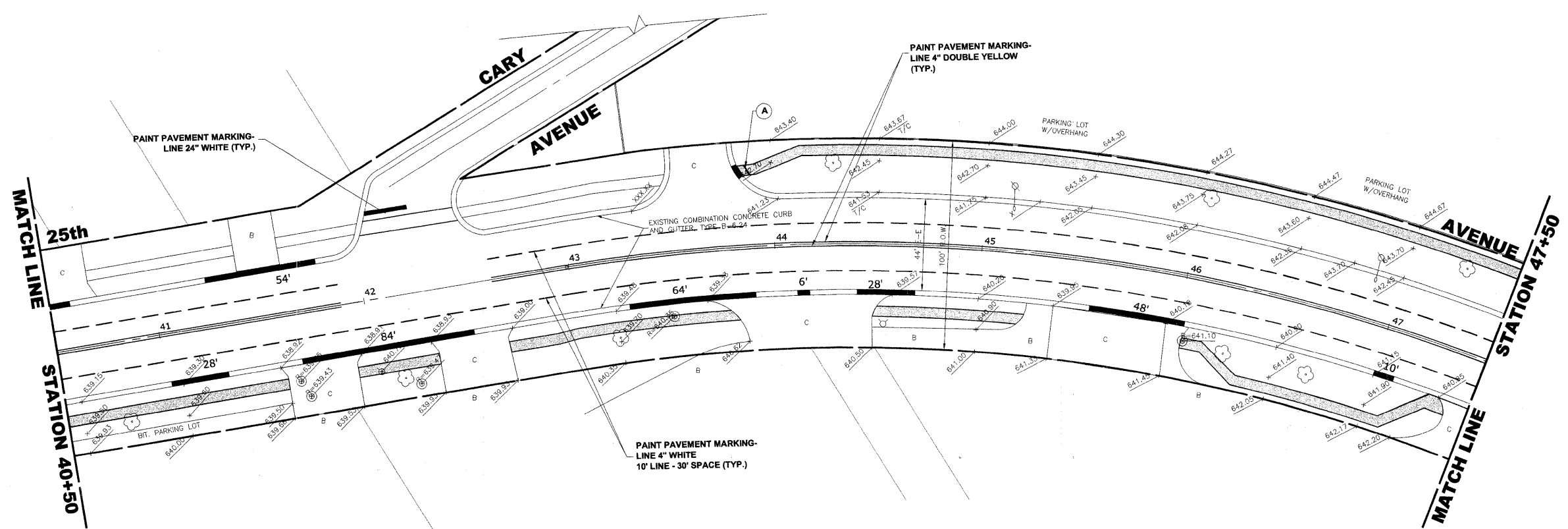

LEGEND:
 (A) DETECTABLE WARNING

NOTE:
 LOCATION & ROUTE OF PROPOSED SIDEWALK TO BE DETERMINED IN FIELD BY THE ENGINEER.

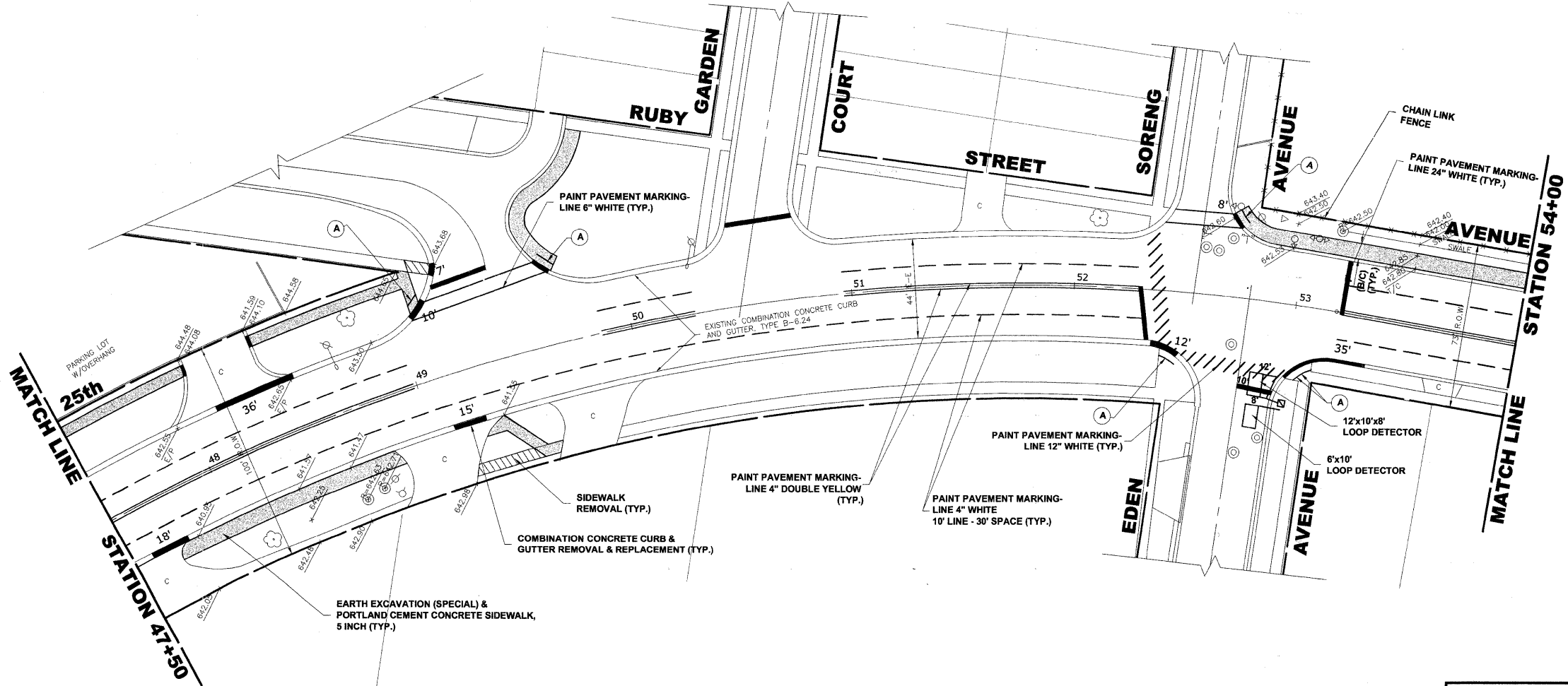

Drawing file: W:\Projects\90008092 - 25th Ave Improvement\25th Avenue\25th Avenue.dwg Jul 23, 2008 - 4:50pm

HANCOCK ENGINEERING

- ◆ Civil Engineers
- ◆ Municipal Consultants
- ◆ Established 1911

9933 Roosevelt Road
 Westchester, Illinois 60154-2780
 Phone: 708/965-0300
 Fax: 708/965-1212

REVISION	DATE	BY

SCHILLER PARK
25th AVENUE IMPROVEMENT
(WAVELAND AVENUE TO LAWRENCE AVENUE)

DRAWN BY: LEV, DMM, MK
 CHECKED BY: BP
 DATE: 7/23/2008

SCALE: 1"=30'

E.H.E. PROJECT NO.: 800-08-06201

ROUTE NO.	SECTION	COUNTY	TOTAL SHEETS	SHEET NO.
2714	07-00075-00-RP	COOK	16	9
ILLINOIS PROJECT		M-9003 (035)		
CONTRACT NO.		63070		

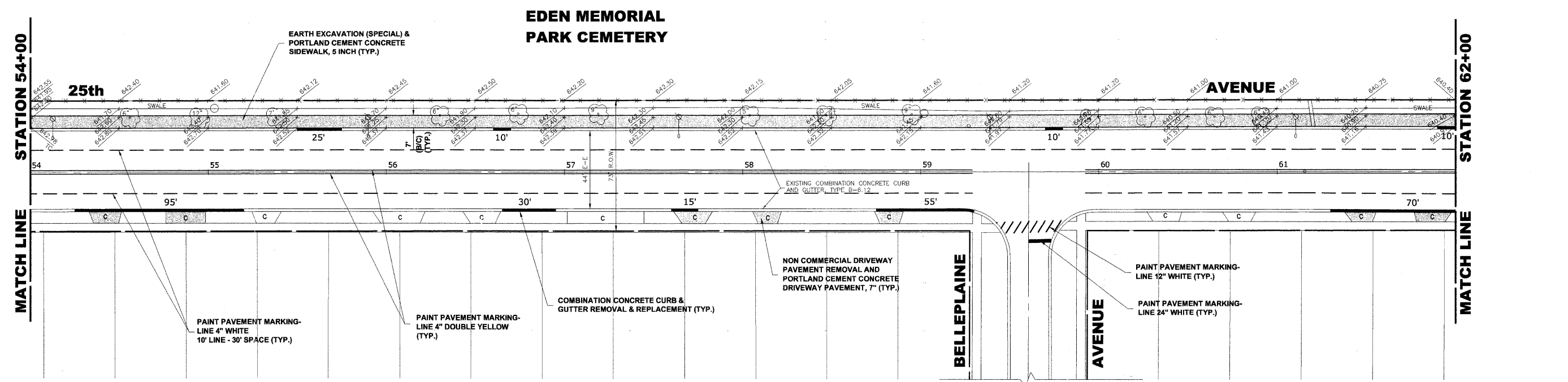

NOTE :
LOCATION & ROUTE OF PROPOSED SIDEWALK TO BE DETERMINED IN FIELD BY ENGINEER.

LEGEND:
A DETECTABLE WARNING

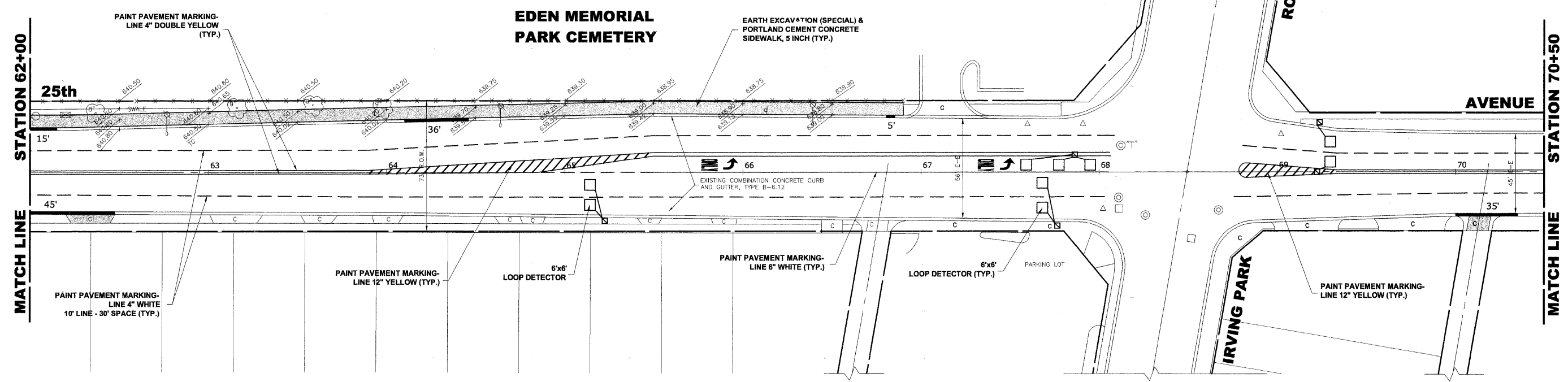
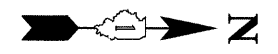

SCHILLER PARK
25th AVENUE IMPROVEMENT
(WAVELAND AVENUE TO LAWRENCE AVENUE)

REVISION

HANCOCK ENGINEERING ♦ Civil Engineers ♦ Municipal Consultants ♦ Established 1911

9933 Roosevelt Road
Westchester, Illinois 60154-2780
Phone: 708-965-0300
Fax: 708-965-1212

SCALE: 1"=30'

DRAWN BY: LEV, DMM, MK
CHECKED BY: BP
DATE: 7/23/2008

ROUTE NO.	SECTION	COUNTY	TOTAL SHEETS	SHEET NO.
2714	07-00075-00-RP	COOK	16	10
ILLINOIS PROJECT		M-9003 (035)		
CONTRACT NO.		63070		

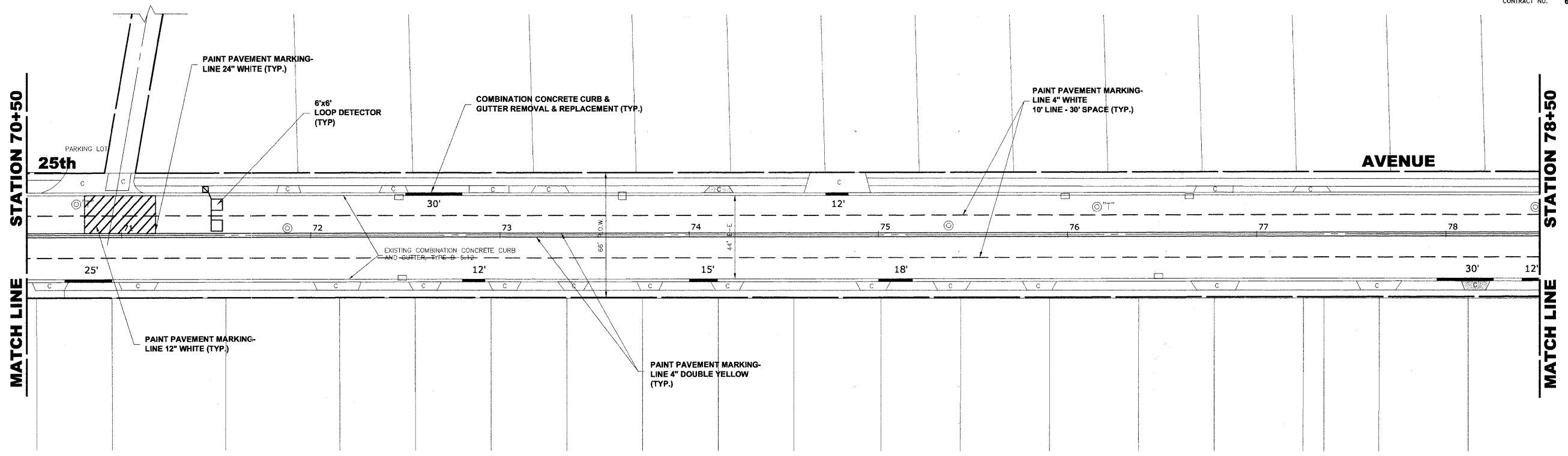

NOTE :
LOCATION & ROUTE OF PROPOSED SIDEWALK
TO BE DETERMINED IN FIELD BY ENGINEER.

LEGEND:
A DETECTABLE WARNING

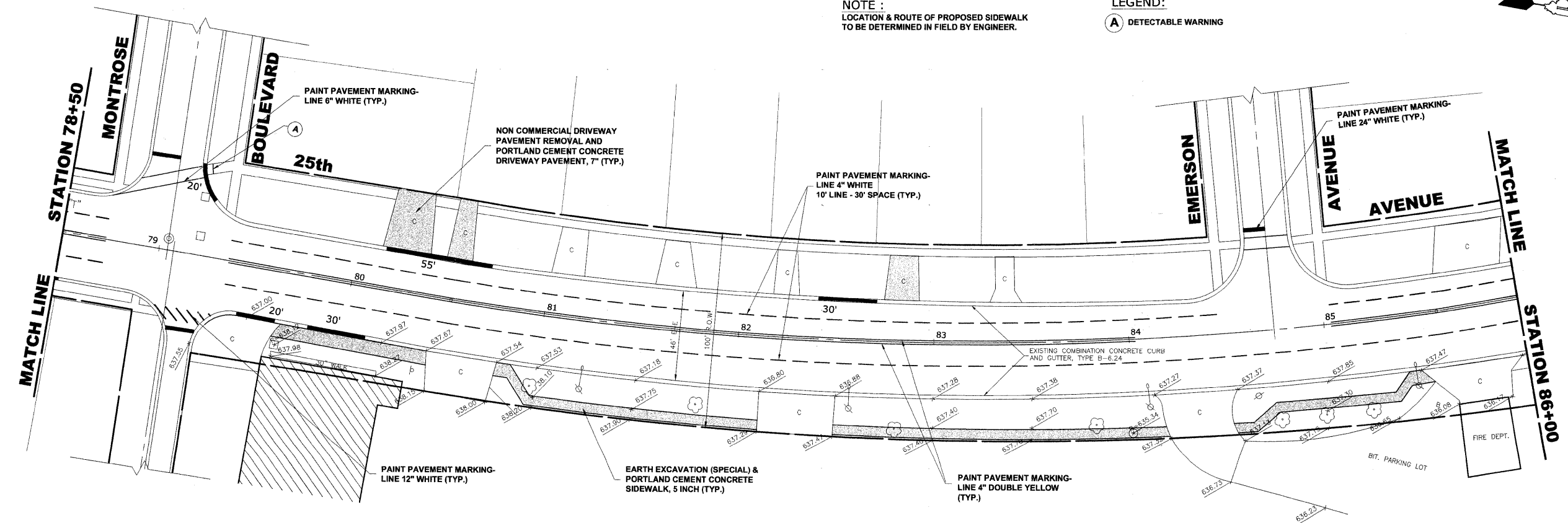

Drawing file: W:\Projects\80009062 - 25th Ave Improvement\25th Avenue\25th Avenue.dwg Jul 23, 2008 - 4:50pm

REVISION:	

**SCHILLER PARK
25th AVENUE IMPROVEMENT
(WAVELAND AVENUE TO
LAWRENCE AVENUE)**

HANCOCK ENGINEERING ♦ Civil Engineers
♦ Municipal Consultants
♦ Established 1911

933 Roosevelt Road
Westchester, Illinois 60154-2780
Phone: 708/865-0300
Fax: 708/865-1212

SCALE: 1"=30'
DRAWN BY: LEV, DMM, MK
CHECKED BY: BP
DATE: 7/23/2008
E.H.E. PROJECT NO.: 800-08-06201

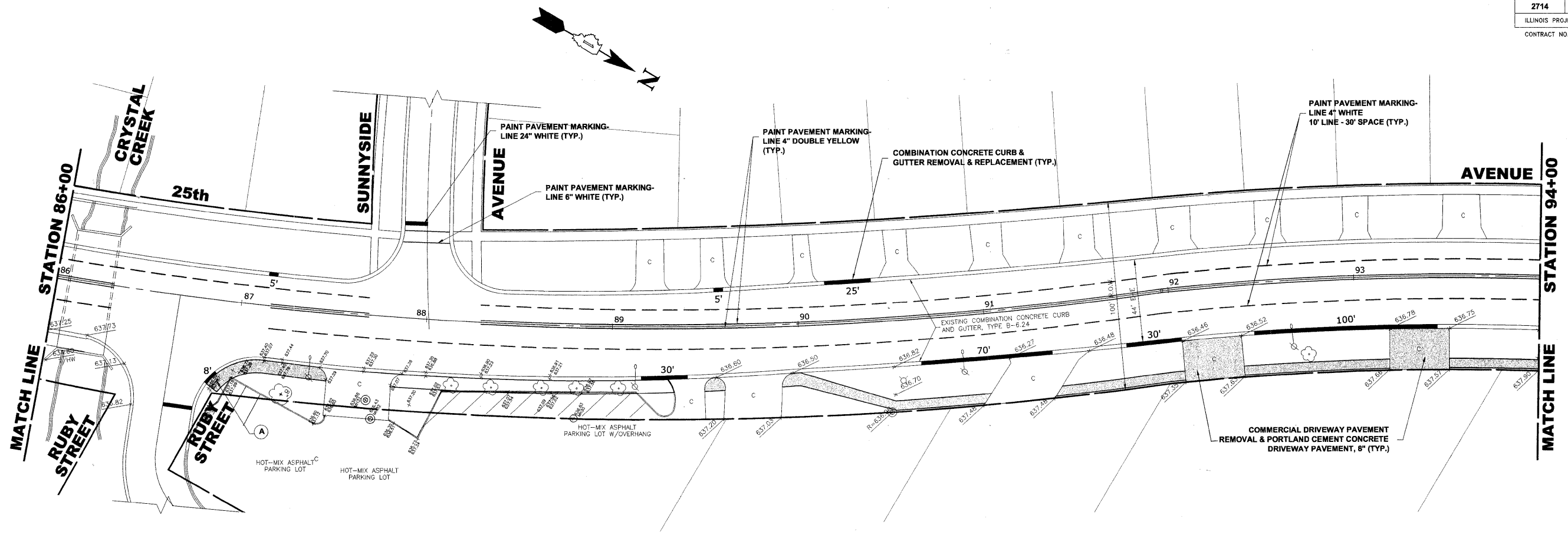

LEGEND:
 (A) DETECTABLE WARNING

NOTE:
 LOCATION & ROUTE OF PROPOSED SIDEWALK TO BE DETERMINED IN FIELD BY ENGINEER.

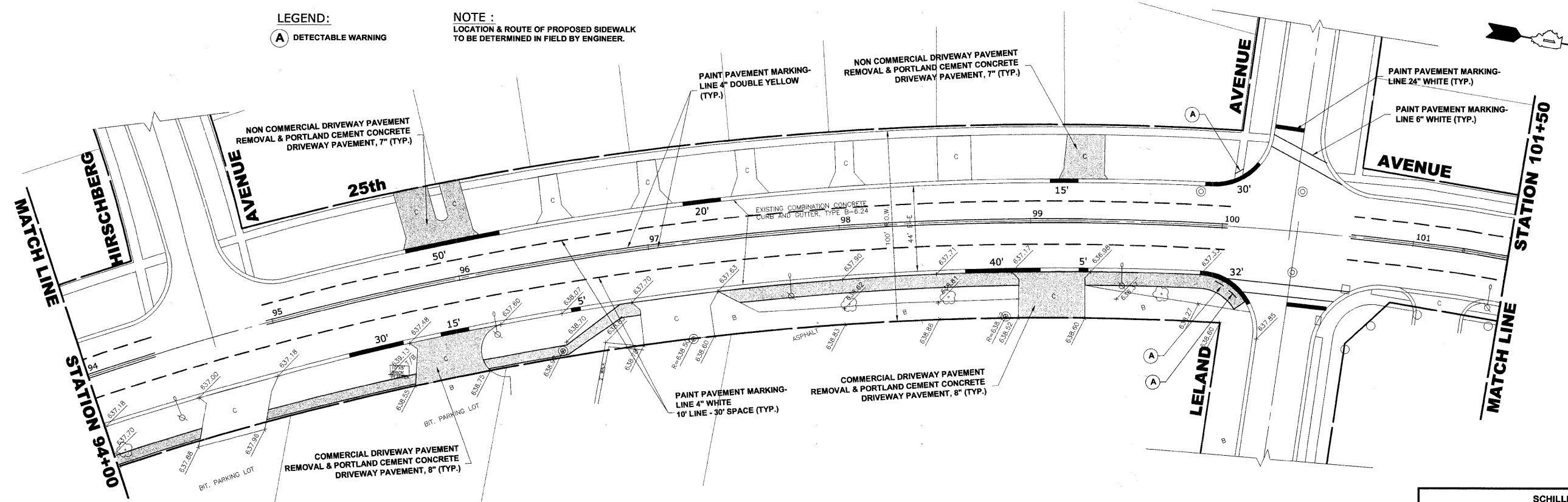

**SCHILLER PARK
 25th AVENUE IMPROVEMENT
 (WAVELAND AVENUE TO
 LAWRENCE AVENUE)**

REVISION:	DATE:



Civil Engineers
Municipal Consultants
Established 1911

9933 Roosevelt Road
 Westchester, Illinois 60154-2780
 Phone: 708/865-0300
 Fax: 708/865-1212

Drawing file: W:\Projects\80008062 - 25th Ave Improvement\25th Avenue\25th Avenue.dwg Jul 23, 2008 4:50pm

ROUTE NO.	SECTION	COUNTY	TOTAL SHEETS	SHEET NO.
2714	07-00075-00-RP	COOK	16	12
ILLINOIS PROJECT		M-9003 (035)		
CONTRACT NO.		63070		

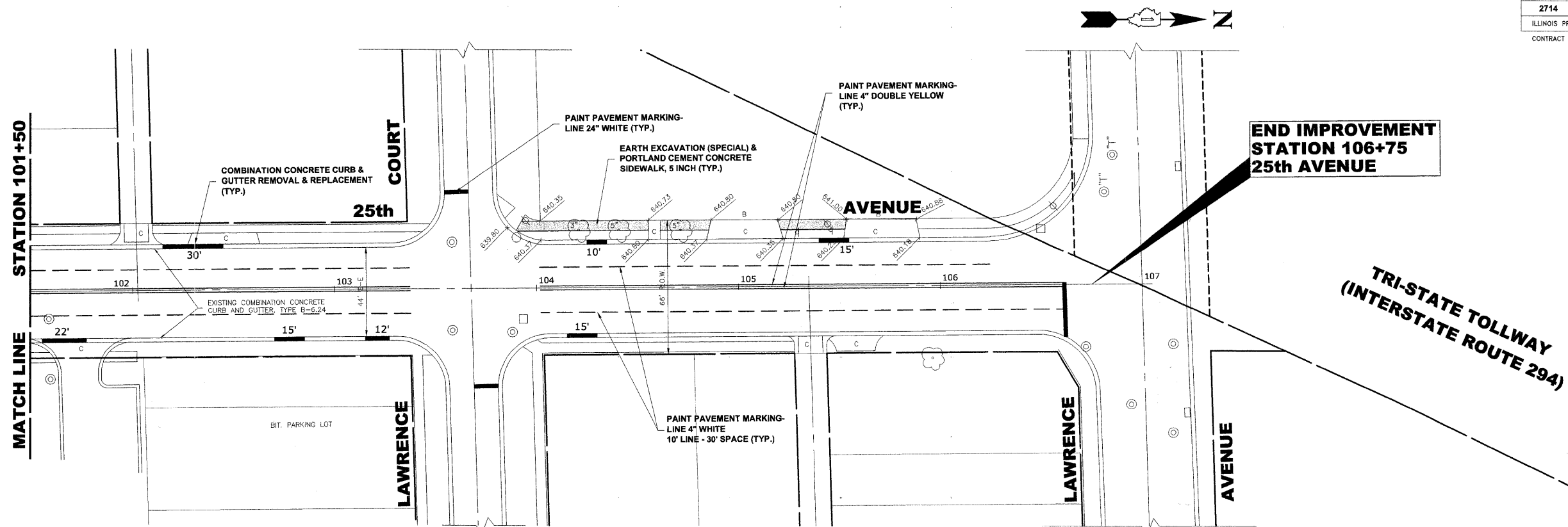

NOTE :
 LOCATION & ROUTE OF PROPOSED SIDEWALK
 TO BE DETERMINED IN FIELD BY ENGINEER.

LEGEND:
 (A) DETECTABLE WARNING

**END IMPROVEMENT
 STATION 106+75
 25th AVENUE**

**TRI-STATE TOLLWAY
 (INTERSTATE ROUTE 294)**

Drawing file: W:\Projects\80006062 - 25th Ave Improvement\25th AVENUE_25th AVENUE.dwg Jul 23, 2008 - 4:50pm

HANCOCK ENGINEERING ♦ Civil Engineers ♦ Municipal Consultants ♦ Established 1911

9933 Roosevelt Road
 Westchester, Illinois 60154-2780
 Phone: 708/865-0300
 Fax: 708/865-1212

REVISION:	

**SCHILLER PARK
 25th AVENUE IMPROVEMENT
 (WAVELAND AVENUE TO
 LAWRENCE AVENUE)**

SCALE: _____

DRAWN BY: LEV, DMM, MK
 CHECKED BY: BP
 DATE: 7/23/2008

E.H.E. PROJECT NO.: 800-08-06201

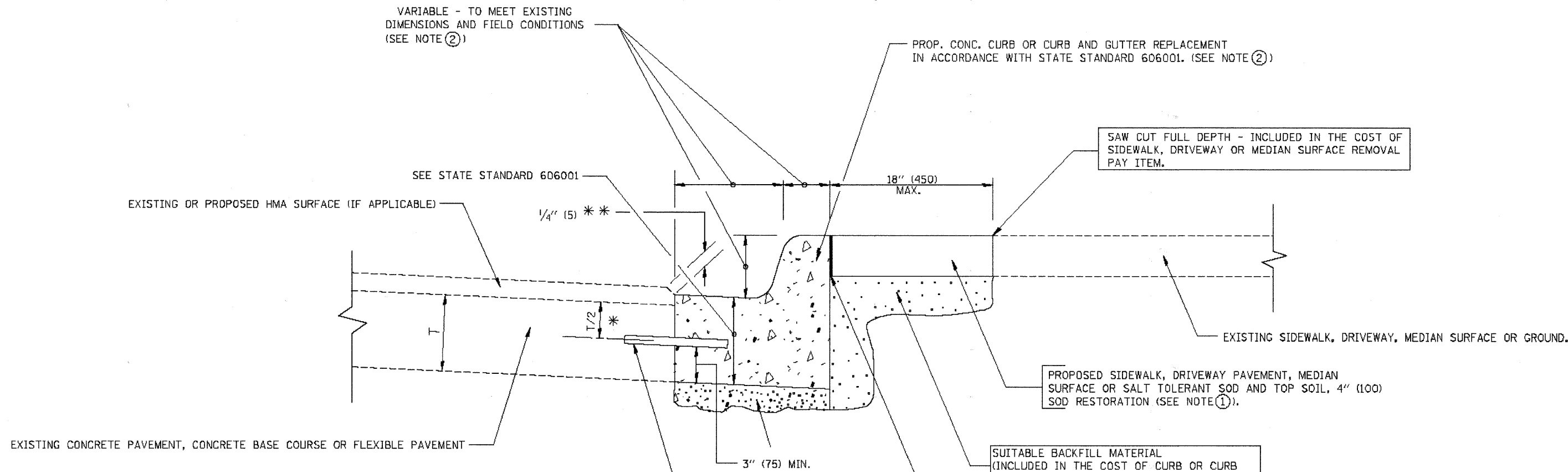

* 3" (75) MINIMUM FROM TOP AND BOTTOM OF THE CONCRETE PAVEMENT OR BASE COURSE.
 ** IF THE FINAL SURFACE OF THE PAVEMENT IS CONCRETE, THE GUTTER IS TO BE FLUSH WITH THE PAVEMENT.

NOTE: ① SIDEWALK, DRIVEWAY PAVEMENT OR MEDIAN SURFACE SHALL BE SIMILAR TO THE MATERIAL BEING REMOVED AND WILL BE PAID FOR SEPARATELY.

SALT TOLERANT SOD AND TOP SOIL, 4" (100) RESTORATION WILL NOT BE PAID FOR SEPARATELY, BUT SHALL BE INCLUDED IN THE COST OF CURB OR CURB AND GUTTER REMOVAL AND REPLACEMENT.

② CURB OR CURB AND GUTTER REPLACEMENT SHALL MATCH THE SHAPE OF THE EXISTING CURB OR CURB AND GUTTER UNLESS OTHERWISE SPECIFIED.

③ FOR CURB OR CURB AND GUTTER REMOVAL AND REPLACEMENT ADJACENT TO FLEXIBLE PAVEMENT DELETE EPOXY COATED TIE BARS.

④ LONGITUDINAL BARS, IF ENCOUNTERED IN THE EXISTING CURB OR CURB AND GUTTER, ARE NOT TO BE REPLACED. CUTTING AND REMOVING LONGITUDINAL BARS SHALL BE INCLUDED IN THE COST OF CURB OR CURB AND GUTTER REMOVAL AND REPLACEMENT.

⑤ THE COST OF HMA SURFACE REMOVAL IN THE EXISTING GUTTER FLAG SHALL BE INCLUDED IN THE COST OF THE CURB AND GUTTER REMOVAL AND REPLACEMENT.

⑥ THE REMOVAL AND REPLACEMENT OF THE EXISTING CURB OR CURB AND GUTTER SHALL BE DONE IN ACCORDANCE WITH THE APPLICABLE PORTIONS OF SECTION 440 AND 606 OF THE STANDARD SPECIFICATIONS.

⑦ THE LOCATIONS OF REMOVAL AND REPLACEMENT OF EXISTING CURB OR CURB AND GUTTER SHALL BE DETERMINED BY THE RESIDENT ENGINEER AT THE TIME OF CONSTRUCTION.

BASIS OF PAYMENT:

THIS WORK WILL BE PAID FOR AT THE CONTRACT UNIT PRICE PER FOOT (METER) FOR "CURB REMOVAL AND REPLACEMENT" OR "COMBINATION CONCRETE CURB AND GUTTER REMOVAL AND REPLACEMENT".

ALL DIMENSIONS ARE IN INCHES (MILLIMETERS) UNLESS OTHERWISE SHOWN.

REVISIONS	
NAME	DATE
A. HOUSEH	03/11/94
R. SHAH	02/24/99
R. SHAH	03/02/99
R. SHAH	08/19/99
R. SHAH	09/12/99
R. SHAH	09/19/99
R. SHAH	10/03/99
A. ABBAS	03/21/97
M. GOMEZ	01/22/01
R. BORO	01/01/07

ILLINOIS DEPARTMENT OF TRANSPORTATION

CURB OR CURB AND GUTTER REMOVAL AND REPLACEMENT

SCALE: VERT. NONE HORIZ. NONE

DRAWN BY CHECKED BY

CURB OR CURB AND GUTTER REMOVAL AND REPLACEMENT

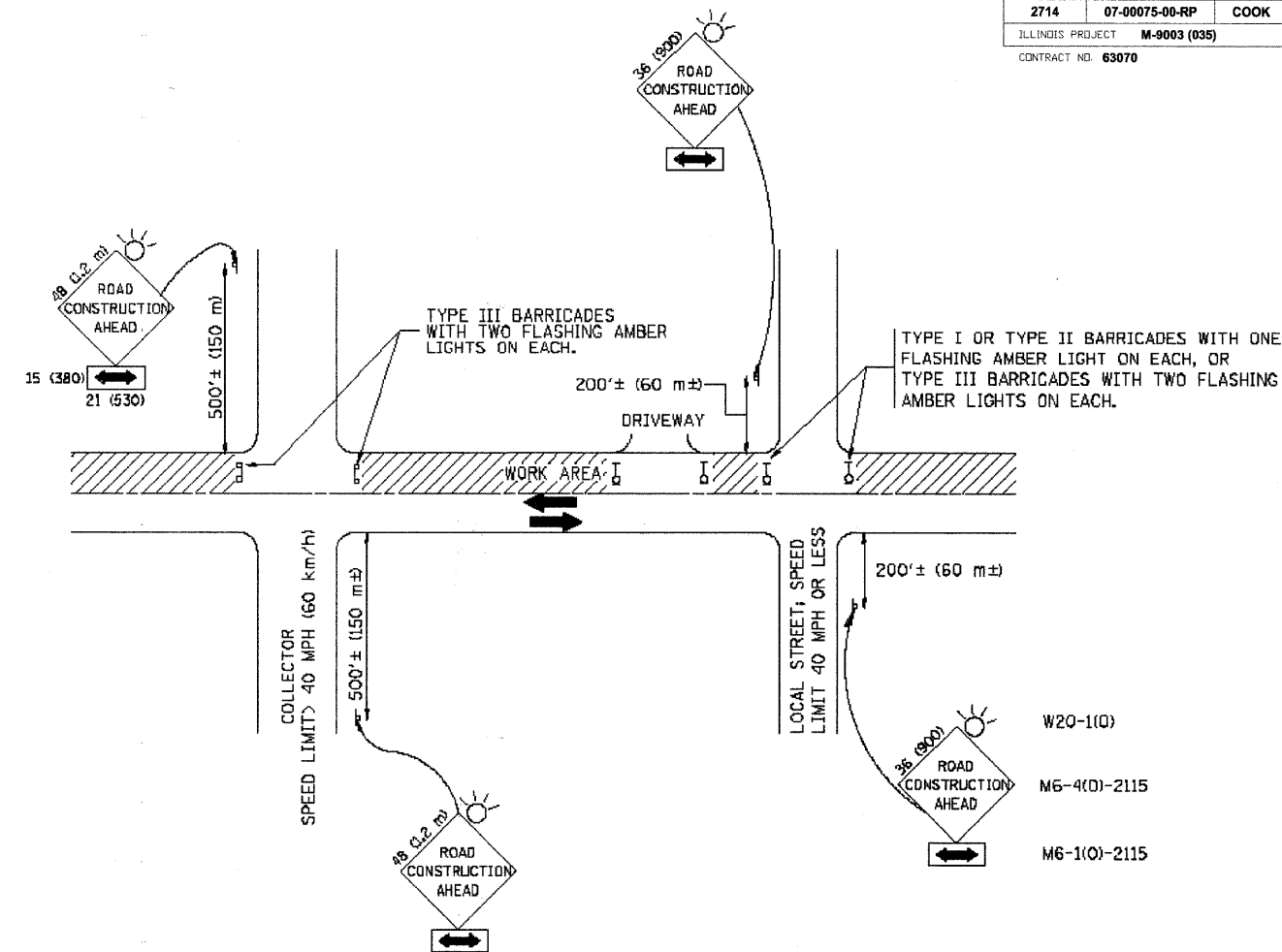

TRAFFIC CONTROL AND PROTECTION FOR SIDE ROADS, INTERSECTIONS, AND DRIVEWAYS

NOTES:

A. FOR NO LANE RESTRICTION ON THE SIDE ROAD OR DRIVEWAYS

- SIDE ROAD WITH A SPEED LIMIT OF 40 MPH (60 km/h) OR LESS AS SHOWN ON THE DRAWING AND AS DIRECTED BY THE ENGINEER:
 - ONE **ROAD CONSTRUCTION AHEAD** SIGN 36 x 36 (900x900) WITH A FLASHER AND FLAG MOUNTED ON IT APPROXIMATELY 200' (60 m) IN ADVANCE OF THE MAIN ROUTE.
 - THE CLOSED PORTION OF THE MAIN ROUTE SHALL BE PROTECTED BY BLOCKING WITH TYPE I, TYPE II OR TYPE III BARRICADES, 1/3 OF THE CROSS SECTION OF THE CLOSED PORTION.
- SIDE ROAD WITH A SPEED LIMIT GREATER THAN 40 MPH (60 km/h) AS SHOWN ON THE DRAWING AND AS DIRECTED BY THE ENGINEER:
 - ONE **ROAD CONSTRUCTION AHEAD** SIGN 48 x 48 (1.2 m x 1.2 m) WITH A FLASHER MOUNTED ON IT APPROXIMATELY 500' (150 m) IN ADVANCE OF THE MAIN ROUTE.
 - THE CLOSED PORTION OF THE MAIN ROUTE SHALL BE PROTECTED BY BLOCKING WITH TYPE III BARRICADES, 1/2 OF THE CROSS SECTION OF THE CLOSED PORTION.
- WHEN THE SIDE ROAD LIES BETWEEN THE BEGINNING OF THE MAINLINE SIGNING AND THE WORK ZONE, A SINGLE HEADED ARROW (M6-1) SHALL BE USED IN LIEU OF THE DOUBLE HEADED ARROW (M6-4).

B. FOR A LANE CLOSURE ON A SIDE ROAD OR DRIVEWAY:

- USE APPLICABLE PORTIONS OF THE TYPICAL APPLICATION OF TRAFFIC CONTROL DEVICES (STD. 701501, STD. 701606 OR THE APPROPRIATE STANDARD). THE SPACING OF SIGNS AND BARRICADES SHALL BE ADJUSTED FOR FIELD CONDITIONS AS DIRECTED BY THE ENGINEER. THE DIRECTIONAL ARROW SHALL BE COVERED OR REMOVED WHEN NO LONGER CONSISTENT WITH THE SIDE ROAD LANE CLOSURE.
- C. ADVANCE WARNING SIGNS ARE TO BE OMITTED ON DRIVEWAY UNLESS OTHERWISE NOTED.
- D. THE TRAFFIC CONTROL AND PROTECTION FOR SIDE ROADS, INTERSECTIONS, AND DRIVEWAYS SHALL BE INCIDENTAL TO THE COST OF SPECIFIED TRAFFIC CONTROL STANDARDS OR ITEMS.

All dimensions are in millimeters (inches) unless otherwise shown.

REVISIONS	
NAME	DATE
LHA	6/89
T. RAMMACHER	09/08/94
J. OBERLE	10/18/95
A. HOUSEH	03/08/96
A. HOUSEH	10/15/96
T. RAMMACHER	01/06/00

ILLINOIS DEPARTMENT OF TRANSPORTATION
TRAFFIC CONTROL AND PROTECTION FOR SIDE ROADS, INTERSECTIONS, AND DRIVEWAYS

SCALE: NONE

DRAWN BY

CHECKED BY

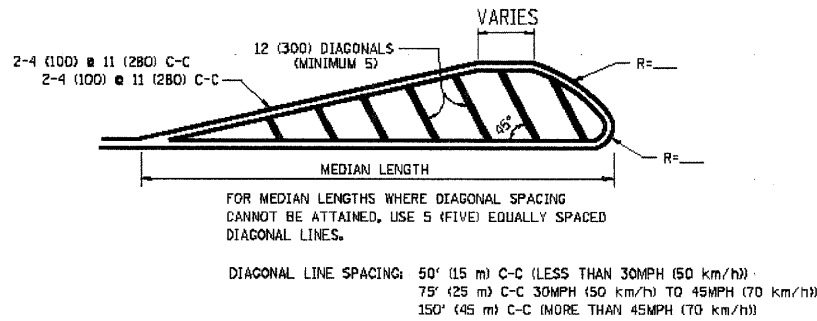
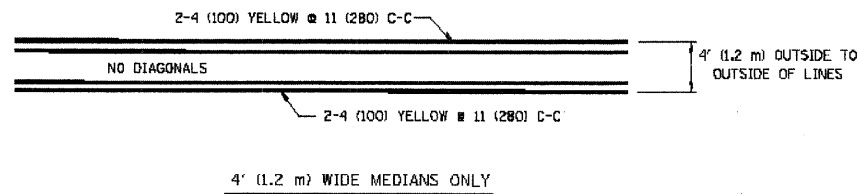
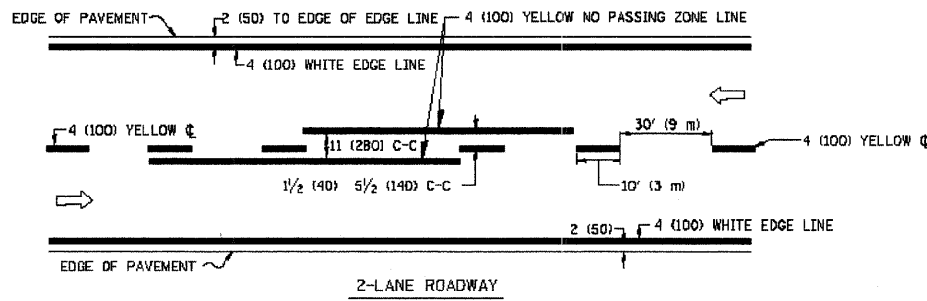

MEDIANS OVER 4' (1.2 m) WIDE

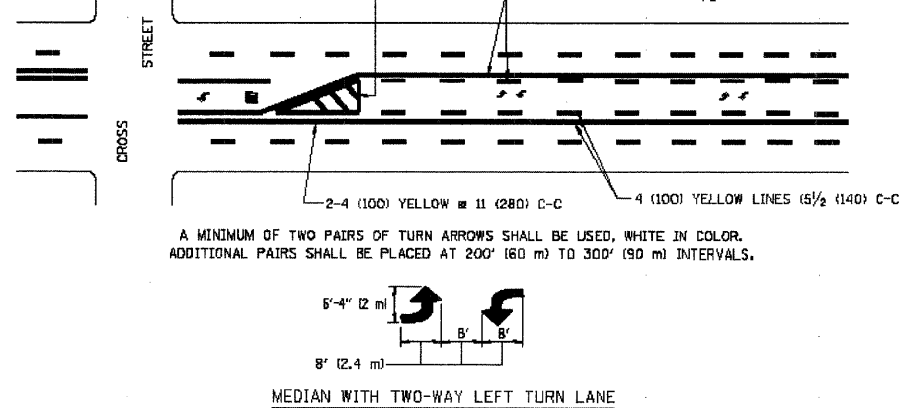

TYPICAL PAINTED MEDIAN MARKING

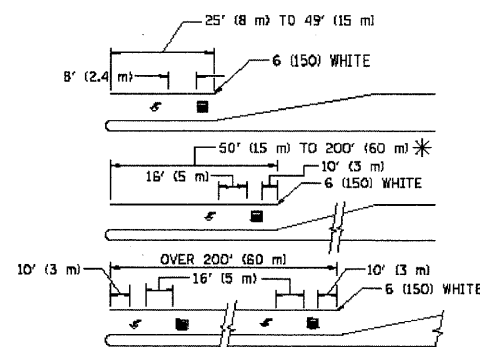

FULL SIZE LETTERS 8' (2.4 m) AND ARROWS SHALL BE USED.
AREA = 15.6 SQ. FT. (1.5 m²) AREA = 20.8 SQ. FT. (1.9 m²)

* TURN LANES IN EXCESS OF 400' (120 m) IN LENGTH MAY HAVE AN ADDITIONAL SET OF ARROW - "ONLY" INSTALLED MIDWAY BETWEEN THE OTHER TWO SETS OF ARROW - "ONLY".

TYPICAL LEFT (OR RIGHT) TURN LANE

TYPICAL TURN LANE MARKING

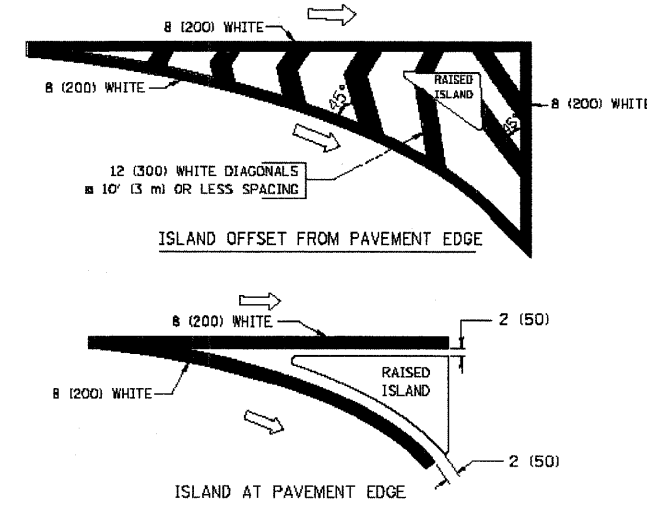

TYPICAL ISLAND MARKING

TYPE OF MARKING	WIDTH OF LINE	PATTERN	COLOR	SPACING / REMARKS
CENTERLINE ON 2 LANE PAVEMENT	4 (100)	SKIP-DASH	YELLOW	10' (3 m) LINE WITH 30' (9 m) SPACE
CENTERLINE ON MULTI-LANE UNDIVIDED PAVEMENT	2 @ 4 (100)	SOLID	YELLOW	11 (280) C-C
NO PASSING ZONE LINES FOR ONE DIRECTION FOR BOTH DIRECTIONS	4 (100) 2 @ 4 (100)	SOLID SOLID	YELLOW YELLOW	5/2 (140) C-C FROM SKIP-DASH CENTERLINE 11 (280) C-C OMIT SKIP-DASH CENTERLINE BETWEEN
LANE LINES	4 (100) 5 (125) ON FREEWAYS	SKIP-DASH SKIP-DASH	WHITE WHITE	10' (3 m) LINE WITH 30' (9 m) SPACE
DOTTED LINES (EXTENSIONS OF CENTER, LANE OR TURN LANE MARKINGS)	SAME AS LINE BEING EXTENDED	SKIP-DASH	SAME AS LINE BEING EXTENDED	2' (600) LINE WITH 6' (1.8 m) SPACE
EDGE LINES	4 (100)	SOLID	YELLOW-LEFT WHITE-RIGHT	OUTLINE MOUNTABLE MEDIANS IN YELLOW; EDGE LINES ARE NOT USED NEXT TO BARRIER CURB
TURN LANE MARKINGS	6 (150) LINE; FULL SIZE LETTERS & SYMBOLS (8' (2.4m))	SOLID	WHITE	SEE TYPICAL TURN LANE MARKING DETAIL
TWO WAY LEFT TURN MARKING	2 @ 4 (100) EACH DIRECTION 8' (2.4m) LEFT ARROW	SKIP-DASH AND SOLID IN PAIRS	YELLOW WHITE	10' (3 m) LINE WITH 30' (9 m) SPACE FOR SKIP-DASH; 5/2 (140) C-C BETWEEN SOLID LINE AND SKIP-DASH LINE SEE TYPICAL TWO-WAY LEFT TURN MARKING DETAIL
CROSSWALK LINES (PEDESTRIAN) A. DIAGONALS (BIKE & EQUESTRIAN) B. LONGITUDINAL BARS (SCHOOL)	2 @ 6 (150) 12 (300) @ 45° 12 (300) @ 90°	SOLID SOLID SOLID	WHITE WHITE WHITE	NOT LESS THAN 6' (1.8 m) APART 2' (600) APART SEE TYPICAL CROSSWALK MARKING DETAILS.
STOP LINES	24 (600)	SOLID	WHITE	PLACE 4' (1.2 m) IN ADVANCE OF AND PARALLEL TO CROSSWALK, IF PRESENT. OTHERWISE, PLACE AT DESIRED STOPPING POINT, PARALLEL TO CROSSROAD CENTERLINE, WHERE POSSIBLE.
PAINTED MEDIANS	2 @ 4 (100) WITH 12 (300) DIAGONALS @ 45° NO DIAGONALS USED FOR 4' (1.2 m) WIDE MEDIANS	SOLID	YELLOW; TWO WAY TRAFFIC WHITE; ONE WAY TRAFFIC	11 (280) C-C FOR THE DOUBLE LINE SEE TYPICAL PAINTED MEDIAN MARKING.
GORE MARKING AND CHANNELIZING LINES	8 (200) WITH 12 (300) DIAGONALS @ 45°	SOLID	WHITE	DIAGONALS: 15' (4.5 m) C-C (LESS THAN 30MPH (50 km/h)) 20' (6 m) C-C 30MPH (50 km/h) TO 45MPH (70 km/h) 30' (9 m) C-C (OVER 45MPH (70 km/h))
RAILROAD CROSSING	24 (600) TRANSVERSE LINES; "RR" 15 6' (1.8 m) LETTERS; 16 (400) LINE FOR "X"	SOLID	WHITE	SEE STATE STANDARD 780001 AREA OF: "R"=3.6 SQ. FT. (0.33 m ²) EACH "X"=54.0 SQ. FT. (5.0 m ²)
SHOULDER DIAGONALS	12 (300) @ 45°	SOLID	WHITE - RIGHT YELLOW - LEFT	50' (15 m) C-C (LESS THAN 30MPH (50 km/h)) 75' (25 m) C-C (30 MPH (50 km/h) TO 45MPH (70 km/h)) 150' (45 m) C-C (OVER 45MPH (70 km/h))

FOR FURTHER DETAILS ON PAVEMENT MARKING REFER TO STANDARD SPECIFICATIONS FOR ROAD AND BRIDGE CONSTRUCTION AND STATE STANDARD 780001.

All dimensions are in inches (millimeters) unless otherwise shown.

REVISIONS	
NAME	DATE
EVERS	03-19-90
T. RAMMACHER	10-27-94
ALEX HOUSEH	10-09-96
ALEX HOUSEH	10-17-96
T. RAMMACHER	01-06-00

ILLINOIS DEPARTMENT OF TRANSPORTATION
DISTRICT ONE
TYPICAL PAVEMENT MARKINGS

SCALE: NONE

DRAWN BY CADD

CHECKED BY

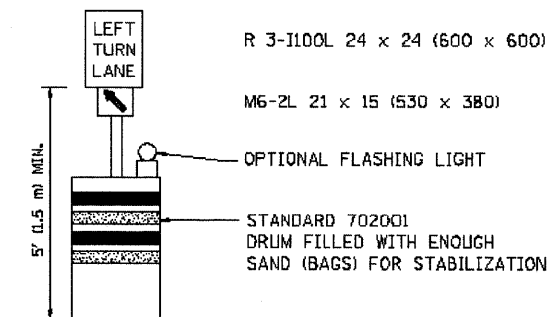
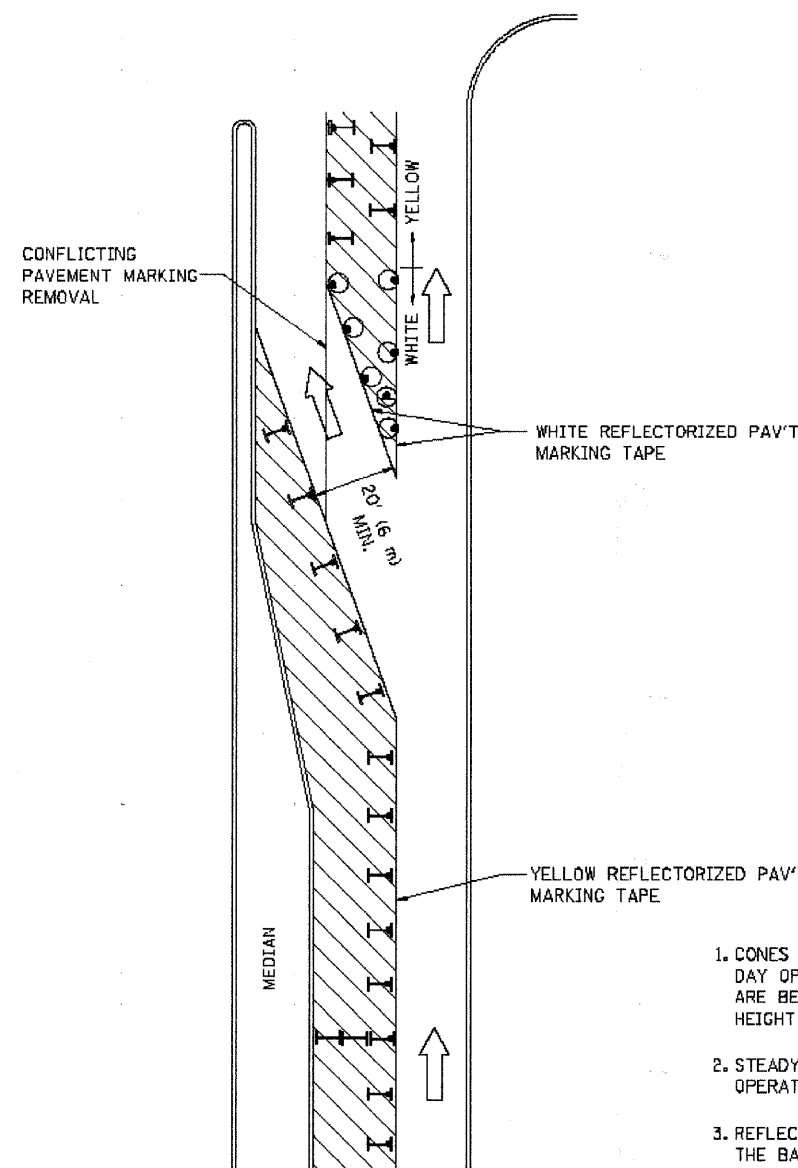

ROUTE NO.	SECTION	COUNTY	TOTAL SHEETS	SHEET NO.
2714	07-00075-00-RP	COOK	16	16
ILLINOIS PROJECT M-9003 (035)				
CONTRACT NO. 63070				



GENERAL NOTES

1. CONES MAY BE SUBSTITUTED FOR BARRICADES OR DRUMS AT HALF THE SPACING DURING DAY OPERATIONS. CONES SHALL BE A MINIMUM OF 28 (710) IN HEIGHT. WHEN CONES ARE BEING USED, THE "LEFT TURN LANE" SIGN MAY BE SKID MOUNTED AT A MINIMUM HEIGHT OF 5' (1.5 m).
2. STEADY BURNING LIGHTS WILL NOT BE REQUIRED ON BARRICADES OR DRUMS FOR DAY OPERATIONS. ALL LIGHTS SHALL BE MONODIRECTIONAL.
3. REFLECTORIZED TEMPORARY PAVEMENT MARKING TAPE SHALL BE PLACED THROUGHOUT THE BARRICADED AREA OF EACH TURN BAY WHERE THE CLOSURE TIME IS GREATER THAN FOURTEEN DAYS.
4. THIS APPLICATION ALSO APPLIES WHEN WORK IS BEING PERFORMED IN THE RIGHT LANE(S) AND THE RIGHT TURN BAY IS TO REMAIN OPEN. UNDER THIS CONDITION, "RIGHT TURN LANE" R3-100 24 x 24 (600 x 600) AND M6-2R 21 x 15 (530 x 380) SHALL BE USED.
5. THESE CONTROLS SHALL SUPPLEMENT MAINLINE TRAFFIC CONTROL FOR LANE CLOSURES.
6. LONGITUDINAL DIMENSIONS MAY BE ADJUSTED TO FIT FIELD CONDITIONS.
7. FORM BT 725 IS REQUIRED.
8. TRAFFIC CONTROL AND PROTECTION AT TURN BAYS (TO REMAIN OPEN TO TRAFFIC) SHALL BE INCLUDED IN THE COST SPECIFIED TRAFFIC CONTROL STANDARDS OR ITEMS.

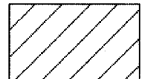
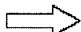
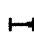
LEGEND

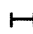
-  WORK AREA
-  LANE OPEN TO TRAFFIC
-  TYPE I OR II BARRICADE WITH STEADY BURN LIGHT
-  DRUM WITH STEADY BURN LIGHT
-  DRUM WITH SIGN (WITH OPTIONAL FLASHING LIGHT) SEE DETAIL
-  TYPE I OR II CHECK BARRICADE WITH FLASHING LIGHT

All dimensions are in inches (millimeters) unless otherwise shown.

REVISIONS	
NAME	DATE
T. RAMMACHER	09/08/99
A. HOUSEH	11/07/95
A. HOUSEH	10/12/96
T. RAMMACHER	01/06/00

ILLINOIS DEPARTMENT OF TRANSPORTATION
**TRAFFIC CONTROL AND PROTECTION
 AT TURN BAYS
 (TO REMAIN OPEN TO TRAFFIC)**

SCALE: NONE

DRAWN BY
 CHECKED BY LHA