

F.A.U. RTE.	SECTION	COUNTY	TOTAL SHEETS	SHEET NO.
3803	03-00049-00-FP	COOK	045	009
STA.		TO STA.		
FED. ROAD DIST. NO. 1		ILLINOIS	FED. AID PROJECT M8003 (559)	

CONTRACT #63078

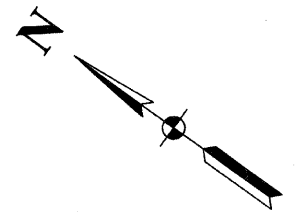

LEGEND

- HMA SURFACE REMOVAL
- SIDEWALK REMOVAL
- DRIVEWAY PAVEMENT REMOVAL
- SHOULDER REMOVAL
- PAVEMENT REMOVAL
- COMB. CURB AND GUTTER REMOVAL
- PAVEMENT WIDENING
- CLASS D PATCHES
- 10' BUTT JOINTS
- P.C.C. SIDEWALK-5"
- TREE REMOVAL

NOTES

1. ALL HMA DRIVEWAYS SHALL CONSIST OF HOT-MIX ASPHALT SURFACE COURSE, MIX "C", N50-2", AND HOT-MIX ASPHALT BASE COURSE-6".
2. ALL PROPOSED COMBINATION CONCRETE CURB AND GUTTER SHALL BE TYPE B-6.24 UNLESS OTHERWISE NOTED.

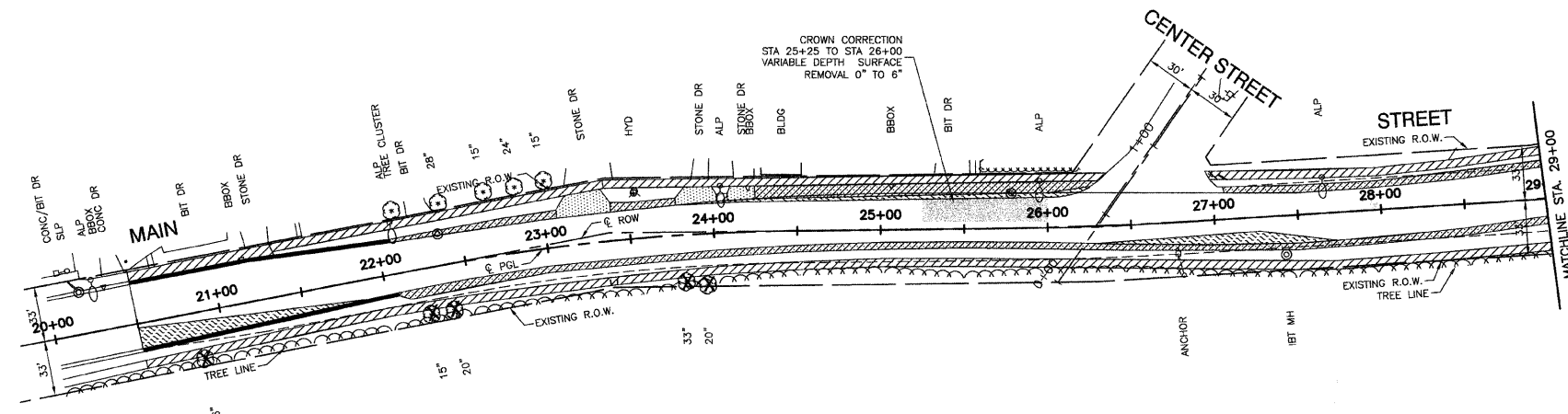

EXISTING CONDITIONS

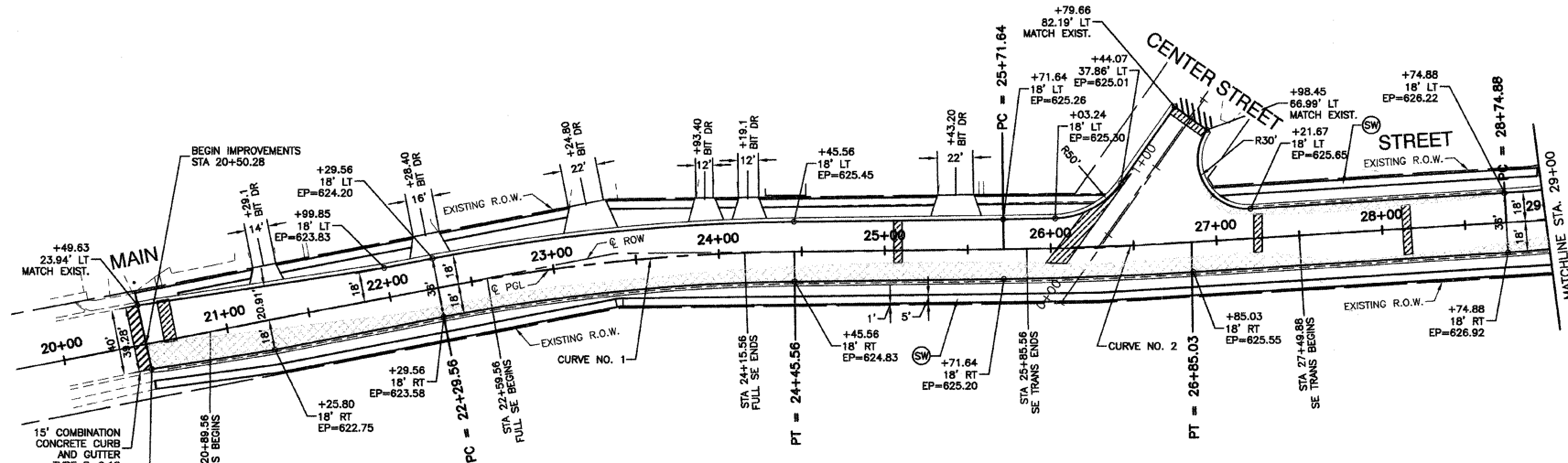

PROPOSED IMPROVEMENTS

CURVE NO. 1

P.I.=STA. 23+37.56
 $\Delta=10^{\circ}18'48''$
 R=1200 FT
 T=108.293 FT
 L=216 FT
 E=4.876 FT
 P.C.=STA 22+29.56
 P.T.=STA 24+45.56
 S.E. RATE=2.2%
 S.E. TRANSITION=170FT

CURVE NO. 2

P.I.=STA. 26+28.34
 $\Delta=2^{\circ}49'29''$
 R=2300 FT
 T=56.706 FT
 L=113.39 FT
 E=0.699 FT
 P.C.=STA 25+71.64
 P.T.=STA 26+85.03

BENCH MARK: #96

N FLANGE OF HYD N SIDE GLENWOOD CHICAGO HEIGHTS RD BETWEEN GLENWOOD OAKS AND FOREST PRESERVE ELEVATION = 621.80

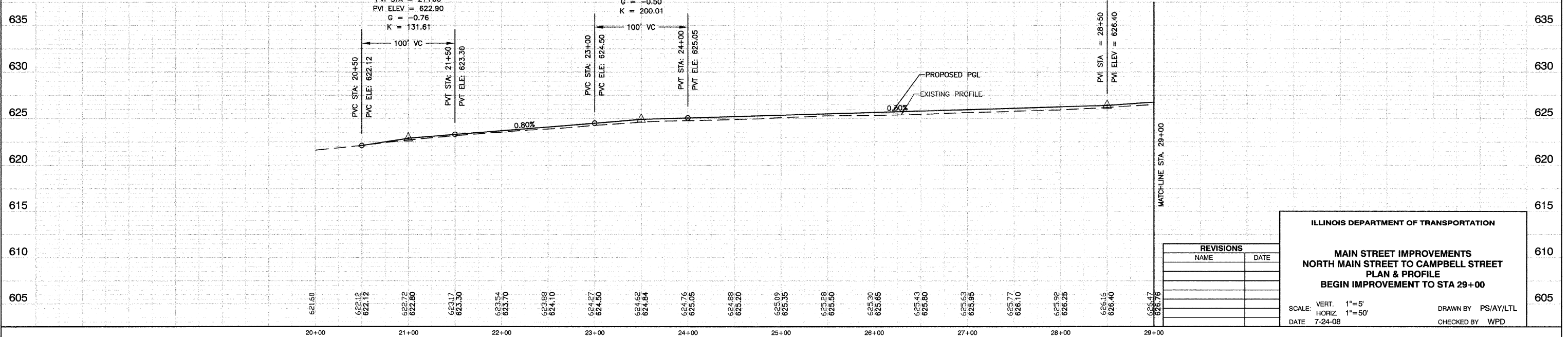

REVISIONS	
NAME	DATE

ILLINOIS DEPARTMENT OF TRANSPORTATION

**MAIN STREET IMPROVEMENTS
 NORTH MAIN STREET TO CAMPBELL STREET
 PLAN & PROFILE
 BEGIN IMPROVEMENT TO STA 29+00**

SCALE: VERT. 1"=5'
 HORIZ 1"=50'

DATE 7-24-08

DRAWN BY PS/AY/LTL
 CHECKED BY WPD