

FAU R/E	SECTION	COUNTY	TOTAL SHEETS	SHEET NO
3603	03-00049-00-FP	COOK	045	010
STA.		TO STA.		
FED. ROAD DIST. NO. 1		ILLINOIS	FED. AID PROJECT MB003 (559)	

CONTRACT #63078

**LEGEND**

- HMA SURFACE REMOVAL
- SIDEWALK REMOVAL
- DRIVEWAY PAVEMENT REMOVAL
- SHOULDER REMOVAL
- PAVEMENT REMOVAL
- COMB. CURB AND GUTTER REMOVAL
- PAVEMENT WIDENING
- CLASS D PATCHES
- 10' BUTT JOINTS
- P.C.C. SIDEWALK-5"
- TREE REMOVAL

**NOTES**

1. ALL HMA DRIVEWAYS SHALL CONSIST OF HOT-MIX ASPHALT SURFACE COURSE, MIX "C", N50-2", AND HOT-MIX ASPHALT BASE COURSE-6".
2. ALL PROPOSED COMBINATION CONCRETE CURB AND GUTTER SHALL BE TYPE B-6.24 UNLESS OTHERWISE NOTED.

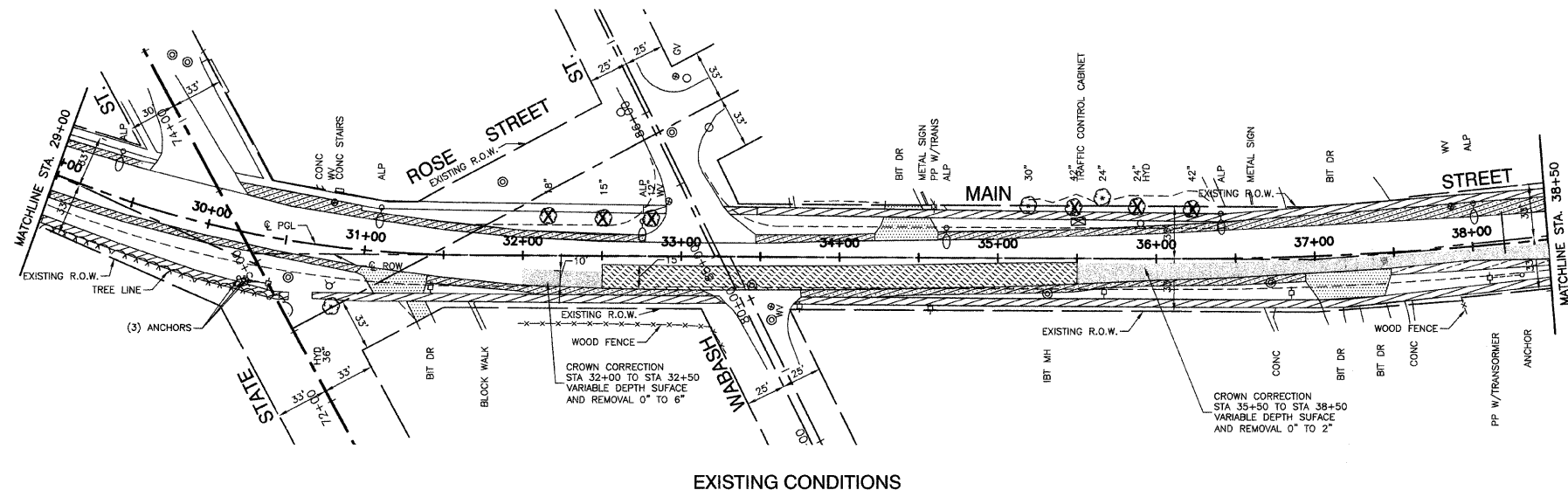

EXISTING CONDITIONS

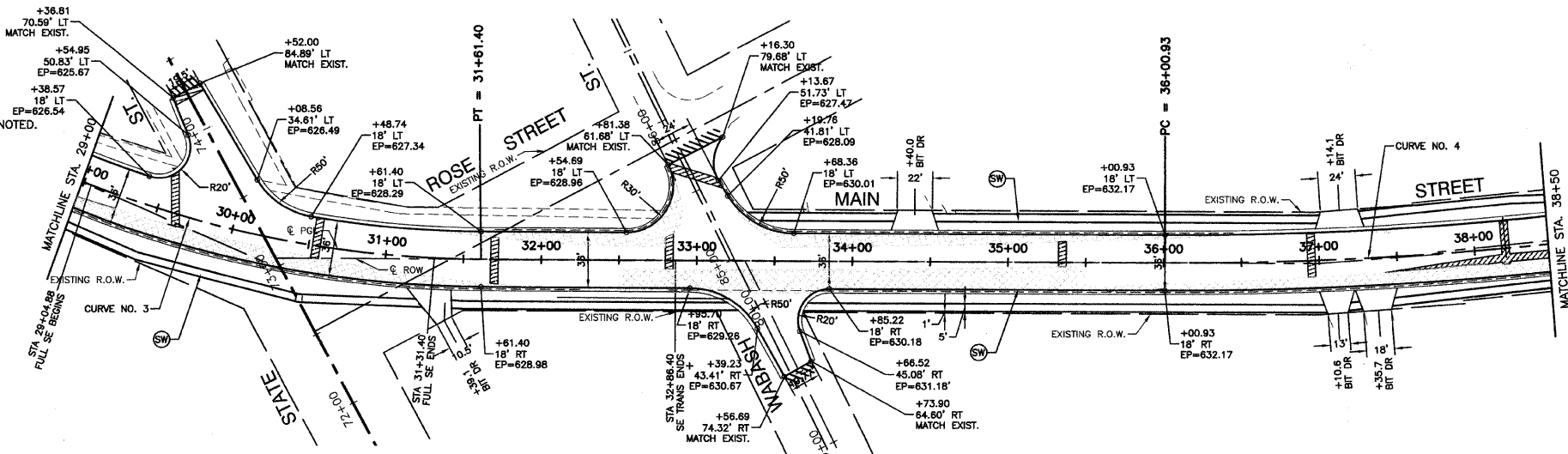

PROPOSED IMPROVEMENTS

**CURVE NO. 3**

P.I.=STA. 30+18.14  
 $\Delta=23^{\circ}27'07''$   
 R=700 FT  
 T=145.294 FT  
 L=286.52 FT  
 E=14.92 FT  
 P.C.=STA 28+74.88  
 P.T.=STA 31+61.40  
 S.E. RATE=2.8%  
 S.E. TRANSITION=155FT

**CURVE NO. 4**

P.I.=STA. 37+31.7  
 $\Delta=6^{\circ}30'54''$   
 R=2300 FT  
 T=130.906 FT  
 L=261.53 FT  
 E=3.722 FT  
 P.C.=STA 36+00.93  
 P.T.=STA 38+62.46

**BENCH MARK: #96**

N FLANGE OF HYD N SIDE GLENWOOD CHICAGO HEIGHTS RD  
 BETWEEN GLENWOOD OAKS AND FOREST PRESERVE  
 ELEVATION = 621.80

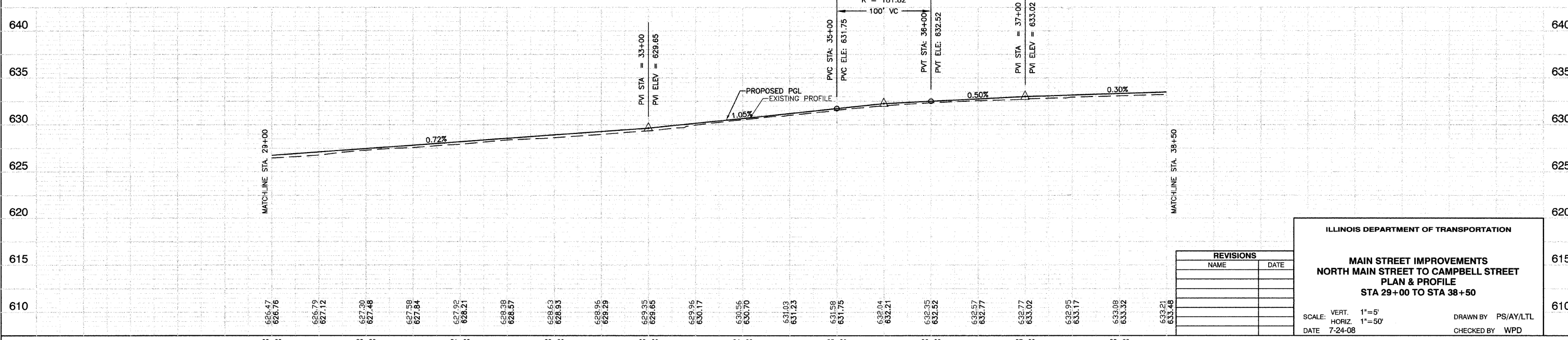

REVISIONS	
NAME	DATE

**ILLINOIS DEPARTMENT OF TRANSPORTATION**

**MAIN STREET IMPROVEMENTS  
 NORTH MAIN STREET TO CAMPBELL STREET  
 PLAN & PROFILE  
 STA 29+00 TO STA 38+50**

SCALE: VERT. 1"=5'  
 HORIZ. 1"=50'  
 DATE 7-24-08

DRAWN BY PS/AY/LTL  
 CHECKED BY WPD