

STAGE 2

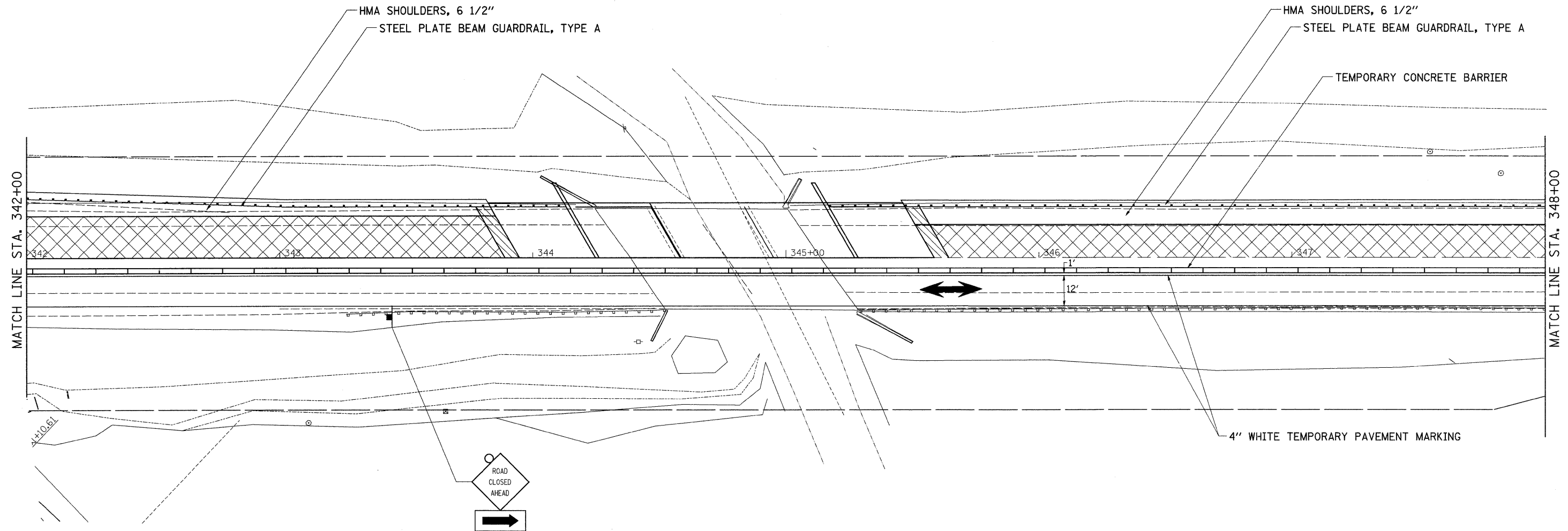

STAGE 2 NOTES

1. USE STANDARD 701321.
2. CLOSE W. EBSON RD.
3. CONSTRUCT BRIDGE LT TO STAGE CONSTRUCTION LINE.
4. CONSTRUCT LEVEL BINDER (MACHINE METHOD).
5. CONSTRUCT FULL WIDTH SHOULDERS AND GUARDRAIL FROM STA. 339+53.50 LT TO STA. 348+60.00 LT
6. CONSTRUCT TEMPORARY RAMP.
7. CONSTRUCT TEMPORARY PAVEMENT.
8. INSTALL GUARDRAIL.

	= WORK AREA
	= TYPE III BARRICADE WITH FLASHING LIGHTS
	= SIGN
	= BARRICADE, OR DRUM WITH STEADY BURNING LIGHTS
	= INDUCTION LOOP DETECTOR
	= TRAFFIC SIGNAL

	TEMPORARY RAMP STA 343+90 TO STA 343+95 STA 345+58.61 TO STA 345+63.61 STA 348+55 TO STA 348+60 STA. 339+48.50 TO STA. 339+53.50
	TEMPORARY PAVEMENT STA 338+45 TO STA 339+53.50 STA 348+60 TO STA 349+73.40
	LEVEL BINDER (MACHINE METHOD) STA 339+53.50 TO STA 343+95 STA 345+58.61 TO 348+55

FILE NAME = c:\projects\p206006\d06006stg.dgn	USER NAME = hensonke	DESIGNED -	REVISED -	STATE OF ILLINOIS DEPARTMENT OF TRANSPORTATION	STAGING PLANS				F.A.P. RTE. 308	SECTION 109BR-5	COUNTY WHITESIDE	TOTAL SHEETS 83	SHEET NO. 25
	PLOT SCALE = 20.0000 ft / in.	DRAWN -	REVISED -		SCALE:	SHEET NO.	OF	SHEETS	STA.	TO STA.	CONTRACT NO. 64C25		
	PLOT DATE = Thu Jul 31 09:41:11 2008	CHECKED -	REVISED -		FED. ROAD DIST. NO. ILLINOIS FED. AID PROJECT								
		DATE -	REVISED -										