

STATE OF ILLINOIS
DEPARTMENT OF TRANSPORTATION

ROUTE NO.	SECTION	COUNTY	TOTAL SHEETS	SHEET NO.	SHEET NO. 7
FAP 308	109BR-5	WHITESIDE	83	41	19 SHEETS
FED. ROAD DIST. NO. 7	ILLINOIS	FED. AID PROJECT			

Contract #64C25

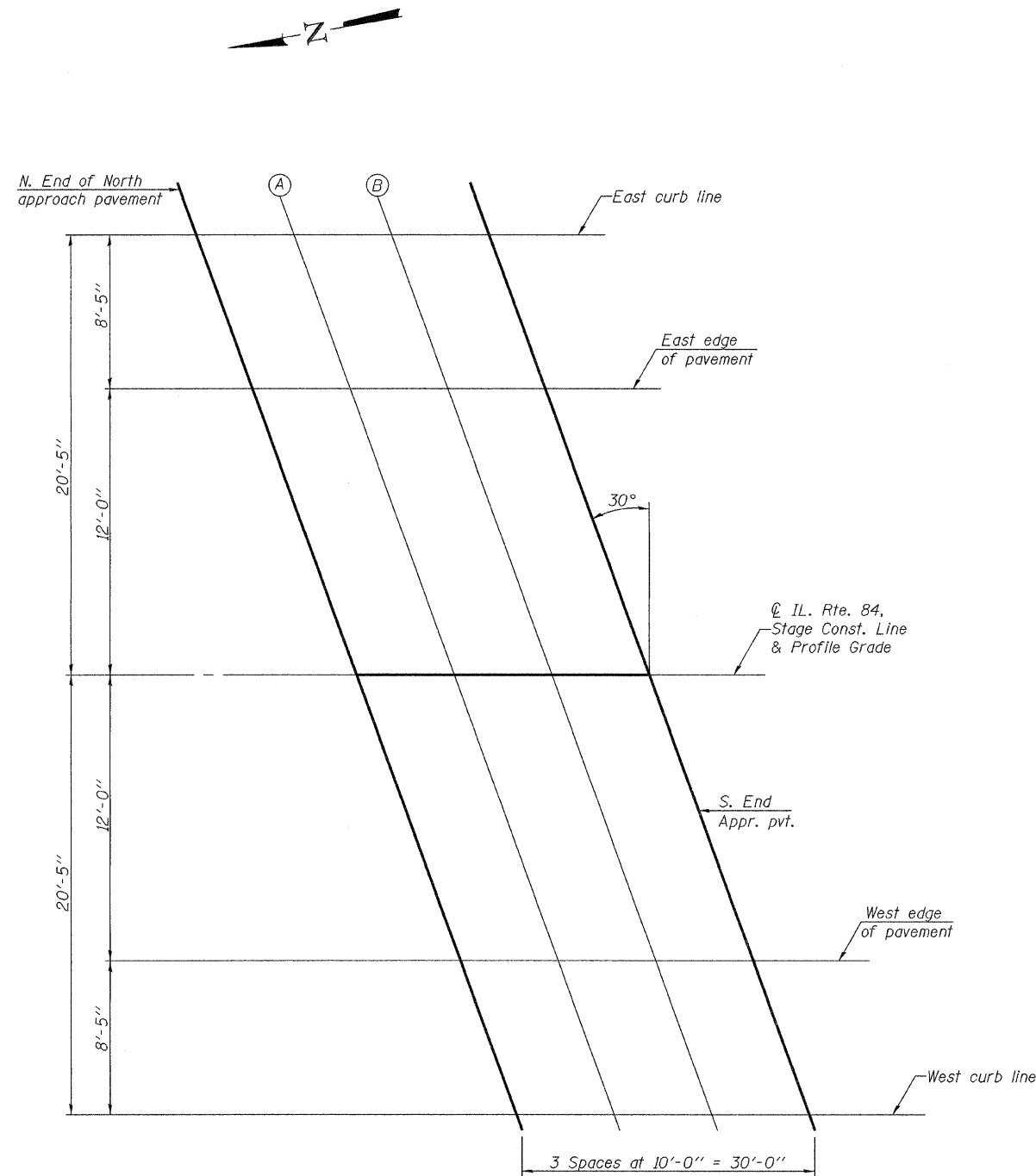

PLAN

EAST CURB LINE

Location	Station	Offset	Theoretical Grade Elevations
N. End N. Appr. Pav't.	343+82.98	-20.42	590.15
A	343+92.98	-20.42	590.11
B	344+02.98	-20.42	590.06
S. End of N. Appr. Pav't.	344+12.98	-20.42	590.01

EAST EDGE OF PAVEMENT

Location	Station	Offset	Theoretical Grade Elevations
N. End N. Appr. Pav't.	343+87.84	-12.00	590.31
A	343+97.84	-12.00	590.26
B	344+07.84	-12.00	590.21
S. End of N. Appr. Pav't.	344+17.84	-12.00	590.16

☉ ROADWAY, P.G. & STAGE CONSTRUCTION LINE

Location	Station	Offset	Theoretical Grade Elevations
N. End N. Appr. Pav't.	343+94.77	0.00	590.46
A	344+04.77	0.00	590.42
B	344+14.77	0.00	590.37
S. End of N. Appr. Pav't.	344+24.77	0.00	590.32

WEST EDGE OF PAVEMENT

Location	Station	Offset	Theoretical Grade Elevations
N. End N. Appr. Pav't.	344+10.70	12.00	590.24
A	344+11.70	12.00	590.19
B	344+21.70	12.00	590.14
S. End of N. Appr. Pav't.	344+31.70	12.00	590.09

WEST CURB LINE

Location	Station	Offset	Theoretical Grade Elevations
N. End N. Appr. Pav't.	344+06.55	20.42	590.04
A	344+16.55	20.42	589.99
B	344+26.55	20.42	589.94
S. End of N. Appr. Pav't.	344+36.55	20.42	589.89

**NORTH APPROACH
TOP OF SLAB ELEVATIONS
F.A.P. ROUTE 308 - SECTION 109BR-5
WHITESIDE COUNTY
STATION 344+76.69
STRUCTURE NO. 098-0114**

DESIGNED	Dewey H. Coultas
CHECKED	Stephen M. Ryan
DRAWN	BECKY M. LEACH
CHECKED	DHC/SMR

September 2, 2008
 EXAMINED *Thomas J. Demasaliki*
 PASSED *Ronald E. Anderson*
 ENGINEER OF BRIDGES AND STRUCTURES