

FAS RTE	SECTION	COUNTY	TOTAL SHEETS	SHEET NO.
338	34BR	IROQUOIS	49	19
STA. 2141+00		TO STA. 2157+00		
FED. ROAD DIST. NO.		ILLINOIS	FED. AID PROJECT	

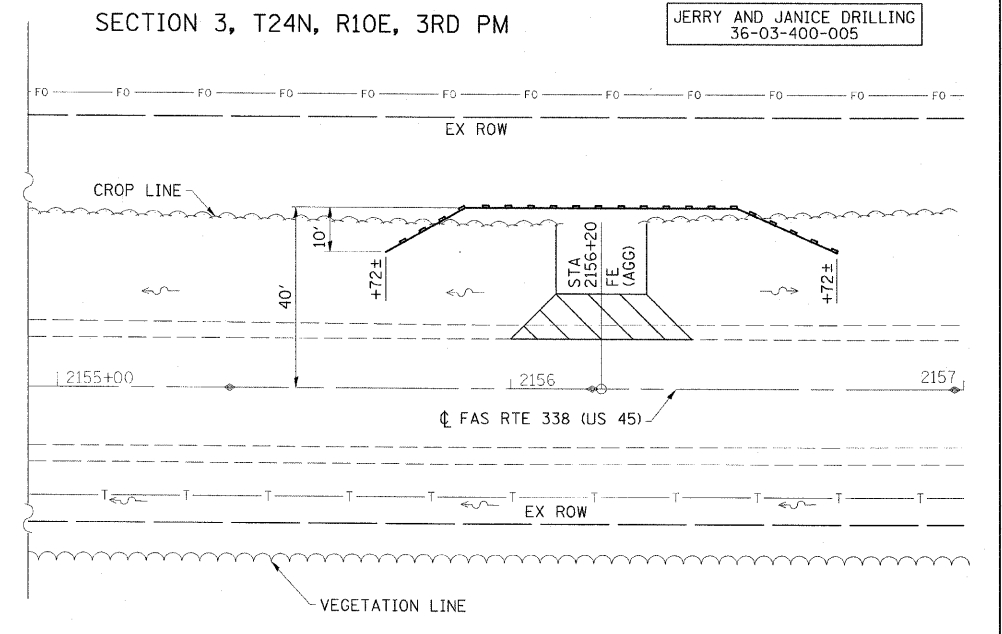
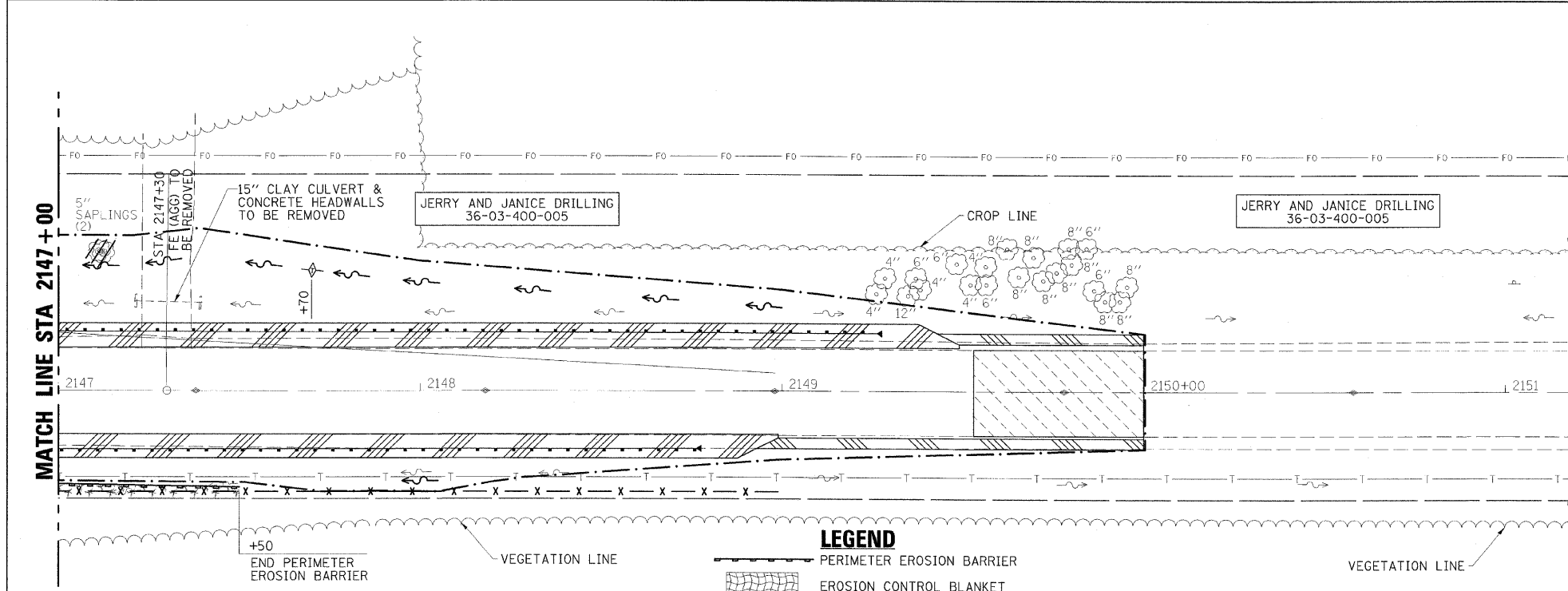
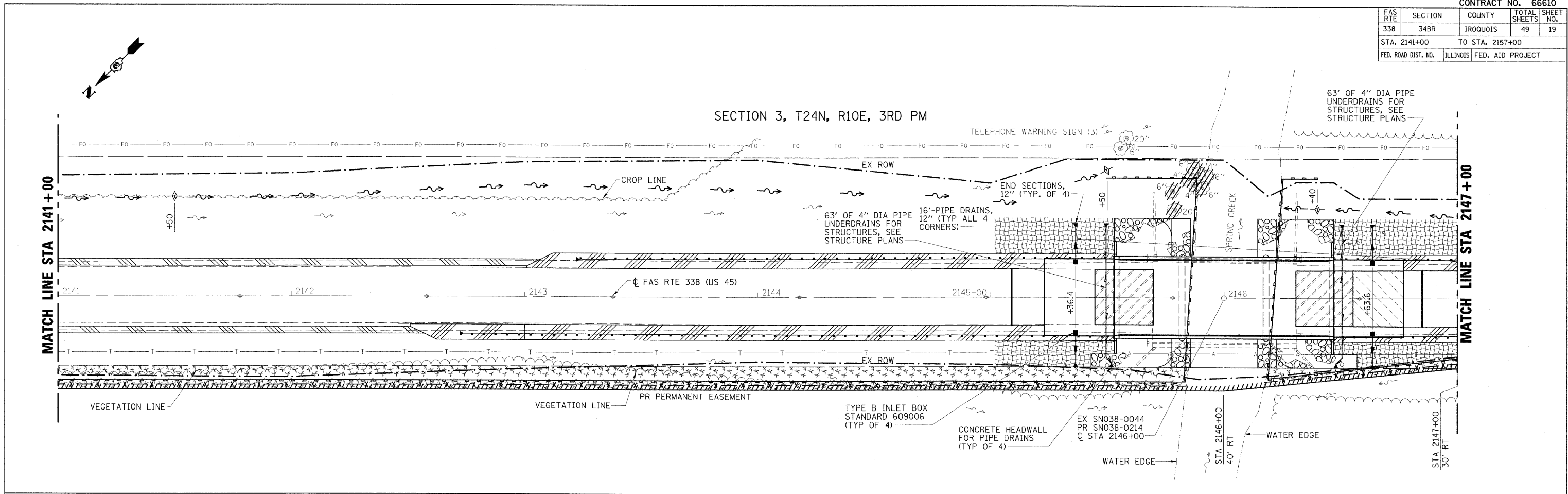

- LEGEND**
- PERIMETER EROSION BARRIER
 - EROSION CONTROL BLANKET
 - EXISTING DITCH FLOW
 - PROPOSED DITCH FLOW
 - CONSTRUCTION LIMITS
 - TEMPORARY DITCH CHECK
 - CLASS 7 MODIFIED SEEDING
 - HIGH VISIBILITY TEMPORARY FENCING

ESCA
CONSULTANTS, INC.

DESIGNED BY:	ELH	11/05
DRAWN BY:	CJG	12/05
CHECKED BY:	ELH	04/06
APPROVED BY:	RDP	04/06

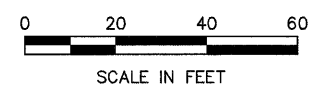

**EROSION CONTROL
AND DRAINAGE PLAN**
FAS ROUTE 338 (US 45)
SECTION 34BR
IROQUOIS COUNTY