

STATE OF ILLINOIS
 DEPARTMENT OF PUBLIC WORKS & BUILDINGS
 DIVISION OF HIGHWAYS

ITEM	QUANTITY	UNIT	TOTAL	SHEET NO.	TOTAL SHEETS
25	1	Sheet	24	15	7 SHEETS

ROUTE NO.	SECTION	COUNTY	TOTAL SHEETS	SHEET NO.
FAS 338	34BR	IRROQUOIS	49	39

CONTRACT NO. 66610

3.5.1. Top Mt. Wing, Elev. 110.0,
 Existing Structure: R.C. thru Girder 1 Span @ 99'-0"
 Rdyg. 15' R.C. Class. Abut. Superstructure to be
 removed by Contractor. Abutments to be left
 intact so they can be extended.
 81.6 Cu. Yds. Concrete in Exist. Super.

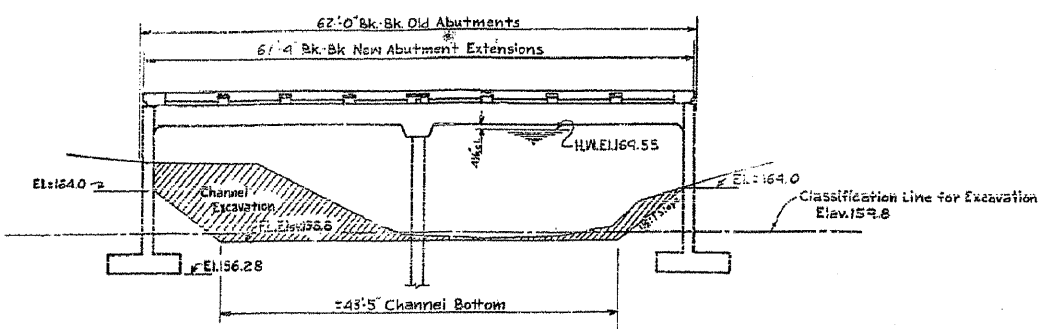

ELEVATION

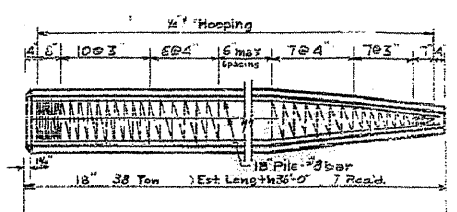

DETAIL OF PRECAST CONCRETE PILES

Note: Spiral Hooping May be Struct. Grade Steel

GENERAL NOTES

Class X Concrete shall be used thru-out, except as noted.
 Concrete floor slab shall be finished in accordance with Art. 26.4 of the Standard Specs. and shall be poured in one continuous operation on either side of the center joint. The falsework on one side of the center joint shall not be removed until after the slab is poured on the other side of the center joint.
 Handrail concrete shall be used in rail and posts.
 Handrail shall not be poured until falsework has been removed.
 One test pile shall be driven in permanent pile location as directed by the Engineer, before casting piles.
 The contract unit price each for "Expansion Bolts" shall include furnishing, drilling holes and setting Expansion Bolts.
 Contractor shall excavate channel to the cross section shown for a distance of 50' upstream and 50' downstream of E. of Roadway.
 For waterproofing, see Special Provisions.

STA. 2146+00
 BUILT 1952 BY
 STATE OF ILLINOIS
 S.B.I. RTE. 25 SEC. 34-B-Y
 H.A. PROJ. F.I. 29(12)
 LOADING H20-S16

LETTERING FOR NAME &
 See Std. 1881

WATERWAY INFORMATION

Drainage Area	2100 Acres
Character	Level, Cultivated
Opening Req'd (C. 2 Tailor)	343 Sq. Ft.
Present Opening	392 Sq. Ft.
Proposed Opening	579 Sq. Ft.

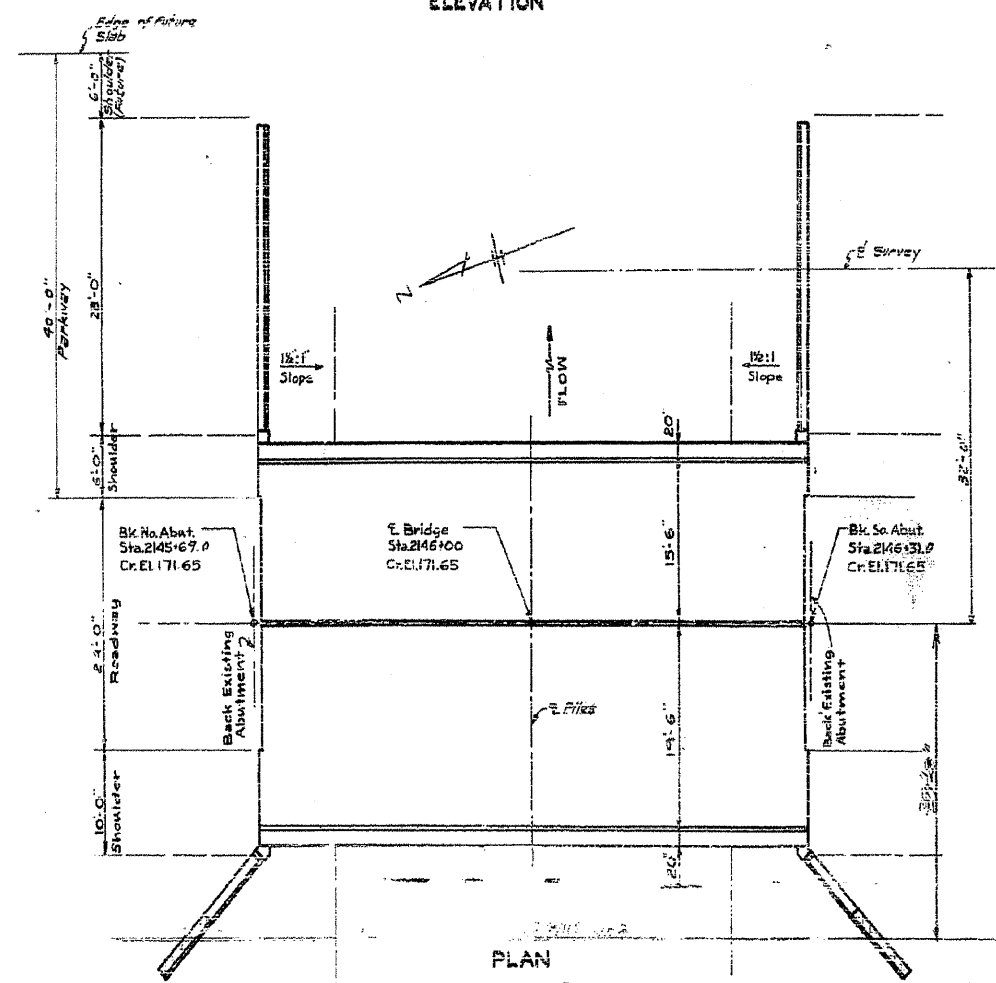

PLAN

TOTAL BILL OF MATERIAL

ITEM	SUPER	SUBSTR.	TOTAL
Class X Concrete	128.9	(117.0)	245.9
Handrail Concrete	2.7		2.7
Reinforcement Bars	25990	5740	31730
Expansion Bolts		24	24
Channel Excavation			624
Class B Excavator Str.			90
Test Piles			One
Removal of Exst. Superstr.			One
Name Plate			One

Bit. Conc. Surface Course 2-11	Yds. 20		
Temporary Bridge Complete	Each 1		
Removal of Temp. Bridge	Each 1		
Transferring Temp. Bridge	Lump Sum		

STRESSES

f_s = 20000 lbs./sq. in.
 f_c = 1400 lbs./sq. in.
 f_c = 1200 lbs./sq. in.
 n = 10

GENERAL PLAN & ELEVATION
 PROJ. F.I. 29 (12)
 H.A. RTE. 25 (S.B.I. RTE. 25) SEC. 34-B-Y
 IRROQUOIS COUNTY
 STA. 2146+00

DESIGNED: *W. B. Harrison*
 CHECKED: *W. B. Harrison*
 DRAWN: *W. B. Harrison*
 EXAMINED: *W. B. Harrison*
 PASSED: *W. B. Harrison*
 APPROVED: *F. M. Barber*

H20-516-44