

FAS RTE	SECTION	COUNTY	TOTAL SHEETS	SHEET NO.
338	34BR	IROQUOIS	49	48
STA. 2149+00		TO STA. 2155+00		
FED. ROAD DIST. NO.	ILLINOIS	FED. AID PROJECT		

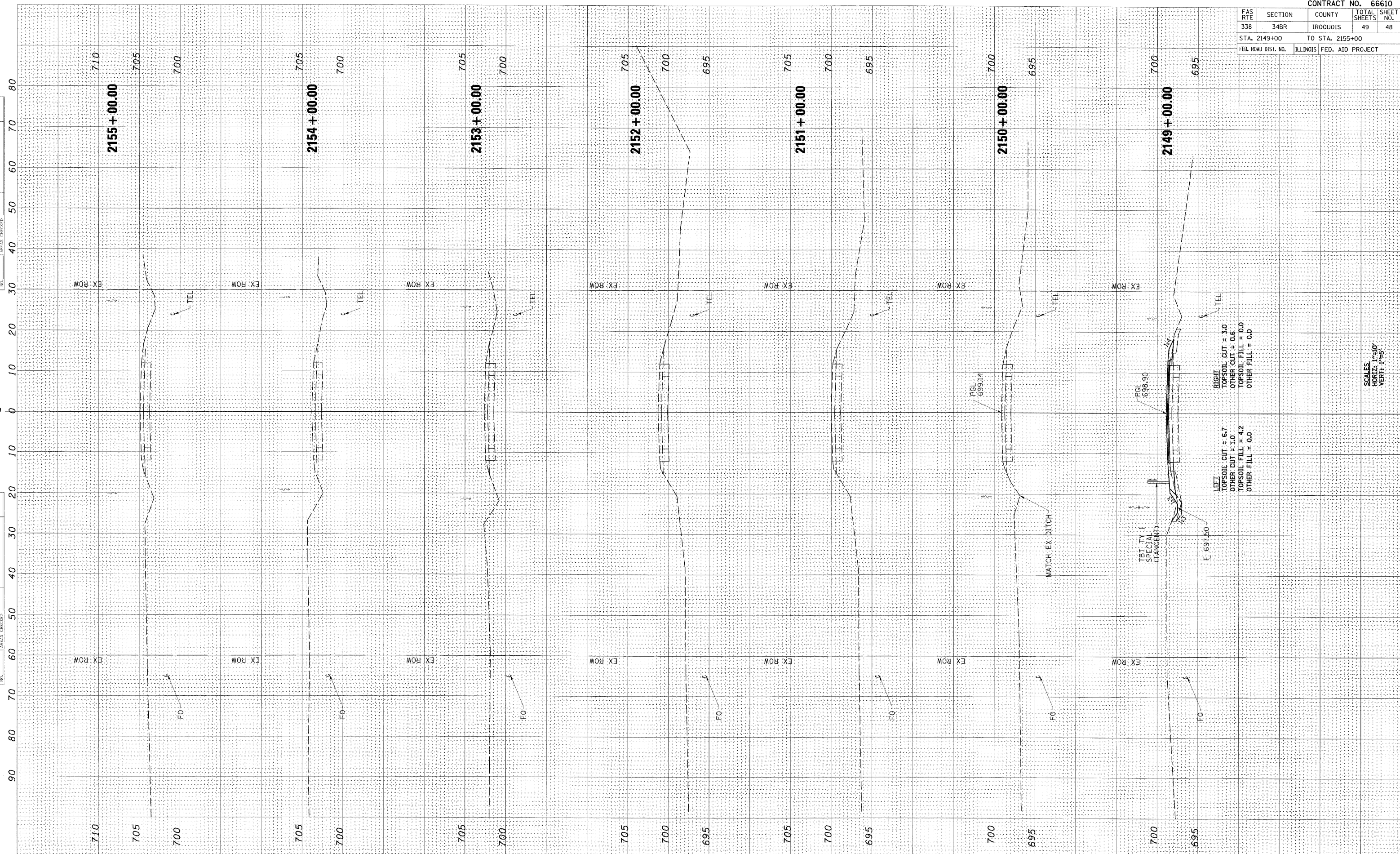

LEFT
TOPSOIL CUT = 6.7
OTHER CUT = 1.0
TOPSOIL FILL = 4.2
OTHER FILL = 0.0

RIGHT
TOPSOIL CUT = 3.0
OTHER CUT = 0.6
TOPSOIL FILL = 0.0
OTHER FILL = 0.0

SCALES
HORIZ: 1"=10'
VERT: 1"=5'

FAS RTE 338 (US 45) CROSS SECTION
STA 2149+00 TO STA 2155+

FINAL SURVEY	SURVEYED	BY	DATE
NOTE BOOK	PLOTTED		
NO.	TEMPLATE		
	AREAS CHECKED		

ORIGINAL SURVEY	SURVEYED	BY	DATE
NOTE BOOK	PLOTTED		
NO.	TEMPLATE		
	AREAS CHECKED		