

**EXISTING STRUCTURE**

THE EXISTING STRUCTURE CONSISTS OF A 3 SPAN CONTINUOUS CONCRETE SLAB W/SOLID FACE PIERS ON SPREAD FOOTINGS W/TIMBER PILING.

IT HAS A 98'-2" BACK TO BACK ABUTMENT LENGTH ALONG C OF ROADWAY. THE STRUCTURE IS TO REMAIN IN PLACE WITH PROPOSED REPAIRS.

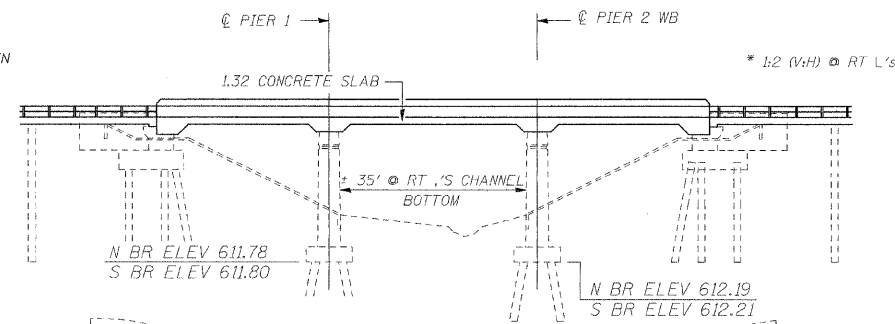

**ELEVATION**

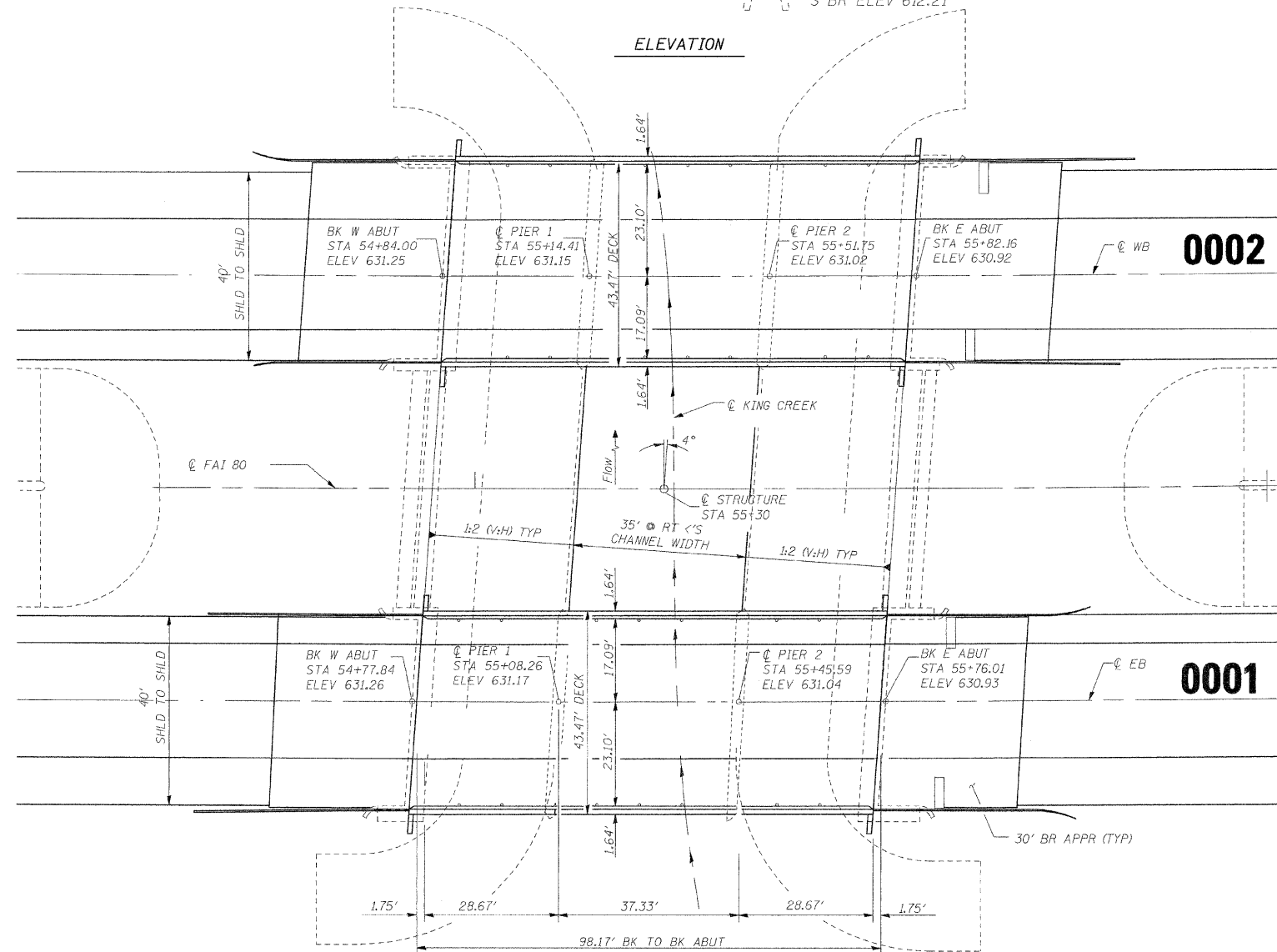

**PLAN**

**GENERAL NOTES**

- 1.) PLAN DIMENSIONS AND DETAILS RELATIVE TO EXISTING PLANS ARE SUBJECT TO ROUTINE VARIATION. THE CONTRACTOR SHALL FIELD VERIFY EXISTING DIMENSIONS AND DETAILS AFFECTING NEW CONSTRUCTION AND MAKE NECESSARY APPROVED ADJUSTMENTS PRIOR TO CONSTRUCTION OR ORDERING OF MATERIALS. SUCH VARIATIONS SHALL NOT BE CAUSE FOR ADDITIONAL COMPENSATION FOR A CHANGE IN SCOPE OF THE WORK, HOWEVER, THE CONTRACTOR WILL BE PAID FOR THE QUANTITY ACTUALLY FURNISHED BASED UPON THE UNIT PRICE BID FOR THE WORK.
- 2.) LAYOUT OF THE SLOPE PROTECTION SYSTEM MAY BE VARIED TO SUIT GROUND CONDITIONS IN THE FIELDS AS DIRECTED BY THE ENGINEER.

**PROPOSED WORK**

- 1.) CHANNEL EXCAVATION
- 2.) PLACEMENT OF SCOUR COUNTERMEASURE

**EXISTING CONDITIONS**

(TO BE USED FOR BLOCK DESIGN)  
 STREAM SLOPE 14.5 FT/MILE  
 MAX DESIGN VELOCITY 4 FT / SEC  
 SHEAR STRESS OF EXISTING SOIL 0.25 TONS/SQ FT

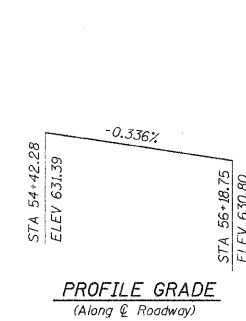

**PROFILE GRADE**  
(Along C Roadway)

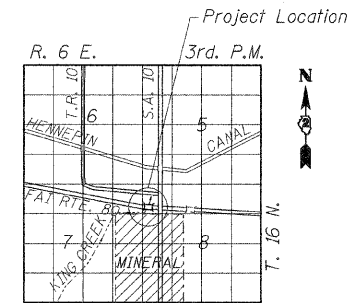

**LOCATION SKETCH**  
(NTS)

TOTAL BILL OF MATERIALS		
ITEM	UNIT	TOTAL
ARTICULATED BLOCK REVETMENT MAT	SQ YDS	975
GEOTECHNICAL FABRIC (SPECIAL)	SO YDS	946
CHANNEL EXCAVATION	CU YDS	986
BEDDING MATERIAL (SPECIAL)	CU YDS	173
SLOPE WALL REMOVAL	SO YDS	142

**GENERAL PLAN & ELEVATION**

FAI ROUTE 80 OVER KING CREEK  
 SECTION 06-1BR  
 BUREAU COUNTY  
 STATION 55+30  
 SN 006-0001 EB  
 SN 006-0002 WB

2 - REVISED 10/27/08, HJL

FILE NAME =	USER NAME = braboypc	DESIGNED -	REVISED -	<b>STATE OF ILLINOIS DEPARTMENT OF TRANSPORTATION</b>	<b>PR SN 006-0001 &amp; 006-0002</b>	F.A.I. RTE.	SECTION	COUNTY	TOTAL SHEETS	SHEET NO.	
et:\pwork\PIWIDOT\BRABOYPC\dms32763\dms32763.dgn		DRAWN -	REVISED -			80	(06-1)RS-3, 1	BUREAU	116	41	
PLOT SCALE = 1/4" = 1' IN.		CHECKED -	REVISED -			SCALE: _____ SHEET NO. OF SHEETS STA. TO STA.		CONTRACT NO. 66623			
PLOT DATE = Oct 27, 2008 - 08:46:54 AM		DATE -	REVISED -			FED. ROAD DIST. NO. - ILLINOIS FED. AID PROJECT					

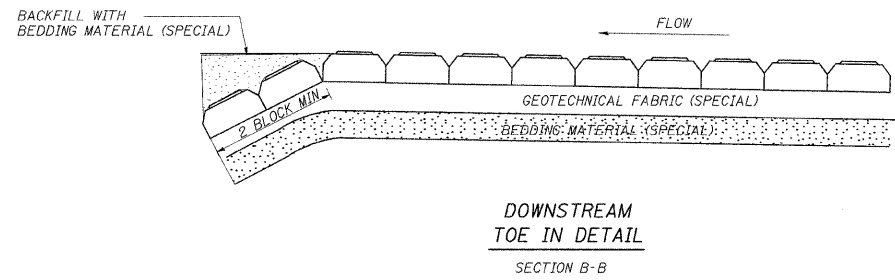
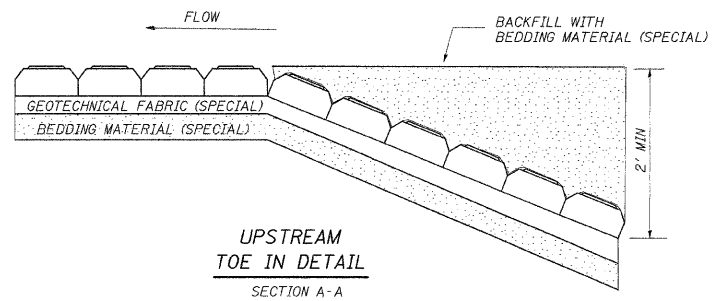
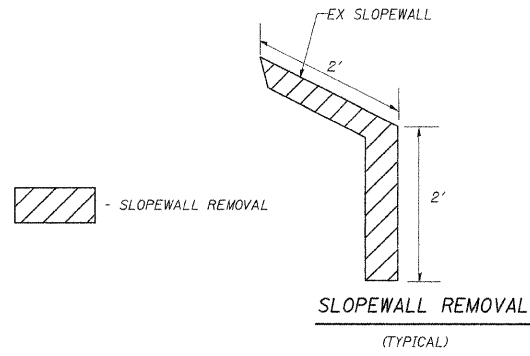

NOTE: THIS DETAIL SHOULD BE UTILIZED ON THE AREAS WHERE SLOPEWALL CONNECTION IS NOT POSSIBLE DUE TO THE EXISTING CONFIGURATIONS UNLESS OTHERWISE NOTED.

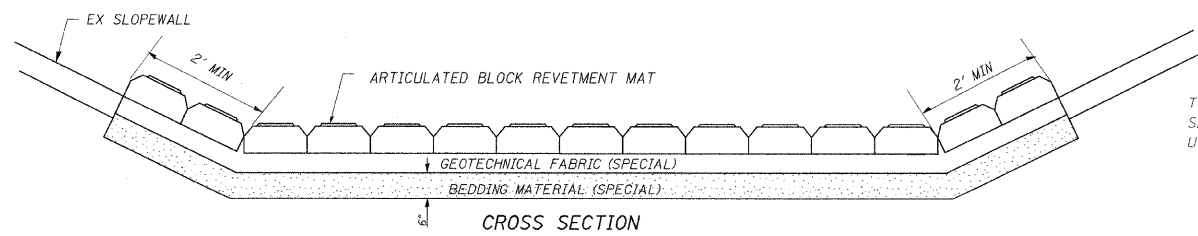

NOTE: THE GAP BETWEEN THE EXISTING SLOPEWALL, PIERS, AND ARTICULATED BLOCK REVETMENT MAT SHOULD BE CLEANED, FREE OF DEBRIS AND FILLED WITH GROUT MATERIAL WITH A MIN 4000 PST

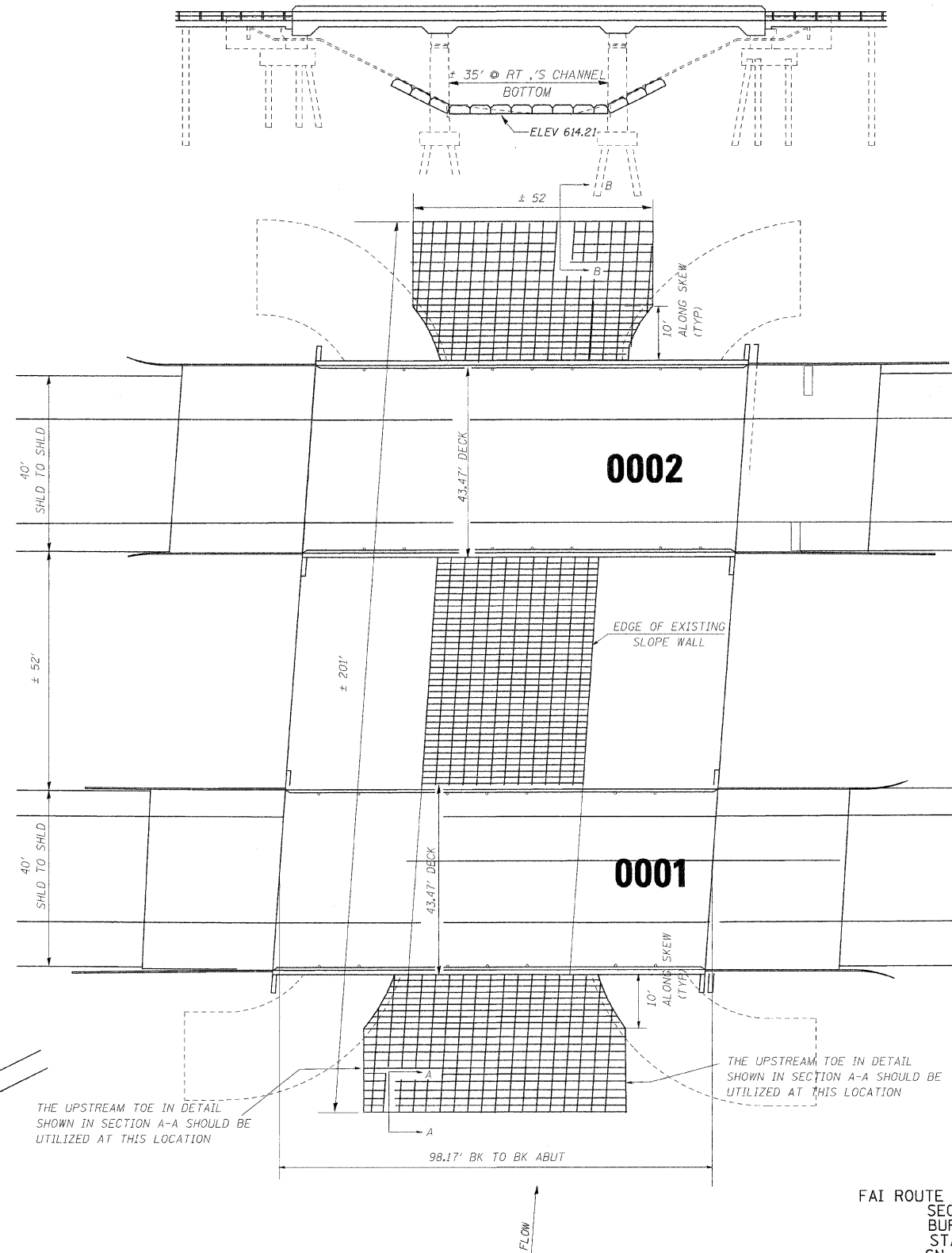

THE UPSTREAM TOE IN DETAIL SHOWN IN SECTION A-A SHOULD BE UTILIZED AT THIS LOCATION

THE UPSTREAM TOE IN DETAIL SHOWN IN SECTION A-A SHOULD BE UTILIZED AT THIS LOCATION

FAI ROUTE 80 OVER KING CREEK  
SECTION 06-1BR  
BUREAU COUNTY  
STATION 55+30  
SN 006-0001 EB  
SN 006-0002 WB

ENTIRE SHEET REVISED 10/27/08, HJL

FILE NAME = c:\pwwork\pkid\DOT\BRABOYPC\dms32763\de	USER NAME = braboypc	DESIGNED - ---	REVISED - ---
atl.s.dgn		DRAWN - ---	REVISED - ---
PLOT SCALE = 1/8" = 1' IN.	CHECKED - ---	REVISED - ---	REVISED - ---
PLOT DATE = Oct 27, 2008 - 08:47:24 AM	DATE - ---	REVISED - ---	REVISED - ---

STATE OF ILLINOIS  
DEPARTMENT OF TRANSPORTATION

PR SN 006-0001 & 006-0002

SCALE: \_\_\_\_\_ SHEET NO. \_\_\_\_ OF \_\_\_\_ SHEETS STA. \_\_\_\_\_ TO STA. \_\_\_\_\_

F.A.I. RTE.	SECTION	COUNTY	TOTAL SHEETS	SHEET NO.
80	(06-1,2)RS-3, 1	BUREAU	116	42
CONTRACT NO. 66623			FED. ROAD DIST. NO. _____ ILLINOIS FED. AID PROJECT	

**EXISTING STRUCTURE**

THE EXISTING STRUCTURE CONSISTS OF A 3 SPAN CONTINUOUS CONCRETE SLAB W/SOLID FACE PIERS ON SPREAD FOOTINGS W/TIMBER PILING.

IT HAS A 73'-6" BACK TO BACK ABUTMENT LENGTH. THE STRUCTURE IS TO REMAIN IN PLACE WITH PROPOSED REPAIRS.

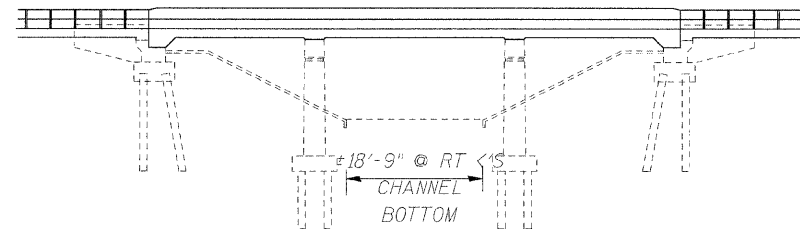

**ELEVATION**

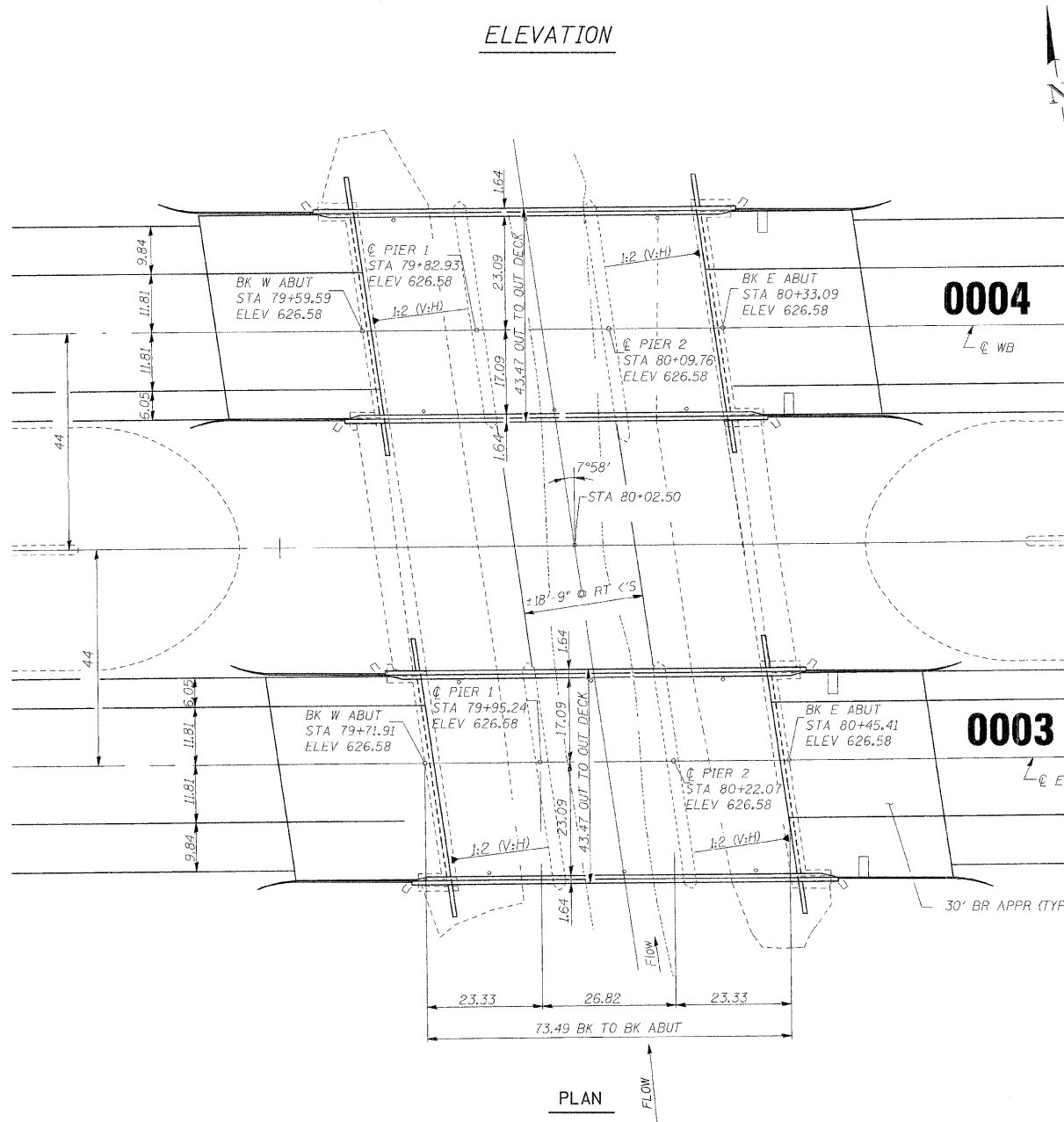

**PLAN**

**GENERAL NOTES**

- 1.) PLAN DIMENSIONS AND DETAILS RELATIVE TO EXISTING PLANS ARE SUBJECT TO ROUTINE VARIATION. THE CONTRACTOR SHALL FIELD VERIFY EXISTING DIMENSIONS AND DETAILS AFFECTING NEW CONSTRUCTION AND MAKE NECESSARY APPROVED ADJUSTMENTS PRIOR TO CONSTRUCTION OR ORDERING OF MATERIALS. SUCH VARIATIONS SHALL NOT BE CAUSE FOR ADDITIONAL COMPENSATION FOR A CHANGE IN SCOPE OF THE WORK, HOWEVER, THE CONTRACTOR WILL BE PAID FOR THE QUANTITY ACTUALLY FURNISHED BASED UPON THE UNIT PRICE BID FOR THE WORK.
- 2.) LAYOUT OF THE SLOPE PROTECTION SYSTEM MAY BE VARIED TO SUIT GROUND CONDITIONS IN THE FIELDS AS DIRECTED BY THE ENGINEER.

**PROPOSED WORK**

- 1.) CHANNEL EXCAVATION
- 2.) PLACEMENT OF SCOUR COUNTERMEASURE

**EXISTING CONDITIONS**

(TO BE USED FOR BLOCK DESIGN)  
 STREAM SLOPE 14.5 FT/MILE  
 MAX DESIGN VELOCITY 6 FT/SEC  
 SHEAR STRESS OF EXISTING SOIL 0.14 TONS/SQ FT

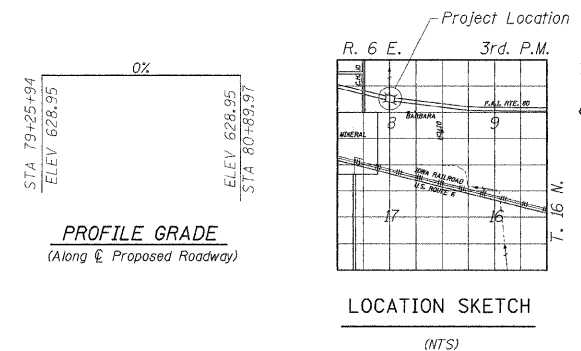

**PROFILE GRADE**  
(Along E Proposed Roadway)

TOTAL BILL OF MATERIALS		
ITEM	UNIT	TOTAL
ARTICULATED BLOCK REVETMENT MAT	50 YDS	591
GEOTECHNICAL FABRIC (SPECIAL)	50 YDS	536
CHANNEL EXCAVATION	CU YDS	638
BEDDING MATERIAL (SPECIAL)	CU YDS	136
SLOPE WALL REMOVAL	50 YDS	144

**GENERAL PLAN & ELEVATION**

FAI ROUTE 80 OVER BARBARA DITCH  
 SECTION 06-1B-1R  
 BUREAU COUNTY  
 STATION 80+02.50  
 SN 006-0003 EB  
 SN 006-0004 WB

REVISOR - REVISED 10/27/08. HJL

FILE NAME = c:\pwworkspace\FWIDOT\BRASOYPC\dms32763\dms32763.dgn	USER NAME = braboypc	DESIGNED -	REVISED -	<b>STATE OF ILLINOIS DEPARTMENT OF TRANSPORTATION</b>	<b>STAGE I TYPICAL SECTION</b>	F.A.I. RTE. 80	SECTION (06-1,2)RS-3, 1	COUNTY BUREAU	TOTAL SHEETS 116	SHEET NO. 43		
PLOT SCALE = 1/4" = 1' IN.	CHECKED -	REVISED -	SCALE: _____			SHEET NO. ____ OF ____ SHEETS	STA. _____ TO STA. _____	CONTRACT NO. 66623				
PLOT DATE = Oct 27, 2008 - 08:47:44 AM	DATE -	REVISED -	FED. ROAD DIST. NO. _ ILLINOIS FED. AID PROJECT									

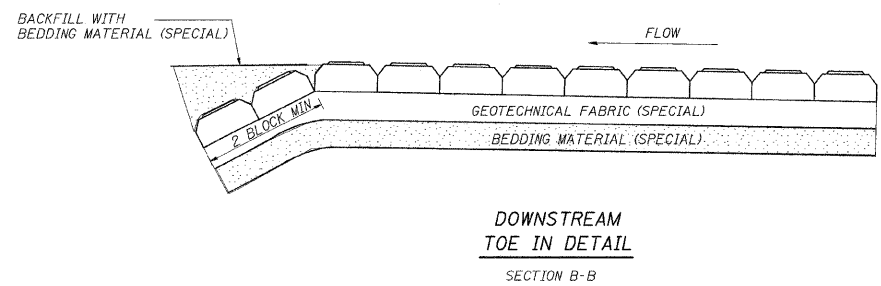
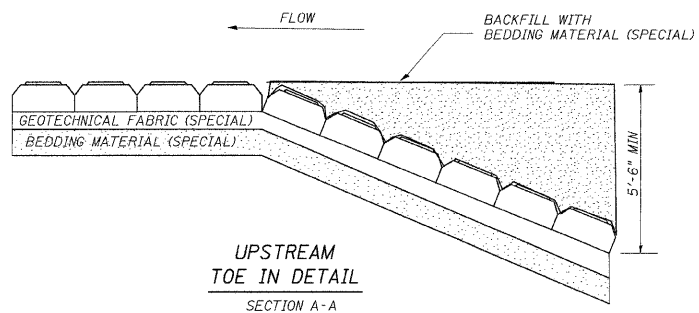
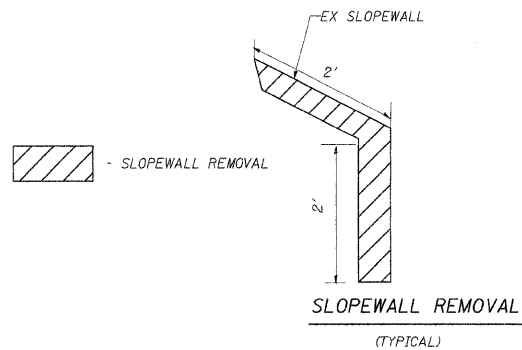

NOTE: THIS DETAIL SHOULD BE UTILIZED ON THE AREAS WHERE SLOPEWALL CONNECTION IS NOT POSSIBLE DUE TO EXISTING CONFIGURATIONS UNLESS OTHERWISE NOTED.

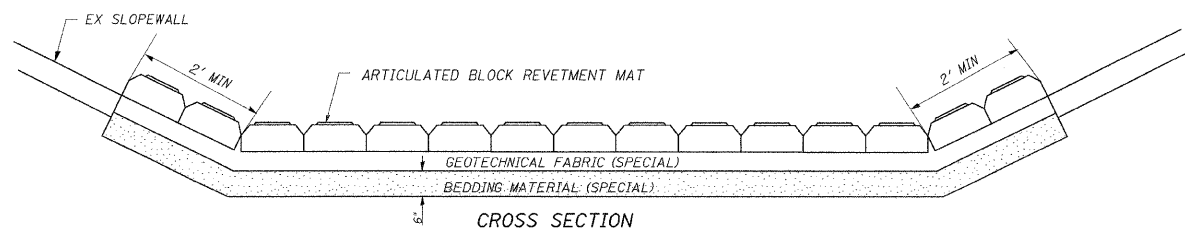

NOTE: THE GAP BETWEEN THE EXISTING SLOPEWALL, PIERS, AND ARTICULATED BLOCK REVETMENT MAT SHOULD BE CLEANED, FREE OF DEBRIS AND FILLED WITH GROUT MATERIAL WITH A MIN 4000 PSI

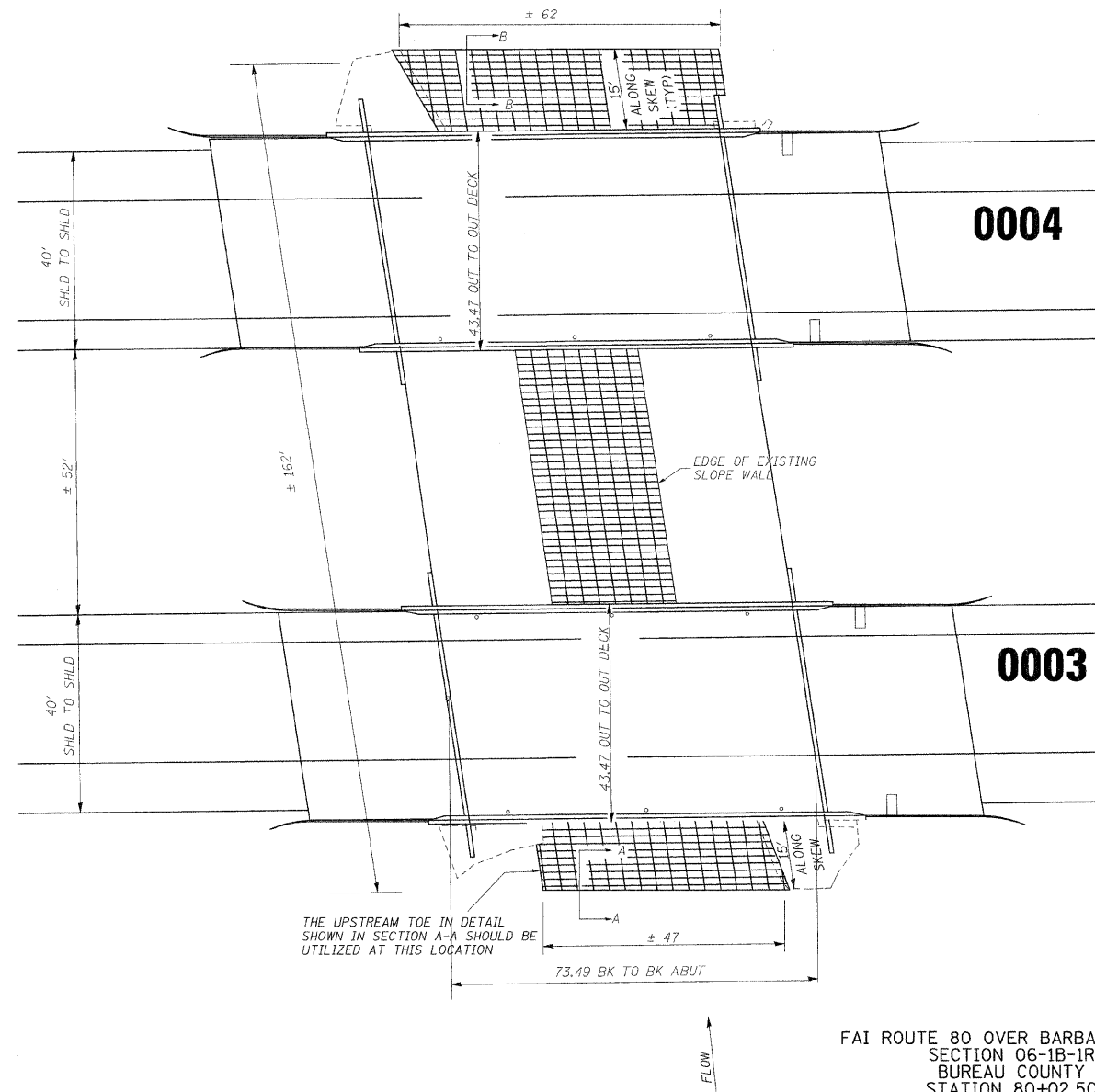
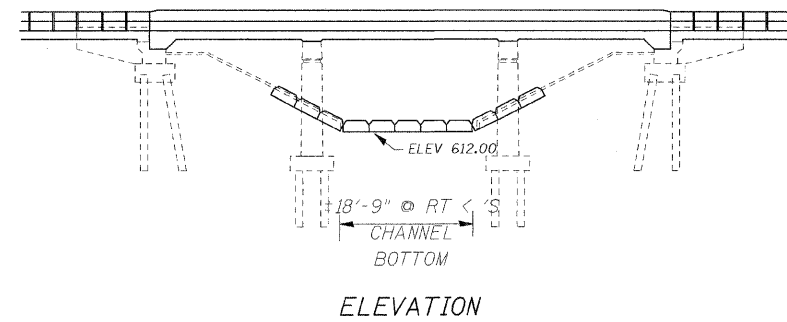

THE UPSTREAM TOE IN DETAIL SHOWN IN SECTION A-A SHOULD BE UTILIZED AT THIS LOCATION

FAI ROUTE 80 OVER BARBARA DITCH  
SECTION 06-1B-1R  
BUREAU COUNTY  
STATION 80+02.50  
SN 006-0003 EB  
SN 006-0004 WB

ENTIRE SHEET REVISED 10/27/08, HUL

FILE NAME =	USER NAME = lbraboypc	DESIGNED -	REVISED -
cr:\pwork\p\1\DOT\BRABOYPC\dms32763\do	as1s.dgn	DRAWN -	REVISED -
	PLOT SCALE = 1/8" = 1' IN.	CHECKED -	REVISED -
	PLOT DATE = Oct 27, 2008 - 08:48:02 AM	DATE -	REVISED -

STATE OF ILLINOIS  
DEPARTMENT OF TRANSPORTATION

STAGE I TYPICAL SECTION

SCALE: \_\_\_\_\_ SHEET NO. \_\_\_\_ OF \_\_\_\_ SHEETS STA. \_\_\_\_\_ TO STA. \_\_\_\_\_

F.A.I. RTE.	SECTION	COUNTY	TOTAL SHEETS	SHEET NO.
80	(06-1,2)RS-3, 1	BUREAU	116	44
CONTRACT NO. 66623				
FED. ROAD DIST. NO. _____ ILLINOIS FED. AID PROJECT				

**EXISTING STRUCTURE**

THE EXISTING STRUCTURE CONSISTS OF A 3 SPAN CONTINUOUS CONCRETE SLAB W/SOLID FACE PIERS ON SPREAD FOOTINGS W/TIMBER PILING.

IT HAS A 116'-0" BACK TO BACK ABUTMENT LENGTH. THE STRUCTURE IS TO REMAIN IN PLACE WITH PROPOSED REPAIRS.

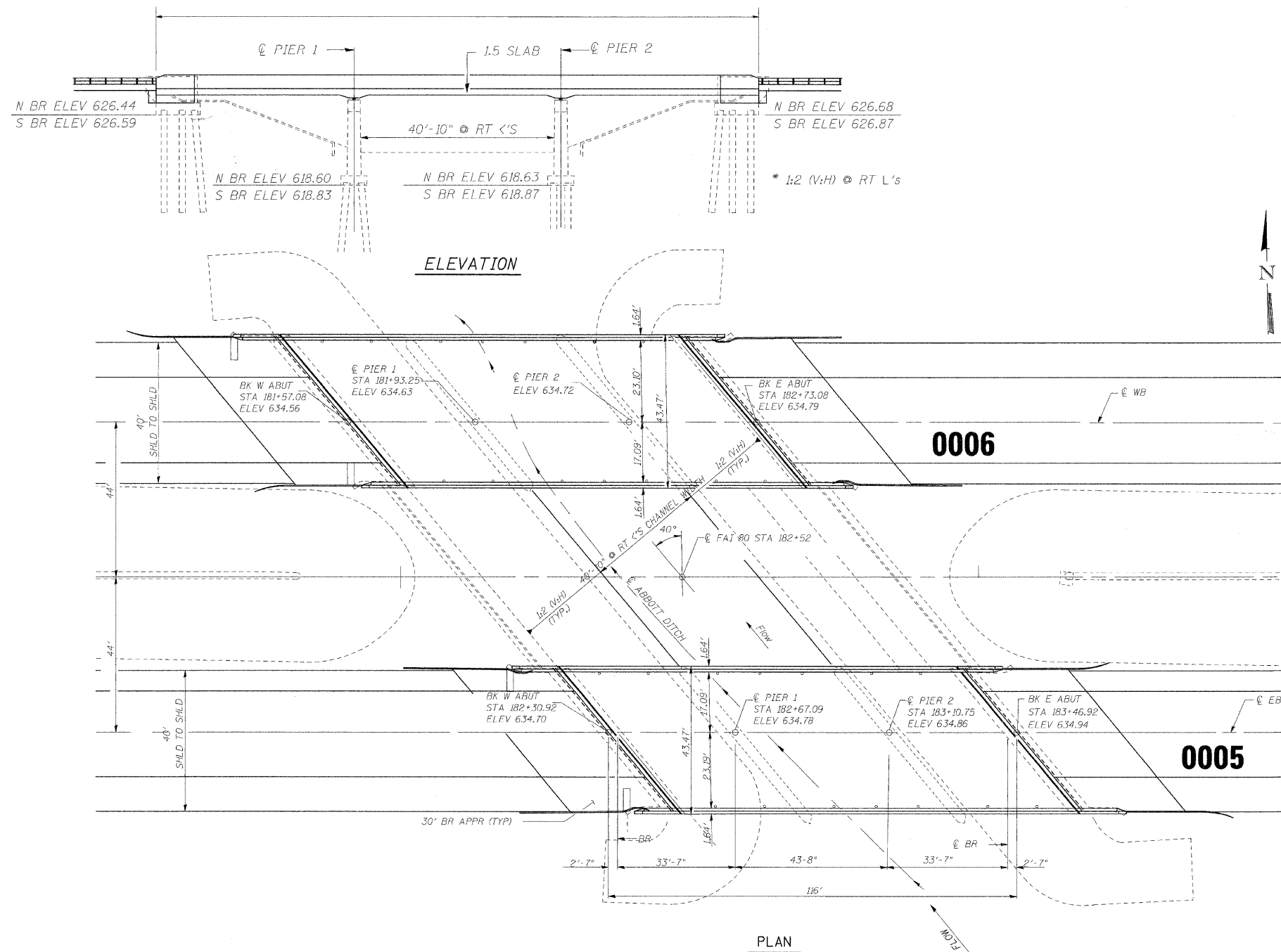

**GENERAL NOTES**

1.) PLAN DIMENSIONS AND DETAILS RELATIVE TO EXISTING PLANS ARE SUBJECT TO ROUTINE VARIATION. THE CONTRACTOR SHALL FIELD VERIFY EXISTING DIMENSIONS AND DETAILS AFFECTING NEW CONSTRUCTION AND MAKE NECESSARY APPROVED ADJUSTMENTS PRIOR TO CONSTRUCTION OR ORDERING OF MATERIALS. SUCH VARIATIONS SHALL NOT BE CAUSE FOR ADDITIONAL COMPENSATION FOR A CHANGE IN SCOPE OF THE WORK, HOWEVER, THE CONTRACTOR WILL BE PAID FOR THE QUANTITY ACTUALLY FURNISHED BASED UPON THE UNIT PRICE BID FOR THE WORK.

2.) LAYOUT OF THE SLOPE PROTECTION SYSTEM MAY BE VARIED TO SUIT GROUND CONDITIONS IN THE FIELDS AS DIRECTED BY THE ENGINEER.

**PROPOSED WORK**

- 1.) CHANNEL EXCAVATION
- 2.) PLACEMENT OF SCOUR COUNTERMEASURE

**EXISTING CONDITIONS**

(TO BE USED FOR BLOCK DESIGN)  
 STREAM SLOPE 14.5 FT/MILE  
 MAX DESIGN VELOCITY 6 FT / SEC  
 SHEAR STRESS OF EXISTING SOIL 0.19 TONS/SQ FT

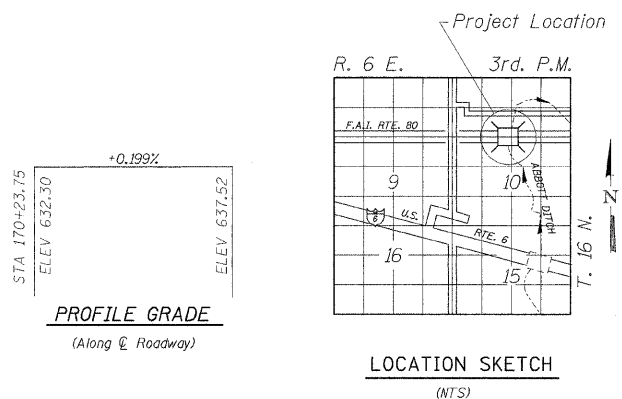

TOTAL BILL OF MATERIALS		
ITEM	UNIT	TOTAL
ARTICULATED BLOCK REVETMENT MAT	SQ YDS	1289
GEOTECHNICAL FABRIC (SPECIAL)	SQ YDS	1251
CHANNEL EXCAVATION	CU YDS	1303
BEDDING MATERIAL (SPECIAL)	CU YDS	229
SLOPE WALL REMOVAL	SO YDS	180

**GENERAL PLAN & ELEVATION**

FAI ROUTE 80 OVER ABBOTT DITCH  
 SECTION 06-1B-2R  
 BUREAU COUNTY  
 STATION 182+52  
 SN 006-0005 EB  
 SN 006-0006 WB

2 - REVISED 10/27/08, HJL

FILE NAME =	USER NAME = lbraboypc	DESIGNED -	REVISED -	<b>STATE OF ILLINOIS DEPARTMENT OF TRANSPORTATION</b>	<b>STAGE I TYPICAL SECTION</b>	F.A.I. RTE.	SECTION	COUNTY	TOTAL SHEETS	SHEET NO.	
cs:\p\work\FWIDOT\BRABOYPC\dms22763\dms22763.dgn		DRAWN -	REVISED -			80	06-1,2,RS-3, I	BUREAU	116	45	
PLOT SCALE = 1/4" = 1' IN.		CHECKED -	REVISED -			SCALE: _____ SHEET NO. ___ OF ___ SHEETS STA. _____ TO STA. _____		CONTRACT NO. 66623			
PLOT DATE = Oct 27, 2008 - 08:48:23 AM		DATE -	REVISED -			FED. ROAD DIST. NO. _ ILLINOIS FED. AID PROJECT					

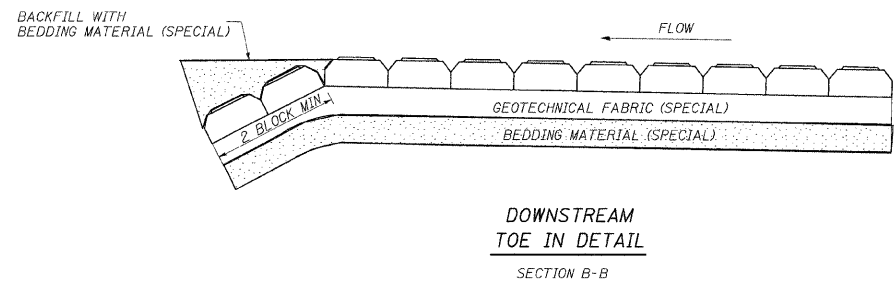
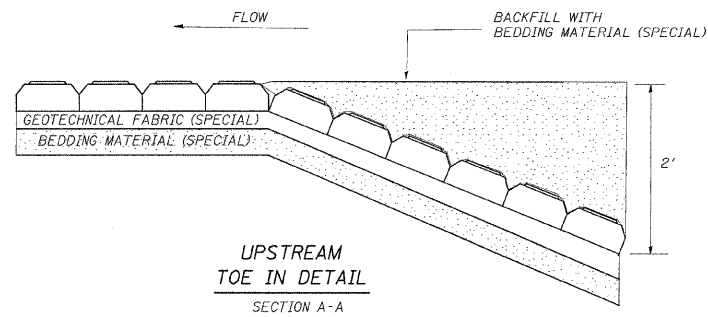
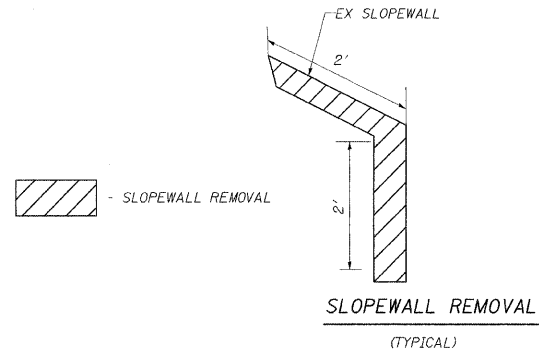

NOTE: THIS DETAIL SHOULD BE UTILIZED ON THE AREAS WHERE SLOPEWALL CONNECTION IS NOT POSSIBLE DUE TO THE EXISTING CONFIGURATIONS UNLESS OTHERWISE NOTED.

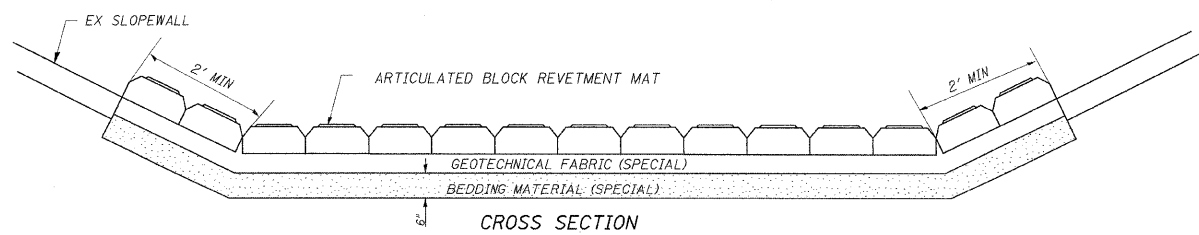

NOTE: THE GAP BETWEEN THE EXISTING SLOPEWALL, PIERS, AND ARTICULATED BLOCK REVETMENT MAT SHOULD BE CLEANED, FREE OF DEBRIS AND FILLED WITH GROUT MATERIAL WITH A MIN 4000 PSI

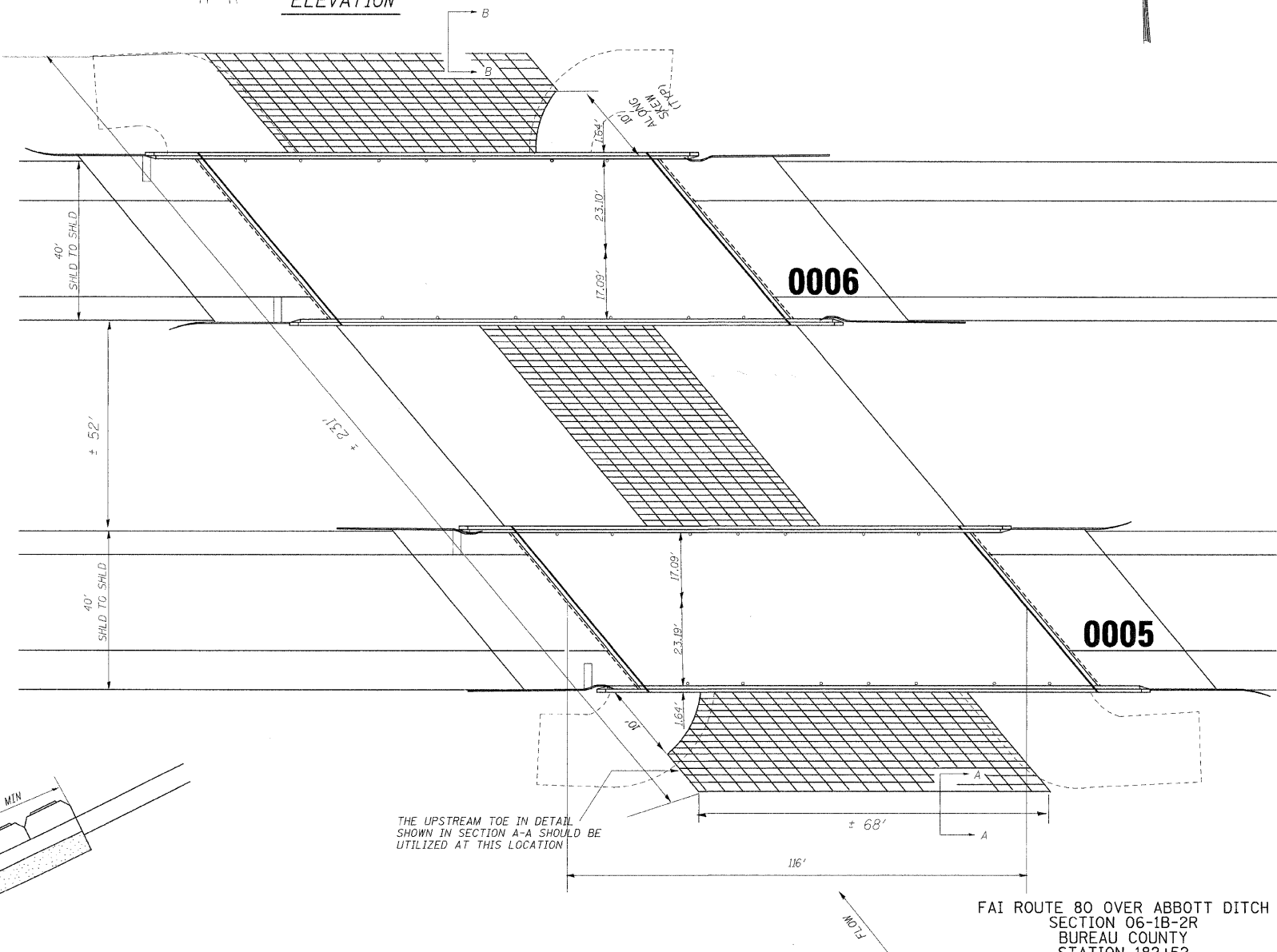
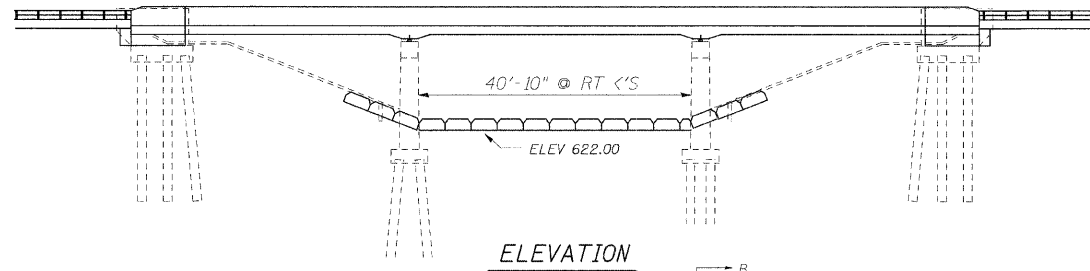

THE UPSTREAM TOE IN DETAIL SHOWN IN SECTION A-A SHOULD BE UTILIZED AT THIS LOCATION

FAI ROUTE 80 OVER ABBOTT DITCH  
SECTION 06-1B-2R  
BUREAU COUNTY  
STATION 182+52  
SN 006-0005 EB  
SN 006-0006 WB

2 - ENTIRE SHEET REVISED 10/27/08, HJL

FILE NAME =	USER NAME = lbraboypc	DESIGNED -	REVISED -
os:\pwwork\p\w\DOT\BRABOYPC\dms32763\dms32763.dgn		DRAWN -	REVISED -
		CHECKED -	REVISED -
		DATE -	REVISED -

STATE OF ILLINOIS  
DEPARTMENT OF TRANSPORTATION

STAGE I TYPICAL SECTION

SCALE: SHEET NO. OF SHEETS STA. TO STA.

F.A.I. RTE.	SECTION	COUNTY	TOTAL SHEETS	SHEET NO.
80	006-1,2RS-3, I	BUREAU	116	46
FED. ROAD DIST. NO. ILLINOIS FED. AID PROJECT			CONTRACT NO. 66623	