

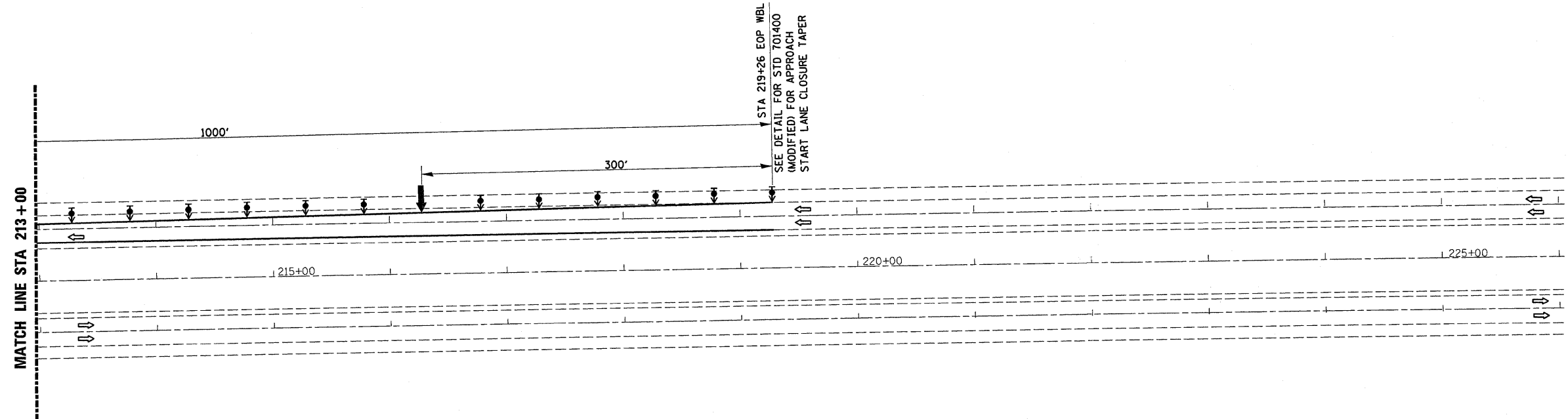







STAGE II EAST END 0007 & 0008

CONTRACT NO. 66623

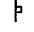
F.A.I. RTE.	SECTION	COUNTY	TOTAL SHEETS	SHEET NO.
80	06-1,2RS-3, 1	BUREAU	116	38
STA. 213+00		TO STA. 226+00		
FED. ROAD DIST. NO.		ILLINOIS FED. AID PROJECT		

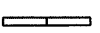

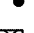
SYMBOLS

-  Arrow board
-  Work area
-  Sign
-  Direction indicator barricade with steady burn monodirectional light. (50') Centers
-  Type II barricade, drum, or vertical barricade with steady burn monodirectional light. (100') Centers
-  Temporary concrete barrier
-  Type C Monodirectional reflector. (50') Centers
-  Vertical panel with steady burn monodirectional light. (25') Centers
-  Impact attenuator

- ① Wet temporary pavement marking tape - TY III shall be placed throughout the taper and along-side the work area. The right edge line shall be white and the left edge line shall be yellow.
- ② Vertical panels at (25') centers with steady burning monodirectional lights.
- ③ SEE STD 701402 FOR DETAILS NOT SHOWN

PLOT DATE = Sep 04, 2008 - 08:28:21 AM
 FILE NAME = c:\p\work\p\06-007-008\06-007-008.dgn
 PLOT SCALE = 5/8" = 1' / IN.
 USER NAME = bdruggie

STAGE II SN 006-0007 & SN 006-0008 STA 213+00 TO STA 226+00