

STATE OF ILLINOIS  
DEPARTMENT OF TRANSPORTATION

ROUTE NO.	SECTION	COUNTY	TOTAL SHEETS	SHEET NO.	SHEET NO.
FAP 798	107 BR-1	FORD	92	81	2
FED. ROAD DIST. NO. 7		ILLINOIS	FED. AID PROJECT		

Contract # 66698

GENERAL NOTES

- Reinforcement bars shall conform to the requirements of ASTM A 706 Gr 60. See Special Provisions.
- Layout of slope protection system may be varied in the field to suit ground conditions as directed by the Engineer.
- The Contractor shall make allowance for the deflection of forms, shrinkage and settlement of falsework, in addition to allowance for dead load deflection. Forms for deck slab shall be removed prior to placement of bridge approach pavement.
- The Contractor shall drive test piles to 110% of the nominal required bearing specified in production locations at substructures specified or approved by the Engineer before ordering the remainder of piles.
- All Construction joints shall be bonded.
- Excavation behind existing abutment walls shall be done before removing the existing superstructure.
- Slipforming of parapets is not allowed.
- The steel H piles shall be according to AASHTO M270 grade 50.

TOTAL BILL OF MATERIAL

Item	Unit	Super	Sub.		Total
			Piers	Abut.	
Structure Excavation	Cu. Yd.		0	120	120
Driving Piles	Foot		260	506	766
Floor Drains	Each	8			8
Channel Excavation	Cu. Yd.			390	390
Porous Granular Embankment (Special)	Cu. Yd.			70.8	70.8
Concrete Structures	Cu. Yd.		45.5	28.3	73.8
Concrete Superstructure	Cu. Yd.	162.8			162.8
Bridge Deck Grooving	Sq. Yd.	252			252
Stone Riprap, Class A4	Sq. Yd.		527		527
Reinforcement Bars, Epoxy Coated	Pound	26690	2320	3900	32910
Furnishing Steel Piles HP 10x42	Foot		260	506	766
Test Pile Steel HP 10x42	Each		1	1	2
Filter Fabric	Sq. Yd.		527		527
Name Plates	Each	1			1
Removal of Existing Structures No. 4	Each	1			1
Protective Coat	Sq. Yd.	312			312
Geocomposite Wall Drains	Sq. Yd.			44	44
Pipe Underdrains for Structures, 4"	Foot			110	110
Underwater Structure Excavation Protection, Location 1	Each		1		1

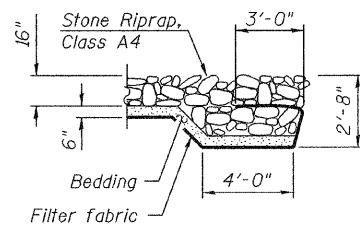

RIPRAP FLANK DETAIL

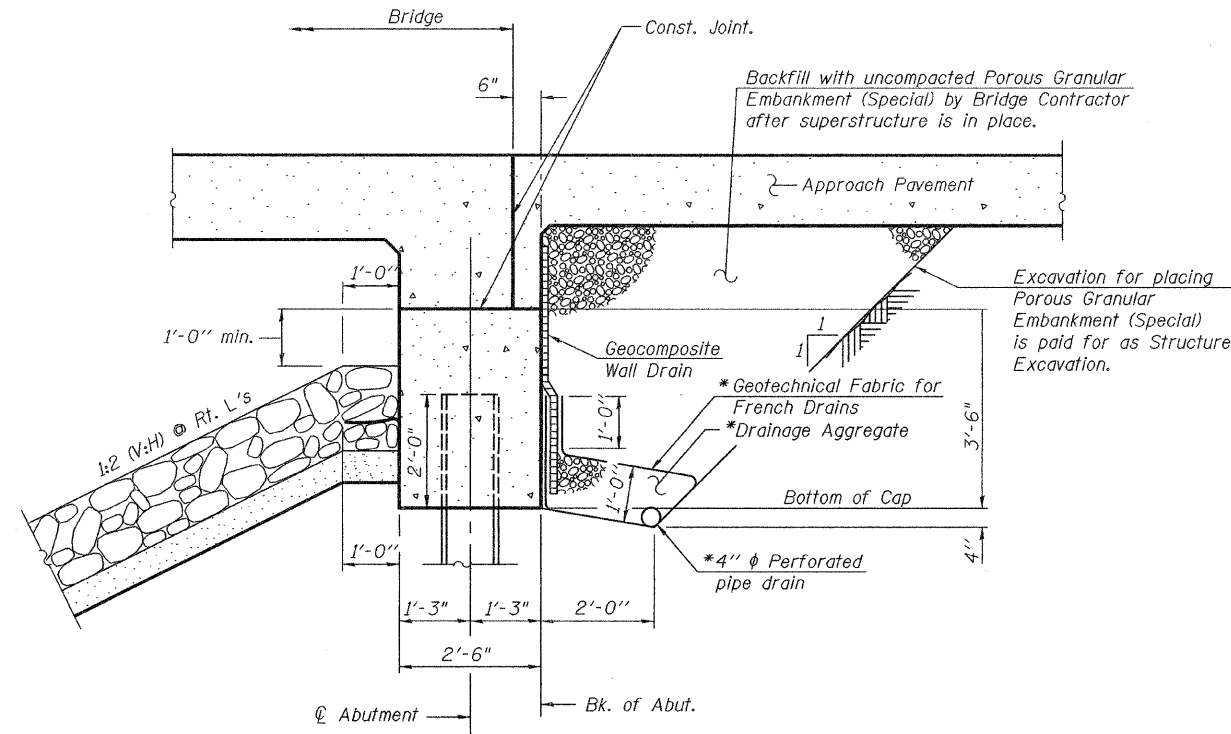

SECTION THRU INTEGRAL ABUTMENT

(Horiz. dim. @ Rt. L's)  
(Reinforcement not shown)

\* Included in the cost of Pipe Underdrains for Structures, 4".

Note:  
All drainage system components shall extend to 2'-0" from the end of each wingwall except an outlet pipe shall extend 12" beyond the end of the wingwall, turn 90°, and extend with non-perforated drain pipe until intersecting with the side slopes. The pipes shall drain into concrete headwalls \*. (See Article 601.05 of the Standard Specifications and Highway Standard 60110).

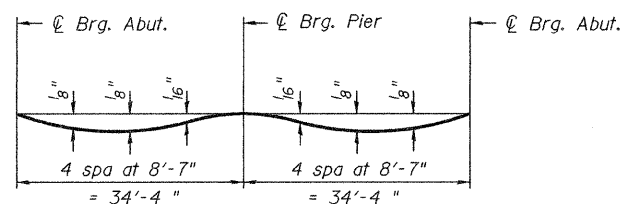

DEAD LOAD DEFLECTION DIAGRAM

(Includes weight of concrete only.)

DESIGNED	MAJ/MSJ
CHECKED	MJB
DRAWN	MSJ
CHECKED	WCC

GENERAL NOTES, DETAILS  
AND BILL OF MATERIALS  
IL RTE 115 OVER DRAINAGE DITCH  
TRIBUTARY TO NORTH VERMILLION RIVER  
FAP RTE 798 SECTION 107 BR-1  
FORD COUNTY  
STATION 178+88.00  
S.N. 027-0095