

**DETOUR MAP**  
 \*TO BE PLACED WITH INTERSTATE IDENTIFICATION SIGNS AND EXIT SIGNS.

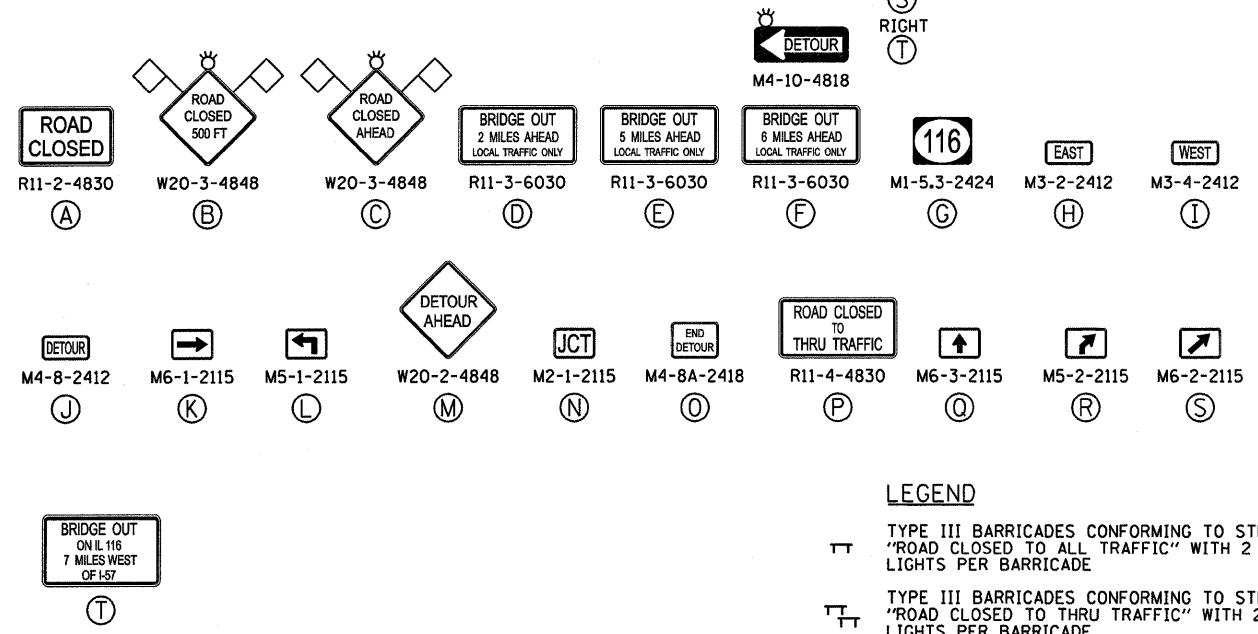

**LEGEND**

TYPE III BARRICADES CONFORMING TO STD. 702001 "ROAD CLOSED TO ALL TRAFFIC" WITH 2 FLASHING LIGHTS PER BARRICADE

TYPE III BARRICADES CONFORMING TO STD. 702001 "ROAD CLOSED TO THRU TRAFFIC" WITH 2 FLASHING LIGHTS PER BARRICADE

SIGNS ON PERMANENT SUPPORTS

FLASHING LIGHT ABOVE SIGN

18"x18" ORANGE FLAG

DETOUR ROUTE

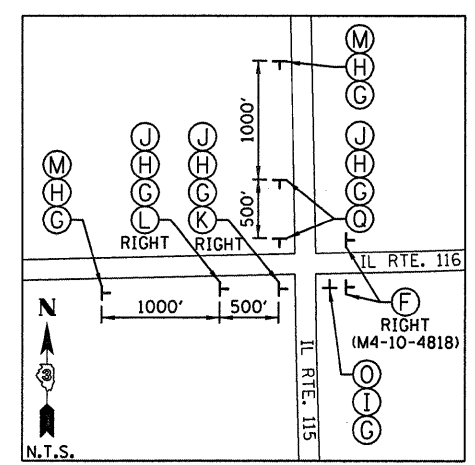

**IL RTE. 116 & IL RTE. 115 INTERSECTION (DETAIL "A")**

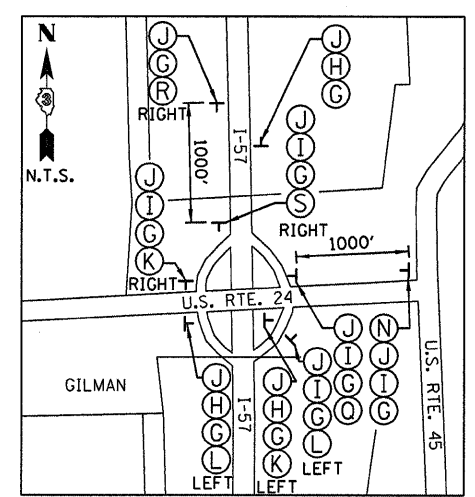

**CITY OF GILMAN INTERCHANGE (DETAIL "C")**

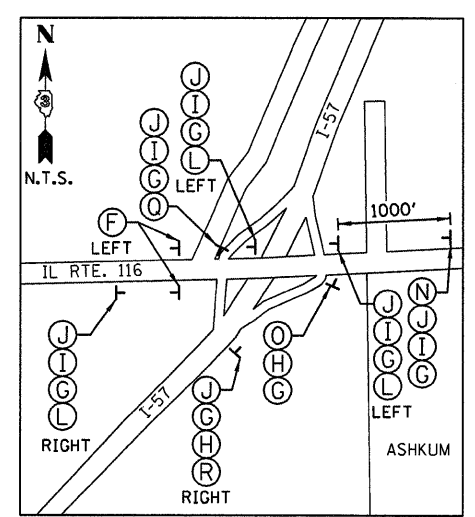

**VILLAGE OF ASHKUM INTERCHANGE (DETAIL "D")**

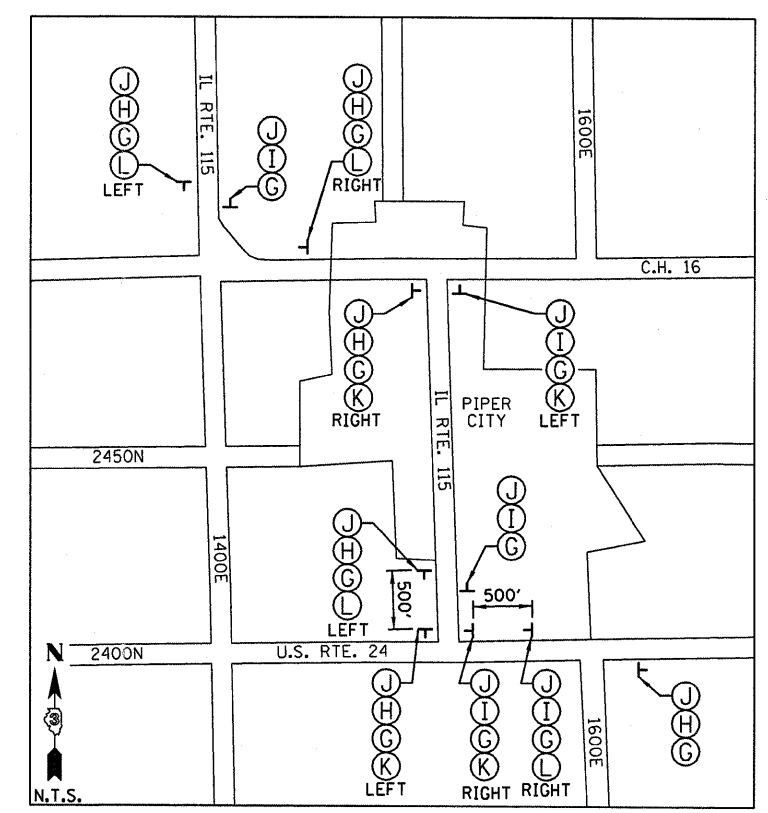

**IL RTE. 115 & U.S. RTE. 24 INTERSECTION (DETAIL "B")**

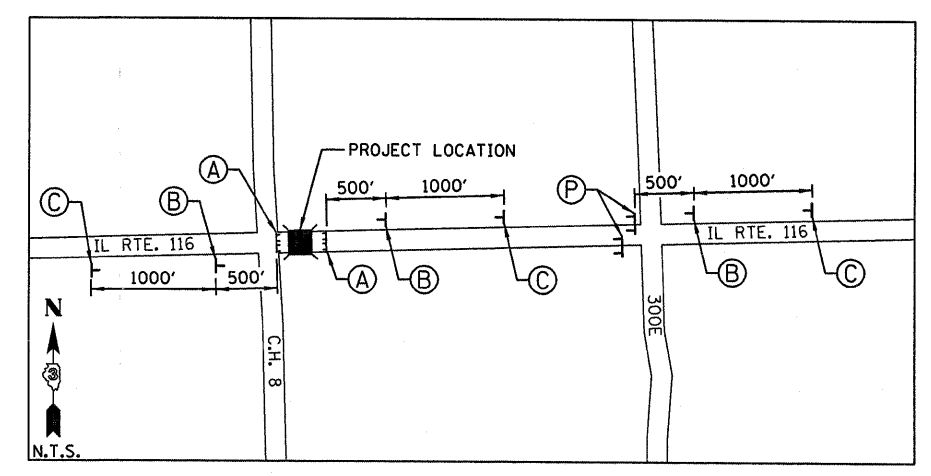

**PROJECT LOCATION VICINITY (DETAIL "E")**

- NOTES:**
- 1.) ALL TRAFFIC CONTROL DEVICES SHALL BE FURNISHED, ERECTED AND MAINTAINED BY THE CONTRACTOR.
  - 2.) ALL SIGNS NOT ATTACHED TO BARRICADES SHALL BE POST MOUNTED, UNLESS OTHERWISE NOTED.
  - 3.) LOCATIONS OF TRAFFIC CONTROL DEVICES MAY BE ADJUSTED BY THE ENGINEER.
  - 4.) THE ILLINOIS DEPARTMENT OF TRANSPORTATION, BUREAU OF OPERATIONS WILL SUPPLY ALL IL 116 ROUTE SIGNS FOR THIS DETOUR. THE CONTRACTOR SHALL NOTIFY DISTRICT 3 BUREAU OF OPERATIONS 21 CALENDAR DAYS PRIOR TO PLACING THE DETOUR.
  - 5.) WORK SHALL BE DONE IN ACCORDANCE WITH BLR-21.
  - 6.) COVER ANY SIGNS DENOTING EAST IL ROUTE 116 WITHIN A MILE RADIUS OF THE INTERSECTION BETWEEN IL ROUTE 116 AND IL ROUTE 115. COVER ANY SIGNS DENOTING WEST IL ROUTE 116 WITHIN A MILE RADIUS OF THE I-57 INTERCHANGE.
  - 7.) TRAFFIC CONTROL SHALL BE IN ACCORDANCE WITH THE STANDARD SPECIFICATIONS FOR ROAD AND BRIDGE CONSTRUCTION MANUAL FOR UNIFORM TRAFFIC CONTROL, HIGHWAY STANDARDS AND SPECIAL PROVISIONS.
  - 8.) COVER "ASHKUM" ON THE GREEN BOARD SIGNS ON I-57 NORTHBOUND AND SOUTHBOUND OF THE ASHKUM EXIT AT IL RTE. 116.

|  |                         |                |           |   |                    |   |                          |                 |                 |                    |  |  |
|--|-------------------------|----------------|-----------|---|--------------------|---|--------------------------|-----------------|-----------------|--------------------|--|--|
| FILE NAME =                              | USER NAME = carpentordj | DESIGNED - JML | REVISED - | <b>STATE OF ILLINOIS<br/>DEPARTMENT OF TRANSPORTATION</b> | <b>DETOUR PLAN</b> | F.A.P. RTE. 681                                 | SECTION 116 BR-1         | COUNTY IROQUOIS | TOTAL SHEETS 28 | SHEET NO. 9        |  |  |
| c:\projects\ep83584\consult\09_0078213.d | detourmaps.dgn          | DRAWN - DJM    | REVISED - |   |                    | SCALE:  | SHEET NO. 9 OF 28 SHEETS | STA.            | TO STA.         | CONTRACT NO. 66730 |  |  |
| PLOT SCALE = 4.0000' / IN.               | CHECKED - MSW           | REVISED -      | REVISED - |   |                    | FED. ROAD DIST. NO. 3 ILLINOIS FED. AID PROJECT |                          |                 |                 |                    |  |  |
| PLOT DATE = Aug 07, 2008 - 09:27:07 AM   | DATE - 04/09/08         | REVISED -      | REVISED - |   |                    |   |                          |                 |                 |                    |  |  |