

F.A.I. RTE.	SECTION	COUNTY	TOTAL SHEETS	SHEET NO.
80	*	**	219	51

STA. 305±00 TO STA. 320±00
 FED. ROAD DIST. NO. ILLINOIS FED. AID PROJECT

*(06-14 & 50-8)RS-1(14B,8-1,VB,VB-1,VB-2,VB-3)BR

** BUREAU & LASALLE

PRE-STAGE I CONSTRUCTION

Patch, mill, resurface (binder & surface courses) EB & WB lanes
 Sta 1803+19 to Sta 341+00 & Sta 349+00 to Sta 533+50

ALL PRE-STAGE I WORK SHALL BE PERFORMED @ NIGHT

LADD INTERCHANGE

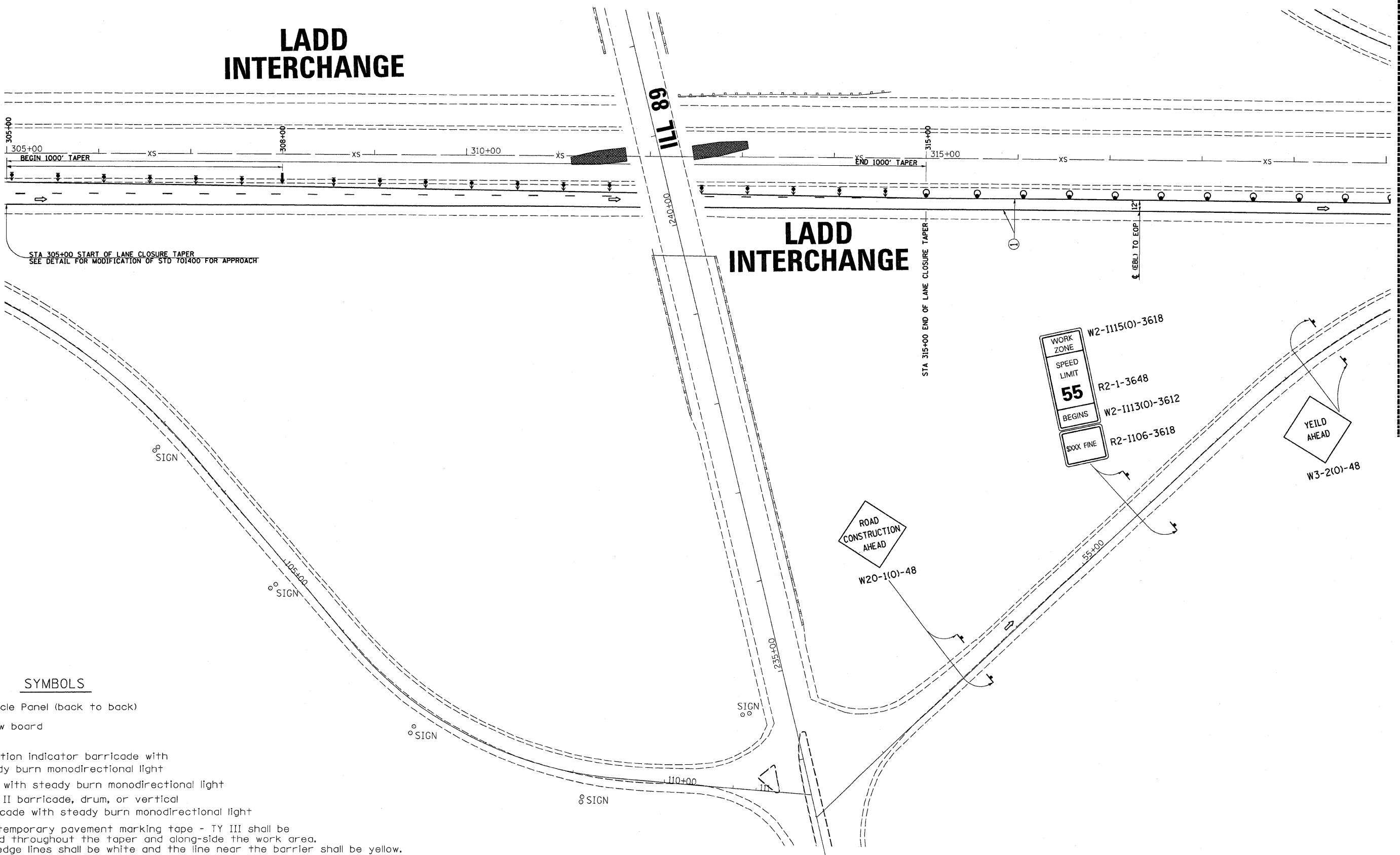

SYMBOLS

- ▨ Vertical Panel (back to back)
- ↑ Arrow board
- ⊥ Sign
- ⬆ Direction indicator barricade with steady burn monodirectional light
- Drum with steady burn monodirectional light
- ⊥ Type II barricade, drum, or vertical barricade with steady burn monodirectional light
- ① Wet temporary pavement marking tape - TY III shall be placed throughout the taper and along-side the work area. The edge lines shall be white and the line near the barrier shall be yellow.

PLOT DATE = Aug 27, 2008 - 8:12:42 PM
 FILE NAME = c:\pwworkspace\user\hko\dm32861\laddstg1.dgn
 PLOT SCALE = 50.0000' / 1" / IN.
 USER NAME = wenzelko