

F.A.I. RTE.	SECTION	COUNTY	TOTAL SHEETS	SHEET NO.
80	*	**	219	54
STA. 380+00		TO STA. 410+00		
FED. ROAD DIST. NO. ILLINOIS FED. AID PROJECT				
*(06-14 & 50-8)RS-1(14B,B-1,VB,VB-1,VB-2,VB-3)BR				

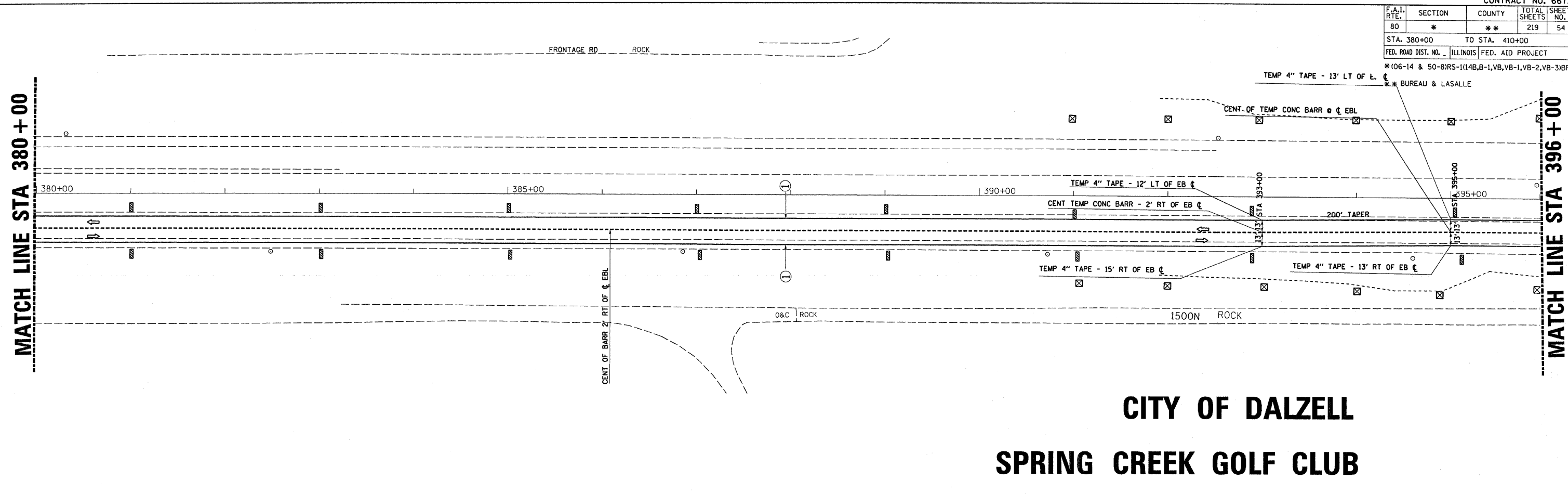

CITY OF DALZELL SPRING CREEK GOLF CLUB

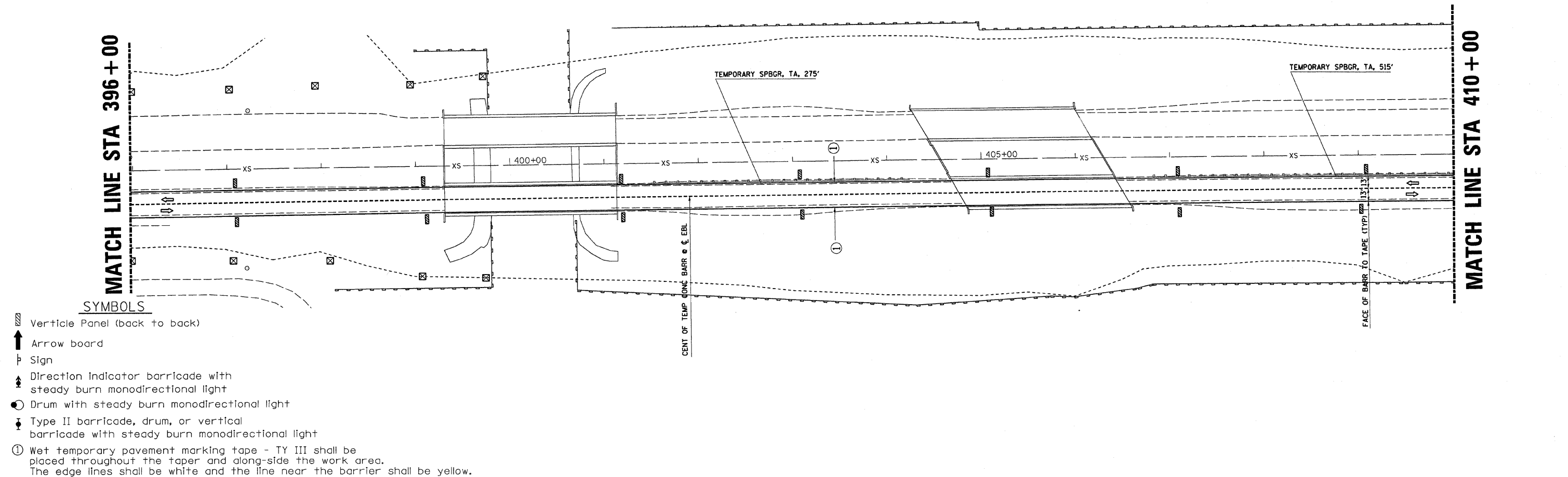

SYMBOLS

- Vertical Panel (back to back)
- Arrow board
- Sign
- Direction Indicator barricade with steady burn monodirectional light
- Drum with steady burn monodirectional light
- Type II barricade, drum, or vertical barricade with steady burn monodirectional light
- Wet temporary pavement marking tape - TY III shall be placed throughout the taper and along-side the work area. The edge lines shall be white and the line near the barrier shall be yellow.

PLOT DATE = Aug 29, 2008 - 09:43:28 AM
 FILE NAME = c:\pva\pva\DOT\BR0807PC\dms32861\sheet54.dgn
 PLOT SCALE = 50.0000 / IN.
 USER NAME = braboyce