

F.A. RTE.	SECTION	COUNTY	TOTAL SHEETS	SHEET NO.
*	*	**	219	72
STA. _____		TO STA. _____		
FED. ROAD DIST. NO. _____ ILLINOIS FED. AID PROJECT				

CONTROL INSTALLATION, 30A, 120/240V
 PHOTOCELL RELAY
 (LOCATION TO BE DETERMINED)
 TO THE SATISFACTION OF
 THE ENGINEER

* (06-14 & 50-8)RS-1 (14B,B-1,VB,VB-1,VB-2,VB-3)BR
 BUREAU & LASALLE

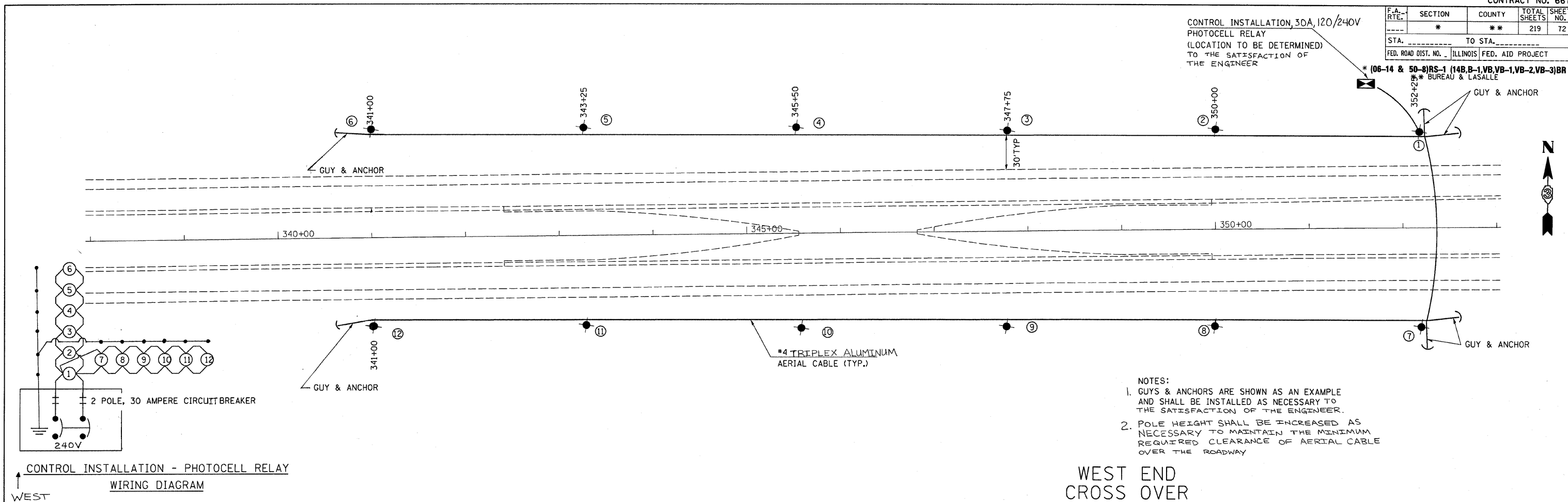

- NOTES:
 1. GUYS & ANCHORS ARE SHOWN AS AN EXAMPLE AND SHALL BE INSTALLED AS NECESSARY TO THE SATISFACTION OF THE ENGINEER.
 2. POLE HEIGHT SHALL BE INCREASED AS NECESSARY TO MAINTAIN THE MINIMUM REQUIRED CLEARANCE OF AERIAL CABLE OVER THE ROADWAY

WEST END
 CROSS OVER

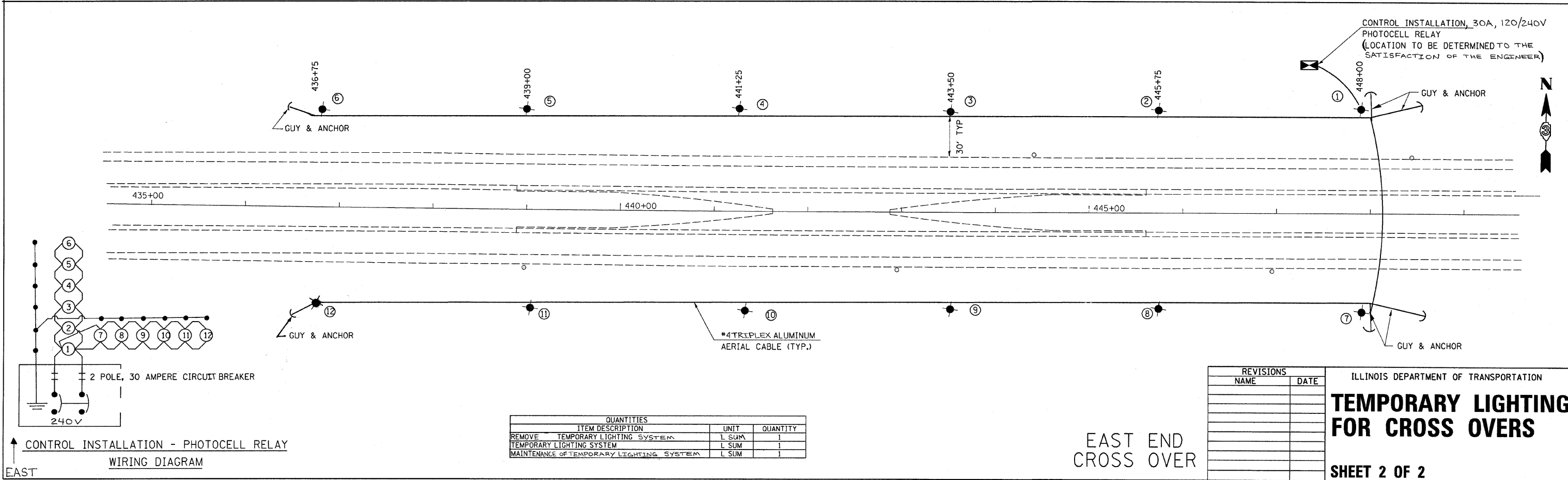

REVISIONS	
NAME	DATE

ILLINOIS DEPARTMENT OF TRANSPORTATION
TEMPORARY LIGHTING FOR CROSS OVERS
 SHEET 2 OF 2

EAST END
 CROSS OVER

QUANTITIES		
ITEM DESCRIPTION	UNIT	QUANTITY
REMOVE TEMPORARY LIGHTING SYSTEM	L SUM	1
TEMPORARY LIGHTING SYSTEM	L SUM	1
MAINTENANCE OF TEMPORARY LIGHTING SYSTEM	L SUM	1

PLOT DATE = Aug 27 2008 11:03:59 PM
 FILE NAME = c:\p\work\projects\66731\work\66731.dgn
 PLOT SCALE = 1/8" = 1'-0"
 USER NAME = wenzelko