

Bench Mark: Top of SW wingwall of S.N.006-0032, Sta. 399+28.47, 53.5' right. Elevation 602.83.

Existing Structures: S.N. 006-0032 (EB) built in 1957 as F.A.P. Route 154, Section 14-B. S.N. 006-0033 (WB) built in 1958 as F.A.I. Route 6, Section 6-14B-1. Each structure consists of a three span reinforced concrete deck on continuous wide flange steel beams supported by pile bent spill thru abutments and multi-column piers. 185'-0" back-to-back abutments. 35'-8" out-to-out deck. Existing structures to be removed and replaced using cross overs.

No Salvage.

STATE OF ILLINOIS
DEPARTMENT OF TRANSPORTATION

ROUTE NO.	SECTION	COUNTY	TOTAL SHEETS	SHEET NO.
F.A.I. 80	14BR & 14BR-1	BUREAU	219	73
FED. ROAD DIST. NO. 7		ILLINOIS	FED. AID PROJECT-	

Contract No. 66731

INDEX OF SHEETS

- 1 General Plan & Elevation
- 2 General Data
- 3 Footing Layout
- 4-8 Top of Slab Elevations
- 9 Top of West Approach Pavement Elevation (E.B.)
- 10 Top of East Approach Pavement Elevation (E.B.)
- 11 Top of West Approach Pavement Elevation (W.B.)
- 12 Top of East Approach Pavement Elevation (W.B.)
- 13 Superstructure (E.B.)
- 14 Superstructure (W.B.)
- 15 Superstructure Details
- 16 Diaphragm Details
- 17 Structural Steel
- 18 Structural Steel Details
- 19 Bearing Details
- 20 West Abutment (E.B.)
- 21 East Abutment (E.B.)
- 22 West Abutment (W.B.)
- 23 East Abutment (W.B.)
- 24 Pier (E.B.)
- 25 Pier (W.B.)
- 26 Bar Splicer Assembly Details
- 27 Steel H Pile Details
- 28 Concrete Parapet Slipforming Option
- 29-32 Boring Logs

STATION 400+22.07
BUILT 200 BY
STATE OF ILLINOIS
F.A.I. RTE. 80 SEC. 14BR & 14BR-1
LOADING HL93
STRUCTURE NO. 006-0165 (E.B.)

STATION 400+22.07
BUILT 200 BY
STATE OF ILLINOIS
F.A.I. RTE. 80 SEC. 14BR & 14BR-1
LOADING HL93
STRUCTURE NO. 006-0166 (W.B.)

NAME PLATE
See Std. 515001

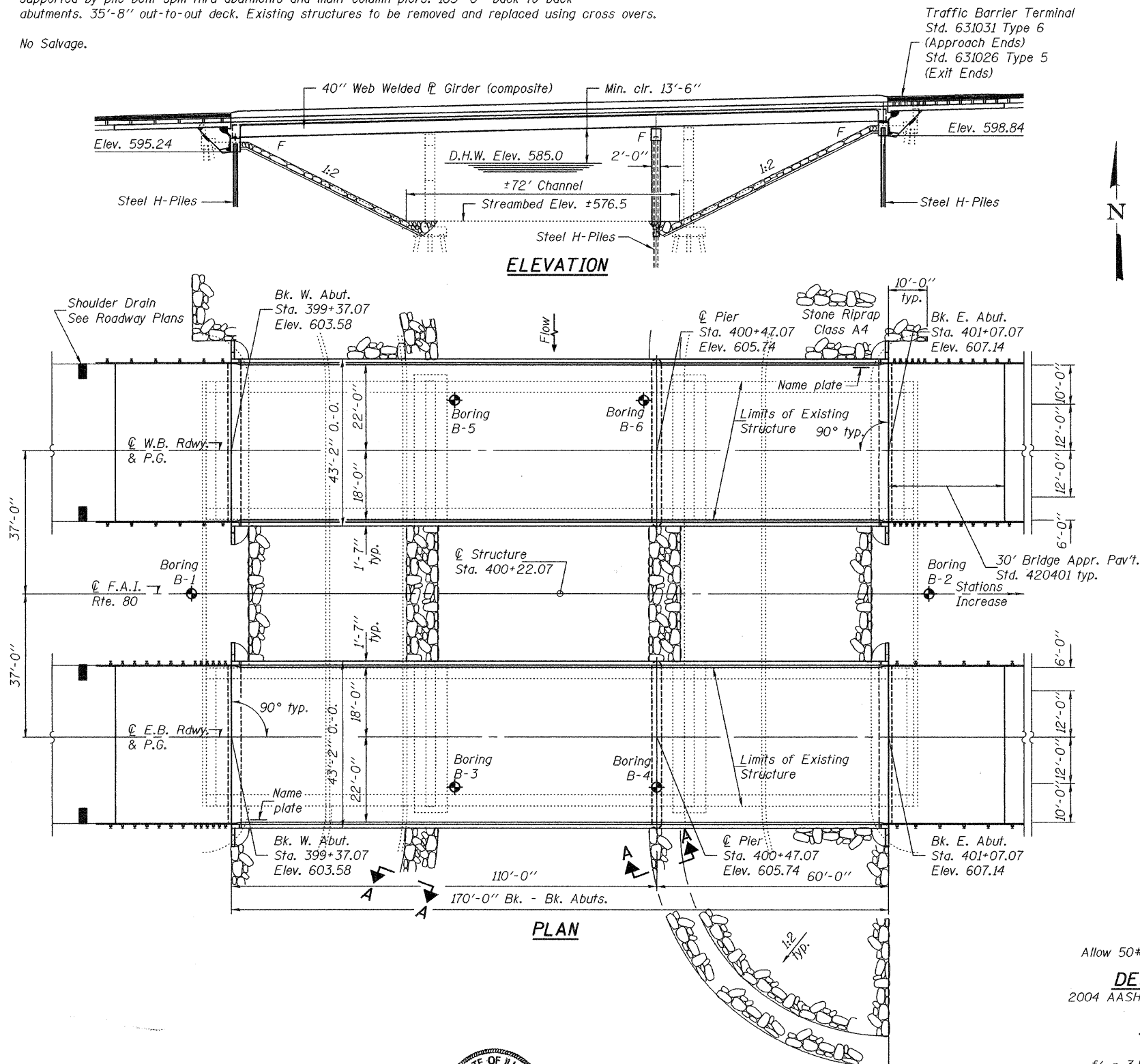
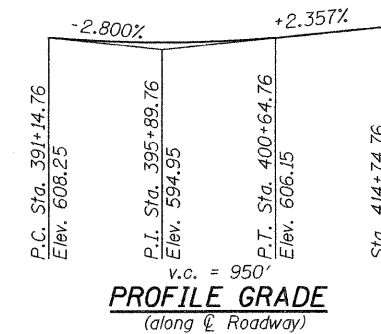

WATERWAY INFORMATION

Prop. Low Grade Elev. 600.99 @ Sta. 396+47.61
Exist. Low Grade Elev. 599.57 @ Sta. 396+13.61
Drainage Area = 38.50 sq. mi.

Flood	Freq. Yr.	Q C.F.S.	Opening Sq. Ft.		Nat. H.W.E.	Head - Ft.		Headwater El.	
			Exist.	Prop.		Exist.	Prop.	Exist.	Prop.
Design	10	2563	478	547	582.3	0.7	0.3	583.0	582.6
Base	50	3783	542	615	583.0	1.2	0.5	584.2	583.5
Overtopping	100	4282	570	644	583.3	1.4	0.5	584.7	583.8
Max. Calc.	500	5449	617	694	583.8	2.1	0.5	585.9	584.3

DESIGN SCOUR TABLE

Design Scour Elevation	W. Abut.	Pier	E. Abut.
	595.24	560.50	598.84

LOADING HL-93

Allow 50#/sq. ft. for future wearing surface.

DESIGN SPECIFICATIONS

2004 AASHTO LRFD with 2005 and 2006 Interims

DESIGN STRESSES

FIELD UNITS

$f'_c = 3,500$ psi
 $f_y = 60,000$ psi (reinforcement)
 $f_y = 50,000$ psi (AASHTO M270 Grade 50W)

SEISMIC DATA

Seismic Performance Zone (SPZ) = 1
Bedrock Acceleration Coefficient (A) = 3.8%g
Site Coefficient (S) = 1.0

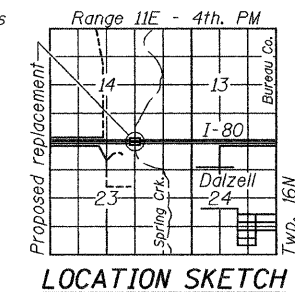

GENERAL PLAN & ELEVATION
I-80 OVER SPRING CREEK
F.A.I. RTE. 80 - SEC. 14BR & 14BR-1
BUREAU COUNTY
STATION 400+22.07
STRUCTURE NO. 006-0165 (E.B.)
STRUCTURE NO. 006-0166 (W.B.)

DESIGNED	<i>Alvin R. B...</i>
CHECKED	<i>...</i>
DRAWN	h.t. duong
CHECKED	NRB/GRA

EXAMINED	<i>...</i>	SEP. 30, 2008
PASSED	<i>...</i>	



EXPIRES 11-30-2008