

F.A.P. RTE.	SECTION	COUNTY	TOTAL SHEETS	SHEET NO.
649	(107) BR	LASALLE	24	1
FED. ROAD DIST. NO.	ILLINOIS	CONTRACT NO.	66844	

STATE OF ILLINOIS  
DEPARTMENT OF TRANSPORTATION  
DIVISION OF HIGHWAYS  
**PROPOSED  
HIGHWAY PLANS**

F.A.P. ROUTE 649 (IL 17)  
SECTION (107) BR  
PROJECT ACF-0649(016)  
LASALLE COUNTY  
C-93-117-08

REPLACEMENT OF THE EXISTING STRUCTURE OVER THE  
SOUTH BRANCH OF MOON CREEK WITH TRIPLE PRECAST BOX CULVERT  
0.8 MILES E. OF OLD IL 179

**INDEX OF SHEETS**

- 1 COVER SHEET
- 2 GENERAL NOTES AND COMMITMENTS
- 3 SUMMARY OF QUANTITIES
- 4 TYPICAL SECTIONS
- 5 SCHEDULE OF QUANTITIES
- 6 TIE POINTS
- 7-8 PLAN AND PROFILE
- 9-10 MAINTENANCE OF TRAFFIC
- 11 RIGHT OF WAY PLAN
- 12-18 CULVERT PLANS
- 19 ROADWAY DETAILS
- 20-24 CROSS SECTIONS

**HIGHWAY STANDARDS**

- 000001-05 STANDARD SYMBOLS, ABBREVIATIONS AND PATTERNS
- 001001-01 AREAS OF REINFORCEMENT BARS
- 001006 DECIMAL OF AN INCH AND OF A FOOT
- 280001-04 TEMPORARY EROSION CONTROL SYSTEMS
- 482011-03 HMA SHLD. STRIPS/SHLDS. WITH RESURFACING OR WIDENING AND RESURFACING PROJECTS
- 515001-02 NAME PLATE FOR BRIDGES
- 630001-07 STEEL PLATE BEAM GUARDRAIL
- 630101-07 GUARDRAIL MOUNTED ON EXISTING CULVERTS
- 630201-05 PCC/HMA STABILIZATION AT STEEL PLATE BEAM GUARDRAIL
- 630301-04 SHOULDER WIDENING FOR TYPE I (SPECIAL) GUARDRAIL TERMINALS
- 635006-02 REFLECTOR AND TERMINAL MARKER PLACEMENT
- 635011-01 REFLECTOR MARKER AND MOUNTING DETAILS
- 666001 RIGHT OF WAY MARKERS
- 667101 PERMANENT SURVEY MARKERS
- 701001-01 OFF-ROAD OPERATIONS, 2L, 2W, MORE THAN 4.5 m (15') AWAY
- 701006-02 OFF-ROAD OPERATIONS, 2L, 2W, 4.5 m (15') TO 600 mm (24") FROM PAVEMENT EDGE
- 701311-02 LANE CLOSURE, 2L, 2W, MOVING OPERATIONS-DAY ONLY
- 701321-09 LANE CLOSURE, 2L, 2W, BRIDGE REPAIR WITH BARRIER
- 701326-02 LANE CLOSURE, 2L, 2W, PAVEMENT WIDENING, FOR SPEEDS ≥ 45 MPH
- 701901 TRAFFIC CONTROL DEVICES
- 704001-04 TEMPORARY CONCRETE BARRIER
- 781001-02 TYPICAL APPLICATIONS RAISED REFLECTIVE PAVEMENT MARKERS

MICROFILMED \_\_\_\_\_  
REEL NUMBER \_\_\_\_\_  
AWARDED \_\_\_\_\_  
RESIDENT ENGINEER \_\_\_\_\_  
AS BUILT CHANGES WERE MADE  
ON THE FOLLOWING SHEETS \_\_\_\_\_

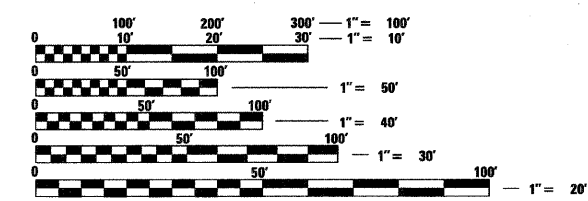

FULL SIZE PLANS HAVE BEEN PREPARED USING STANDARD ENGINEERING SCALES. REDUCED SIZED PLANS WILL NOT CONFORM TO STANDARD SCALES. IN MAKING MEASUREMENTS ON REDUCED PLANS, THE ABOVE SCALES MAY BE USED.

J.U.L.I.E.  
JOINT UTILITY LOCATION INFORMATION FOR EXCAVATION  
1-800-892-0123  
OR 811

**PROJECT ENGINEER: JOE KANNEL**  
**UNIT CHIEF: MICHELE LINDEMANN**  
  
DISTRICT 3 NO. (815) 434-6131  
  
**CONTRACT NO. 66844**

STA. 50+98  
TRIPLE 11'x7' PRECAST  
CONCRETE BOX CULVERT  
EXISTING S.N. 050-0037  
PROPOSED S.N. 050-2044

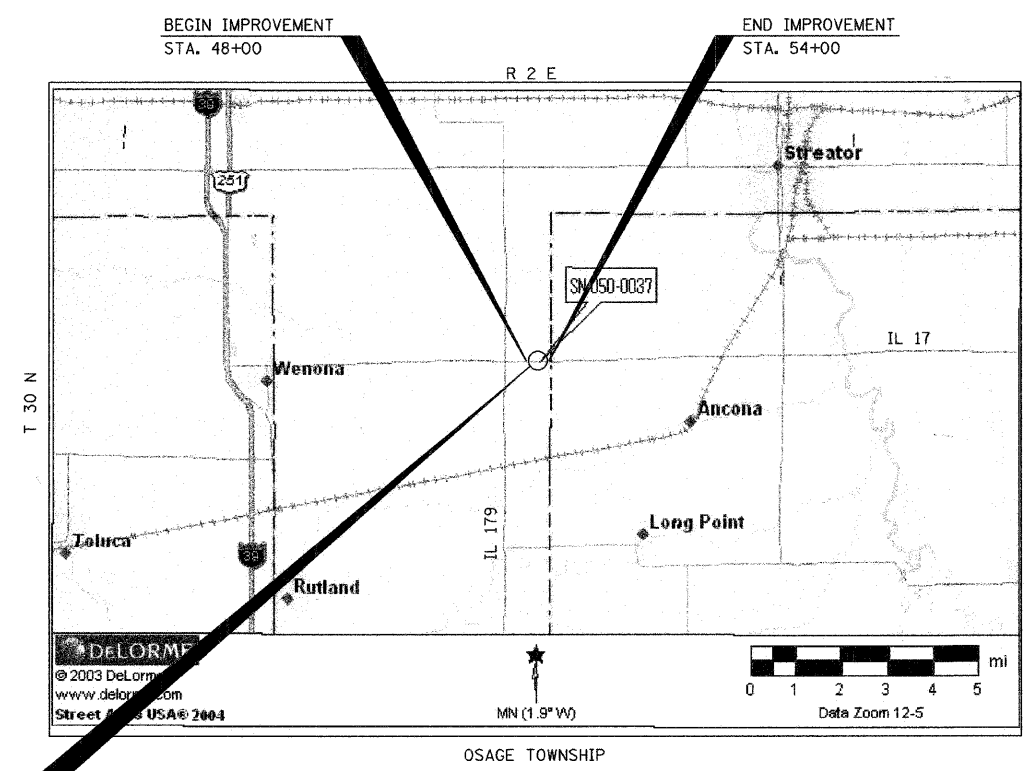

**LOCATION MAP**  
SCALE: NTS

GROSS LENGTH = 600 FT. = 0.114 MI.  
NET LENGTH = 600 FT. = 0.114 MI.

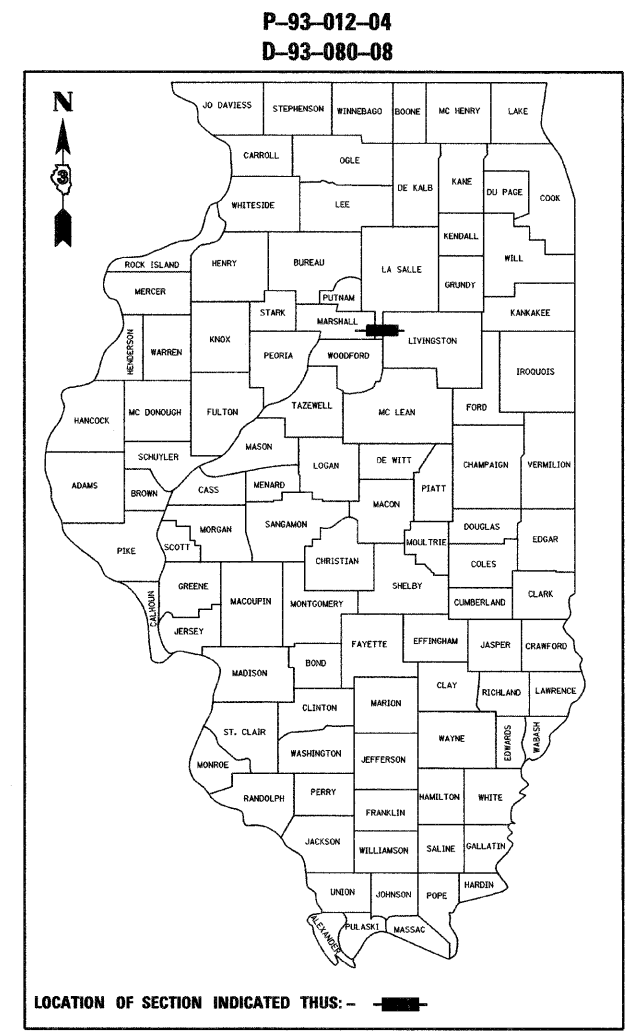

**FUNCTIONAL CLASSIFICATION**

**MINOR ARTERIAL (RURAL)**  
F.A.P. ROUTE 649 (IL 17)  
2009 ADT = 2,200  
P.V. = 84.2% S.U. = 7.3% M.U. = 8.5%

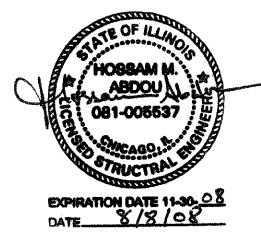
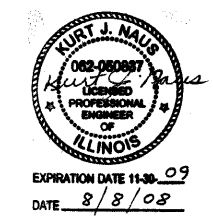

STATE OF ILLINOIS  
DEPARTMENT OF TRANSPORTATION  
DIVISION OF HIGHWAYS

SUBMITTED Aug. 11 2008  
George Degen  
DEPUTY DIRECTOR OF HIGHWAYS, REGION ENGINEER

October 3, 20 08  
Eric E. Haran  
ENGINEER OF DESIGN AND ENVIRONMENT

October 3, 20 08  
Christine M. Reed  
DIRECTOR OF HIGHWAYS, CHIEF ENGINEER

**benesch**  
alfred benesch & company  
Engineers • Surveyors • Planners  
205 North Michigan Avenue, Suite 2400  
Chicago, Illinois 60601  
312-565-0450  
Job # 3938.01

**PRINTED BY THE AUTHORITY  
OF THE STATE OF ILLINOIS**