

F.A.P. RTE.	SECTION	COUNTY	TOTAL SHEETS	SHEET NO.
22	135W-2; RS-5	FULTON	282	42
STA.	TO STA.			
FED. ROAD DIST. NO.	ILLINOIS FED. AID PROJECT			

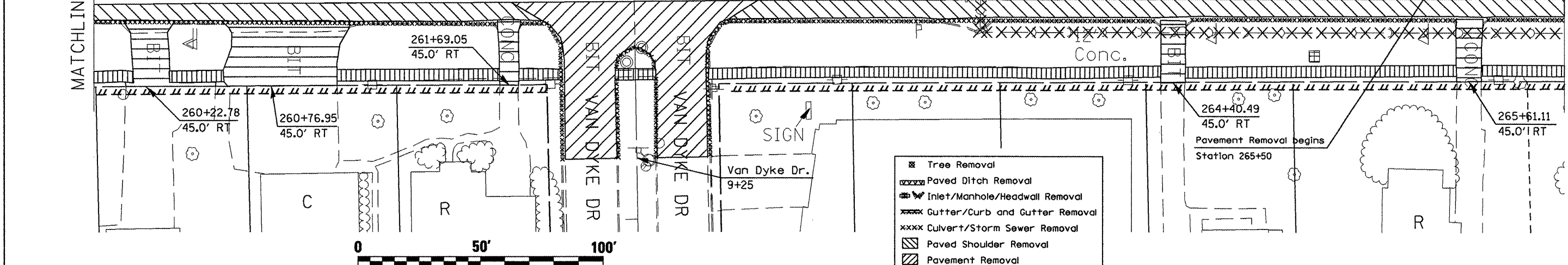

- Tree Removal
- Paved Ditch Removal
- Inlet/Manhole/Headwall Removal
- Gutter/Curb and Gutter Removal
- Culvert/Storm Sewer Removal
- Paved Shoulder Removal
- Pavement Removal
- Driveway Pavement Removal
- Sidewalk Removal
- HMA Surface Removal Butt Joint

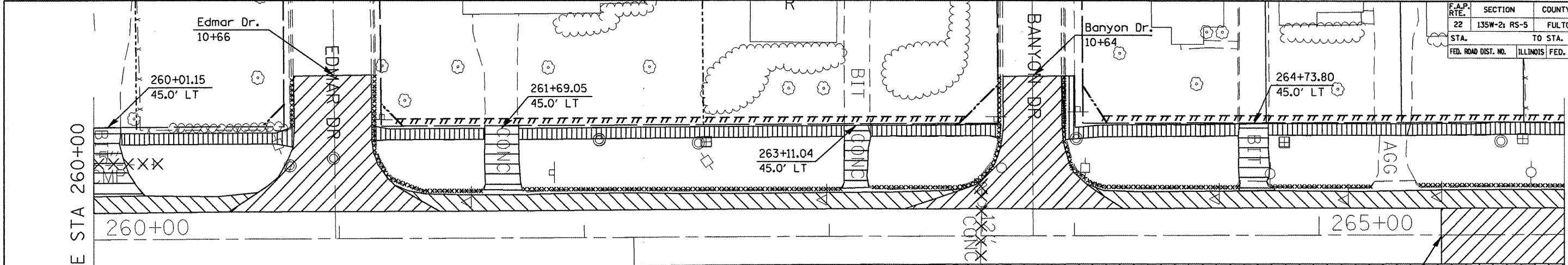
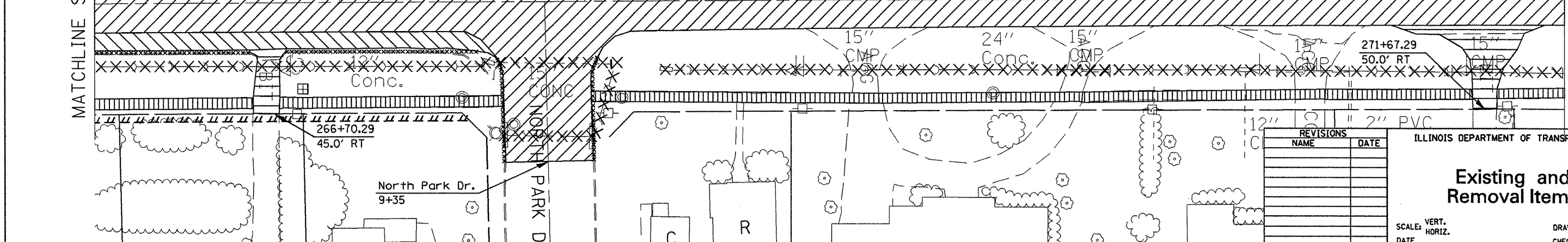
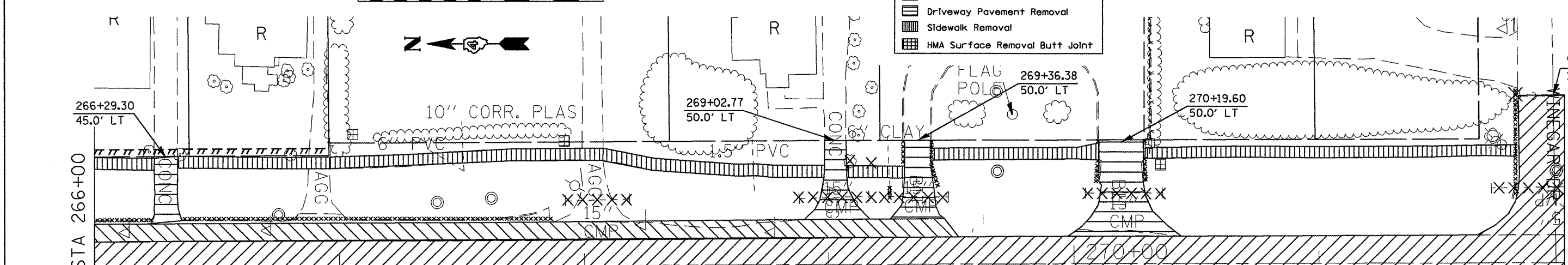

REVISIONS	
NAME	DATE

ILLINOIS DEPARTMENT OF TRANSPORTATION

Existing and Removal Items

SCALE: VERT. DATE HORIZ. DATE

DRAWN BY CHECKED BY

PLOT DATE = 6/18/2008
 FILE NAME = s:\projects\17\Barton\general.dgn
 PLOT SCALE = 42.4874 "/>