

F.A.P. RTE.	SECTION	COUNTY	TOTAL SHEETS	SHEET NO.
22	135W-2; RS-5	FULTON	282	46
STA. TO STA.		FED. ROAD DIST. NO. ILLINOIS FED. AID PROJECT		

- - - Existing Right of Way
 - - - Proposed Right of Way
 ||||| Proposed Temporary Easement
 - - - Construction Limits

note: hot-mix asphalt shoulder width changes from 5' to 6' and pavement width changes from 38' to 36' at station 188+44

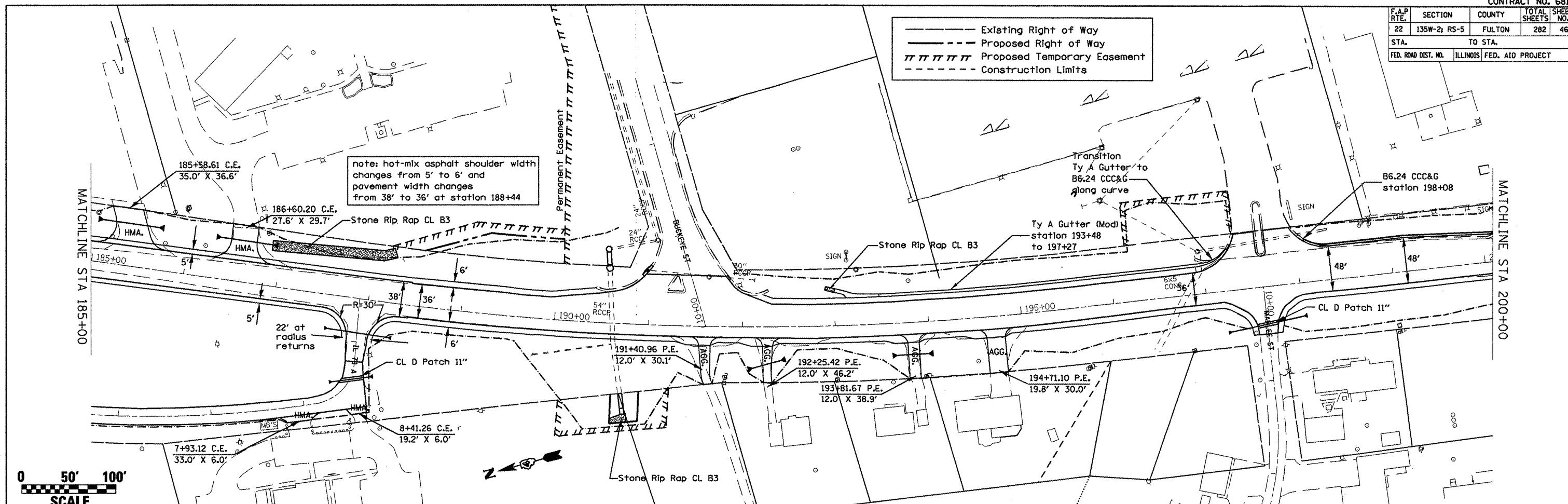

PLAN	DATE
SURVEYED	
ALIGNED	
CHECKED	
NO. OF W.A. CHECKED	
PAID FILE NAME	

PROFILE	DATE
SURVEYED	
GRADED	
CHECKED	
NO. NOTED	
STRUCTURE NOTATIONS GRID	

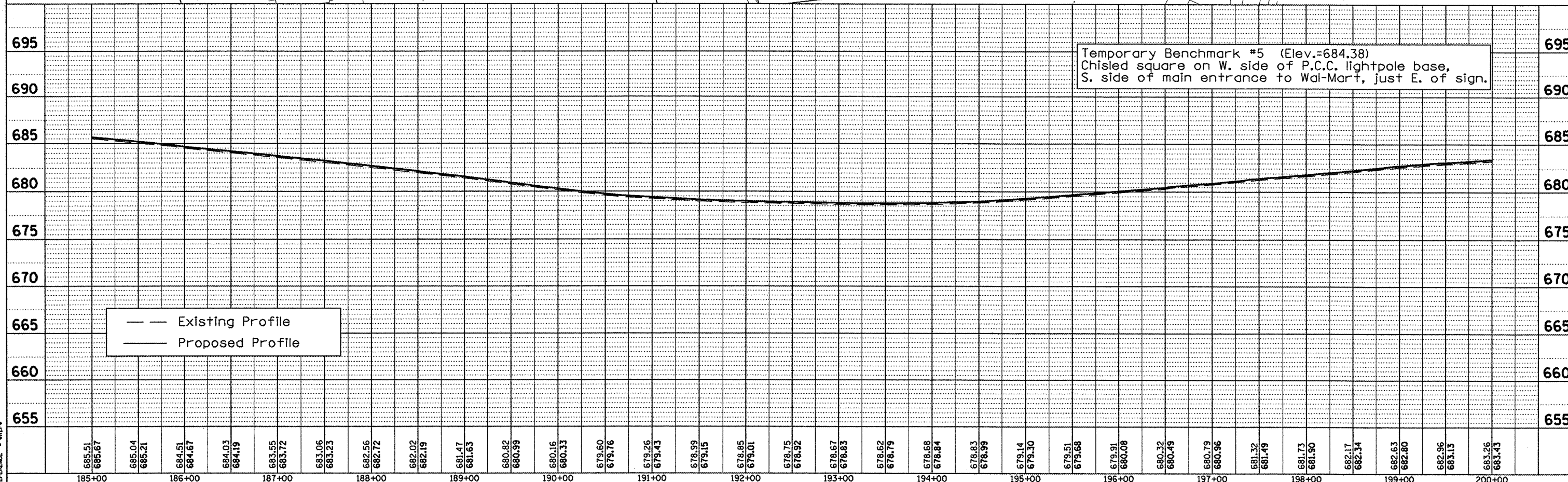

- - - Existing Profile
 - - - Proposed Profile

Temporary Benchmark #5 (Elev.=684.38)
Chisled square on W. side of P.C.C. lightpole base,
S. side of main entrance to Wal-Mart, just E. of sign.

PLOT DATE = 6/10/2008
 FILE NAME = s:\projects\1178antun\general.dgn
 PLOT SCALE = 1/8"=1'-0"
 REFERENCE = N/A