

F.A.P. RTE.	SECTION	COUNTY	TOTAL SHEETS	SHEET NO.
22	135W-21 RS-5	FULTON	282	47
STA.		TO STA.		
FED. ROAD DIST. NO.		ILLINOIS FED. AID PROJECT		

note: hot-mix asphalt shoulder width changes from 6' to 5' and pavement width changes from 36' to 38' at station 200+71

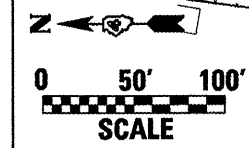
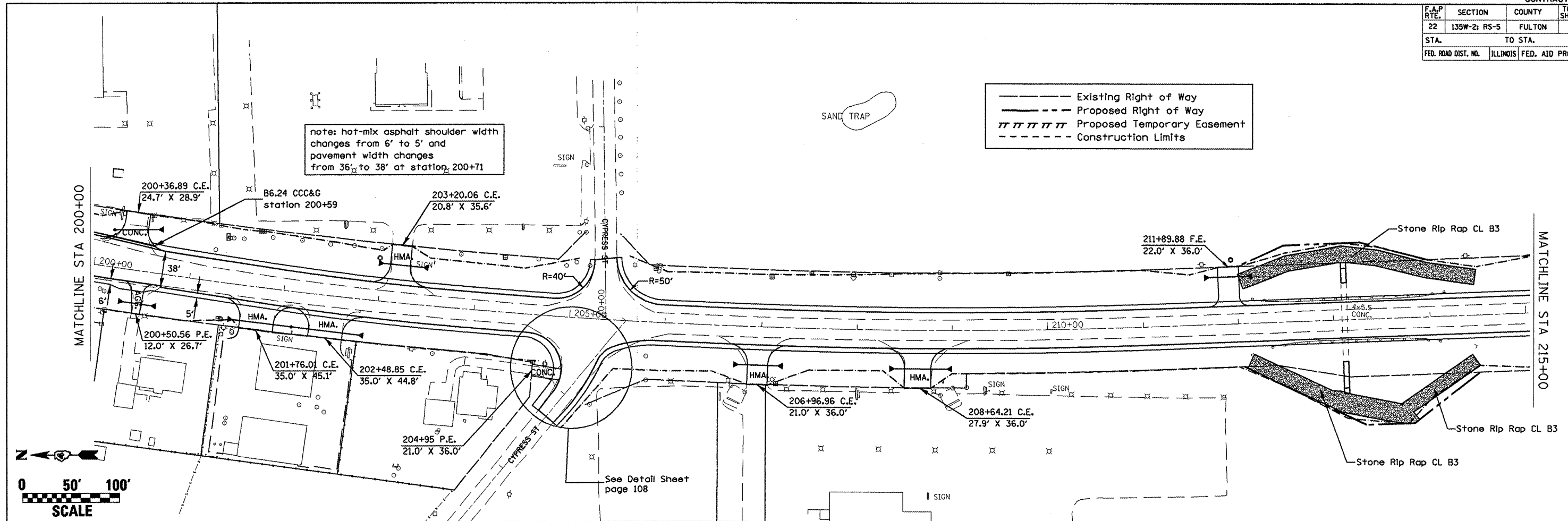
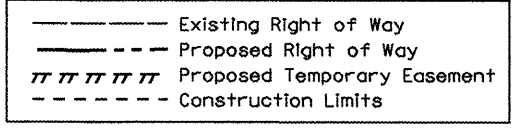

PLAN

DATE	
BY	
CHECKED	
NO.	

PROFILE

DATE	
BY	
CHECKED	
NO.	

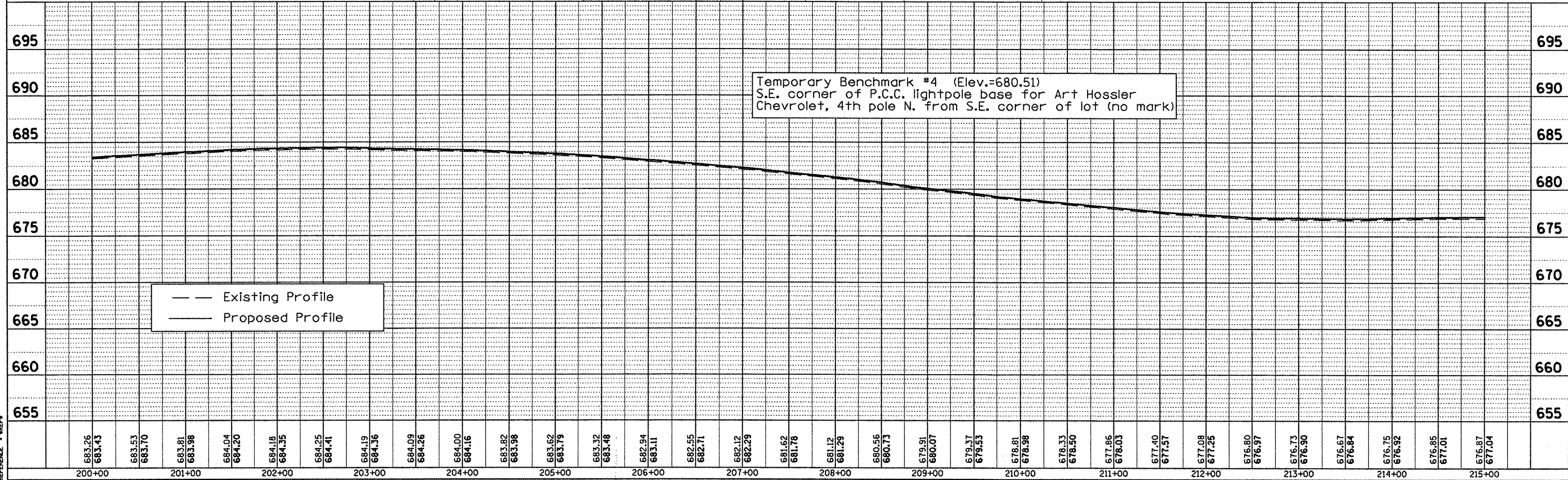

Existing Profile
Proposed Profile

PLOT DATE = 8/18/2008
FILE NAME = c:\pro\pca\178\auton\general2.dgn
PLOT SCALE = 1/8" = 1' / IN.
REFERENCE = REF#