

F.A.P. RTE.	SECTION	COUNTY	TOTAL SHEETS	SHEET NO.
22	135W-2; RS-5	FULTON	282	64
STA. TO STA.		FED. ROAD DIST. NO. ILLINOIS FED. AID PROJECT		

**STAGE VA CONSTRUCTION ACTIVITY**

1. Remove pavement and temporary pavement RT station 263+93 to 272+77
2. Build hot-mix asphalt base course RT station 263+93 to 272+77
3. Remove temporary storm sewer 12" RT station 263+61 to 264+00
4. Build hot-mix asphalt base course, combination concrete curb and gutter, storm sewer, and sidewalk RT station 262+80 to 263+93

**STAGE VB CONSTRUCTION ACTIVITY**

1. Remove temporary pavement LT station 273+21 to 274+85

**LEGEND**

	Hot-Mix Asphalt Base Course 10.5"		Variable Milling
	Temporary Pavement		Traffic Lane
	Flagger		

**STAGE VA TRAFFIC CONTROL**

1. Traffic shifts east to new pavement
2. TRAFFIC CONTROL AND PROTECTION (SPECIAL), LOCATION 2
3. Use Vertical Barricades (STD 701901) at 50' spacings along RT edge of SB lane

**STAGE VB TRAFFIC CONTROL**

1. Traffic shifts to middle two lanes
2. TRAFFIC CONTROL AND PROTECTION (SPECIAL), LOCATION 2

**GENERAL CONSTRUCTION NOTES**

1. Adequate pavement drainage shall be maintained during all stages of construction.
2. Use temporary pavement over storm sewer where the pavement is to be removed during a later stage.

**GENERAL STAGING NOTES**

All construction staging is suggested and can be revised upon written approval from the resident engineer two weeks prior to starting work. There will be no adjustment in the traffic control unit price due to the contractor changing the planned construction sequence.

 W20-1(0)-48 400' from start of taper on north end and south end	 W1-4L(0)-48 200' from start of taper on north end (Stage VA)	 W1-4R(0)-48 200' from start of taper on south end (Stage VA)
 W13-1(0)-2424	 W13-1(0)-2424	 W13-1(0)-2424

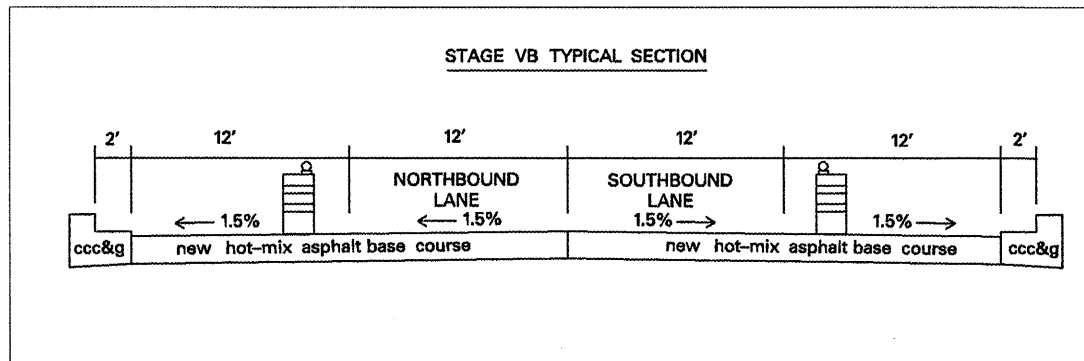
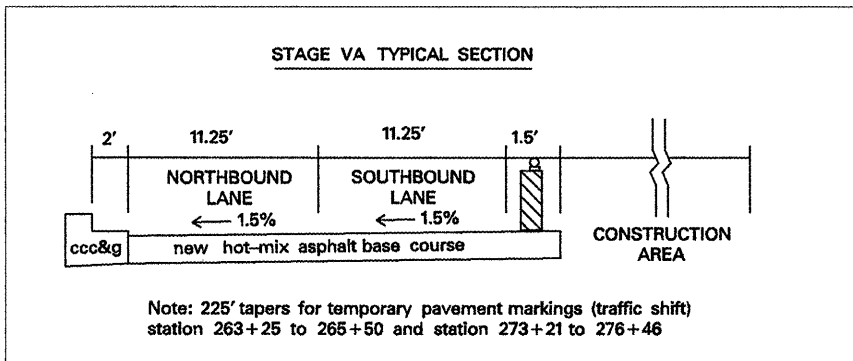
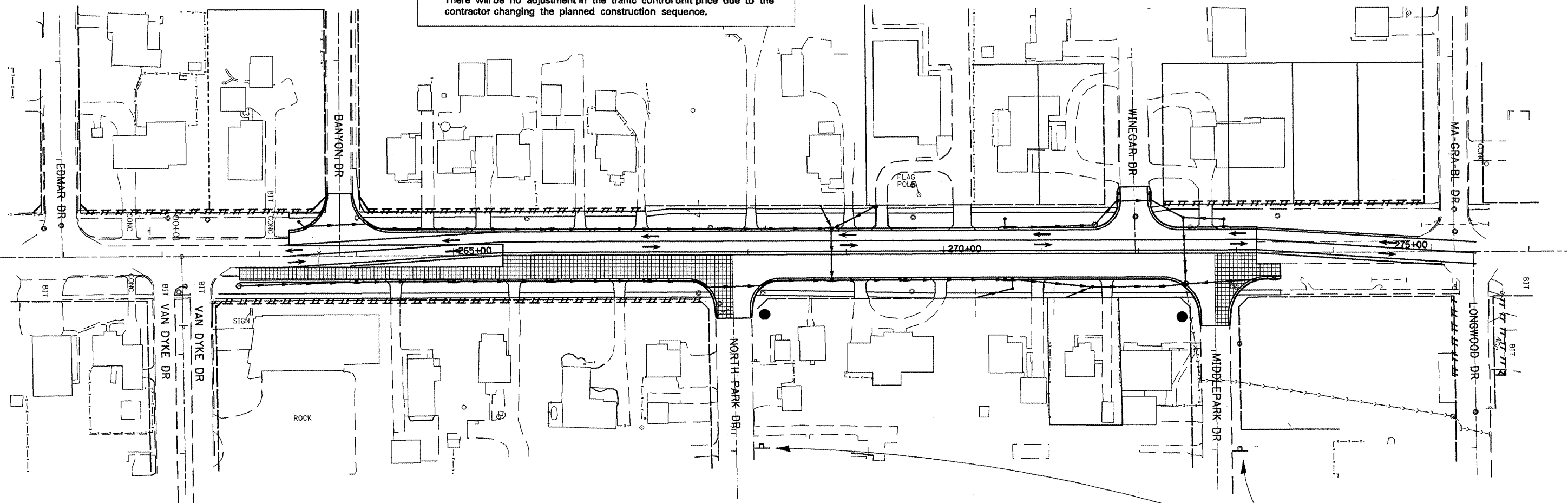

400' from IL 78

W20-110(0)-48

0 50' 100' SCALE

REVISIONS		
NAME	DATE	

ILLINOIS DEPARTMENT OF TRANSPORTATION

**New Pavement Stage V Construction**

SCALE: VERT. DATE:      HORIZ. DATE:      DRAWN BY:      CHECKED BY:

PLT DATE = 8/18/2008  
 FILE NAME = c:\projects\68114\77\Bantion\general.dgn  
 PLOT SCALE = 1/8"=1'-0"  
 USER NAME = hudsonstone