

F.A.P. RTE.	SECTION	COUNTY	TOTAL SHEETS	SHEET NO.
22	135W-2, RS-5	FULTON	282	120
STA.		TO STA.		
FED. ROAD DIST. NO.		ILLINOIS FED. AID PROJECT		

PROPOSED CABLE DIAGRAM

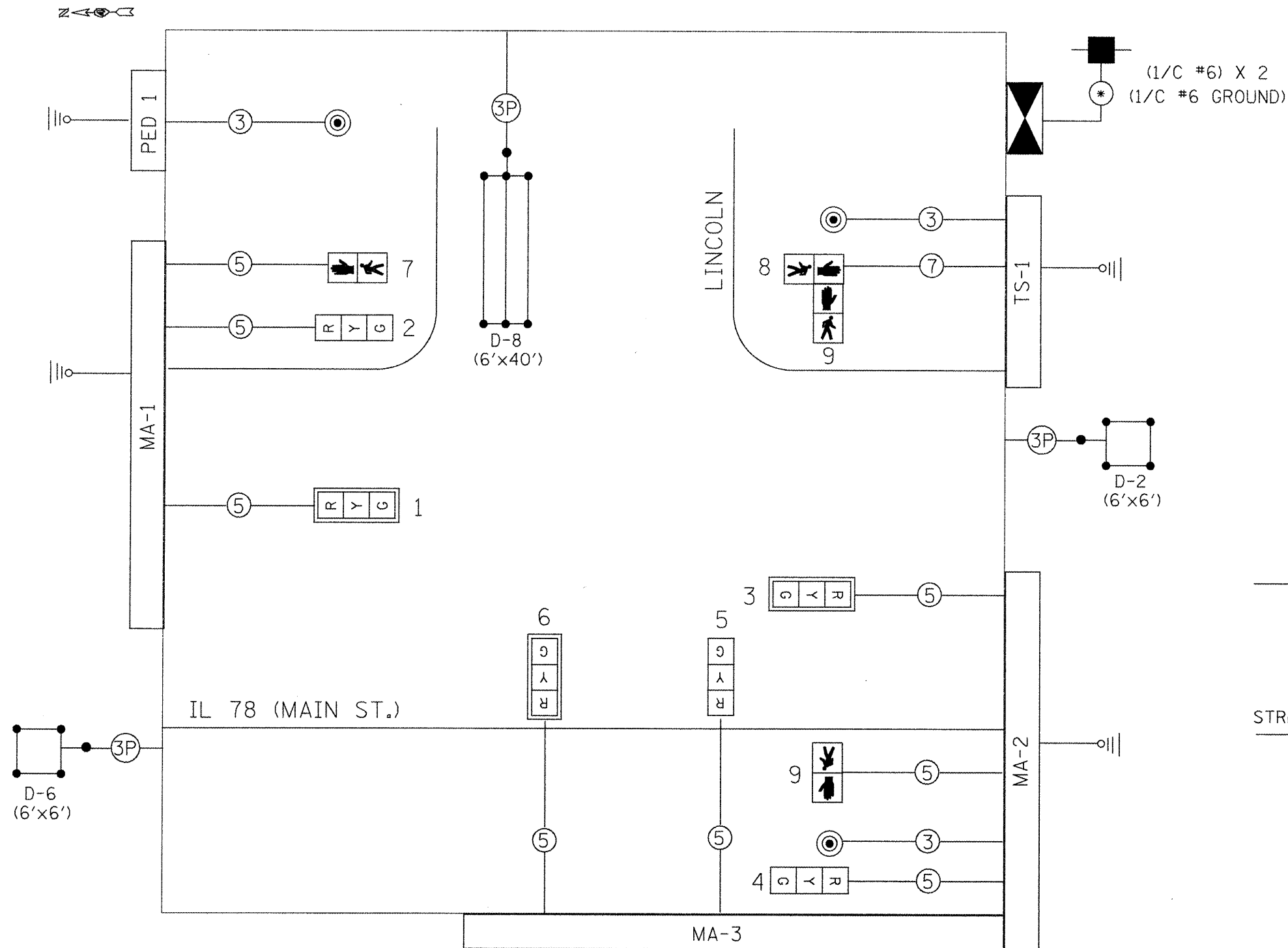

PROPOSED PHASE DIAGRAM

NAME OF INTERSECTION IL 78 (MAIN ST.) & LINCOLN  
 PROPOSED CONTROLLER: FULL ACTUATED CONTROLLER (TS-2), TYPE IV CABINET, TS-2 BACKPANEL

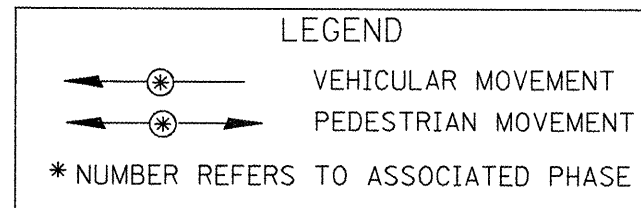
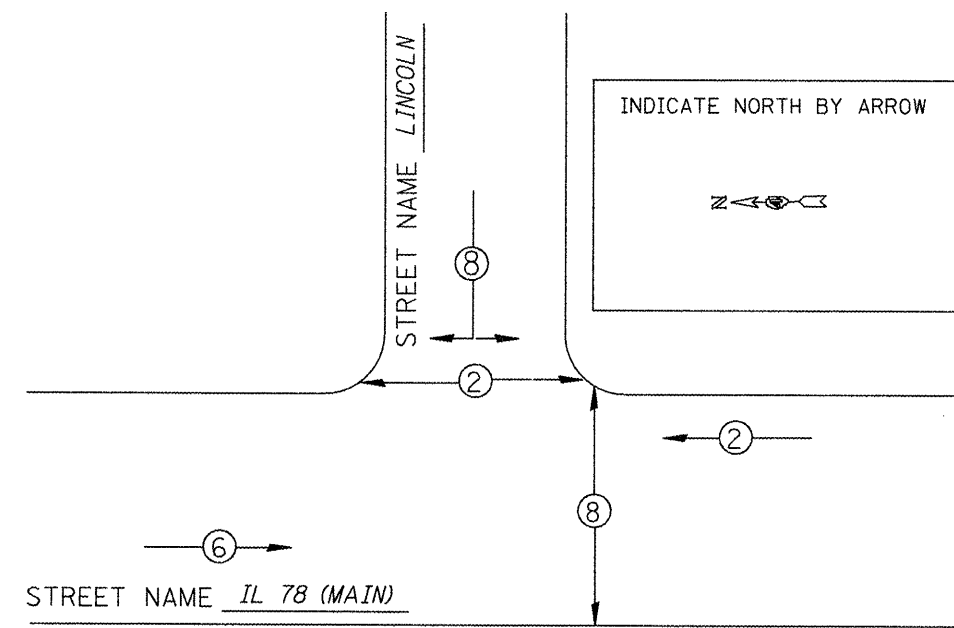

TRAFFIC SIGNALS LEGEND

- |  |                               |  |                               |  |                              |
|--|-------------------------------|--|-------------------------------|--|------------------------------|
|  | PROP.. CONTROLLER (SIGNAL)    |  | PROP. 3/C NO. 14 SIGNAL CABLE |  | PROP. SERVICE INSTALLATION   |
|  | PROP. SIGNAL HEAD W/BACKPLATE |  | PROP. 5/C NO. 14 SIGNAL CABLE |  | PROP. DETECTOR LOOP (6'X6')  |
|  | PROP. SIGNAL HEAD             |  | PROP. 7/C NO. 14 SIGNAL CABLE |  | PROP. DETECTOR LOOP (6'X40') |
|  | PROP. PEDESTRIAN SIGNAL HEAD  |  | PROP. #18 3PR T/S             |  | PROP. PED PUSHBUTTON         |

TRAFFIC SIGNALS  
 SHEET 4 OF 5  
 NOT TO SCALE

REVISIONS	
NAME	DATE

ILLINOIS DEPARTMENT OF TRANSPORTATION  
 PROPOSED TRAFFIC SIGNAL  
 PHASE AND CABLE DIAGRAMS  
 IL 78 (MAIN) & LINCOLN  
 CANTON  
 SCALE: VERT. HORIZ.  
 DATE DRAWN BY CHECKED BY