

F.A.I. RTE.	SECTION	COUNTY	TOTAL SHEETS	SHEET NO.
57	*	DOUGLAS	76	40

STA. 350+00	TO STA. 380+00
FED. ROAD DIST. NO.	ILLINOIS FED. AID PROJECT
*(15,21-25,21-26,27)RS-1	

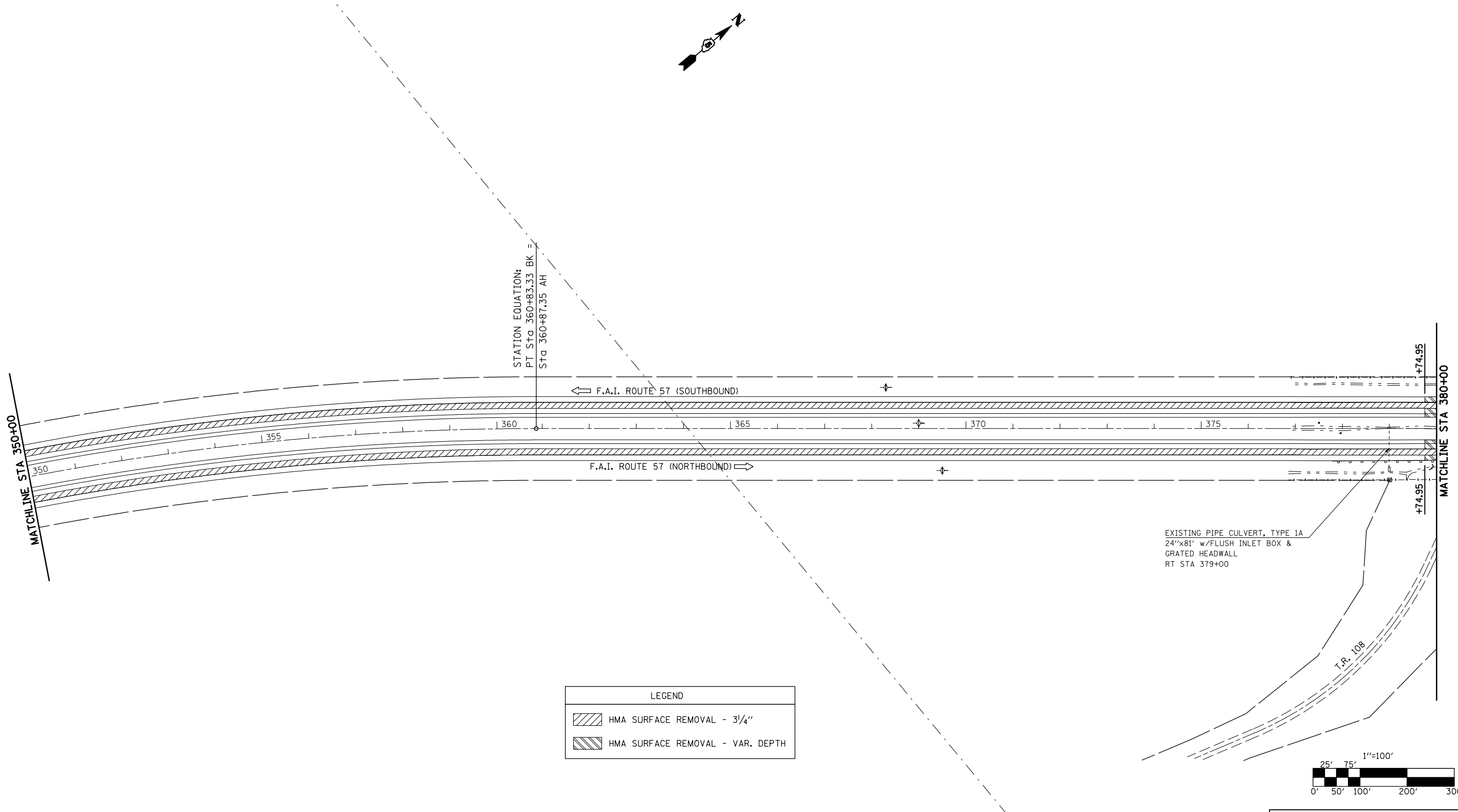

LEGEND	
	HMA SURFACE REMOVAL - 3/4"
	HMA SURFACE REMOVAL - VAR. DEPTH

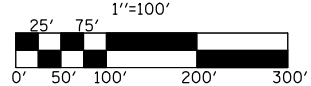

SEC. 15, T. 15 N., R. 8 E., 3RD P.M.

SEC. 10, T. 15 N., R. 8 E., 3RD P.M.

ILLINOIS DEPARTMENT OF TRANSPORTATION  
**PLAN VIEW**  
 F.A.I. ROUTE 57  
 SECTION (15,21-25,21-26,27)RS-1  
 DOUGLAS COUNTY

SCALE: 1" = 100'  
 DATE: 01/19/06

DRAWN BY: J.P.  
 CHECKED BY: K.D.

PLOT DATE = 8/21/2008  
 FILE NAME = c:\projects\1501305 (v8)\100plans\1501305.dgn  
 PLOT SCALE = 211.7647' / IN.  
 USER NAME = sheehyjm