

F.A.I. RTE.	SECTION	COUNTY	TOTAL SHEETS	SHEET NO.
57	*	DOUGLAS	76	52

\* (15,21-25,21-26,27)RS-1

# GENERAL PLAN

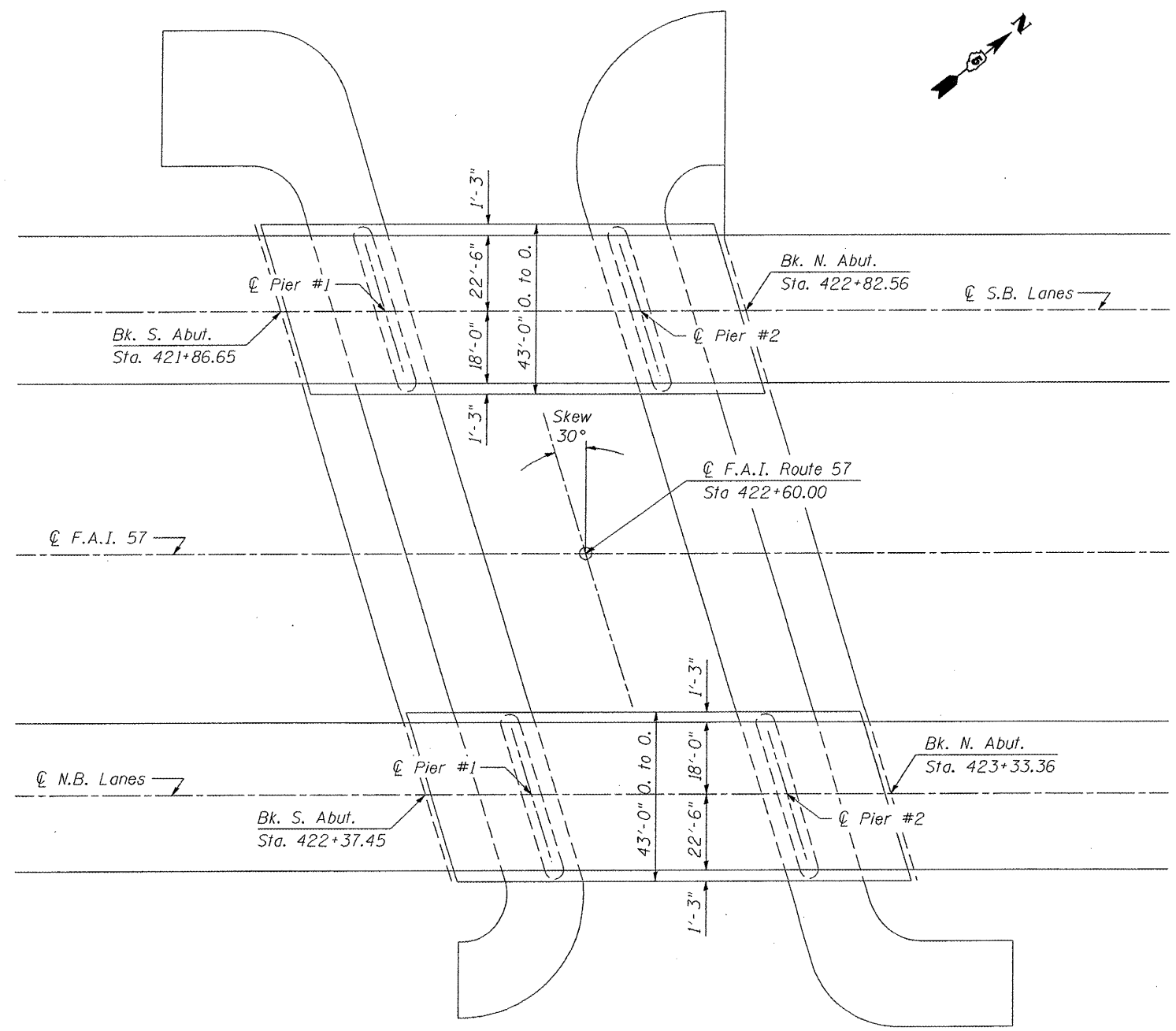

Plan dimensions and details relative to existing plans are subject to routine variations. The Contractor shall field verify existing dimensions and details affecting new construction and make necessary approved adjustments prior to construction or ordering of materials. Such variations shall not be cause for additional compensation for a change in the scope of work, however, the Contractor will be paid for the quantity actually furnished based upon the unit price bid for the work.

TOTAL BILL OF MATERIAL		
ITEM	UNIT	QUANTITY
Deck Slab Repair (Partial)	Sq Yd	14.0

PLAN  
S.N. 021-0006 N.B. &  
S.N. 021-0005 S.B.

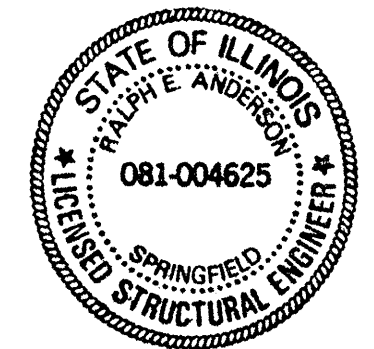

Ralph E. Anderson  
Expires Nov. 30, 2008

F.A.I. 57 OVER DRAINAGE DITCH  
SECTION 21-27B-1  
DOUGLAS COUNTY  
S.N. 021-0006 N.B. &  
S.N. 021-0005 S.B.

SHEET 1 OF 3

ILLINOIS DEPARTMENT OF TRANSPORTATION  
**GENERAL PLAN**  
F.A.I. ROUTE 57  
SECTION (15,21-25,21-26,27)RS-1  
DOUGLAS COUNTY  
SCALE: NOT TO SCALE  
DATE: 03/12/08  
DRAWN BY: J.P.  
CHECKED BY: K.D.

PLOT DATE = 8/21/2008  
PLOT SCALE = 1/8" = 1'-0"  
USER NAME = shenjun