

Contract #70517

NORTH CURB LINE

Location	Station	Offset	Theoretical Grade Elevations
Bk. E. Abut.	407+97.25	-20.37	768.22
A	408+07.25	-20.29	768.26
B	408+17.25	-20.17	768.32
End E. Appr. Pav't	408+27.25	-20.03	768.38

NORTH EDGE OF PAVEMENT

Location	Station	Offset	Theoretical Grade Elevations
Bk. E. Abut.	407+97.25	-11.95	768.40
A	408+07.25	-11.87	768.44
B	408+17.25	-11.75	768.50
End E. Appr. Pav't	408+27.25	-11.61	768.56

☉ ROADWAY & PG

Location	Station	Offset	Theoretical Grade Elevations
Bk. E. Abut.	407+97.25	-0.00	768.59
A	408+07.25	-0.00	768.63
B	408+17.25	-0.00	768.69
End E. Appr. Pav't	408+27.25	-0.00	768.75

SOUTH EDGE OF PAVEMENT

Location	Station	Offset	Theoretical Grade Elevations
Bk. E. Abut.	407+97.25	12.05	768.40
A	408+07.25	12.13	768.44
B	408+17.25	12.25	768.50
End E. Appr. Pav't	408+27.25	12.39	768.56

SOUTH CURB LINE

Location	Station	Offset	Theoretical Grade Elevations
Bk. E. Abut.	407+97.25	20.47	768.22
A	408+07.25	20.55	768.26
B	408+17.25	20.67	768.32
End E. Appr. Pav't	408+27.25	20.81	768.38

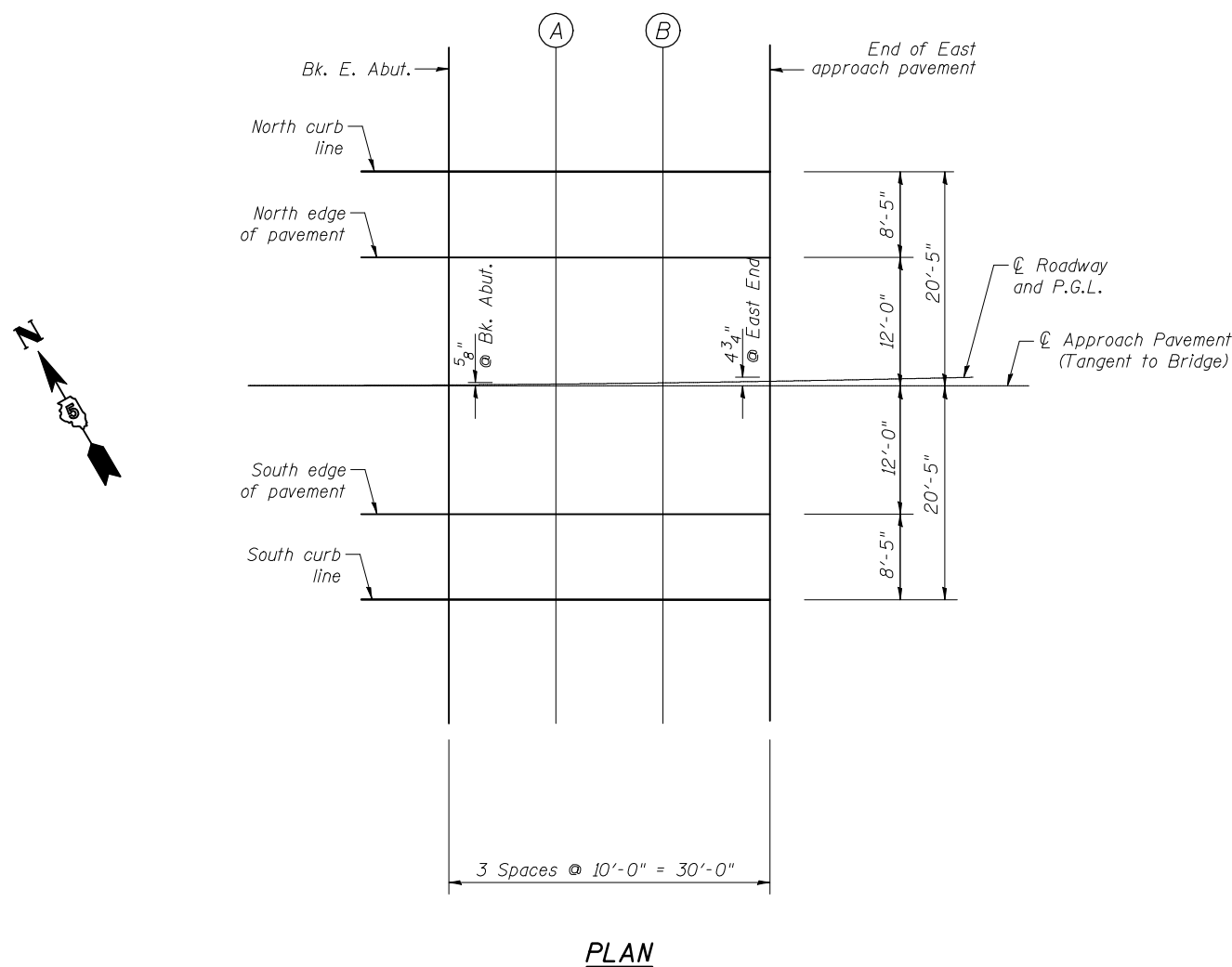

PLAN

**TOP OF EAST APPROACH
SLAB ELEVATIONS
US. ROUTE 150
OVER KICKAPOO CREEK
FAU ROUTE 6406 SECTION 1(BR-2)
MCLEAN COUNTY
STATION 407+23.50
STRUCTURE NO. 057-0246**