

ROUTE NO.	SECTION	COUNTY	TOTAL SHEETS	SHEET NO.
S.B.L. F.A.	1-28-1-3	ADAMS	159	121
FED. ROAD DIST. NO. 7	ILLINOIS	FED. AD PROJECT BR-F-631		

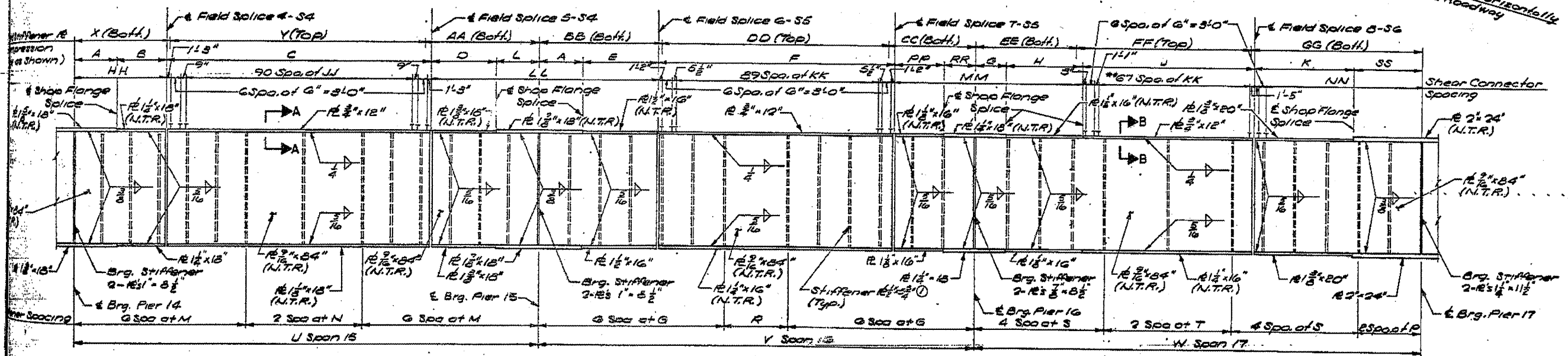
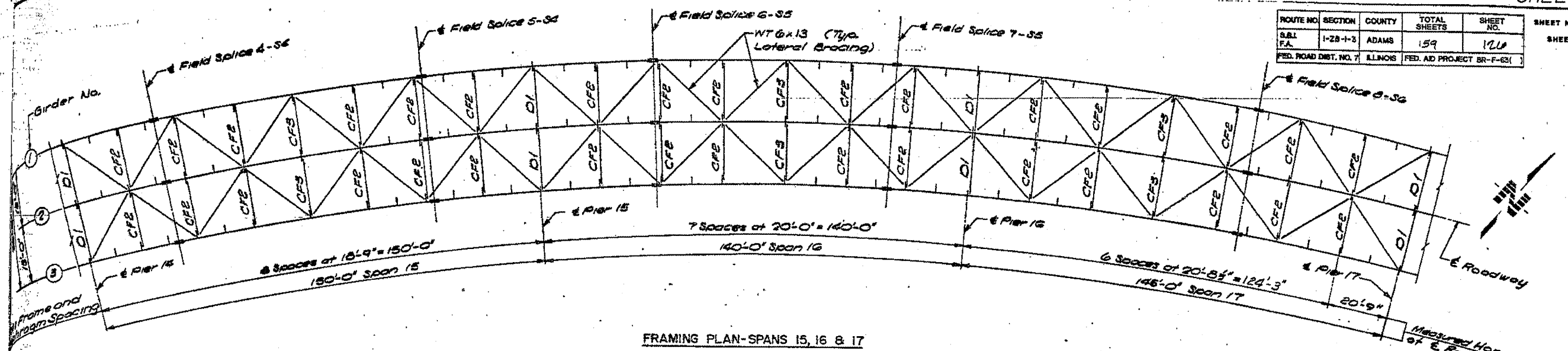

GIRDER DIMENSIONS							
DIM.	GIRDER NO.			DIM.	GIRDER NO.		
	1	2	3		1	2	3
A	14'-1 1/2"	14'-0"	13'-10 1/2"	W	146'-10 1/2"	145'-10"	143'-11 1/2"
B	18'-1 1/2"	18'-0"	17'-10 1/2"	X	30'-11 1/2"	30'-9"	30'-6 1/2"
C	55'-7 1/2"	55'-0"	54'-4 1/2"	Y	83'-1 1/2"	82'-6"	81'-10 1/2"
D	18'-1 1/2"	18'-0"	17'-10 1/2"	AA	37'-0 1/2"	36'-9"	36'-5 1/2"
E	24'-2 1/2"	24'-0"	23'-9 1/2"	BB	35'-9 1/2"	35'-6"	35'-2 1/2"
F	73'-0 1/2"	73'-0"	72'-9 1/2"	CC	27'-2 1/2"	27'-0"	26'-9 1/2"
G	10'-0 1/2"	10'-0"	9'-11 1/2"	DD	75'-0 1/2"	74'-6"	73'-11 1/2"
H	24'-2 1/2"	24'-0"	23'-9 1/2"	EE	30'-9 1/2"	30'-7"	30'-4 1/2"
J	56'-4 1/2"	56'-0"	55'-7 1/2"	FF	59'-1 1/2"	59'-0"	58'-9 1/2"
K	34'-8 1/2"	34'-0"	33'-9 1/2"	GG	55'-8 1/2"	54'-11"	54'-6 1/2"
L	17'-1 1/2"	17'-0"	16'-10 1/2"	HH	30'-2 1/2"	30'-0"	29'-9 1/2"
M	9'-5 1/2"	9'-4 1/2"	9'-3 1/2"	JJ	10'-1 1/2"	10'-0"	9'-9 1/2"
N	18'-10 1/2"	18'-9"	18'-7 1/2"	KK	9'-10"	9'-8"	8'-11 1/2"
P	10'-5 1/2"	10'-4 1/2"	10'-3 1/2"	LL	73'-6 1/2"	73'-0"	72'-5 1/2"
R	20'-1 1/2"	20'-0"	19'-10 1/2"	MM	60'-5 1/2"	60'-0"	59'-6 1/2"
S	10'-5 1/2"	10'-4 1/2"	10'-3 1/2"	NN	50'-1 1/2"	50'-7"	50'-2 1/2"
T	20'-10 1/2"	20'-8 1/2"	20'-6 1/2"	PP	16'-2 1/2"	16'-5"	16'-7 1/2"
U	151'-1"	150'-0"	148'-11 1/2"	RR	9'-9 1/2"	9'-9"	9'-8 1/2"
V	141'-0 1/2"	140'-0"	138'-11 1/2"	SS	21'-1 1/2"	21'-0"	20'-10 1/2"

NOTES

- Intermediate Stiffeners shall be located on the inside face of Girders ① and ③, and on either face of Girder ②.
- Plate designated by (N.T.R.) shall conform to the Supplemental Requirements for Notch Toughness (Zone 2). These components are the Tension Flanges, Webs, and all Splice Plate material of the Steel Girder.
- Weld Cross Frame Connection and Bearing Stiffener R3 to top and/or bottom flanges, as detailed on Sheet 71.
- For Section A-A and B-B see Sheet 6A.
- For Shop Flange Splice Detail see Sheet 6B.
- Four (4) Shear Connectors per row this area only.
- For stiffener clearance at flange splice, see Detail C on Sheet 6A.

REV. NO.	DRAWN	CHKD.	APPR.	DESCRIPTION	DATE
				F A ROUTE 63 (U. S. ROUTE 24) OVER MISSISSIPPI RIVER QUINCY, ILLINOIS EAST APPROACH - STEEL ALTERNATE FRAMING PLAN AND GIRDER ELEVATION SPANS 15, 16 & 17	

EXISTING STEEL PLANS
FOR INFORMATION ONLY