

F.A.P. RTE.	SECTION	COUNTY	TOTAL SHEETS	SHEET NO.
609	...	ST. CLAIR	350	26
STA. -		TO STA. -		
FED. ROAD DIST. NO.		ILLINOIS FED. AID PROJECT		
... 76RS-3, 76-2BR-21				

HORIZONTAL AND VERTICAL CONTROL

BENCH MARKS
SEE PLAN & PROFILE SHEETS FOR BENCH MARK DATA.

Course from 599 to PC C03 N 0° 18' 13.36" E Dist 1,951.9844

Curve Data				

Curve C03				
P.I. Station	92+48.10	N	661,785.6576	E 2,318,253.8061
Delta	= 8° 33' 49.60"	(LT)		
Degree	= 1° 59' 59.65"			
Tangent	= 214.5045			
Length	= 428.2100			
Radius	= 2,864.9300			
External	= 8.0190			
Long Chord	= 427.8115			
Mid. Ord.	= 7.9966			
P.C. Station	90+33.60	N	661,571.1561	E 2,318,252.6691
P.T. Station	94+61.81	N	661,997.9369	E 2,318,222.9890
C.C.		N	661,586.3424	E 2,315,387.7793
Back	= N 0° 18' 13.36"	E		
Ahead	= N 8° 15' 36.24"	W		
Chord Bear	= N 3° 58' 41.44"	W		

Course from PT C03 to PC C04 N 8° 15' 36.24" W Dist 348.3406

Curve Data				

Curve C04				
P.I. Station	100+31.16	N	662,561.3761	E 2,318,141.1931
Delta	= 8° 49' 20.25"	(RT)		
Degree	= 1° 59' 59.65"			
Tangent	= 221.0050			
Length	= 441.1363			
Radius	= 2,864.9300			
External	= 8.5117			
Long Chord	= 440.7006			
Mid. Ord.	= 8.4865			
P.C. Station	98+10.15	N	662,342.6638	E 2,318,172.9441
P.T. Station	102+51.29	N	662,782.3704	E 2,318,143.3617
C.C.		N	662,754.2583	E 2,321,008.1538
Back	= N 8° 15' 36.24"	W		
Ahead	= N 0° 33' 44.00"	E		
Chord Bear	= N 3° 50' 56.12"	W		

Course from PT C04 to PC C05 N 0° 33' 44.00" E Dist 1,028.0069

Beginning chain ZING WEST description

Point 90113	N	661,891.5420	E 2,316,815.1700	Sta 485+77.94
Course from 90113 to 91000	S	89° 41' 38.11"	E Dist 1,422.0605	
Point 91000	N	661,883.9452	E 2,318,237.2102	Sta 500+00.00

Ending chain ZING WEST description

Beginning chain ZING EAST description

Point 90110	N	661,905.8470	E 2,318,234.8376	Sta 500+00.00
Course from 90110 to 90112	S	85° 39' 32.22"	E Dist 374.1548	
Point 90112	N	661,877.5260	E 2,318,607.9190	Sta 503+74.15

Ending chain ZING EAST description

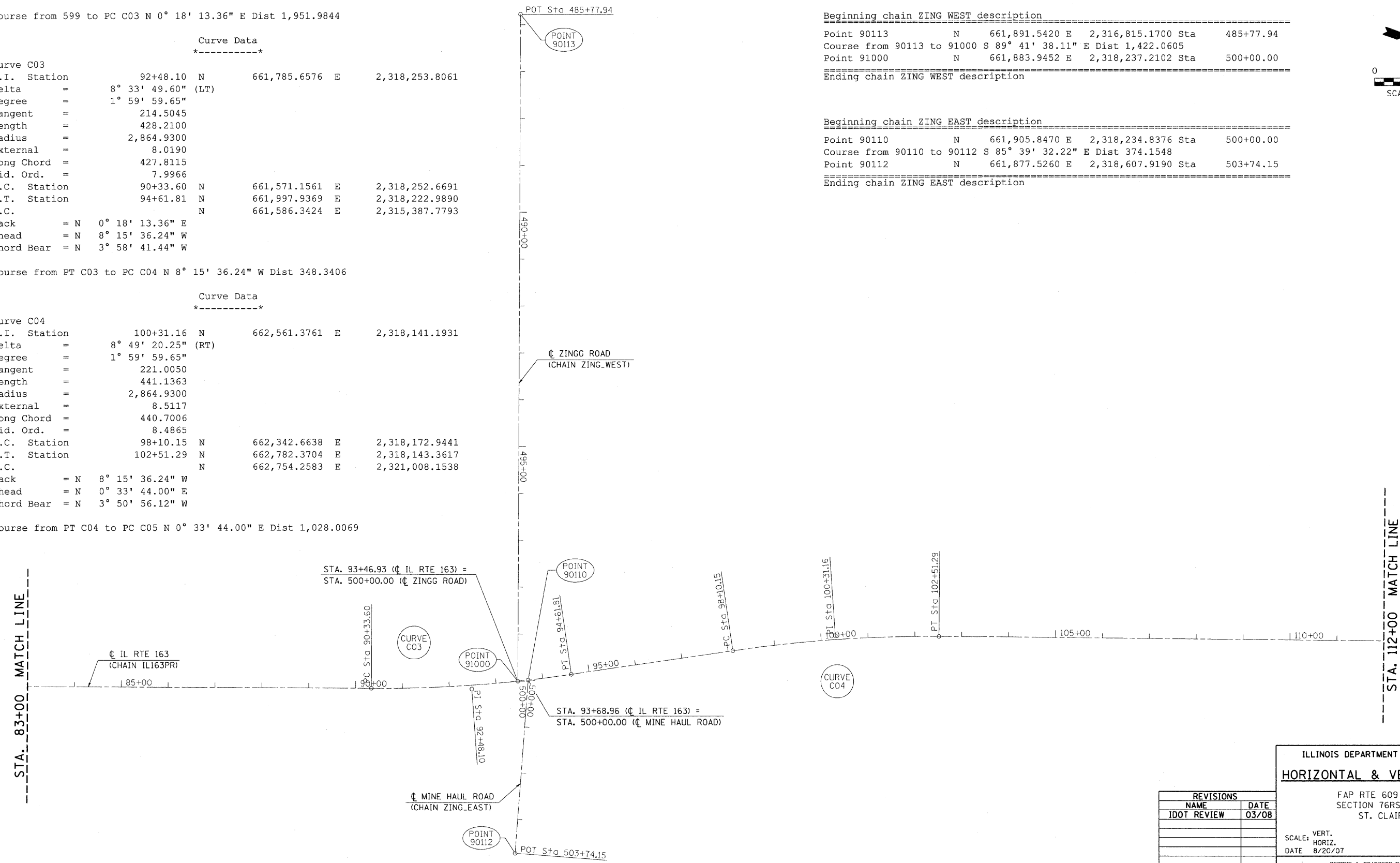
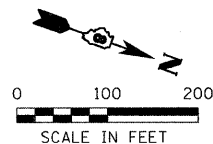

PLOT DATE = 7/28/2008 11:52:12 AM
 FILE NAME = J:\2007\DRAWINGS\HVC163A.dgn
 PLOT SCALE = 100.0000 / IN.
 MODEL = Defaul
 OPERATOR = marks

REVISIONS	
NAME	DATE
IDOT REVIEW	03/08

ILLINOIS DEPARTMENT OF TRANSPORTATION
HORIZONTAL & VERTICAL CONTROL

FAP RTE 609 (IL RTE. 163)
 SECTION 76RS-3, 76-2BR-21
 ST. CLAIR COUNTY

SCALE: VERT. _____
 HORIZ. _____
 DATE 8/20/07

DRAWN BY SUTHEARD
 CHECKED BY BOTI

GREENE & BRADFORD, INC.
 OF SPRINGFIELD

REGISTERED PROFESSIONAL ENGINEERS
 SPRINGFIELD, ILLINOIS, 62702
 PROFESSIONAL DESIGN FOR ILLINOIS
 PROFESSIONAL & STRUCTURAL ENGINEERING CORPORATION
 4217 FAS ROAD, SUITE 201, FARMINGTON, ILLINOIS 62509-4000

COMPUTER FILE NO.
 HVC163A

PROJECT 02076
 8/20/07-MDS