

F.A.P. RTE.	SECTION	COUNTY	TOTAL SHEETS	SHEET NO.
609	***	ST. CLAIR	350	47
STA. 131+00		TO STA. 146+00		
FED. ROAD DIST. NO. ILLINOIS FED. AID PROJECT				
*** 76RS-3, 76-2BR-21				

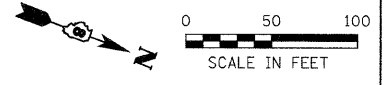

DESIGN		
INT.	DATE	REASON

BY		
DATE	BY	REASON

PLOTS & CHECKS		
INT.	DATE	REASON

BY		
DATE	BY	REASON

CHECKS		
INT.	DATE	REASON

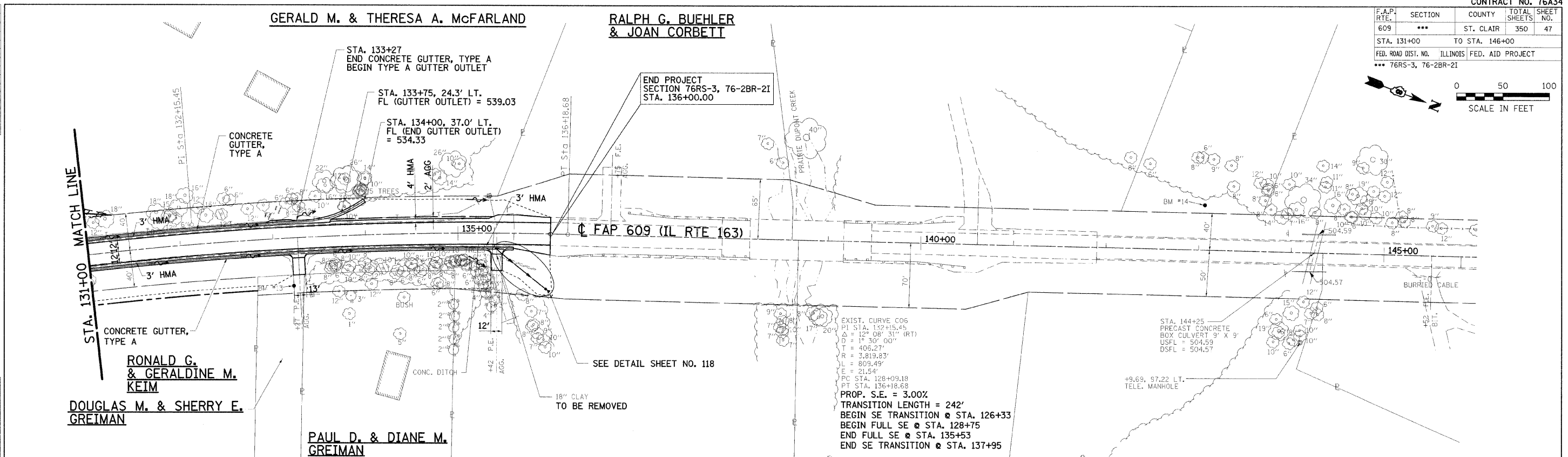

<p>BM # 13 STA. 132+20, 57' RT. TOP OF 24"x3/8" REBAR ON SOUTH SIDE GRAVEL DRIVE. ELEV. 547.02</p>	<p>ERIC WALTER MERZ</p>	<p>BM # 14 STA. 143+05, 52' LT. TOP 24"x3/8" REBAR IN EMBANKMENT ELEV. 513.64</p>	<table border="1"> <tr><th>REVISION</th><th>DATE</th><th>BY</th></tr> <tr><td> </td><td> </td><td> </td></tr> <tr><td> </td><td> </td><td> </td></tr> <tr><td> </td><td> </td><td> </td></tr> </table>	REVISION	DATE	BY										<p>GREENE & BRADFORD, INC. OF SPRINGFIELD</p>	<p>COMPUTER FILE NO. PLN163C_V8-04</p>
REVISION	DATE	BY															

