

F.A.P. RTE.	SECTION	COUNTY	TOTAL SHEETS	SHEET NO.
609	***	ST. CLAIR	350	97
STA.		TO STA.		
FED. ROAD DIST. NO.	ILLINOIS	FED. AID PROJECT		
***76RS-3, 76-2BR-21				

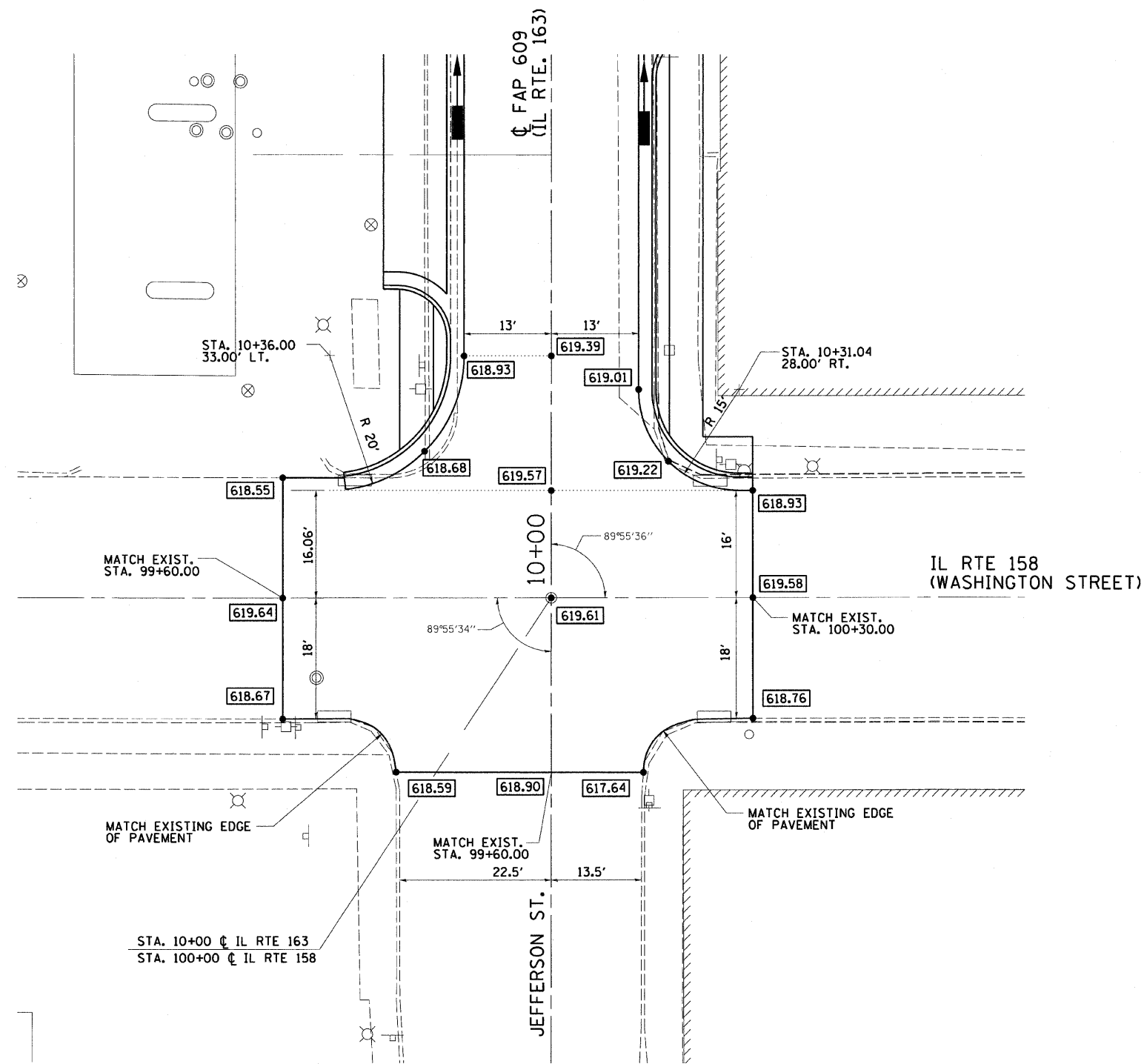

IL RTE. 163 / IL RTE. 158 INTERSECTION DETAIL

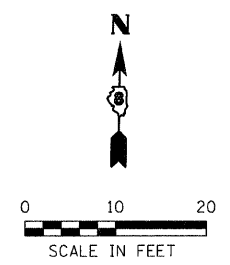

ILLINOIS DEPARTMENT OF TRANSPORTATION
INTERSECTION DETAILS
 FAP 609 (ILLINOIS ROUTE 163)
 SECTION 76RS-3, 76-2BR-21
 ST. CLAIR COUNTY

VERT. SCALE:	DESIGNED BY: SUTHEARD
HORIZ. SCALE:	DESIGNED BY: BOTT
DATE: 11/26/02	CHECKED BY: BOTT

REVISIONS

NAME	DATE
100T REVIEW	03/08

GREENE & BRADFORD, INC.
 OF SPRINGFIELD
 CONSULTING ENGINEERS
 300 CONSTITUTION DRIVE
 SPRINGFIELD, ILLINOIS 62707
 217.793-8844

COMPUTER FILE NO.
 02076INT01_V8-1
 PROJECT: 02076
 6/18/07-MDS

DESIGN		
INT.	DATE	REASON

PLOTS & CHECKS			
INT.	DATE	NO.	REASON

CHECKS		
INT.	DATE	REASON