

DESIGN		
INT.	DATE	REASON

PLAN		
NO.	DATE	BY

PLOTS & CHECKS		
INT.	DATE	REASON

PROFILE		
NO.	DATE	BY

CHECKS		
INT.	DATE	REASON

RAYMOND AND GERTRUDE HELLWIG

WILLIAM E. & MARGUERITE SCHARF

WILLIAM E. & MARGUERITE SCHARF

JOHN R. AND CECILLE M. JUTTON

DOROTHY P. AND JOHN A. LOFLAMME

DAVID LEE & BARBARA JEAN SIMPSON

RANDALL AND BETHANN EASTWOOD

F.A.P. RTE.	SECTION	COUNTY	TOTAL SHEETS	SHEET NO.
609	76-2BR-2I	ST. CLAIR	350	126
STA. 236+00		TO STA. 251+00		
FED. ROAD DIST. NO.		ILLINOIS	FED. AID PROJECT	

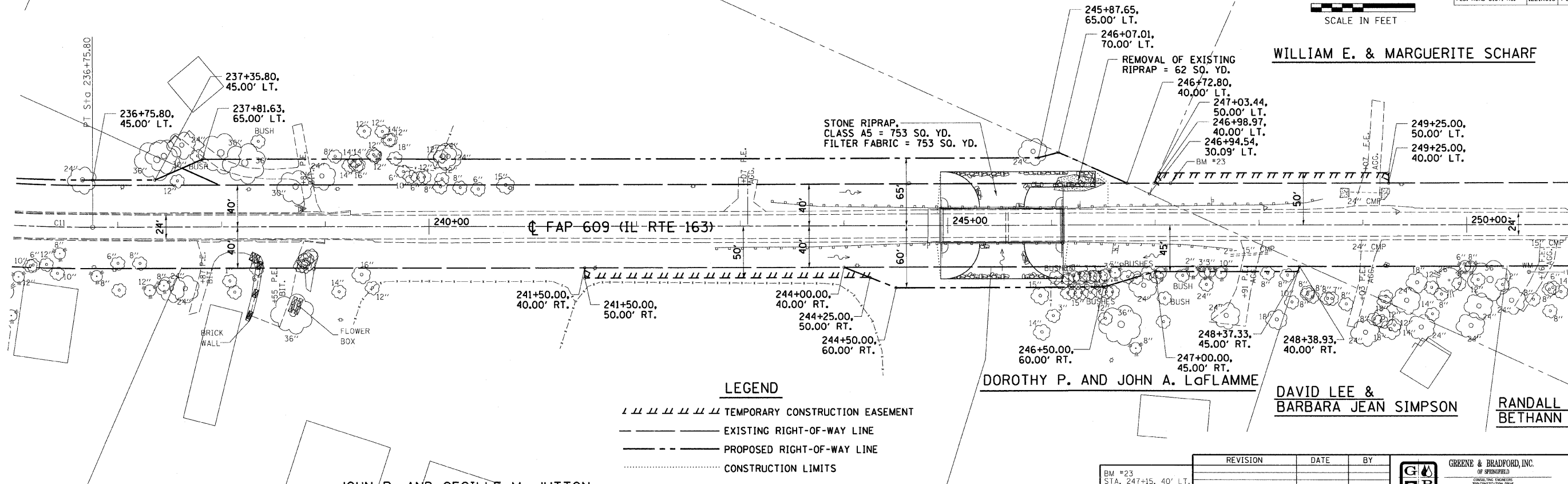
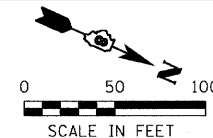

- LEGEND**
- TEMPORARY CONSTRUCTION EASEMENT
 - EXISTING RIGHT-OF-WAY LINE
 - PROPOSED RIGHT-OF-WAY LINE
 - CONSTRUCTION LIMITS

BM #23
STA. 247+15, 40' LT.
SPIKE IN PP
ELEV. 451.86

REVISION	DATE	BY

GREENE & BRADFORD, INC.
OF SPRINGFIELD
CONSULTING ENGINEERS
PROFESSIONAL ENGINEERS
REGISTERED IN ILLINOIS
1001 W. BARKER, 2ND FLOOR, SPRINGFIELD, IL 62761
TEL: 217-223-1111 FAX: 217-223-1112

COMPUTER FILE NO.
PLN163EBR
PROJECT: 02076
9/27/07-MML

