

F.A.P. RTE.	SECTION	COUNTY	TOTAL SHEETS	SHEET NO.
609	***	ST. CLAIR	350	153
STA. 24+36.78		TO STA. 24+75.00		
FED. ROAD DIST. NO.	ILLINOIS	FED. AID PROJECT		
*** 76RS-3, 76-2BR-21	70	80		

BY	DATE
FINAL SURVEY	
PLOTTED	
NOTE BOOK	
AREAS CHECKED	
NO.	

BY	DATE
ORIGINAL SURVEY	
PLOTTED	
NOTE BOOK	
AREAS CHECKED	
NO.	

PLOT DATE = 8/1/2008 3:28:22 PM
 FILE NAME = J:\2007\DRAWINGS\SSHT163A.VB
 PLOT SCALE = 1/8" = 100'
 MODEL = Default
 OPERATOR =

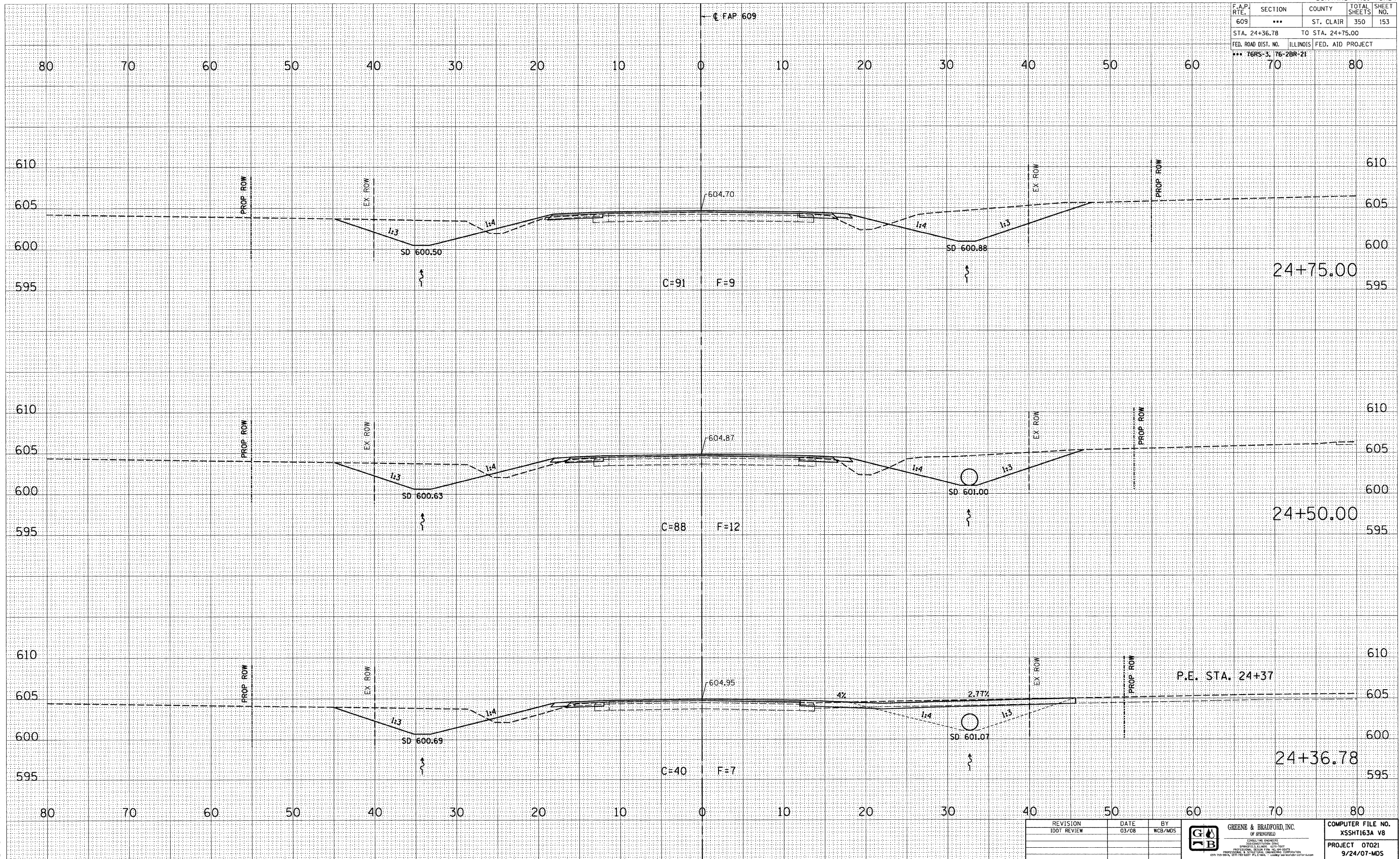

REVISION	DATE	BY
1007 REVIEW	03/08	WCB/MDS

GREENE & BRADFORD, INC.
 OF SPRINGFIELD
 CONSULTING ENGINEERS
 1000 W. WASHINGTON ST., SUITE 100
 SPRINGFIELD, ILLINOIS 62760-1000
 PHONE: 217-223-8800 FAX: 217-223-8801
 WWW: WWW.GREENE-AND-BRADFORD.COM

COMPUTER FILE NO. XSSHT163A V8
PROJECT 07021 9/24/07-MDS

MAINLINE CROSS SECTIONS - FAP 609 (IL RTE. 163) ST. CLAIR COUNTY
STA. 24+36.78 TO STA. 24+75.00