

F.A.P. RTE.	SECTION	COUNTY	TOTAL SHEETS	SHEET NO.
609	***	ST. CLAIR	350	154
STA. 25+00.00		TO STA. 25+25.00		
FED. ROAD DIST. NO.		ILLINOIS FED. AID PROJECT		
*** 76RS-3, 76-2BR-21				

BY	DATE

BY	DATE

PLOT DATE = 8/1/2008 3:28:22 PM
 FILE NAME = I:\2007\DRAWINGS\SSHT163A.VB
 PLOT SCALE = 1/4" = 100'
 MODEL = D:\tbl1
 OPERATOR = mbrs

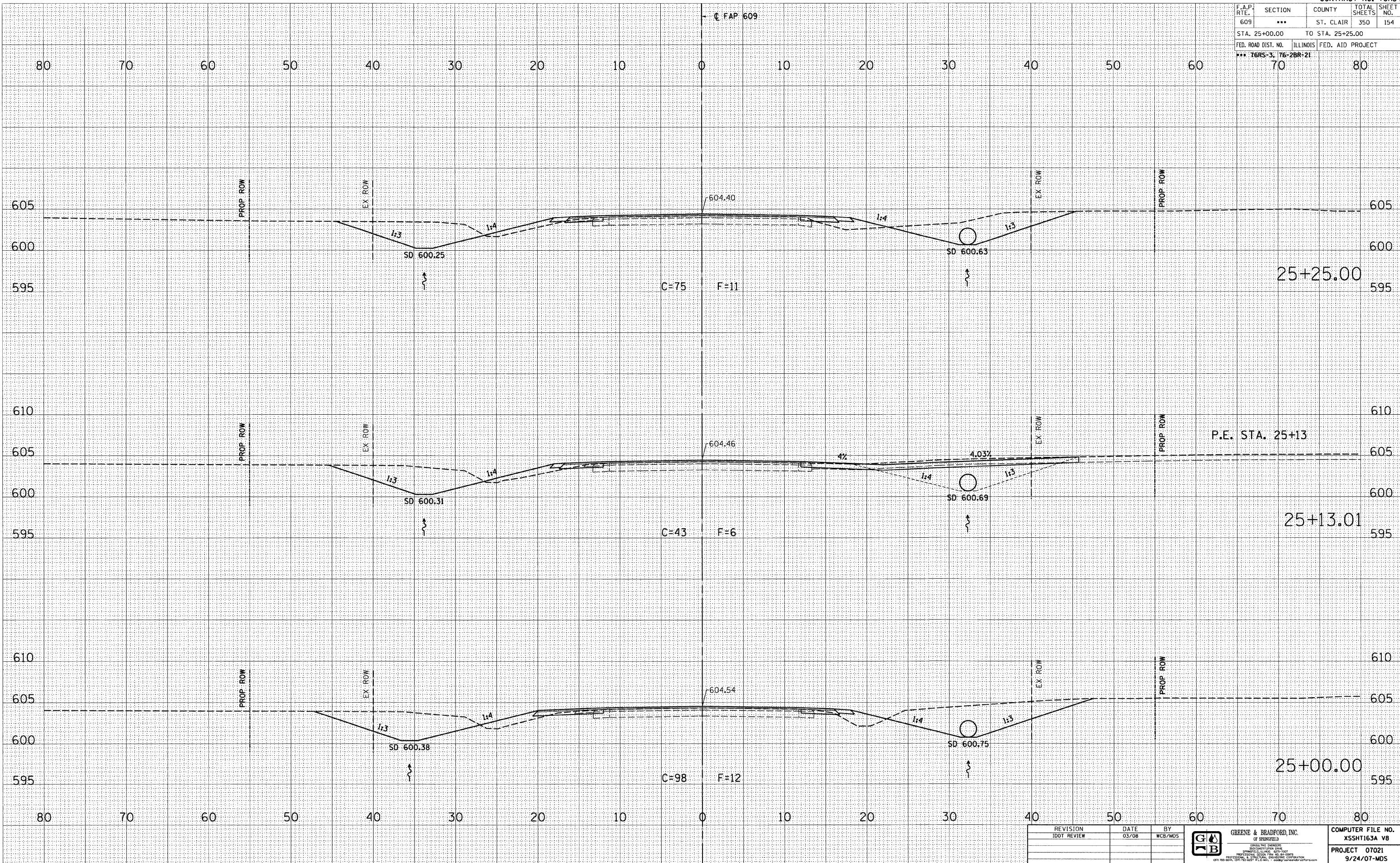

REVISION	DATE	BY

<p>GREENE & BRADFORD, INC. OF SPRINGFIELD</p> <p>REGISTERED PROFESSIONAL ENGINEERS PROFESSIONAL ENGINEERS PROFESSIONAL SURVEYORS</p>	COMPUTER FILE NO. XSSHT163A.VB PROJECT 07021 9/24/07-MDS
	DATE: 03/08 BY: WCB/MDS

MAINLINE CROSS SECTIONS - FAP 609 (IL RTE. 163) ST. CLAIR COUNTY
STA. 25+00.00 TO STA. 25+25.00