

F.A.P. RTE	SECTION	COUNTY	TOTAL SHEETS	SHEET NO.
609	***	ST. CLAIR	350	167
STA. 39+81.00		TO STA. 40+50.00		
FED. ROAD DIST. NO.		ILLINOIS FED. AID PROJECT		
*** 76RS-3, 76-2BR-21				

FINAL SURVEY	SURVEYED	BY	DATE
NOTE BOOK	PLOTTED		
NO.	AREAS		
	CHECKED		

ORIGINAL SURVEY	SURVEYED	BY	DATE
NOTE BOOK	PLOTTED		
NO.	AREAS		
	CHECKED		

PLOT DATE = 8/1/2008 4:29:21 PM
 FILE NAME = J:\02876\DRAWINGS\XSSHT163A.VB
 PLOT SCALE = 5/8" = 1' / IN.
 MODEL = Default
 OPERATOR =

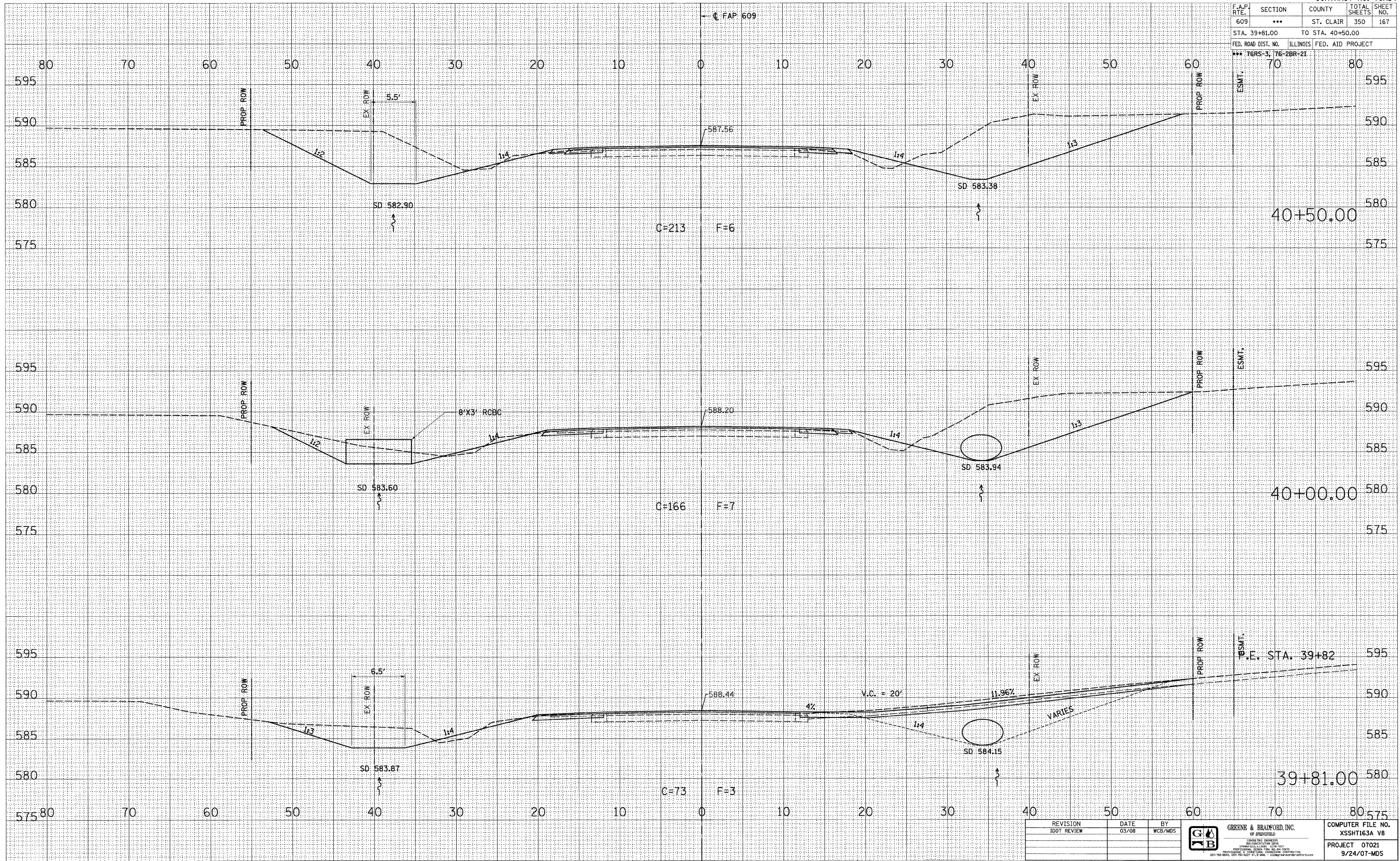

REVISION	DATE	BY
1	03/08	WCB/MDS

GREENE & BRADFORD, INC.
 OF SPRINGFIELD
 CONSULTING ENGINEERS
 200 CONVENT ROAD, SUITE 100
 SPRINGFIELD, ILLINOIS 62761-1000
 (217) 782-8944, (217) 795-4227, FAX: (217) 782-8944

COMPUTER FILE NO.
 XSSHT163A V8
 PROJECT 07021
 9/24/07-MDS

**MAINLINE CROSS SECTIONS - FAP 609 (IL RTE. 163) ST. CLAIR COUNTY
 STA. 39+81.00 TO STA. 40+50.00**