

F.A.P. RTE.	SECTION	COUNTY	TOTAL SHEETS	SHEET NO.
609	***	ST. CLAIR	350	201
STA. 78+50.00		TO STA. 79+00.00		
FED. ROAD DIST. NO.		ILLINOIS	FED. AID PROJECT	
*** 76RS-3; 76-2BR+21		70 80		

DATE	BY
DATE	BY
DATE	BY

DATE	BY
DATE	BY
DATE	BY

PLOT DATE = 8/1/2008 4:29:34 PM
 FILE NAME = J:\02876\DRAWINGS\XSSHT163A.VB
 PLOT SCALE = 5.0000 / IN.
 MODEL = Default
 OPERATOR = marks

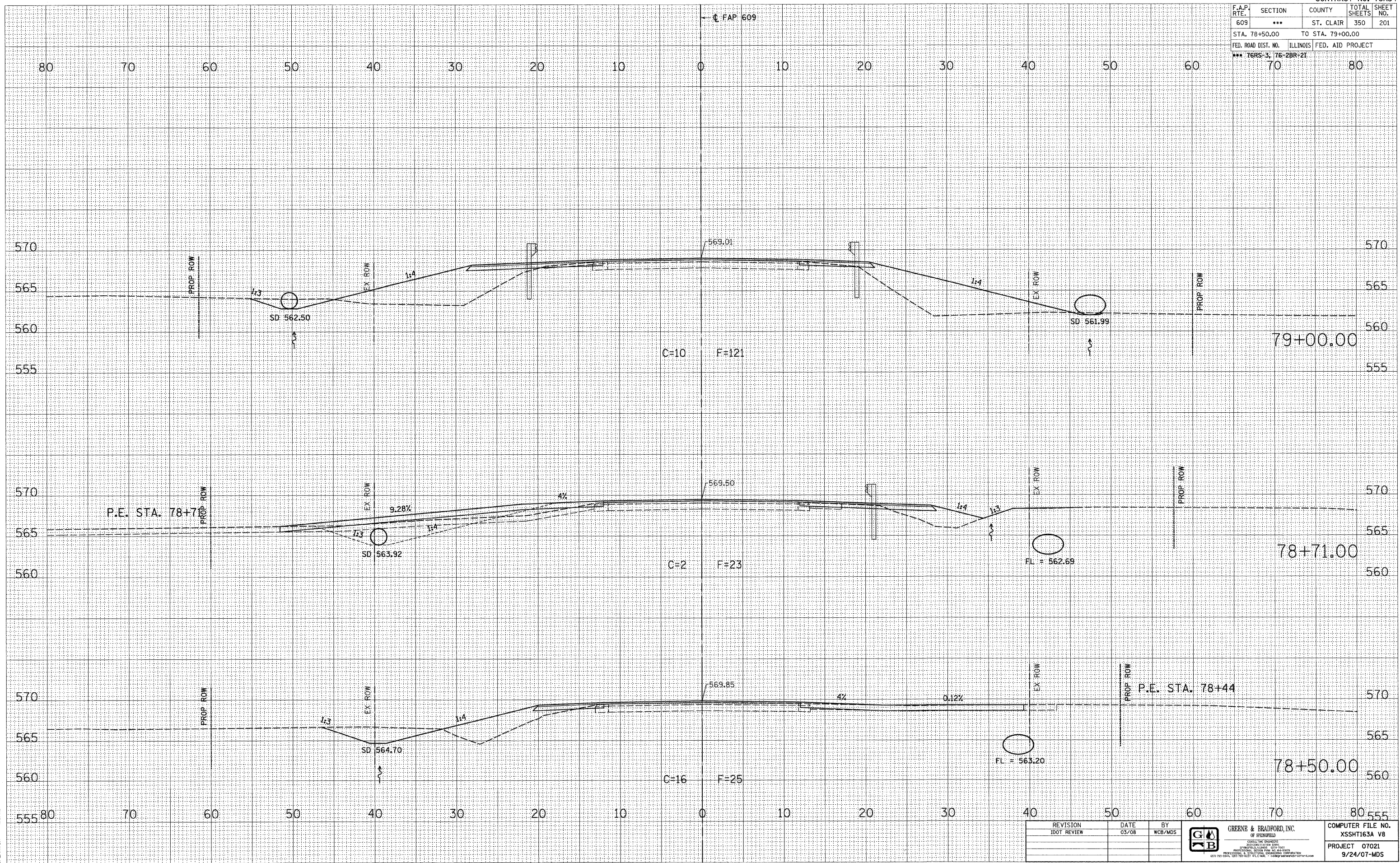

REVISION	DATE	BY	 GREENE & BRADFORD, INC. OF SPRINGFIELD <small>CONSULTING ENGINEERS PROFESSIONAL ENGINEERING FIRM NO. 020-00001 PROFESSIONAL SURVEYING CORPORATION 6201 N. 54th, 6201 N. 54th, Springfield, IL 62761</small>	COMPUTER FILE NO.
IDOT REVIEW	03/08	WCB/MDS		XSSHT163A V8
				PROJECT 07021
				9/24/07-MDS

MAINLINE CROSS SECTIONS - FAP 609 (IL RTE. 163) ST. CLAIR COUNTY
STA. 78+50.00 TO STA. 79+00.00