

F.A.P. RTE.	SECTION	COUNTY	TOTAL SHEETS	SHEET NO.
609	***	ST. CLAIR	350	206
STA. 85+00.00		TO STA. 86+00.00		
FED. ROAD DIST. NO.		ILLINOIS	FED. AID PROJECT	
*** 76RS-3, 76-2BR-21			80	

FINAL SURVEY	DATE
NO.	

ORIGINAL SURVEY	DATE
NO.	

PLOT DATE = 8/1/2008 4:29:36 PM
 FILE NAME = J:\2007\DRAWINGS\XSSHT163A.V8
 PLOT SCALE = 5/8" = 1' IN.
 MODEL = Default
 OPERATOR = marks

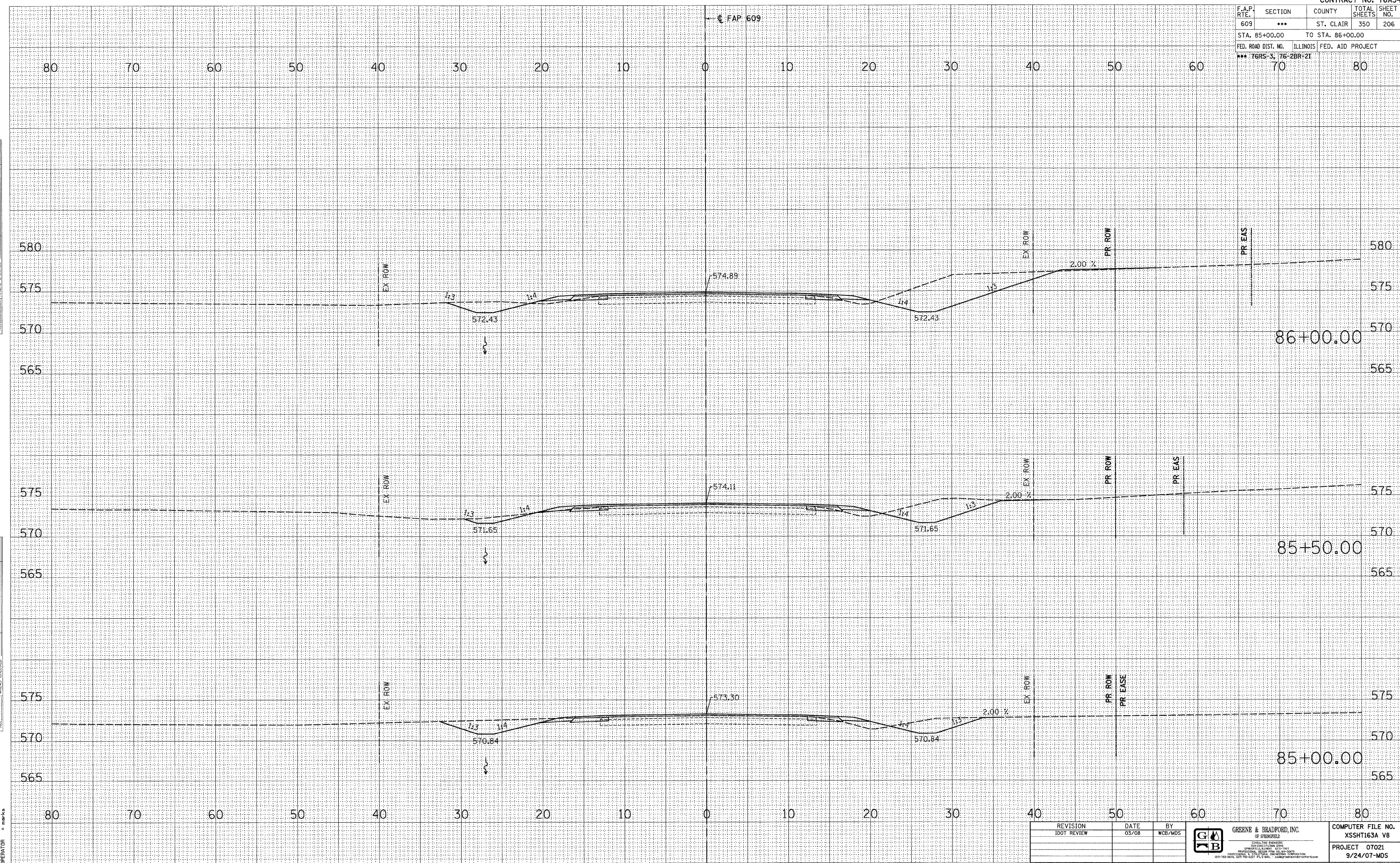

REVISION	DATE	BY
1007 REVIEW	03/08	WCB/MDS

GREENE & BRADFORD, INC.
 OF SPRINGFIELD
 CONSULTING ENGINEERS
 200 SOUTH MAIN STREET
 SPRINGFIELD, ILLINOIS 62760-1000
 PHONE: 217-223-1111 FAX: 217-223-1112
 WWW: WWW.GREENEANDBRADFORD.COM

COMPUTER FILE NO.	XSSHT163A V8
PROJECT	07021
	9/24/07-MDS

MAINLINE CROSS SECTIONS - FAP 609 (IL RTE. 163) ST. CLAIR COUNTY
STA. 85+00.00 TO STA. 86+00.00