

F.A.P. RTE.	SECTION	COUNTY	TOTAL SHEETS	SHEET NO.
609	***	ST. CLAIR	350	209
STA. 89+50.00		TO STA. 90+50.00		
FED. ROAD DIST. NO.		ILLINOIS	FED. AID PROJECT	
*** 76RS-3, 76-2BR-2T				

FINAL SURVEY	DATE
SURVEYED	
PLOTTED	
NOTE BOOK	
AREAS CHECKED	
NO.	

ORIGINAL SURVEY	DATE
CURVEY	
PLOTTED	
TEMP. LATE	
NOTE BOOK	
AREAS CHECKED	
NO.	

PLOT DATE = 8/1/2008 4:28:37 PM  
 FILE NAME = J:\2007\DRAWINGS\XSSHT163A.VB  
 PLOT SCALE = 5/8" = 1' IN.  
 MODEL = Default  
 OPERATOR = marks

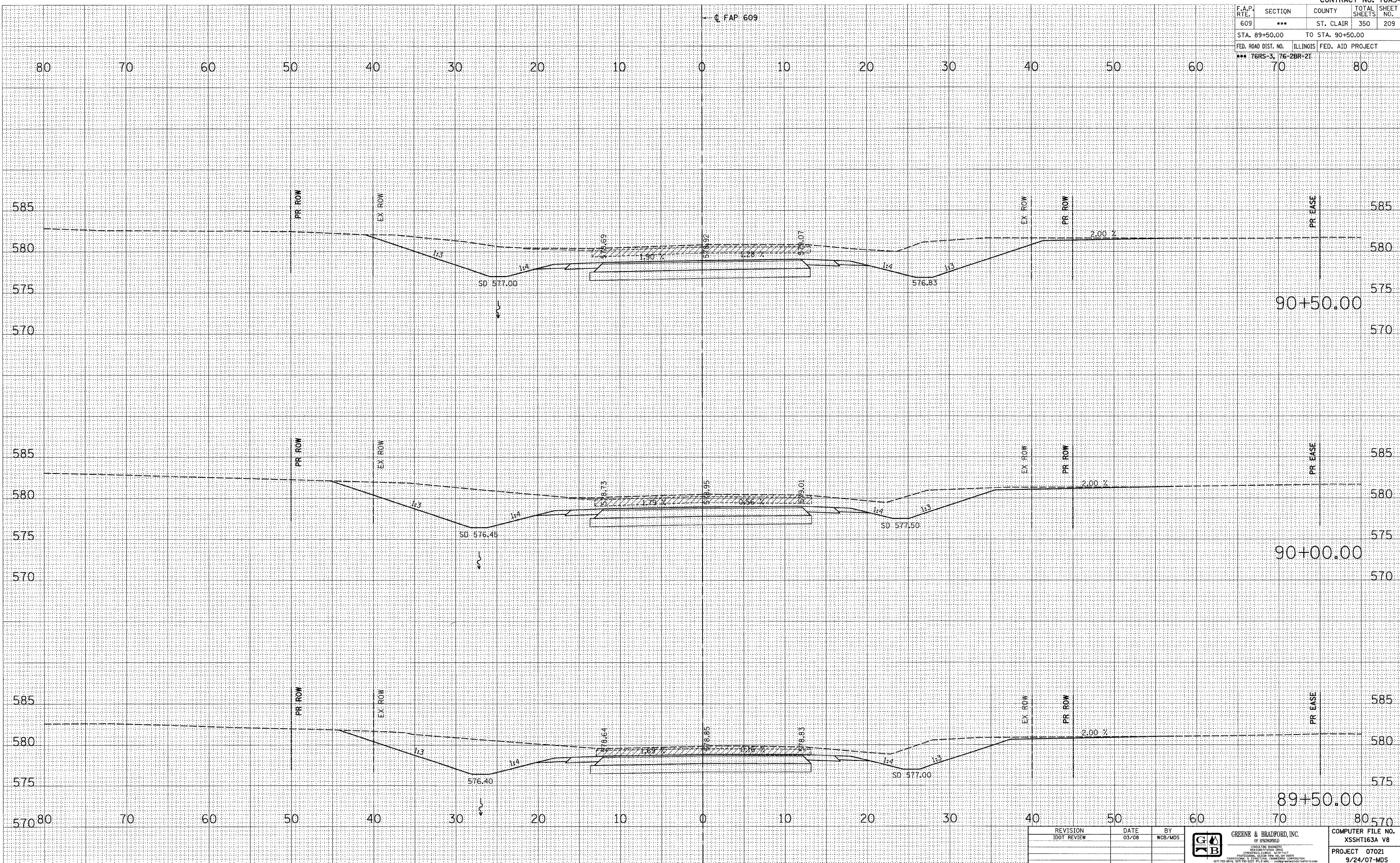

REVISION	DATE	BY
1	03/08	WCB/MDS

**GREENE & BRADFORD, INC.**  
 OF SPRINGFIELD  
 CONSULTING ENGINEERS  
 1000 W. WASHINGTON STREET  
 SPRINGFIELD, ILLINOIS 62760-3000  
 (618) 792-8944, (618) 792-8227 FAX (618) 792-8944

COMPUTER FILE NO.  
 XSSHT163A V8  
 PROJECT 07021  
 9/24/07-MDS

**MAINLINE CROSS SECTIONS - FAP 609 (IL RTE. 163) ST. CLAIR COUNTY**  
**STA. 89+50.00 TO STA. 90+50.00**