

F.A.P. RTE.	SECTION	COUNTY	TOTAL SHEETS	SHEET NO.
609	***	ST. CLAIR	350	210
STA. 90+74.00		TO STA. 91+50.00		
FED. ROAD DIST. NO.		ILLINOIS FED. AID PROJECT		
*** 76RS-3, 76-2BR-21		70		

DATE	BY
DATE	BY
DATE	BY

DATE	BY
DATE	BY
DATE	BY

PLOT DATE = 8/1/2008 4:26:37 PM
 FILE NAME = J:\2007\DRAWINGS\XSSHT163A.VB
 PLOT SCALE = 5/8" = 1' IN.
 MODEL = mrcg
 OPERATOR =

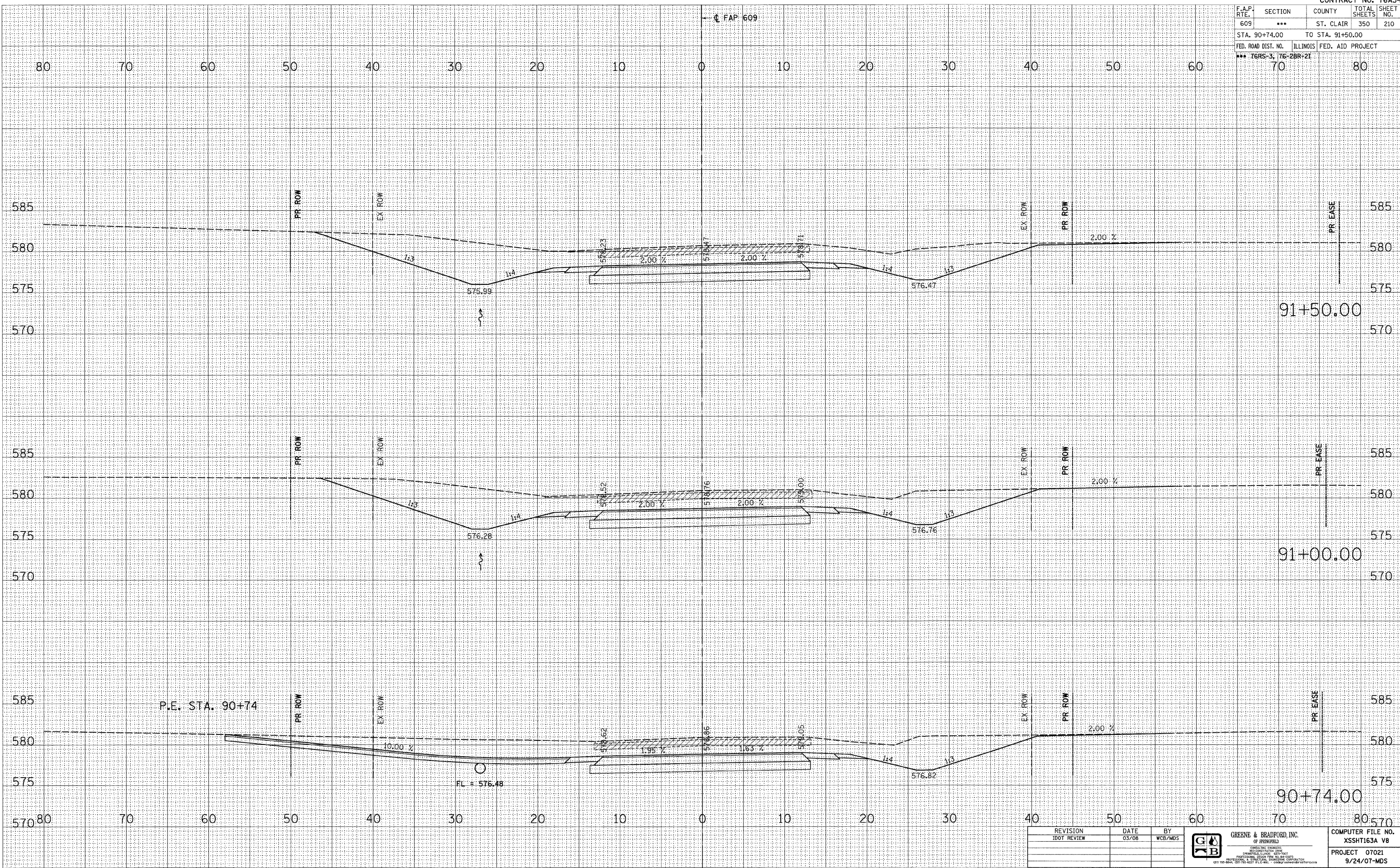

REVISION	DATE	BY
IDOT REVIEW	03/08	WCB/MDS

GREENE & BRADFORD, INC.
 OF SPRINGFIELD
 CONSULTING ENGINEERS
 200 CONVENT ROAD, SUITE 100
 SPRINGFIELD, ILLINOIS 62761
 (618) 793-8844, (618) 793-8227 FAX (618) 793-8844

COMPUTER FILE NO.
 XSSHT163A V8
 PROJECT 07021
 9/24/07-MDS

MAINLINE CROSS SECTIONS - FAP 609 (IL RTE. 163) ST. CLAIR COUNTY
STA. 90+74.00 TO STA. 91+50.00