

F.A.P. RTE.	SECTION	COUNTY	TOTAL SHEETS	SHEET NO.
609	***	ST. CLAIR	350	214
STA. 94+50.00		TO STA. 95+00.00		
FED. ROAD DIST. NO.		ILLINOIS	FED. AID PROJECT	
*** 76RS-3; 76-2BR-21				

FINAL SURVEY	BY	DATE
SURVEYED		
PLOTTED		
NOTE BOOK		
AREAS CHECKED		
NO.		

ORIGINAL SURVEY	BY	DATE
SURVEYED		
PLOTTED		
NOTE BOOK		
AREAS CHECKED		
NO.		

PLOT DATE = 8/1/2008 4:25:38 PM  
 FILE NAME = J:\02076\DRAWINGS\XSSHT163A V8.dwg  
 PLOT SCALE = 5/8" = 1' IN.  
 MODEL = Default  
 OPERATOR = mcrk

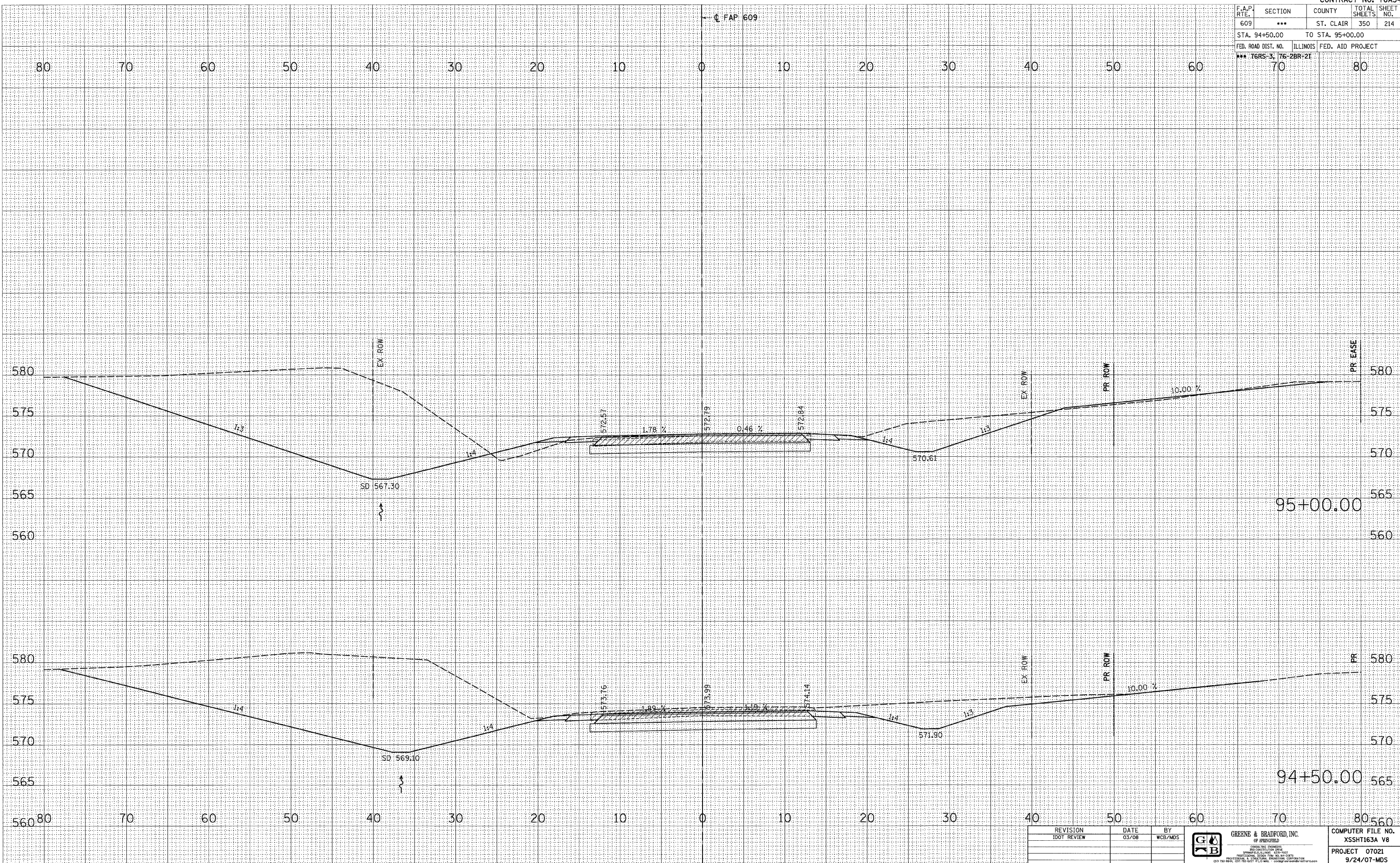

REVISION	DATE	BY
IDOT REVIEW	03/08	WCB/MDS

**GREENE & BRADFORD, INC.**  
 OF SPRINGFIELD  
 CONSULTING ENGINEERS  
 1000 CONSTITUTION DRIVE, SUITE 100  
 SPRINGFIELD, ILLINOIS 62761  
 (618) 782-8824, (618) 782-8277, FAX: (618) 782-8824

COMPUTER FILE NO.  
 XSSHT163A V8  
 PROJECT 07021  
 9/24/07-MDS

**MAINLINE CROSS SECTIONS - FAP 609 (IL RTE. 163) ST. CLAIR COUNTY**  
**STA. 94+50.00 TO STA. 95+00.00**