

F.A.P. RTE.	SECTION	COUNTY	TOTAL SHEETS	SHEET NO.
609	***	ST. CLAIR	350	216
STA. 97+00.00 TO STA. 98+00.00				
FED. ROAD DIST. NO.		ILLINOIS	FED. AID PROJECT	
*** 76RS-3, 76-ZBR-21				

DATE	BY
SURVEYED	PLOTTED
NOTE BOOK	AREAS CHECKED
NO.	

DATE	BY
SURVEYED	PLOTTED
NOTE BOOK	AREAS CHECKED
NO.	

PLOT DATE = 8/1/2008 4:28:39 PM
 FILE NAME = J:\2007\DRAWINGS\XSSHT163A.V8
 PLOT SCALE = 5/8" = 1' IN.
 MODEL = Defaults
 OPERATOR =

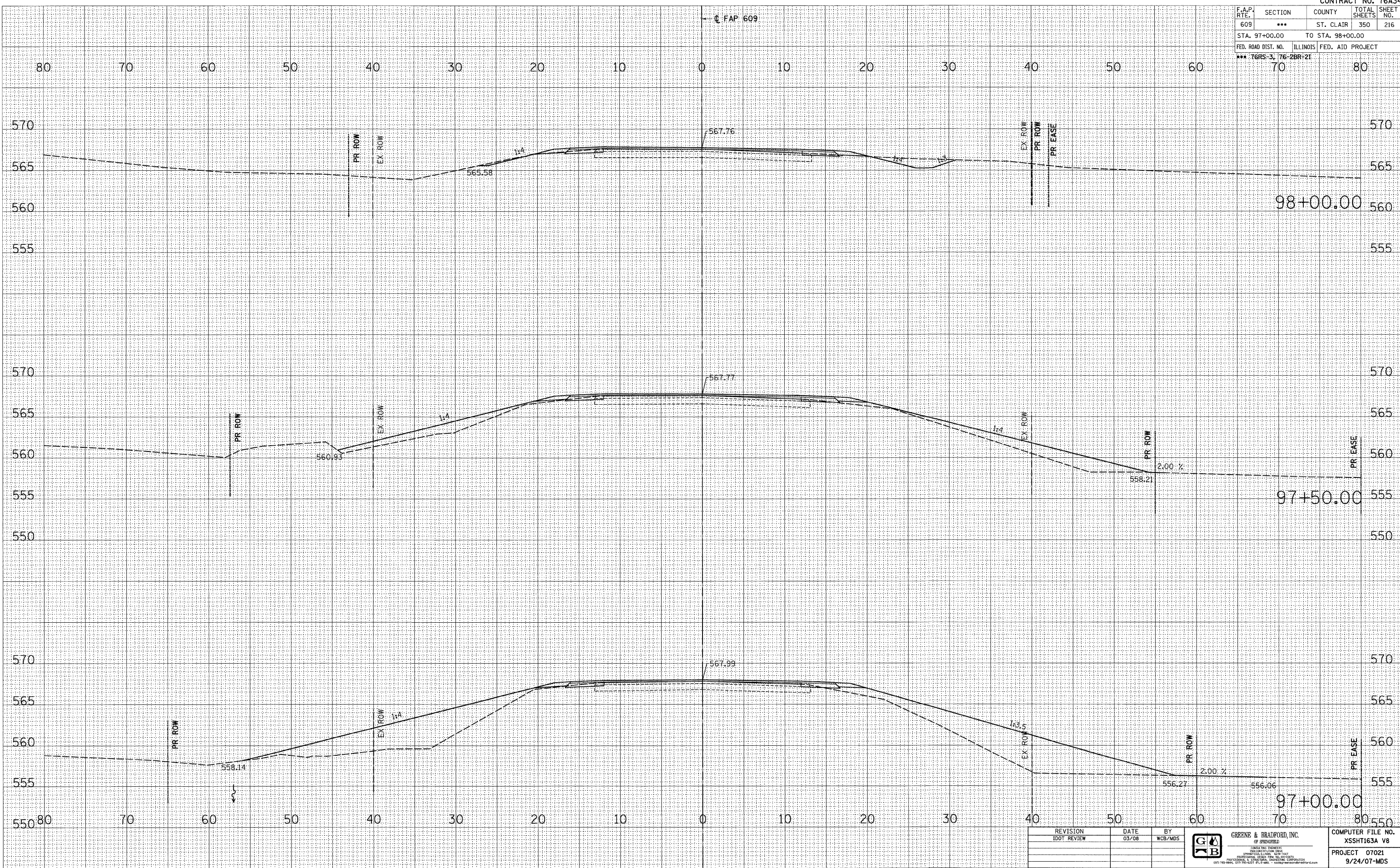

REVISION	DATE	BY
IDOT REVIEW	03/08	WCB/MDS



COMPUTER FILE NO. XSSHT163A V8
PROJECT 07021 9/24/07-MDS

MAINLINE CROSS SECTIONS - FAP 609 (IL RTE. 163) ST. CLAIR COUNTY
STA. 97+00.00 TO STA. 98+00.00