

F.A.P. RTE.	SECTION	COUNTY	TOTAL SHEETS	SHEET NO.
609	***	ST. CLAIR	350	217
STA. 98+44.16		TO STA. 99+00.00		
FED. ROAD DIST. NO.		ILLINOIS	FED. AID PROJECT	
*** 76RS-3, 76-2BR-21				

DATE	
BY	
FINAL SURVEY	
PLOTTED	
NOTE BOOK	
AREAS CHECKED	
NO.	

DATE	
BY	
ORIGINAL SURVEY	
PLOTTED	
NOTE BOOK	
AREAS CHECKED	
NO.	

PLOT DATE = 8/1/2008 4:28:39 PM
 FILE NAME = J:\2007\DRAWINGS\XSSH163A V8.dwg
 PLOT SCALE = 5.0000 / IN.
 MODEL = Default
 OPERATOR = marks

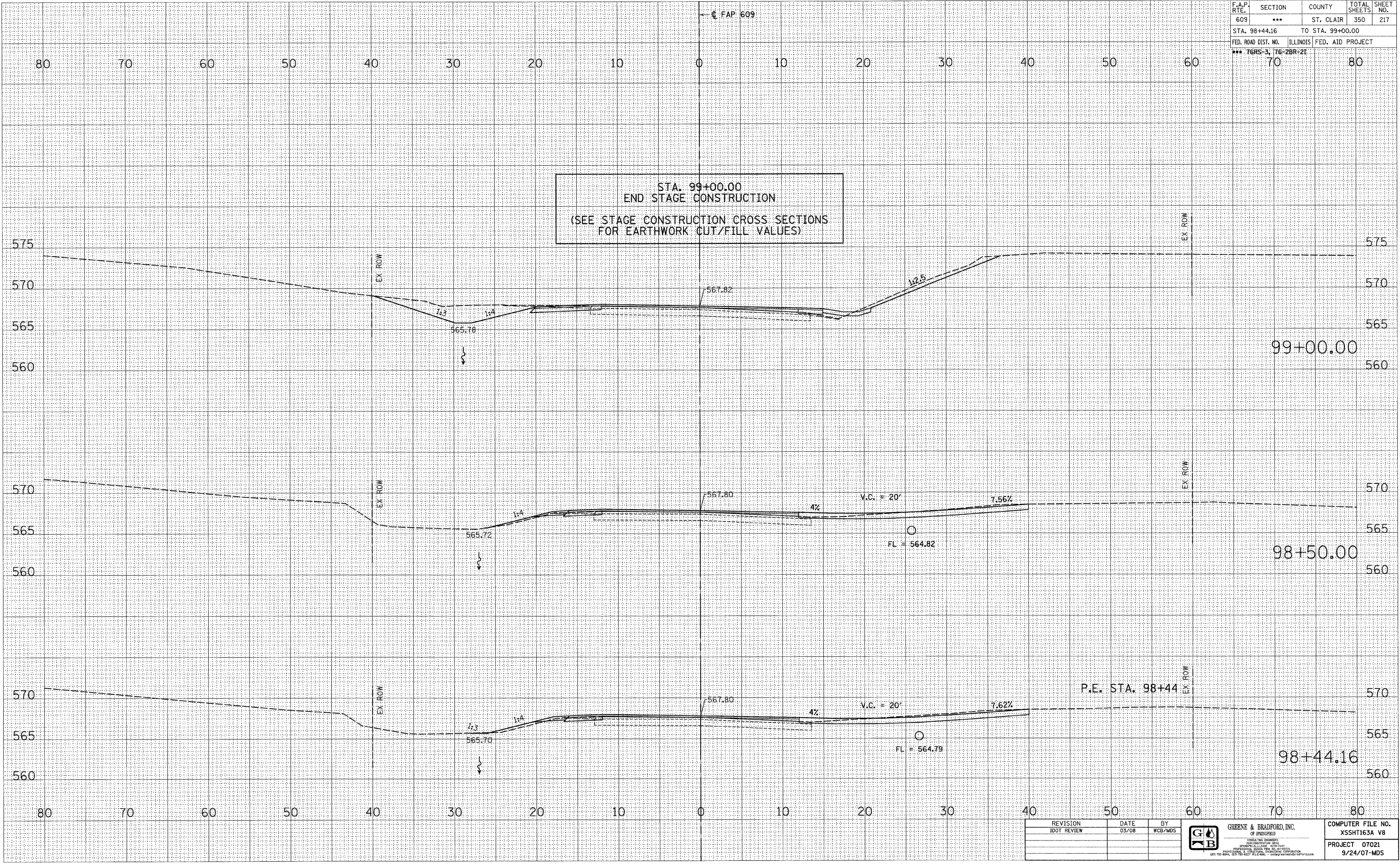

STA. 99+00.00
 END STAGE CONSTRUCTION
 (SEE STAGE CONSTRUCTION CROSS SECTIONS
 FOR EARTHWORK CUT/FILL VALUES)

REVISION	DATE	BY
IDOT REVIEW	03/08	WCB/MDS



COMPUTER FILE NO.
XSSH163A V8
PROJECT 07021
9/24/07-MDS

**MAINLINE CROSS SECTIONS - FAP 609 (IL RTE. 163) ST. CLAIR COUNTY
 STA. 98+44.16 TO STA. 99+00.00**