

F.A.P. RTE.	SECTION	COUNTY	TOTAL SHEETS	SHEET NO.
609	***	ST. CLAIR	350	219
STA. 100+50.00		TO STA. 101+43.00		
FED. ROAD DIST. NO.		ILLINOIS FED. AID PROJECT		
*** 76RS-3, 76-2BR-21		80		

DATE	BY

DATE	BY

PLOT DATE = 8/1/2008 4:25:40 PM  
 FILE NAME = J:\2007\DRAWINGS\SSHT163A V8.dwg  
 PLOT SCALE = 5/8" = 1' / IN.  
 MODEL = Default  
 OPERATOR = markb

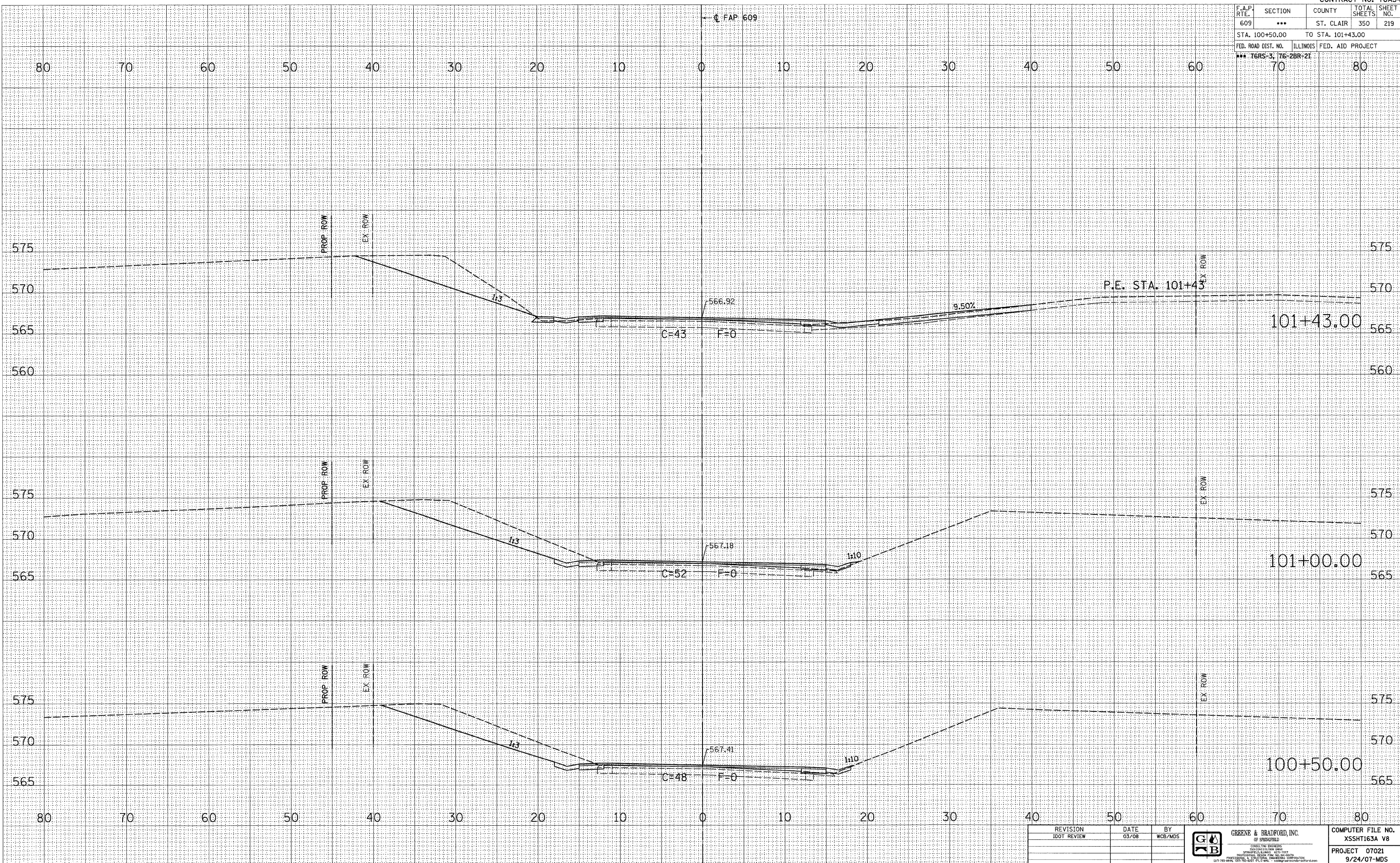

REVISION	DATE	BY



**GREENE & BRADFORD, INC.**  
 OF SPRINGFIELD  
 CONSULTING ENGINEERS  
 1000 S. LINCOLN STREET  
 SPRINGFIELD, ILLINOIS 62761-1000  
 PROFESSIONAL ENGINEERING FIRM NO. 061-00078  
 PROFESSIONAL SURVEYING FIRM NO. 061-00078  
 (217) 763-8444 (217) 763-8227 FAX (217) 763-8444

COMPUTER FILE NO.  
 XSSHT163A V8  
 PROJECT 07021  
 9/24/07-MDS

**MAINLINE CROSS SECTIONS - FAP 609 (IL RTE. 163) ST. CLAIR COUNTY**  
**STA. 100+50.00 TO STA. 101+43.00**