

F.A.P. RTE.	SECTION	COUNTY	TOTAL SHEETS	SHEET NO.
609	***	ST. CLAIR	350	229
STA. 113+50.00		TO STA. 114+50.00		
FED. ROAD DIST. NO.		ILLINOIS	FED. AID PROJECT	
*** 76RS-3, 76-2BR-21			80	

FINAL SURVEY	DATE
SURVEYED	BY
PLOTTED	
NOTE BOOK	
AREAS CHECKED	
NO.	

ORIGINAL SURVEY	DATE
SURVEYED	BY
PLOTTED	
NOTE BOOK	
AREAS CHECKED	
NO.	

PLOT DATE = 8/1/2008 4:25:44 PM
 FILE NAME = J:\02076\DRAWINGS\XSSHT163A.V8
 PLOT SCALE = 5/8" = 1' / IN.
 MODEL = Default
 OPERATOR = marks

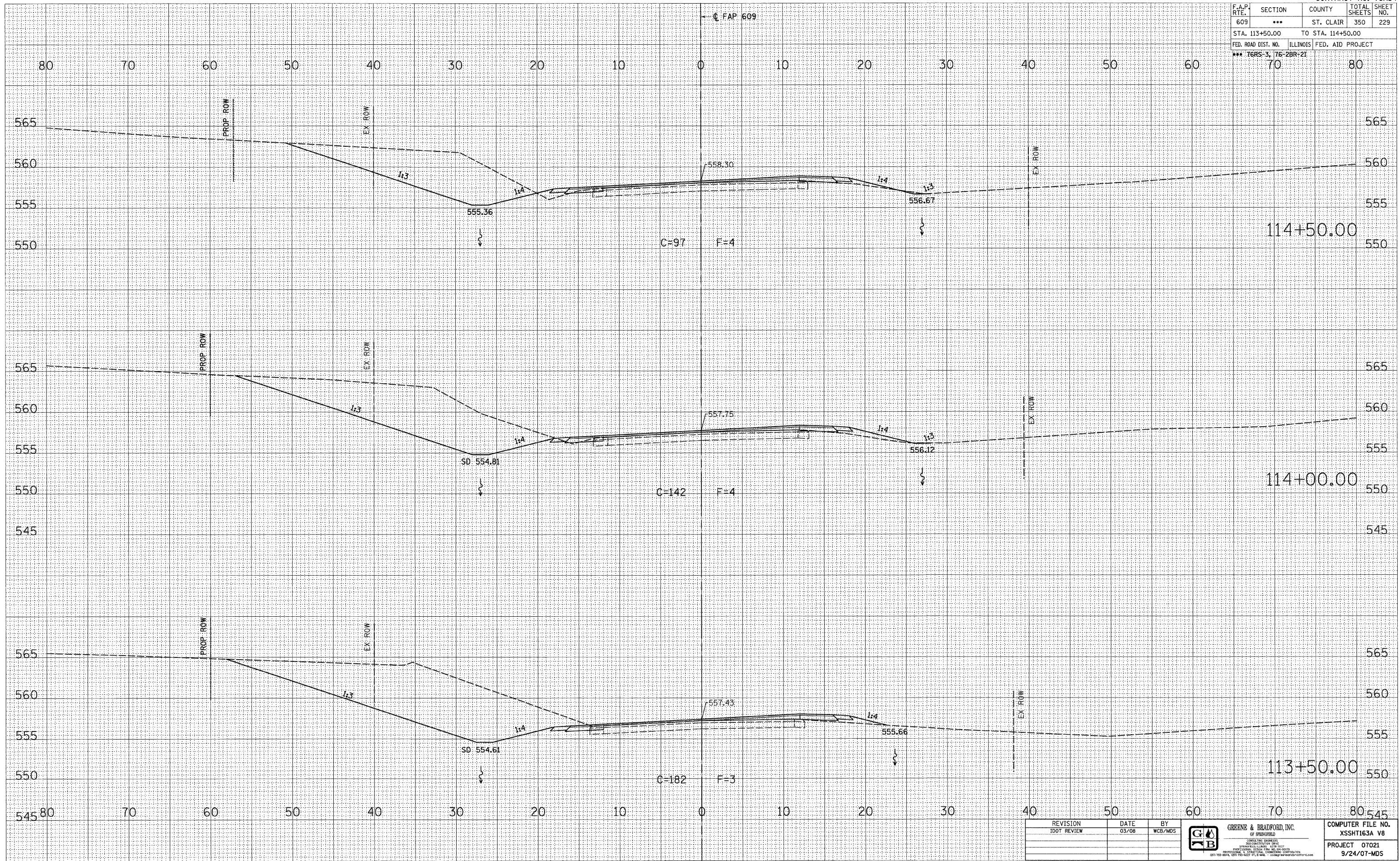

REVISION	DATE	BY
1	03/08	WCB/MDS



COMPUTER FILE NO.
XSSHT163A V8
PROJECT 07021
9/24/07-MDS

**MAINLINE CROSS SECTIONS - FAP 609 (IL RTE. 163) ST. CLAIR COUNTY
 STA. 113+50.00 TO STA. 114+50.00**