

| F.A.P. RTE. | SECTION | COUNTY | TOTAL SHEETS | SHEET NO. |
|----------------------------------|---------|-----------|------------------|-----------|
| 609 | *** | ST. CLAIR | 350 | 234 |
| STA. 120+50.00 TO STA. 121+15.00 | | | | |
| FED. ROAD DIST. NO. | | ILLINOIS | FED. AID PROJECT | |
| *** 76RS-3, 76-ZBR-21 | | | | |

| | |
|----|------|
| BY | DATE |
| | |
| | |
| | |
| | |
| | |

| | |
|----|------|
| BY | DATE |
| | |
| | |
| | |
| | |
| | |

PLOT DATE = 8/7/2008 4:28:46 PM
FILE NAME = J:\2007\DRAWINGS\XSSHT163A.VB
PLOT SCALE = 5.0000 / IN.
MODEL = Default
OPERATOR = mch

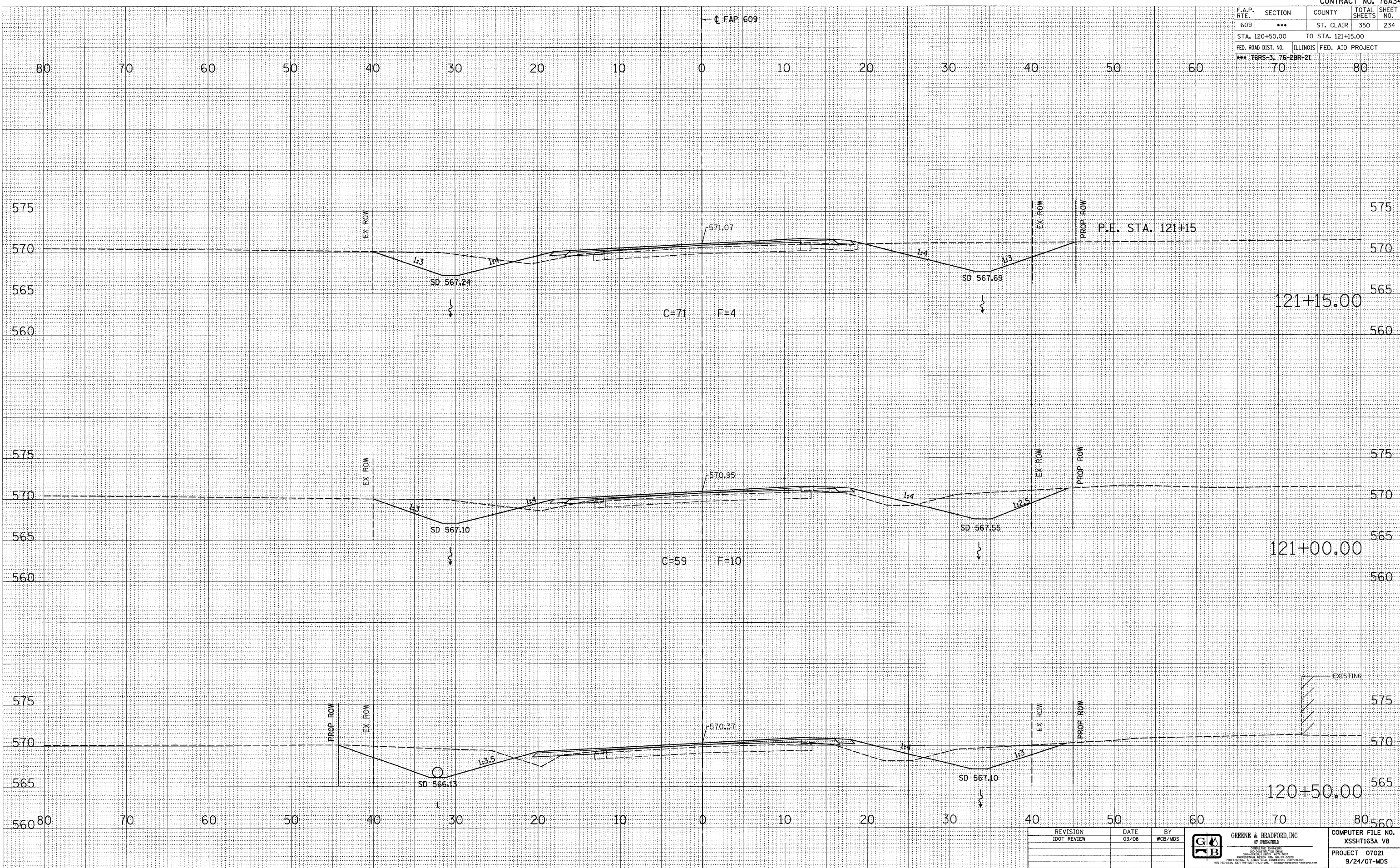

| REVISION | DATE | BY |
|----------|------|----|
| | | |
| | | |

| REVISION | DATE | BY |
|-------------|-------|---------|
| IDOT REVIEW | 03/08 | WCB/MDS |
| | | |

GREENE & BRADFORD, INC.
OF SPRINGFIELD
CONSULTING ENGINEERS
INCORPORATED
PROFESSIONAL ENGINEERS
REGISTERED IN ILLINOIS
OFFICE: 1501 S. SPRINGFIELD AVENUE
SPRINGFIELD, ILLINOIS 62703
(217) 789-8844, (217) 793-8227, FAX: (217) 789-8844
www.greenebroford.com

| | |
|-------------------|--------------|
| COMPUTER FILE NO. | XSSHT163A.VB |
| PROJECT | 07021 |
| | 9/24/07-MDS |

**MAINLINE CROSS SECTIONS - FAP 609 (IL RTE. 163) ST. CLAIR COUNTY
STA. 120+50.00 TO STA. 121+15.00**