

F.A.P. RTE.	SECTION	COUNTY	TOTAL SHEETS	SHEET NO.
609	***	ST. CLAIR	350	238
STA. 126+50.00		TO STA. 127+00.00		
FED. ROAD DIST. NO.		ILLINOIS	FED. AID PROJECT	
*** 76RS-3, 76-2BR-21		70 80		

FINAL SURVEY	DATE
SURVEYED	
PLOTTED	
NOTE BOOK	
AREAS CHECKED	

ORIGINAL SURVEY	DATE
SURVEYED	
PLOTTED	
NOTE BOOK	
AREAS CHECKED	

PLOT DATE = 8/1/2008 4:28:47 PM
 FILE NAME = J:\2007\DRAWINGS\XSSHT163A.V8
 PLOT SCALE = 5.0000 / IN.
 MODEL = Default
 OPERATOR = marks

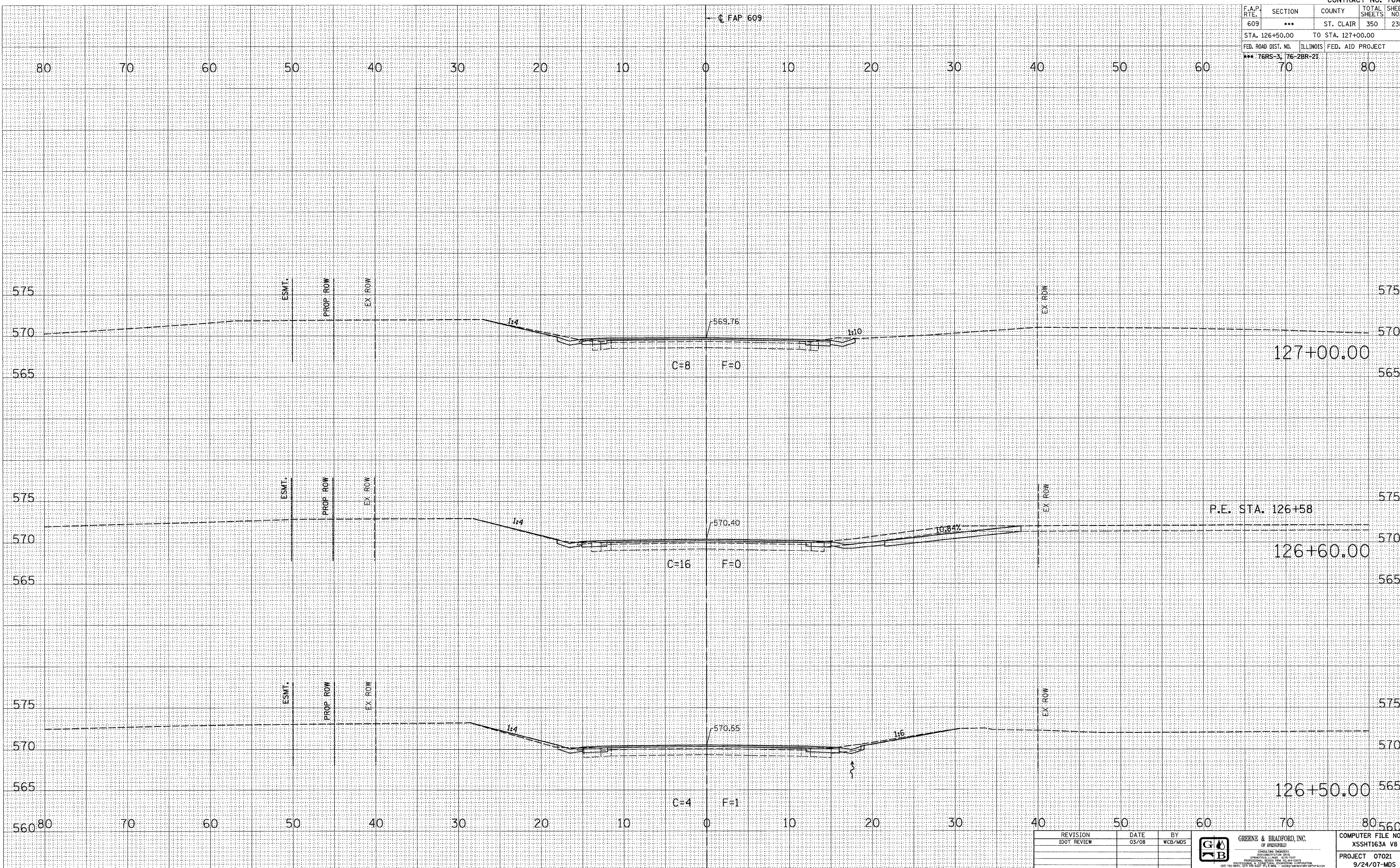

REVISION	DATE	BY
IDOT REVIEW	03/08	WCB/MDS

GREENE & BRADFORD, INC.
 OF SPRINGFIELD
 CONSULTING ENGINEERS
 PROFESSIONAL ENGINEERING
 LICENSE NO. 001-00000000
 PROFESSIONAL SURVEYING
 LICENSE NO. 001-00000000
 101 N. 4th St., Springfield, IL 62761
 TEL: 217-223-8844 FAX: 217-223-8844

COMPUTER FILE NO. XSSHT163A V8
PROJECT 07021 9/24/07-MDS

MAINLINE CROSS SECTIONS - FAP 609 (IL RTE. 163) ST. CLAIR COUNTY
STA. 126+50.00 TO STA. 127+00.00