

F.A.P. RTE.	SECTION	COUNTY	TOTAL SHEETS	SHEET NO.
609	***	ST. CLAIR	350	244
STA. 132+50.00		TO STA. 133+00.00		
FED. ROAD DIST. NO.		ILLINOIS	FED. AID PROJECT	
*** 76RS-3, 76-ZBR-21				

FINAL SURVEY	BY	DATE
NO. _____		
PLOTTED		
NOTE BOOK		
AREAS CHECKED		

ORIGINAL SURVEY	BY	DATE
NO. _____		
PLOTTED		
NOTE BOOK		
AREAS CHECKED		

PLOT DATE = 8/1/2008 4:28:49 PM
 FILE NAME = J:\2007\DRAWINGS\XSSHT163A.VB
 PLOT SCALE = 5/8" = 1' / IN.
 MODEL = Default
 OPERATOR = marks

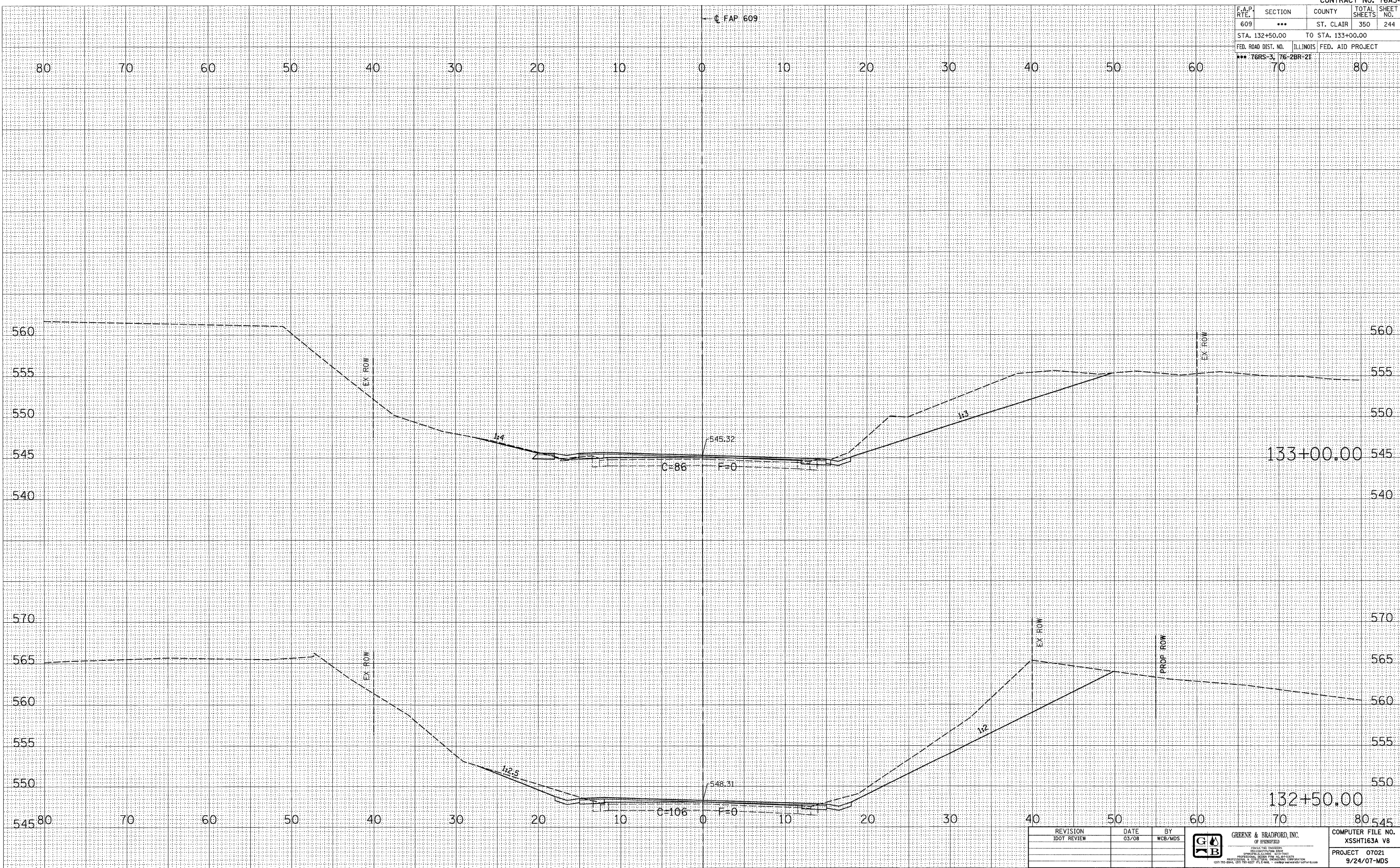

REVISION	DATE	BY
IDOT REVIEW	03/08	WCB/MDS

<p>GREENE & BRADFORD, INC. OF SPRINGFIELD</p> <p>CONSULTING ENGINEERS AND ARCHITECTS</p> <p>PROFESSIONAL DESIGN FIRM NO. 00000000 ILLINOIS PROFESSIONAL ENGINEERING NO. 00000000 ILLINOIS PROFESSIONAL ARCHITECTURE NO. 00000000</p>	<p>COMPUTER FILE NO. XSSHT163A VB</p> <p>PROJECT 07021 9/24/07-MDS</p>
--	--

**MAINLINE CROSS SECTIONS - FAP 609 (IL RTE. 163) ST. CLAIR COUNTY
 STA. 132+50.00 TO STA. 133+00.00**