

F.A.P. RTE.	SECTION	COUNTY	TOTAL SHEETS	SHEET NO.
609	***	ST. CLAIR	350	260
STA. 601+25.00		TO STA. 601+50.00		
FED. ROAD DIST. NO.	ILLINOIS	FED. AID PROJECT		
*** 76RS-3, 76-2BR-21	70	80		

FINAL SURVEY	NO.
SURVEYED	
PLOTTED	
DATE	
BY	
AREAS CHECKED	

ORIGINAL SURVEY	NO.
PLOTTED	
DATE	
BY	
AREAS CHECKED	

PLOT DATE = 8/1/2008 4:46:02 PM
 FILE NAME = J:\2007\DRAWINGS\SSHTLAKE.E.V8
 PLOT SCALE = 5/8" = 1' / IN.
 MODEL = Default
 OPERATOR = marks

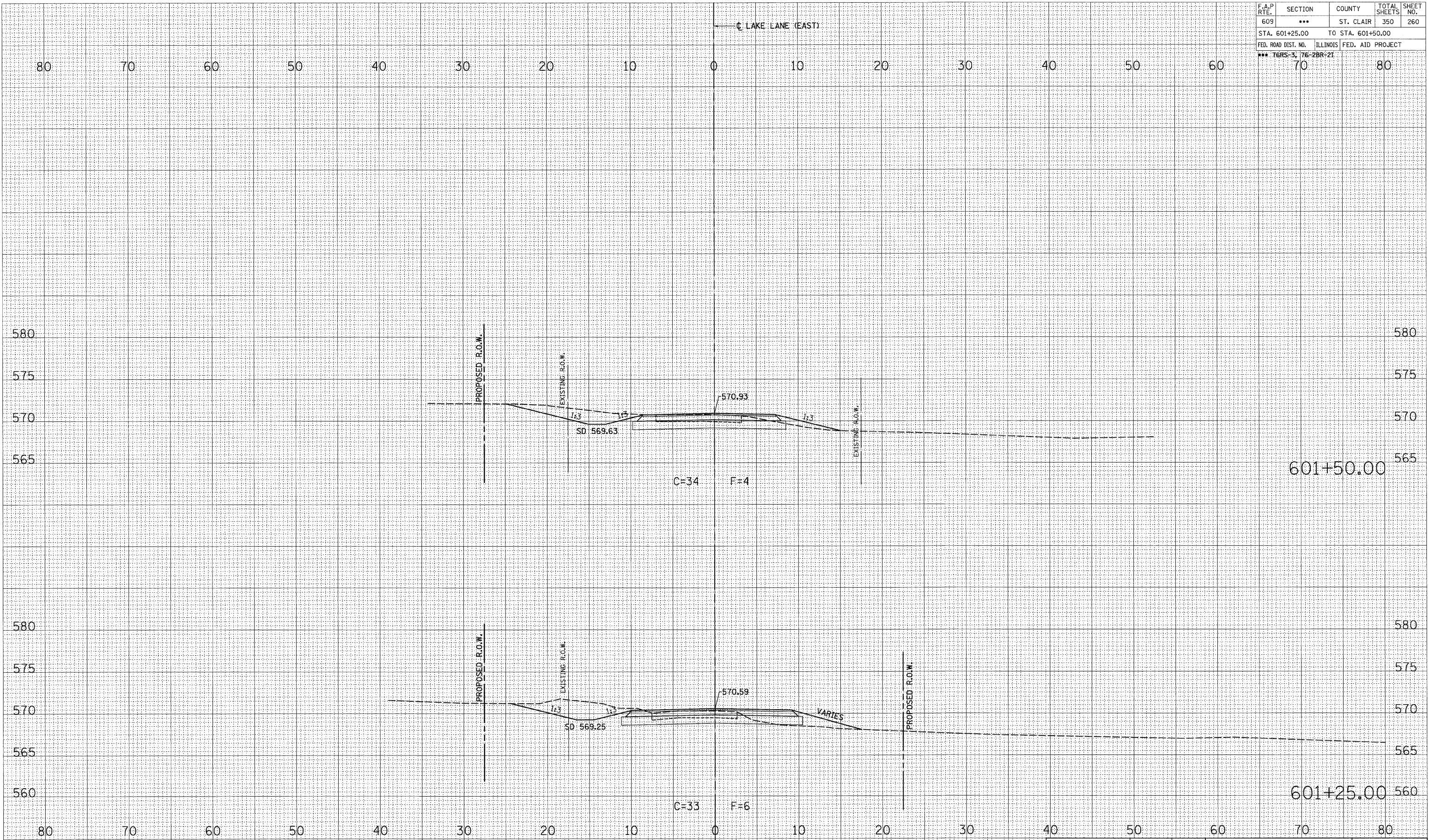

REVISION	DATE	BY
IDOT REVIEW	3/17/08	WCB/MDS



COMPUTER FILE NO.	XSSHTLAKE.E.V8
PROJECT	07021
	9/12/07-MDS

**LAKE LANE CROSS SECTIONS - FAP 609 (IL RTE. 163) ST. CLAIR COUNTY
 STA. 601+25.00 TO STA. 601+50.00**