

F.A.P. RTE.	SECTION	COUNTY	TOTAL SHEETS	SHEET NO.
609	***	ST. CLAIR	350	262
STA. 83+00.00		TO STA. 84+00.00		
FED. ROAD DIST. NO.	ILLINOIS	FED. AID PROJECT		
*** 76RS-3, 76-2BR-21	70	80		

DATE	BY

DATE	BY

PLOT DATE = 8/1/2008 4:51:48 PM  
 FILE NAME = J:\2007\DRAWINGS\XSSHTSTG163A.dgn  
 PLOT SCALE = 5/8" = 1' IN.  
 MODEL = Default  
 OPERATOR = mbrink

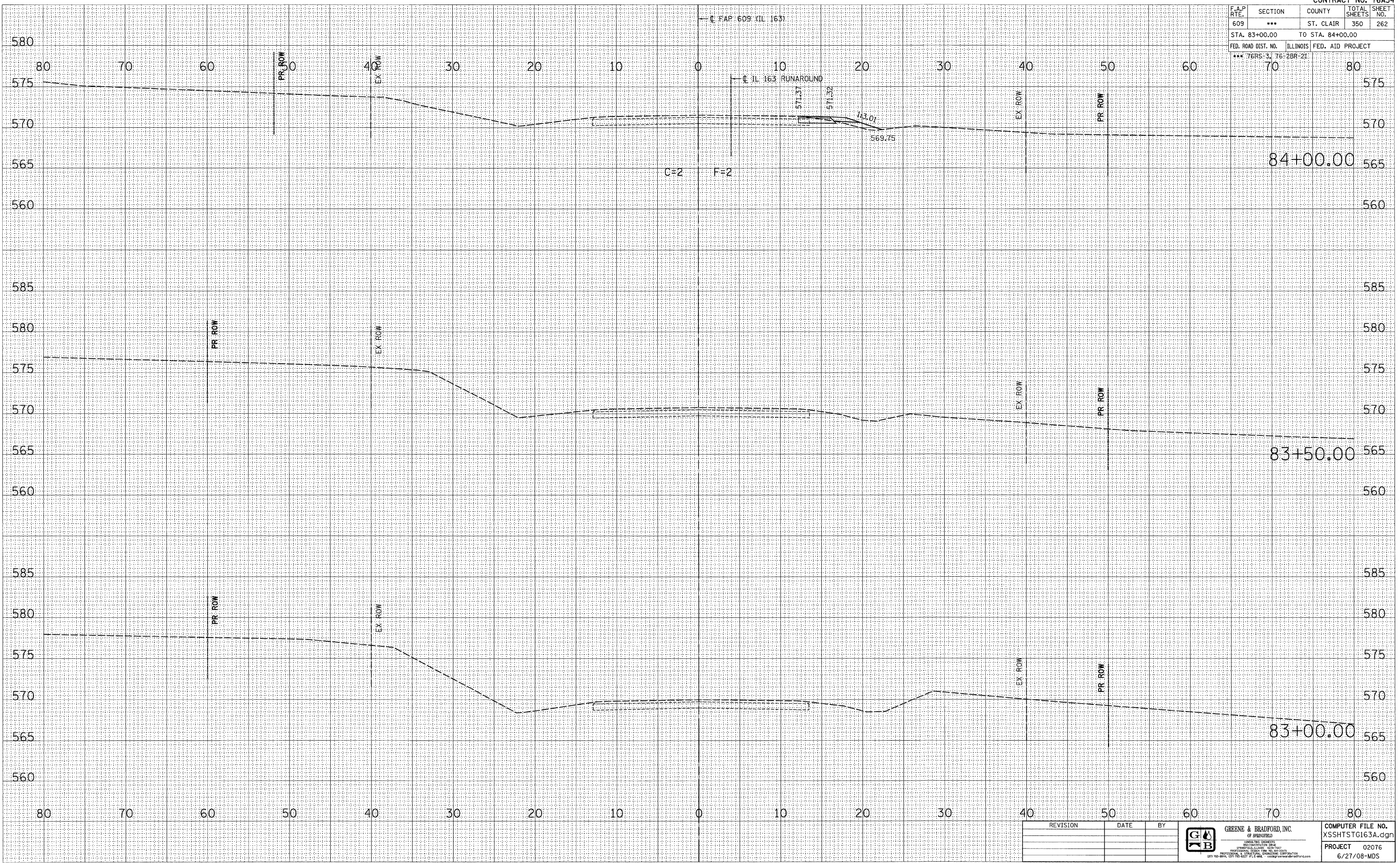

REVISION	DATE	BY



COMPUTER FILE NO.  
 XSSHTSTG163A.dgn  
 PROJECT 02076  
 6/21/08-MDS

**FAP 609 (IL RTE. 163) ST. CLAIR COUNTY / MAINLINE CROSS SECTIONS – STAGE 1  
 STA. 83+00.00 TO STA. 84+00.00**