

F.A.P. RTE.	SECTION	COUNTY	TOTAL SHEETS	SHEET NO.
609	***	ST. CLAIR	350	296
STA. 90+50.00		TO STA. 91+00.00		
FED. ROAD DIST. NO.		ILLINOIS FED. AID PROJECT		
*** 76RS-3, 76-2BR-21				

BY	DATE

BY	DATE

PLOT DATE = 8/1/2008 4:52:06 PM  
 FILE NAME = J:\2007\DRAWINGS\MESH\STG163C.dgn  
 PLOT SCALE = 5/8" = 1' IN.  
 MODEL = Default  
 OPERATOR = mark

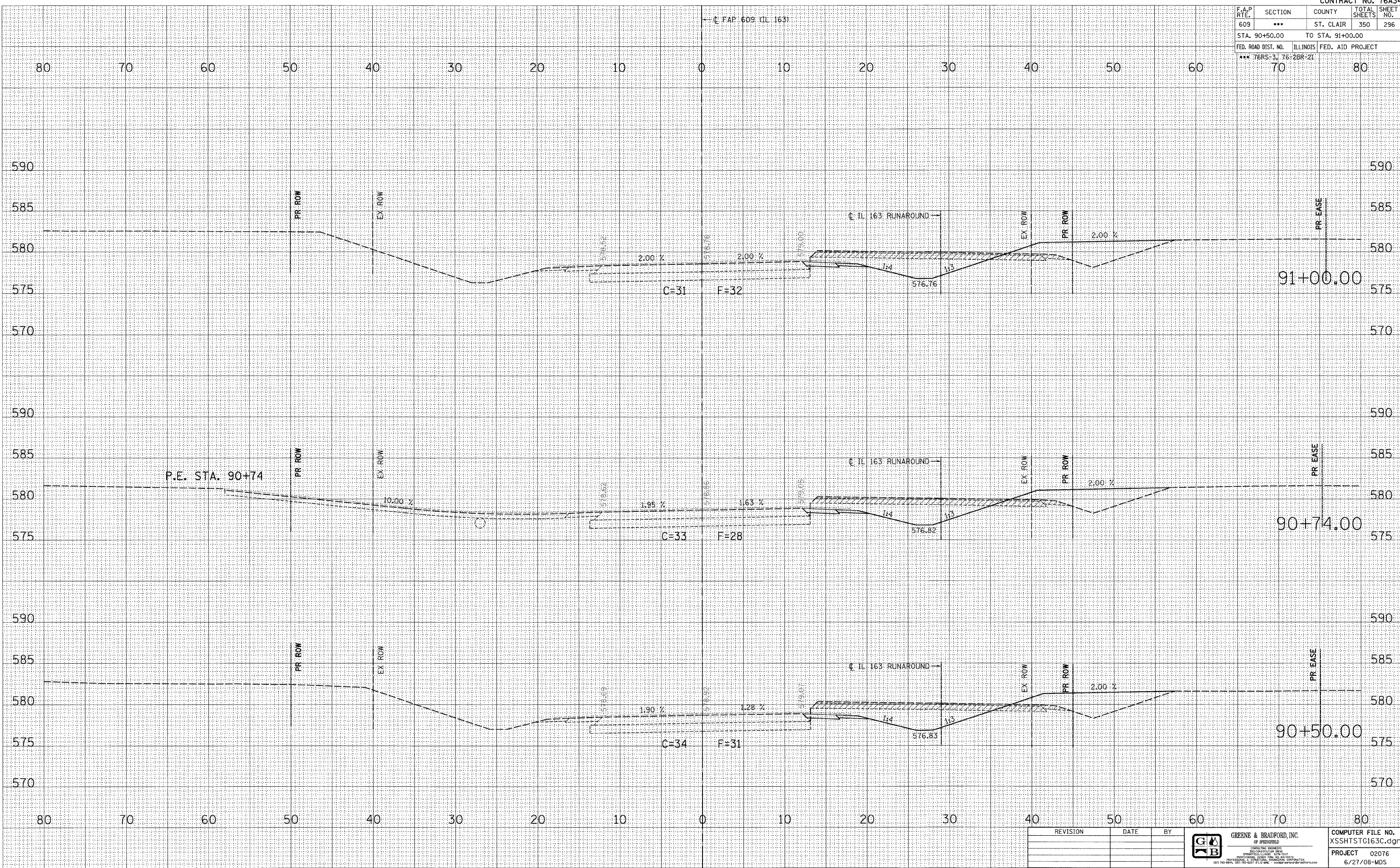

REVISION	DATE	BY

**GREENE & BRADFORD, INC.**  
 OF SPRINGFIELD  
 CONSULTING ENGINEERS  
 200 CONVENT ROAD  
 SPRINGFIELD, ILLINOIS 62761  
 PHONE: 217-223-8200 FAX: 217-223-8202  
 WWW: WWW.GREENE-AND-BRADFORD.COM  
 (618) 793-8844 (800) 793-8227 P.L. 11-816 © 2008/greeneandbradford.com

COMPUTER FILE NO.  
 XSSHTSTG163C.dgn  
 PROJECT 02076  
 6/27/08-MDS

**FAP 609 (IL RTE. 163) ST. CLAIR COUNTY / MAINLINE CROSS SECTIONS – STAGE 3**  
**STA. 90+50.00 TO STA. 91+00.00**