

SEC. 24, T. 15 N., R. 6 E., 3rd P.M.

F.A.P. RTE.	SECTION	COUNTY	TOTAL SHEETS	SHEET NO.
816	6RS-1&6BR1BR	DOUGLAS	176	36
STA. 141+40		TO STA. 147+80		
FED. ROAD DIST. NO.		ILLINOIS FED. AID PROJECT		

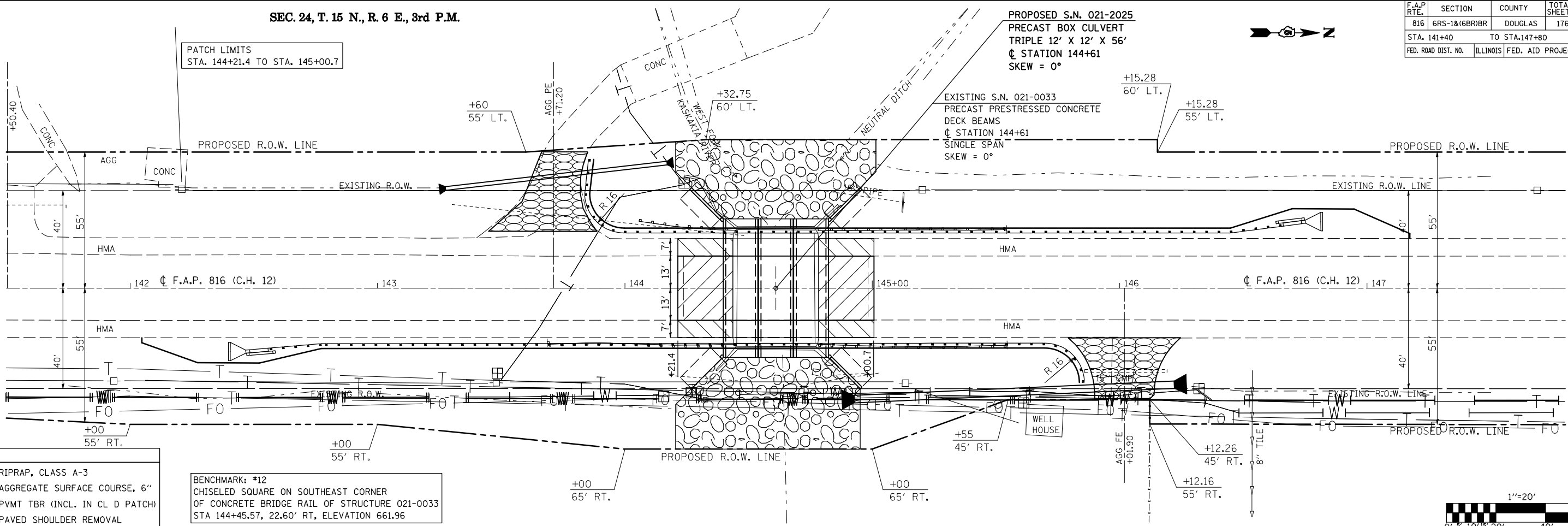

PLAN	SURVEYED	BY	DATE
	NOTED		
	PLOTTED		
	CHECKED		
	BY		
	DATE		



LEGEND

- RIPRAP, CLASS A-3
- AGGREGATE SURFACE COURSE, 6"
- PVMT TBR (INCL. IN CL D PATCH)
- PAVED SHOULDER REMOVAL

BENCHMARK: #12
 CHISELED SQUARE ON SOUTHEAST CORNER
 OF CONCRETE BRIDGE RAIL OF STRUCTURE 021-0033
 STA 144+45.57, 22.60' RT, ELEVATION 661.96

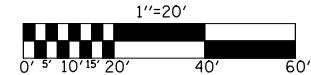

PROFILE	SURVEYED	BY	DATE
	NOTED		
	PLOTTED		
	CHECKED		
	BY		
	DATE		

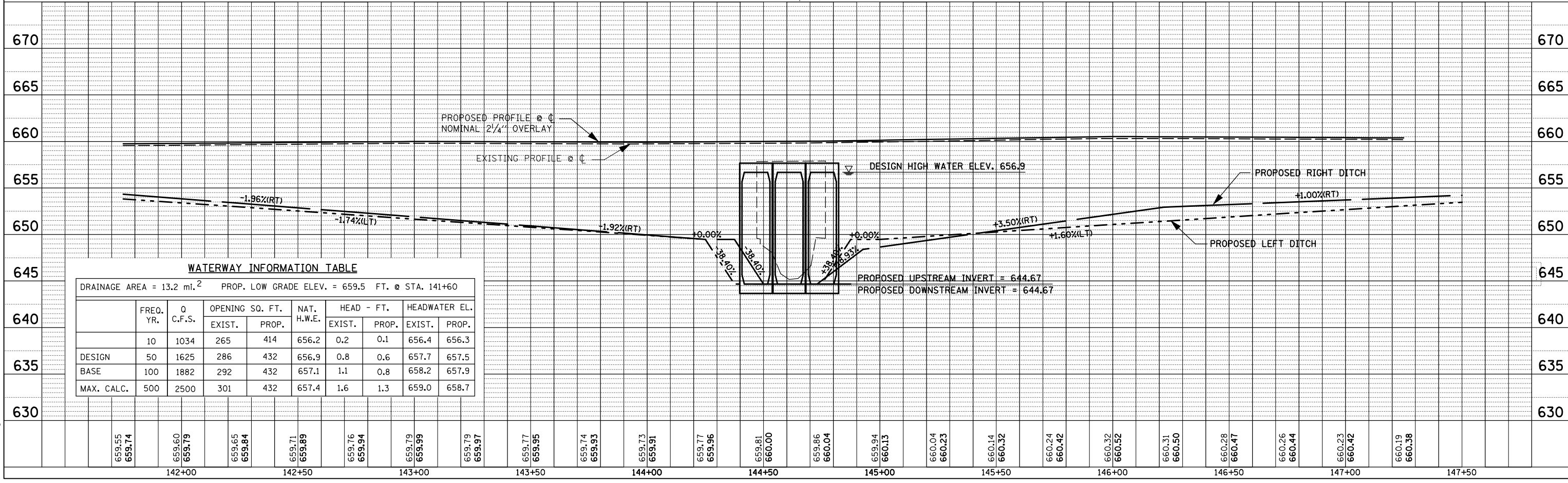

WATERWAY INFORMATION TABLE

DRAINAGE AREA = 13.2 mi.² PROP. LOW GRADE ELEV. = 659.5 FT. @ STA. 141+60

	FREQ. YR.	Q C.F.S.	OPENING SQ. FT.		NAT. H.W.E.	HEAD - FT.		HEADWATER EL.	
			EXIST.	PROP.		EXIST.	PROP.	EXIST.	PROP.
DESIGN	10	1034	265	414	656.2	0.2	0.1	656.4	656.3
BASE	50	1625	286	432	656.9	0.8	0.6	657.7	657.5
MAX. CALC.	100	1882	292	432	657.1	1.1	0.8	658.2	657.9
	500	2500	301	432	657.4	1.6	1.3	659.0	658.7

PLOT DATE = 8/22/2008
 FILE NAME = c:\projeas\080695\2007.08.13 submittal\plan sheets.dgn
 PLOT SCALE = 4:3229 / IN.
 USER NAME = kgjrb